

**FOR SALE OR LEASE**



27,160 SF

**500 AVIS DRIVE**

ANN ARBOR, MI 48108



**CUSHMAN &  
WAKEFIELD**

## Property Summary

500 Avis Drive is a 27,160 SF free-standing office building, sitting on 3.28 acres in Ann Arbor, Michigan. The building was built in 2001 and is located south of downtown Ann Arbor and University of Michigan’s campus.

PROPERTY HIGHLIGHTS	
Total Building Square Footage	27,160 SF
Total Floors	2
Total Land Acreage	3.28 acres
Parking	<ul style="list-style-type: none"><li>• 111 surface spaces</li><li>• Covered parking spaces limited</li><li>• Electric vehicle charging stations available</li></ul>
Power	480v
Zoning	Business District (BD)
Year Built	2001
Parcel ID	12-21-200-034
Taxes	\$110,643.68
SEV	\$5,159,124
Asking Price	\$3,995,000
Lease Rate	Contact broker
Misc:	<ul style="list-style-type: none"><li>• New roof in 2024</li><li>• Rooftop generator</li><li>• First floor showroom</li></ul>

## Zoning Summary

The building is zoned BD: Business District, permitting uses for office, retail, and service-oriented businesses that serve the surrounding neighborhoods (C1: Neighborhood Commercial).

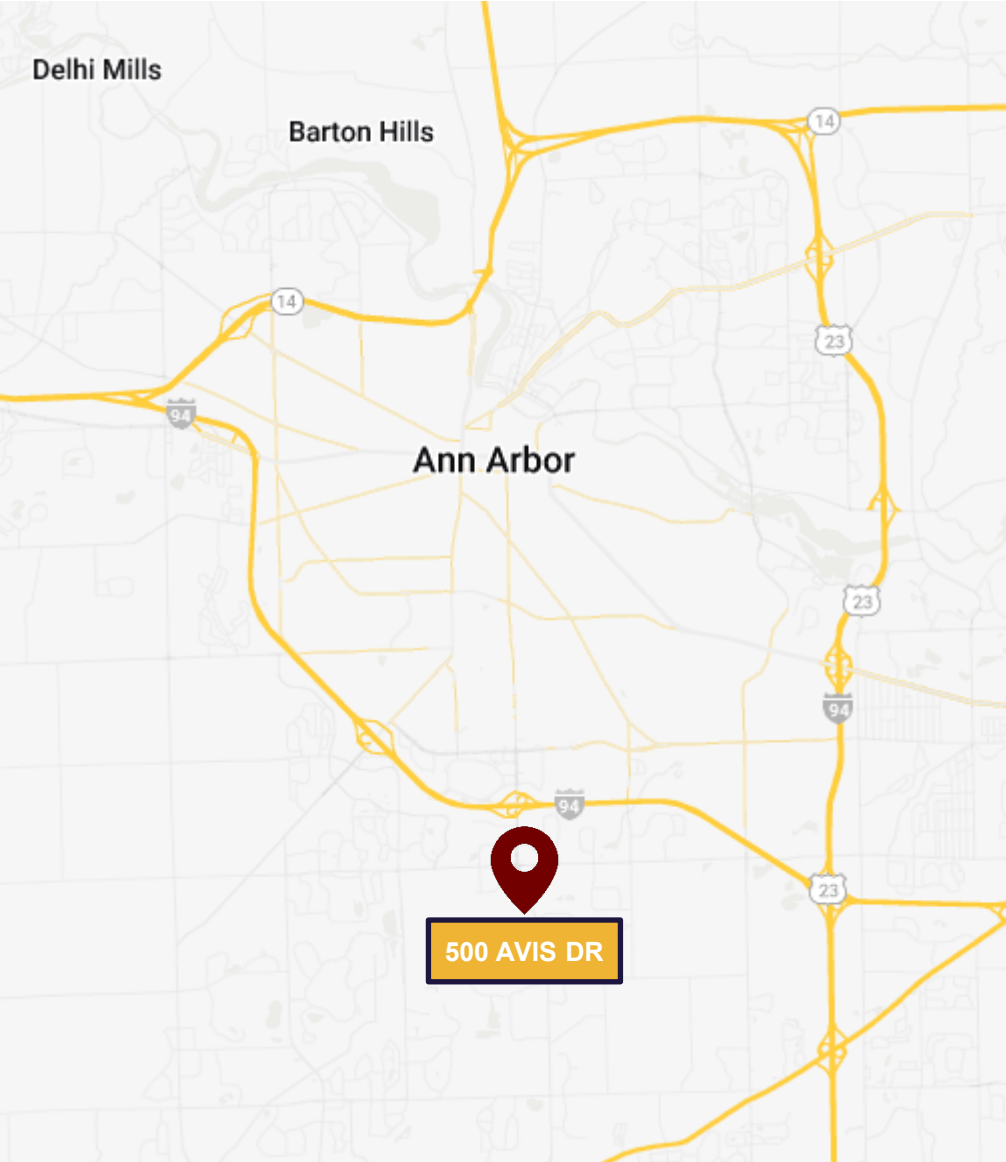



# AERIAL MAP





# FLOOR PLAN

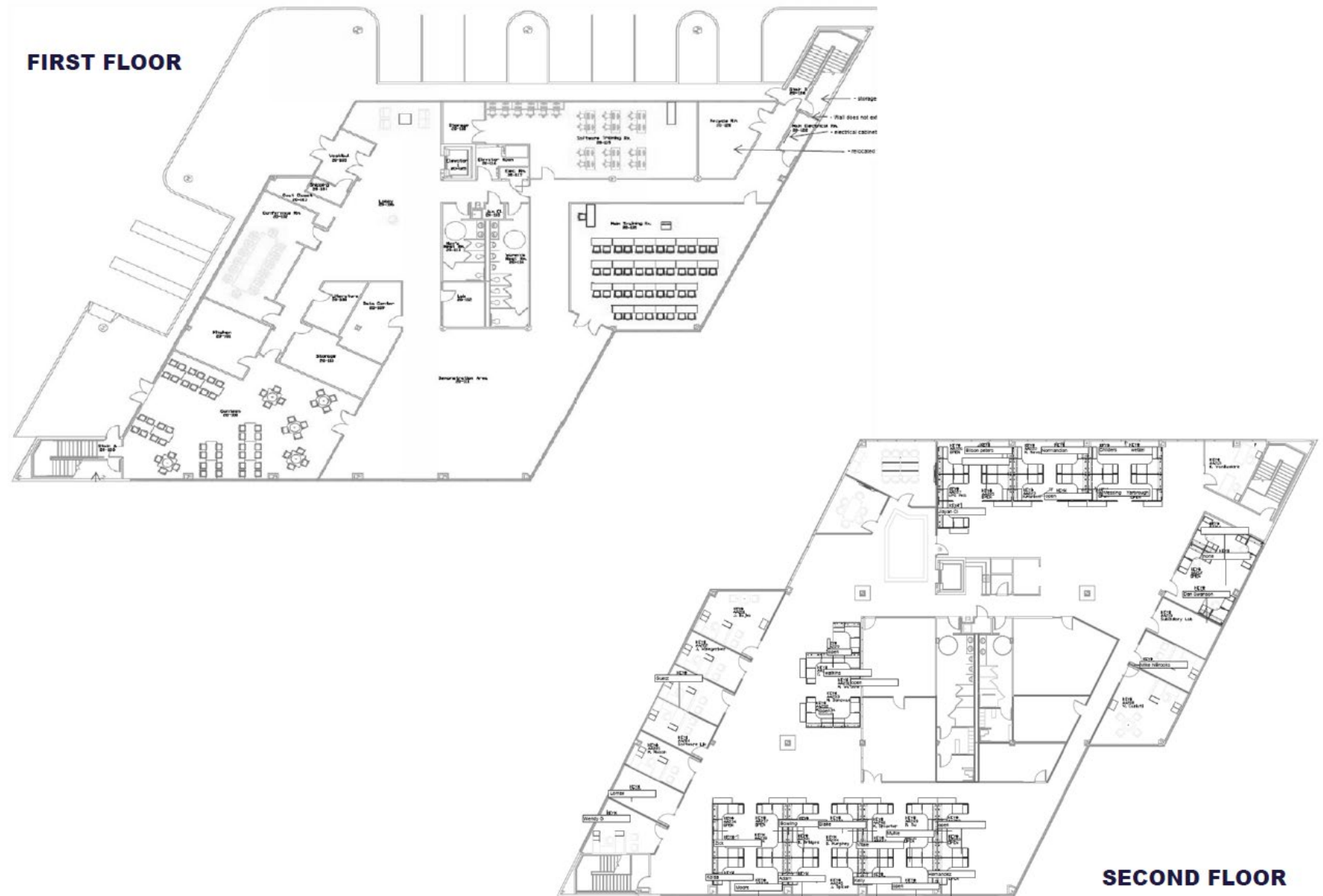

# SITE PLAN

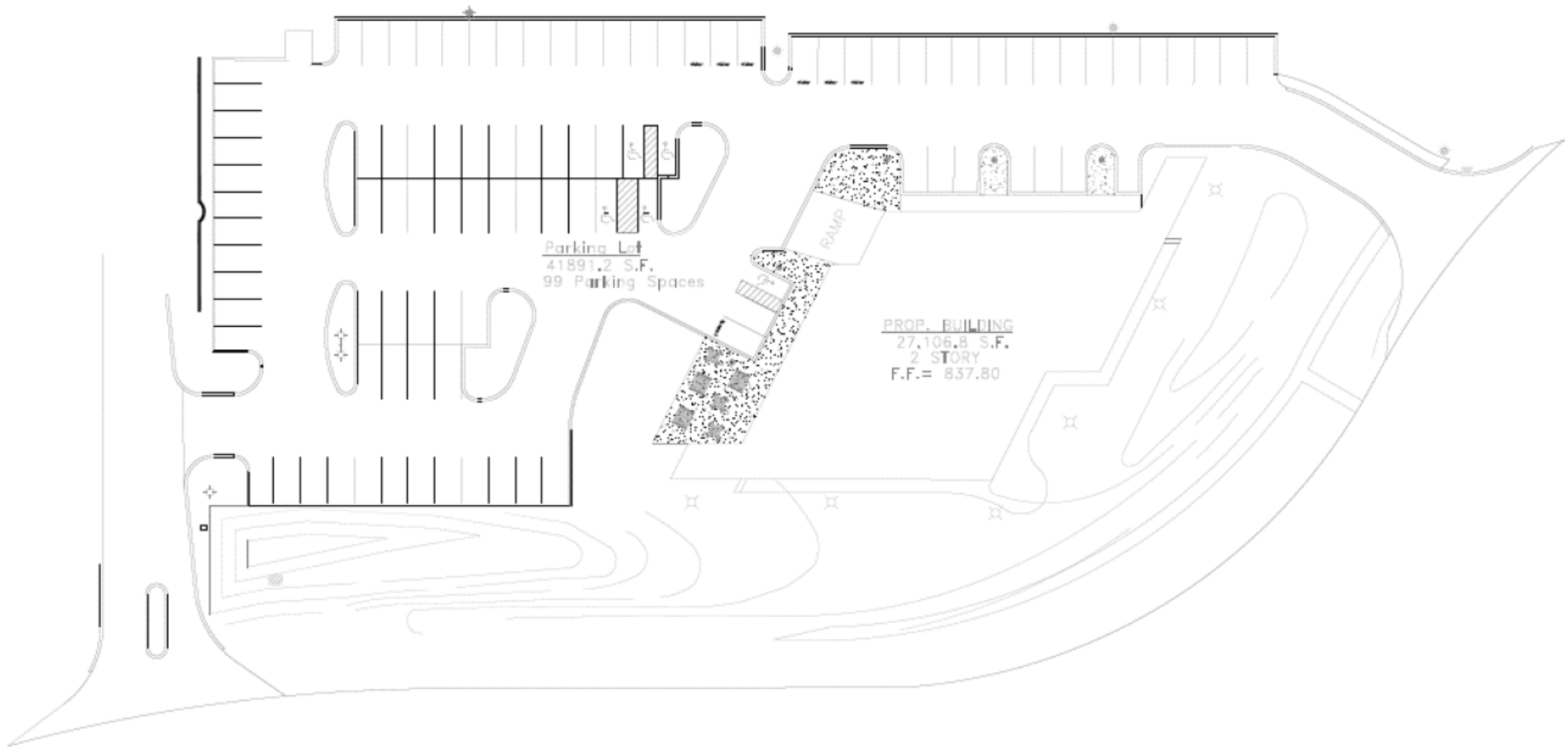

# PROPERTY PHOTOS

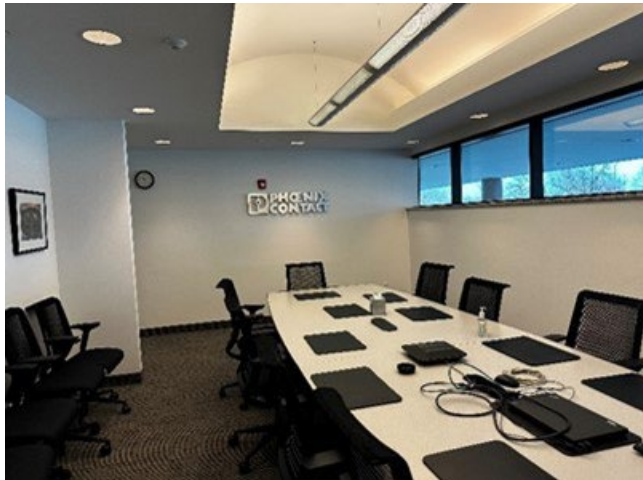



# PROPERTY PHOTOS





# PROPERTY PHOTOS

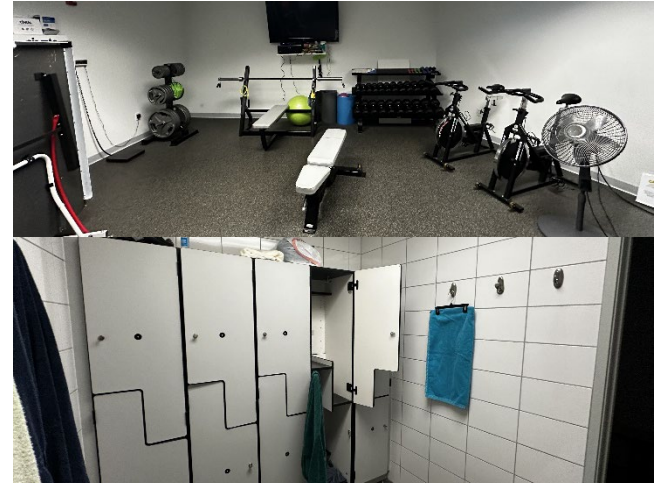





## CONTACT

### **KYLE PASSAGE**

*Senior Associate*

+1 248 358 6113

[kyle.passage@cushwake.com](mailto:kyle.passage@cushwake.com)

### **GARRETT KEAIS, SIOR**

*Executive Managing Director*

+1 248 358 6112

[garrett.keais@cushwake.com](mailto:garrett.keais@cushwake.com)



©2025 Cushman & Wakefield. All rights reserved. The information contained in this communication is strictly confidential. This information has been obtained from sources believed to be reliable but has not been verified. NO WARRANTY OR REPRESENTATION, EXPRESS OR IMPLIED, IS MADE AS TO THE CONDITION OF THE PROPERTY (OR PROPERTIES) REFERENCED HEREIN OR AS TO THE ACCURACY OR COMPLETENESS OF THE INFORMATION CONTAINED HEREIN, AND SAME IS SUBMITTED SUBJECT TO ERRORS, OMISSIONS, CHANGE OF PRICE, RENTAL OR OTHER CONDITIONS, WITHDRAWAL WITHOUT NOTICE, AND TO ANY SPECIAL LISTING CONDITIONS IMPOSED BY THE PROPERTY OWNER(S). ANY PROJECTIONS, OPINIONS OR ESTIMATES ARE SUBJECT TO UNCERTAINTY AND DO NOT SIGNIFY CURRENT OR FUTURE PROPERTY PERFORMANCE.