



ARES  
INDUSTRIAL  
MANAGEMENT

# CAJON DISTRIBUTION CENTER

6207 CAJON BLVD, SAN BERNARDINO, CA 92407

FOR LEASE | ±830,750 SQ FT | Industrial Warehouse Facility



**CHUCK BELDEN, SIOR**

909 942 4640  
chuck.belden@cushwake.com  
CA License #00844840

**PHIL LOMBARDO**

909 942 4678  
phil.lombardo@cushwake.com  
CA License #00892477

**TIM PIMENTEL, SIOR**

909 942 4647  
tim.pimentel@cushwake.com  
CA License #01421452

**ANDREW STARNES**

909 942 4667  
andrew.starnes@cushwake.com  
CA License #01799801

# Property

## FEATURES

830,750 SF Industrial Warehouse Facility

Situated on 35.2 acres

1,198' x 680' Building Dimension

36' Minimum Clear Height

Cross Dock Loading

136 Dock High Doors (48 Dock Packages)  
46 DH Doors w/ 35,000 lb. dock levelers  
2 DH Doors w/ 30,000 lb. dock levelers

4 Grade Level Ramps

232 Auto Parking

213 Trailer Parking

(2) 185' Secured Truck Courts

2,000 Amp (upgradable to 4,000 amp)

ESFR Sprinklers (K22 Heads; 40 psi)

56' (W) Typical Column Spacing

Easy access to I-215 and I-15 Freeways

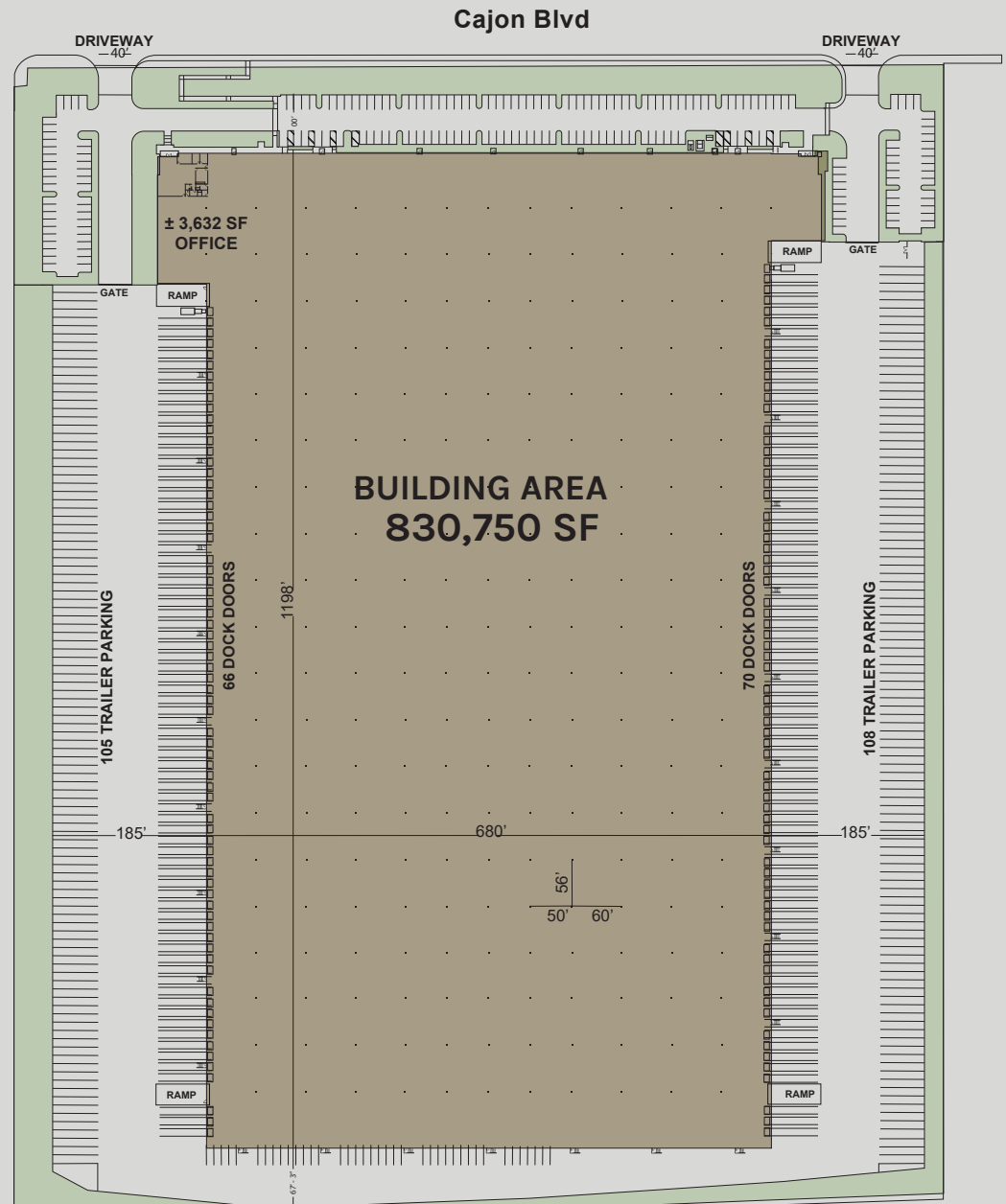

\*All Site & Building Dimensions are approximate.

# Location HIGHLIGHTS

- 2.0 miles to I-215 Freeway
- 3.0 miles to I-15 Freeway
- 5.0 miles to I-210 Freeway
- 8.1 miles to BNSF Intermodal Yard
- 18.7 miles to Ontario International Airport
- 19.9 miles to UPS Hub
- 20.4 miles to FedEx Hub



ARES  
INDUSTRIAL  
MANAGEMENT





## ABOUT ARES MANAGEMENT CORPORATION

Ares Management Corporation (NYSE: ARES) is a leading global alternative investment manager offering clients complementary primary and secondary investment solutions across the credit, private equity, real estate and infrastructure asset classes. We seek to provide flexible capital to support businesses and create value for our stakeholders and within our communities. By collaborating across our investment groups, we aim to generate consistent and attractive investment returns throughout market cycles. For more information, please visit [www.aresgmt.com](http://www.aresgmt.com).

# CORPORATE OCCUPIERS

North San Bernardino / Rialto Submarkets



**CHUCK BELDEN, SIOR**

909 942 4640  
[chuck.belden@cushwake.com](mailto:chuck.belden@cushwake.com)  
 CA License #00844840

**PHIL LOMBARDO**

909 942 4678  
[phil.lombardo@cushwake.com](mailto:phil.lombardo@cushwake.com)  
 CA License #00892477

**TIM PIMENTEL, SIOR**

909 942 4647  
[tim.pimentel@cushwake.com](mailto:tim.pimentel@cushwake.com)  
 CA License #01421452

**ANDREW STARNES**

909 942 4667  
[andrew.starnes@cushwake.com](mailto:andrew.starnes@cushwake.com)  
 CA License #01799801