

333 E MAIN STREET SUITE 500

LOUISVILLE, KY 40202

FOR SALE | 7,031 SF



**CUSHMAN &
WAKEFIELD**
Commercial Kentucky

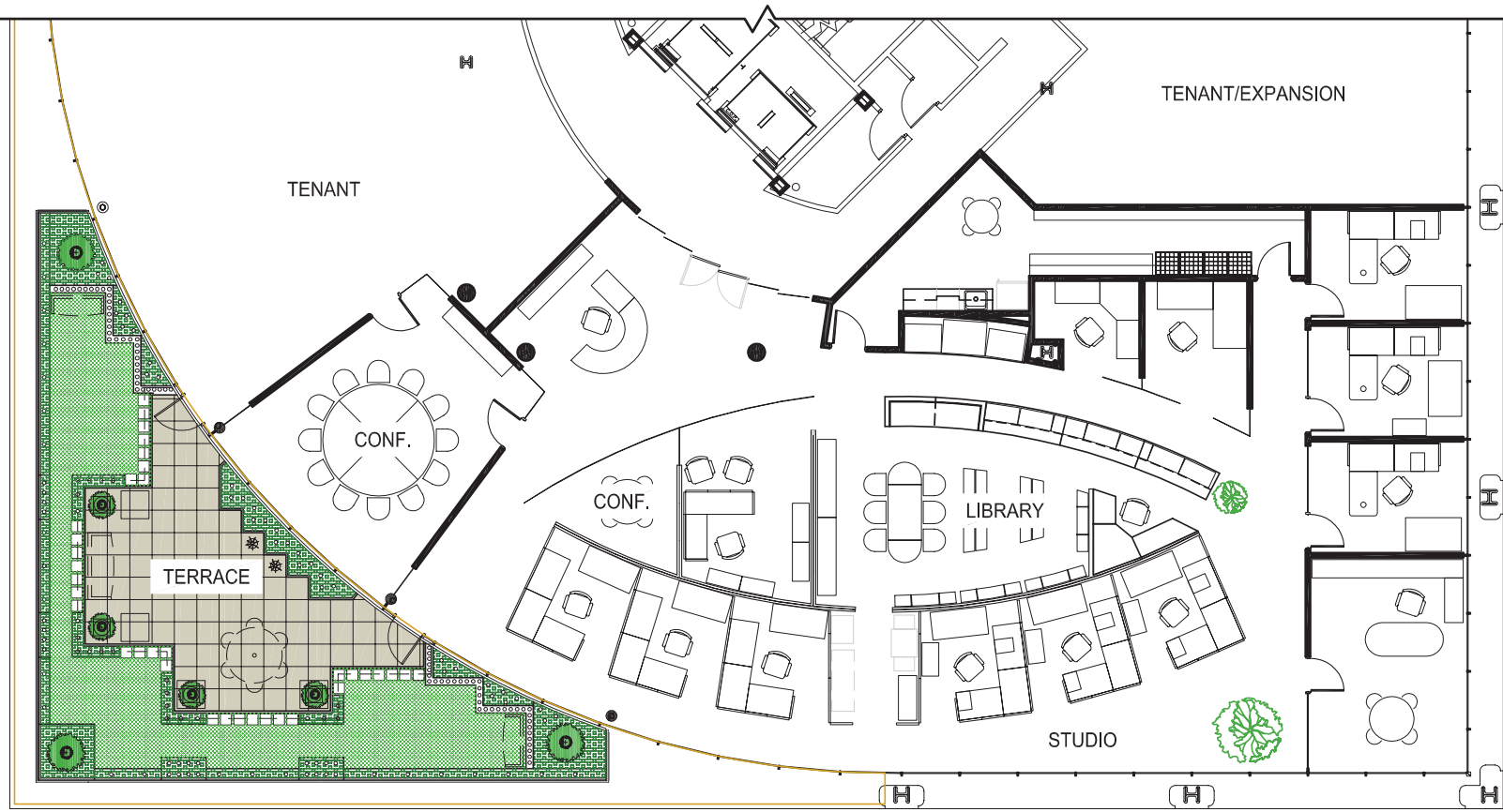

333 E MAIN STREET, SUITE 500

LOUISVILLE, KY 40202

HIGHLIGHTS

- 7,031 sf of Class A office space located on the 5th floor of Preston Pointe, with furniture available upon request
- One of Louisville's most significant works of architecture designed by a multi-award-winning architect
- Suites feature expansive windows throughout with lots of natural light
- Sweeping views of the Ohio River and Waterfront Park
- Private landscaped terrace
- Convenient parking on site
- Walking distance to Louisville Slugger field, NuLu, Whiskey Row, and KFC Yum! Center
- Easy access to I-64 and I-65

333 E MAIN STREET, SUITE 500

LOUISVILLE, KY 40202



AREA MAP

333 E MAIN STREET, SUITE 500

LOUISVILLE, KY 40202





**CUSHMAN &
WAKEFIELD**

Commercial Kentucky

BRENT DOLEN, SIOR, CCIM

Senior Director

+1 502 589 5150 ext. 262

bdolen@commercialkentucky.com

E.P. SCHERER

Senior Director

+1 502 589 5150 ext. 234

epscherer@commercialkentucky.com

CUSHMAN & WAKEFIELD | COMMERCIAL KENTUCKY

333 E Main Street, Suite 510

Louisville, KY 40202

Main +1 502 589 5150

www.commercialkentucky.com

©2024 Cushman & Wakefield. All rights reserved. The information contained in this communication is strictly confidential. This information has been obtained from sources believed to be reliable but has not been verified. NO WARRANTY OR REPRESENTATION, EXPRESS OR IMPLIED, IS MADE AS TO THE CONDITION OF THE PROPERTY (OR PROPERTIES) REFERENCED HEREIN OR AS TO THE ACCURACY OR COMPLETENESS OF THE INFORMATION CONTAINED HEREIN, AND SAME IS SUBMITTED SUBJECT TO ERRORS, OMISSIONS, CHANGE OF PRICE, RENTAL OR OTHER CONDITIONS, WITHDRAWAL WITHOUT NOTICE, AND TO ANY SPECIAL LISTING CONDITIONS IMPOSED BY THE PROPERTY OWNER(S). ANY PROJECTIONS, OPINIONS OR ESTIMATES ARE SUBJECT TO UNCERTAINTY AND DO NOT SIGNIFY CURRENT OR FUTURE PROPERTY PERFORMANCE.