

BUILDING 3 | BAY 5 @ DEPOT PARK

- **±5,445 SF OF WAREHOUSE SPACE AVAILABLE FOR LEASE**
- On-site fueling station for your fleet
- Sprinklered
- Dock & Grade Loading
- Abundant parking
- Depot Park is a fully secured business Park with enclosed perimeter, gated entry points and round-the-clock security patrol

[VIEW WEBSITE](#)

AVAILABLE

8319 Valdez Ave. | Sacramento, CA



**±5,445 SF OF WAREHOUSE SPACE
AVAILABLE FOR LEASE**

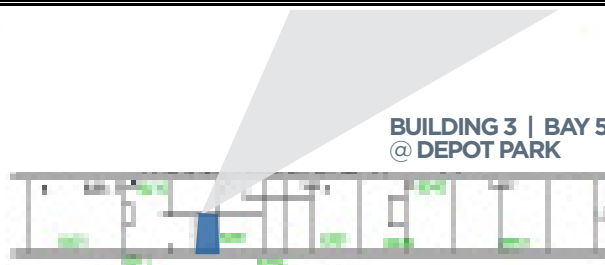

**BUILDING 3 | BAY 5
@ DEPOT PARK**

CONTACT US

David Nicholson

Senior Director

+1 916 288 4422

david.nicholson@cushwake.com

Matt Cologna, SIO

Senior Director

+1 916 288 4805

matt.cologna@cushwake.com

Bryce MacDonald

Senior Director

+1 916 288 4806

bryce.macdonald@cushwake.com

[VIEW WEBSITE](#)

[View Site Specific COVID-19 Prevention Plan](#)

©2021 Cushman & Wakefield. All rights reserved. The material in this presentation has been prepared solely for information purposes, and is strictly confidential. Any disclosure, use, copying or circulation of this presentation (or the information contained within it) is strictly prohibited, unless you have obtained Cushman & Wakefield's prior written consent. The views expressed in this presentation are the views of the author and do not necessarily reflect the views of Cushman & Wakefield. Neither this presentation nor any part of it shall form the basis of, or be relied upon in connection with any offer, or act as an inducement to enter into any contract or commitment whatsoever. No representation or warranty is given, express or implied, as to the accuracy of the information contained within this presentation, and Cushman & Wakefield is under no obligation to subsequently correct it in the event of errors.

8319 Valdez Ave. | Sacramento, CA