

# NEW CONSTRUCTION CLASS A INDUSTRIAL BUILDING

**FOR LEASE**

**±20,760 SF ON 1.58 ACRES**



3623 EAST VAN BUREN STREET

3623

**3623 EAST VAN BUREN STREET**  
**PHOENIX, ARIZONA 85008**

**JIM WILSON**

Executive Managing Director  
Direct +1 602 229 5923  
Mobile +1 602 377 1810  
[jim.wilson@cushwake.com](mailto:jim.wilson@cushwake.com)

**GARRETT WILSON**

Senior Associate  
Direct +1 602 224 4458  
Mobile +1 602 819 4454  
[garrett.wilson@cushwake.com](mailto:garrett.wilson@cushwake.com)

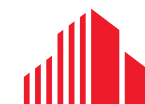

**CUSHMAN &  
WAKEFIELD**

## SITE PLAN

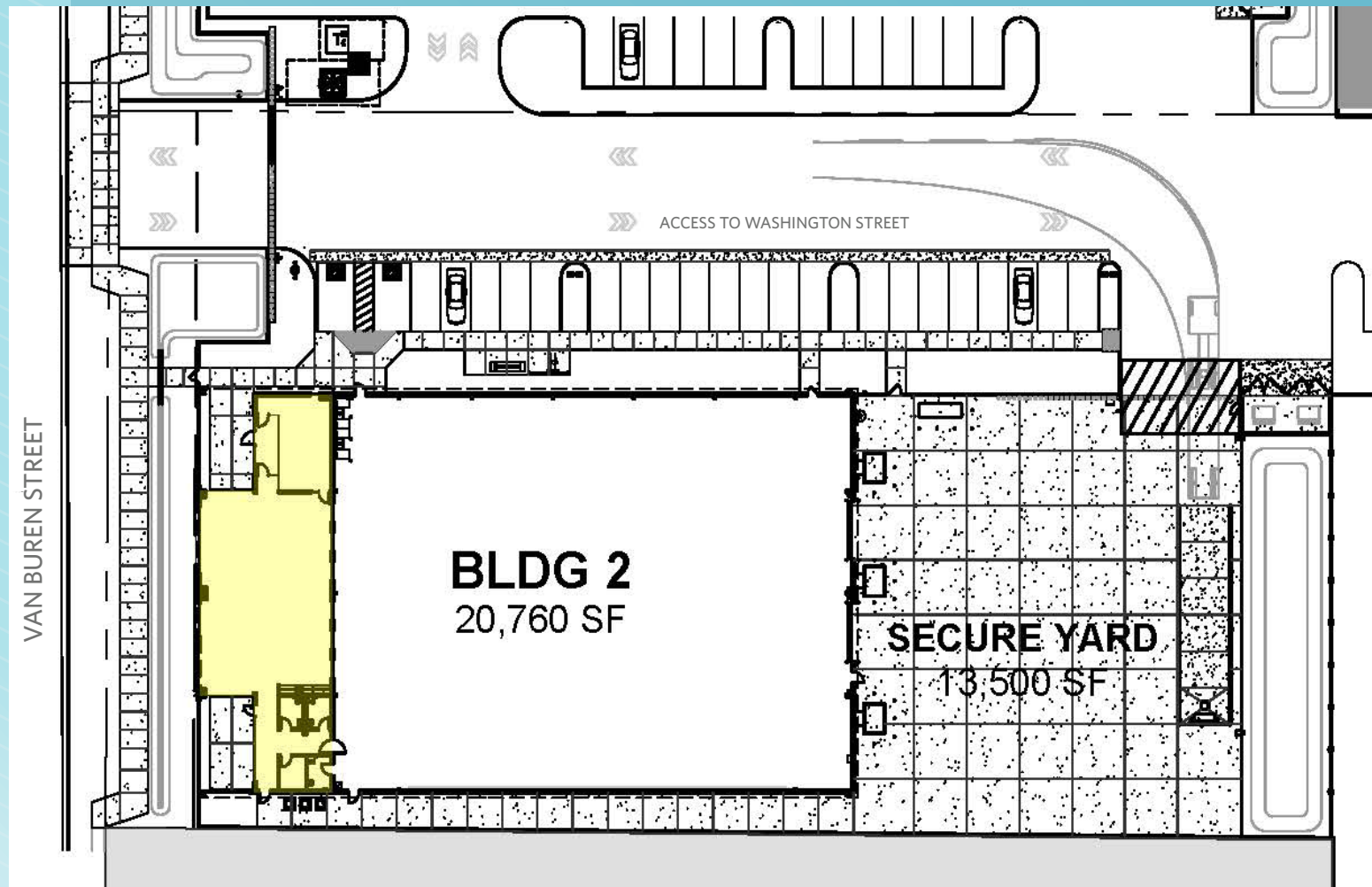

**Available**  
20,760 SF



**Office**  
3,160 SF



**Lot Size**  
1.58 Acres



**Warehouse**  
Clearance  
19' - 22'



**EVAP**  
Cooled  
Warehouse



**800 Amps**  
277/480 Volt  
3-phase



**Grade/  
Truckwell**  
Loading



## LOCATION



### Phoenix Sky Harbor International Airport

Close proximity, within a 5-minute drive



### Interstate 10

<1 mile

## PROPERTY HIGHLIGHTS

- New Block & Metal Construction
- EVAP Cooled Warehouse
- 13,500-SF Fenced truck court & yard with motorized gate (8' block fence)
- 800 amps, 277/480 volt, 3-phase
- (1) 12' x 14' — Grade level Door
- Gate Secured Truckwell
- 19' - 22' clear height (Free-span warehouse)
- C-3 & TOD-2 (Gateway), City of Phoenix
- Parking: 23 spaces
- Sprinklers: ESFR
- Walking distance to Sky Harbor SkyTrain @ 44th Street Station

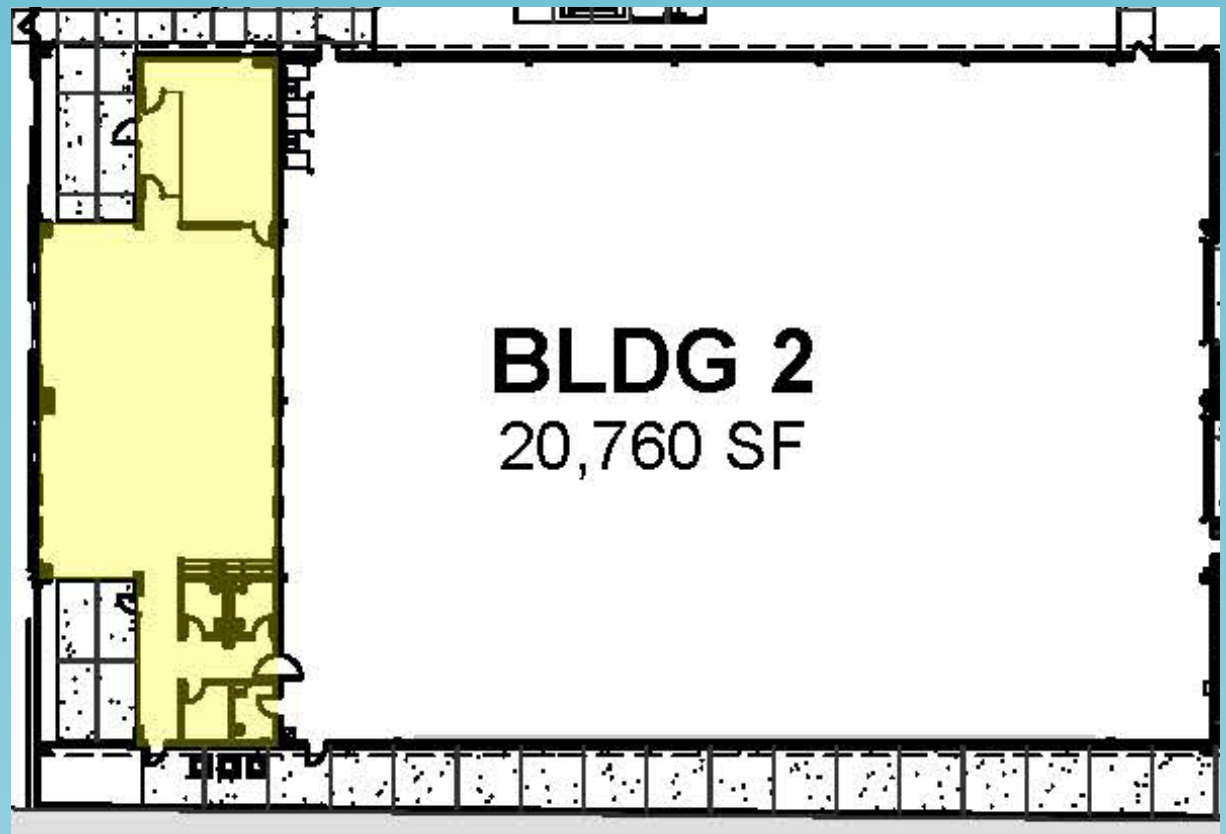

## AREA MAP



3623 EAST VAN BUREN STREET

3623

For more information, please contact:

### JIM WILSON

Executive Managing Director  
Direct +1 602 229 5923  
Mobile +1 602 377 1810  
jim.wilson@cushwake.com

### GARRETT WILSON

Senior Associate  
Direct +1 602 224 4458  
Mobile +1 602 819 4454  
garrett.wilson@cushwake.com

2555 E Camelback Rd., Suite 400  
Phoenix, Arizona 85016  
Main +1 602 954 9000  
Fax +1 602 253 0528  
[cushmanwakefield.com](http://cushmanwakefield.com)



**CUSHMAN &  
WAKEFIELD**

©2025 Cushman & Wakefield. All rights reserved. The information contained in this communication is strictly confidential. This information has been obtained from sources believed to be reliable but has not been verified. NO WARRANTY OR REPRESENTATION, EXPRESS OR IMPLIED, IS MADE AS TO THE CONDITION OF THE PROPERTY (OR PROPERTIES) REFERENCED HEREIN OR AS TO THE ACCURACY OR COMPLETENESS OF THE INFORMATION CONTAINED HEREIN, AND SAME IS SUBMITTED SUBJECT TO ERRORS, OMISSIONS, CHANGE OF PRICE, RENTAL OR OTHER CONDITIONS, WITHDRAWAL WITHOUT NOTICE, AND TO ANY SPECIAL LISTING CONDITIONS IMPOSED BY THE PROPERTY OWNER(S). ANY PROJECTIONS, OPINIONS OR ESTIMATES ARE SUBJECT TO UNCERTAINTY AND DO NOT SIGNIFY CURRENT OR FUTURE PROPERTY PERFORMANCE.