



FOR LEASE – ±100,000 SF

1104 PIEDMONT HIGHWAY

Piedmont, SC 29673



CUSHMAN &
WAKEFIELD

STAG
INDUSTRIAL

PROPERTY FEATURES

1104 PIEDMONT HIGHWAY

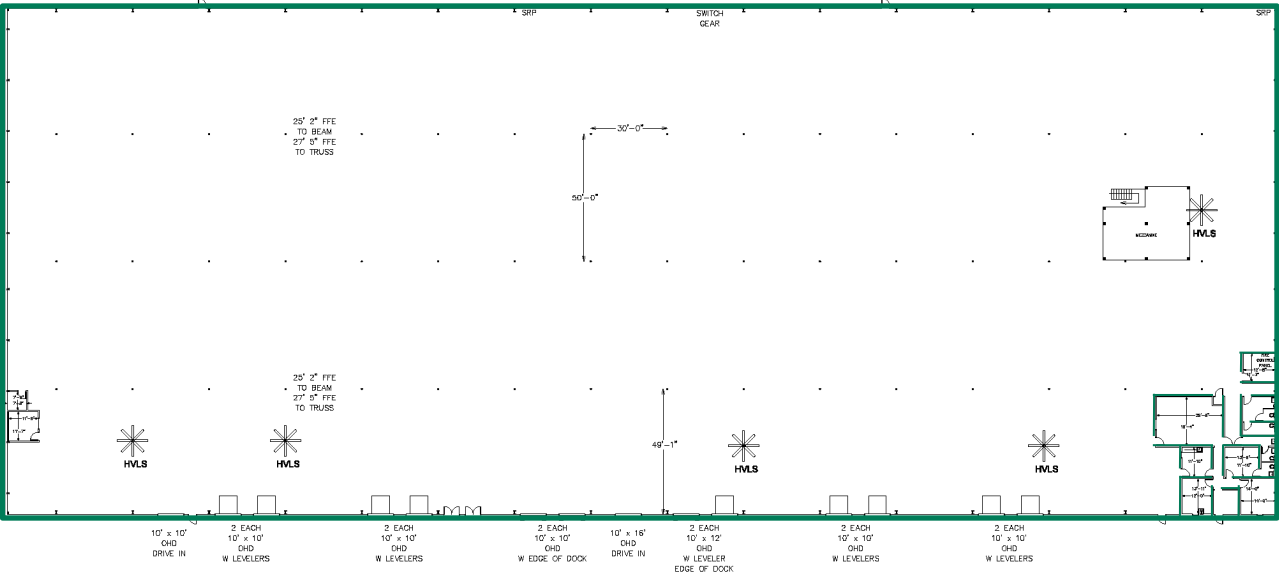

BUILDING SIZE:	±100,000 SF
SPACE AVAILABLE:	±100,000 SF
OFFICE AREA:	± 2,000 SF
SITE AREA:	24.15 AC
CLEAR HEIGHT:	29'
DOCK DOORS:	12
DRIVE-INS:	1 total (10' x 10')
PARKING:	25
YEAR BUILT:	1995 (Renov. 1997)
COLUMN SPACING:	50' x 30'
SPRINKLER:	ESFR
ELECTRICAL:	3phase
LEASE RATE:	Call brokers for details



LOCATION MAP

1104 PIEDMONT HIGHWAY

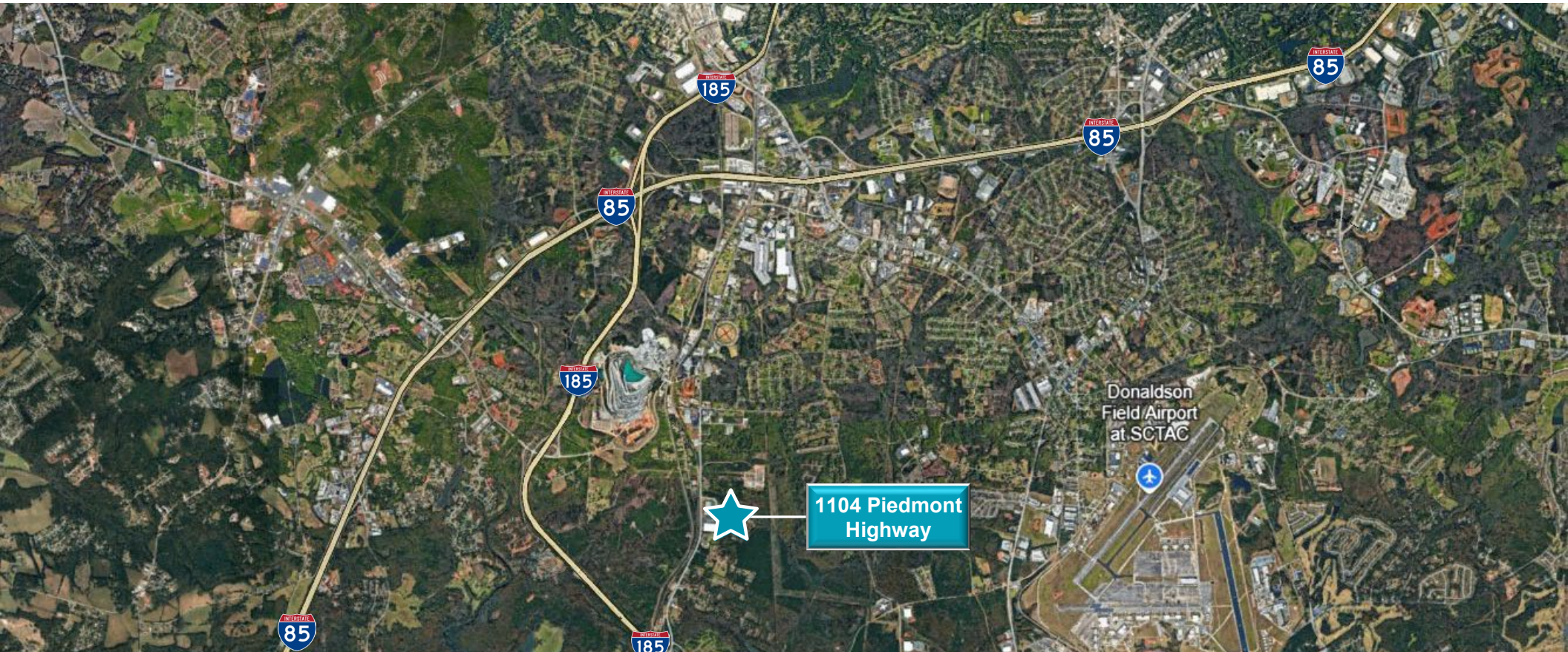

DEMOGRAPHICS 10 MILES

343,407
POPULATION

139,511
HOUSEHOLDS

\$86,608
AVG HH INCOME

Nearby
Neighbors



PROXIMITY MAP

1104 PIEDMONT HIGHWAY



MILEAGE & DRIVE TIME



GREENVILLE



7.2 MILES VIA SC-20 N



13 MINS VIA SC-20 N



**GREENVILLE-SPARTANBURG
INTERNATIONAL AIRPORT (GSP)**



16.9 MILES VIA I-85 N



18 MINS VIA I-85 N



SPARTANBURG



35.7 MILES VIA I-85 N



39 MINS VIA I-85 N



Old Piedmont Hwy

Piedmont Hwy

FOR MORE INFORMATION, CONTACT:

KACIE JACKSON, SIOR
Senior Director
+1 864 370 8193
kacie.jackson@cushwake.com

ELLIOTT FAYSSOUX, SIOR
Senior Director
+1 864 370 8190
elliott.fayssoux@cushwake.com

DREW WALTERS
Associate
+1 864 704 1345
andrew.walters@cushwake.com

©2025 Cushman & Wakefield. All rights reserved. The information contained in this communication is strictly confidential. This information has been obtained from sources believed to be reliable but has not been verified. NO WARRANTY OR REPRESENTATION, EXPRESS OR IMPLIED, IS MADE AS TO THE CONDITION OF THE PROPERTY (OR PROPERTIES) REFERENCED HEREIN OR AS TO THE ACCURACY OR COMPLETENESS OF THE INFORMATION CONTAINED HEREIN, AND SAME IS SUBMITTED SUBJECT TO ERRORS, OMISSIONS, CHANGE OF PRICE, RENTAL OR OTHER CONDITIONS, WITHDRAWAL WITHOUT NOTICE, AND TO ANY SPECIAL LISTING CONDITIONS IMPOSED BY THE PROPERTY OWNER(S). ANY PROJECTIONS, OPINIONS OR ESTIMATES ARE SUBJECT TO UNCERTAINTY AND DO NOT SIGNIFY CURRENT OR FUTURE PROPERTY PERFORMANCE.

