

1600 PARK 370 PLACE

HAZELWOOD, MO 63042

PROPERTY HIGHLIGHTS

Total Building Area:	174,000 SF
Total Available Area:	45,620 SF
Office Area:	9,600 SF
Clear Height:	28'
Loading:	8 (9' x 10') Docks, 2 Drive-Ins
Column Spacing:	40' x 40'
Speed Bay	60' x 40'
Building Depth:	220'
Building Type:	Tilt-up panel (2001)
Power:	2,000 amp, 3-phase, 480/277 volt
Fire Suppression:	ESFR
Lease Rate:	Contact Broker

45,620 SF

AVAILABLE FOR LEASE

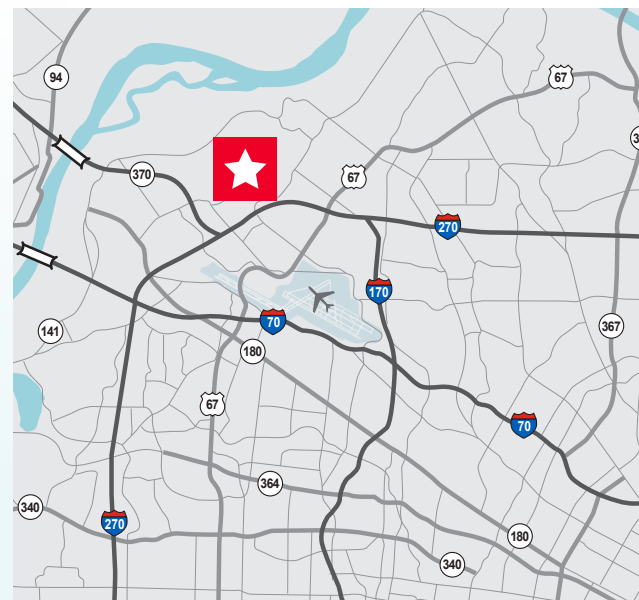

MATT EASTIN, SIOR, CCIM
Executive Director
+1 314 746 0350
matt.eastin@cushwake.com

CHRISTY WIRTH, SIOR, CCIM
Director
+1 314 813 9524
christy.wirth@cushwake.com

OWNED BY

STOCKBRIDGE

**LEASING &
MANAGEMENT**

**CUSHMAN &
WAKEFIELD**

FOR LEASE
45,620 SF

1600 PARK 370 | HAZELWOOD, MO 63042

FLOOR PLAN

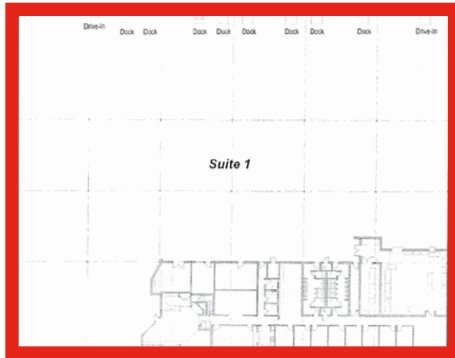

Leased

AERIAL



FOR MORE INFORMATION, PLEASE CONTACT:

MATT EASTIN, SIOR, CCIM
Executive Director
+1 314 746 0350
matt.eastin@cushwake.com

CHRISTY WIRTH, SIOR, CCIM
Director
+1 314 813 9524
christy.wirth@cushwake.com