

FOR LEASE

14501 E 35TH PLACE, UNIT 400

UPLAND INDUSTRIAL PARK 1
AURORA, CO 80011



END-CAP WITH AMPLE PARKING
AND POTENTIAL SMALL YARD AREA



NEW OFFICE REFRESH



45,588 SF FOR LEASE | LEASE RATE: \$7.25/SF

PROPERTY FEATURES

Available SF	Unit 400: ±45,588 SF
Total Building SF	156,838 SF
Location	I-70 and Chambers Road
Office SF	±2,673 SF
Loading	6 Dock-High Doors 1 Drive-In Door 2 Rail Doors
Clear Height	±24' - 27'
Zoning	M-1
YOC	1982
City/County	Aurora/Adams
Sprinklered	ESFR
Rail	Union Pacific
Power	3 phase, 480v, 200 amps (TBV and power upgrade possible)
Building Depth	200'
Column Spacing	40' x 33.3'
Rate	\$7.25/SF
Est. Expenses	\$5.54/SF (2025)

BUILDING FLOOR PLAN

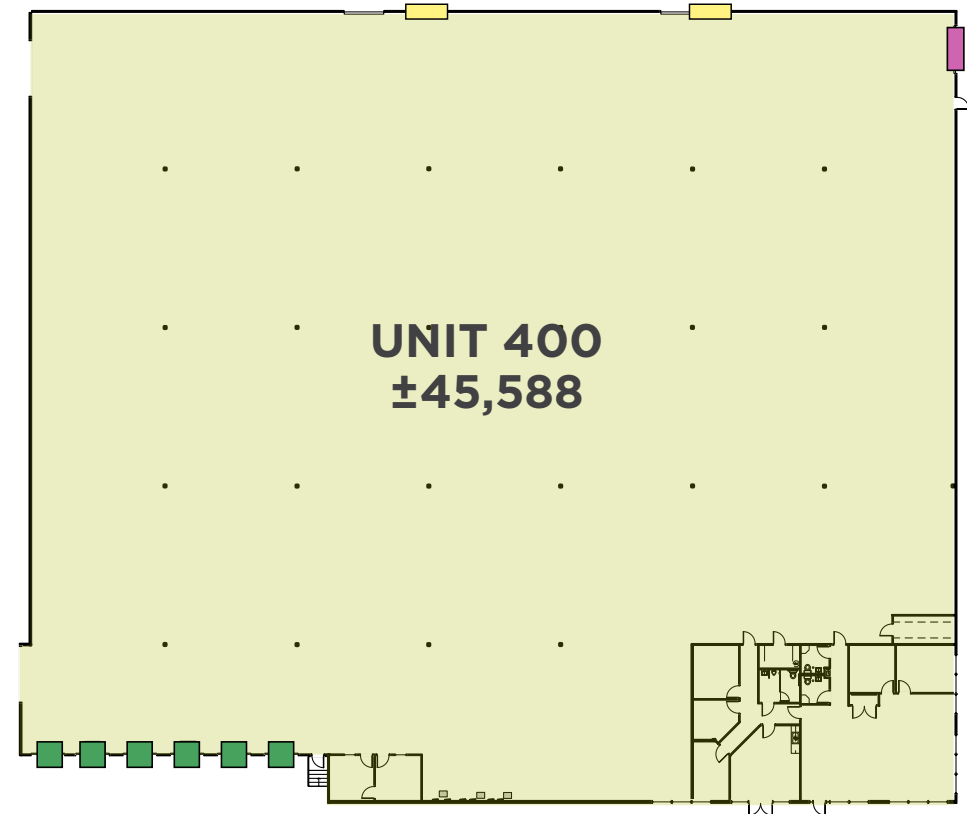

■ DOCK HIGH DOOR

■ DRIVE IN DOOR

■ RAIL DOOR

PROPERTY HIGHLIGHTS



Skylights in the warehouse



Potential fenced yard areas



Dock and drive-in loading



Front park / front load



New office refresh



Rail served

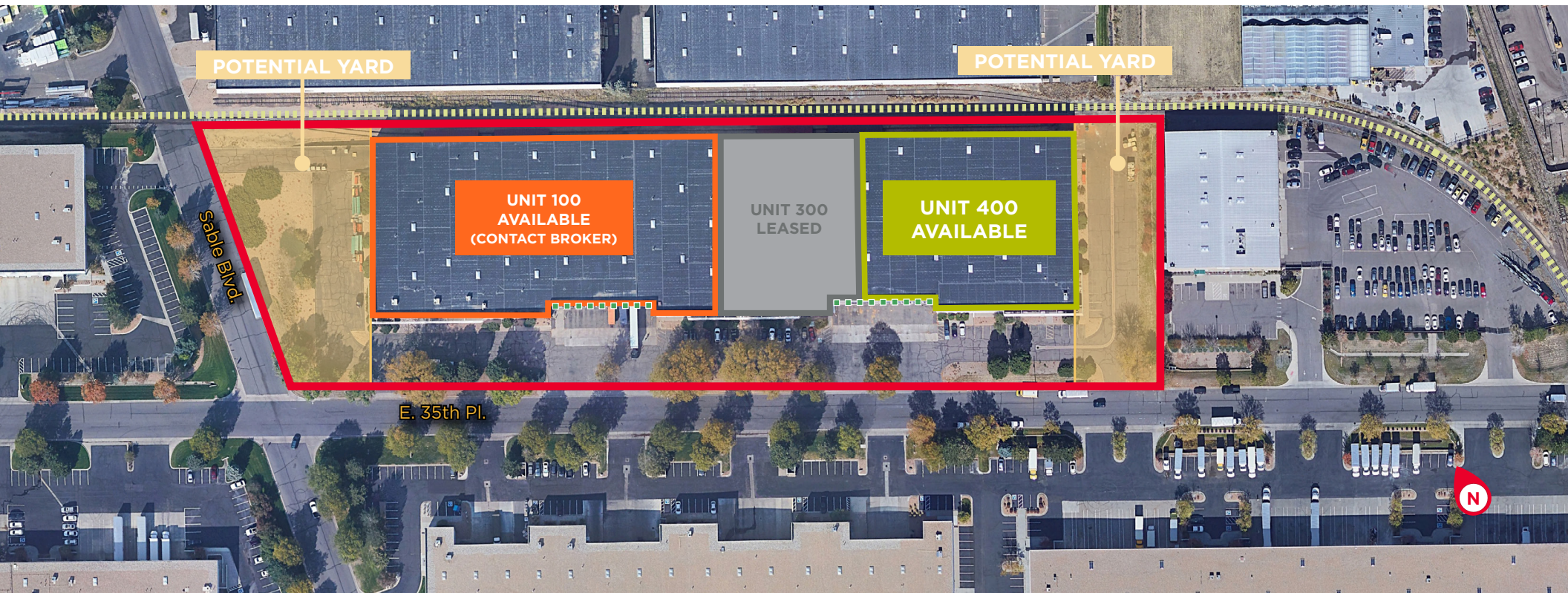



**SUBJECT
PROPERTY**



FOR MORE INFORMATION, CONTACT:

JOE KRAHN

Director

+1 303 312 4231

joe.krahn@cushwake.com

1401 Lawrence Street, Suite 1100

Denver, Colorado 80202

+1 303 292 3700

cushmanwakefield.com

©2025 Cushman & Wakefield. All rights reserved. The information contained in this communication is strictly confidential. This information has been obtained from sources believed to be reliable but has not been verified. NO WARRANTY OR REPRESENTATION, EXPRESS OR IMPLIED, IS MADE AS TO THE CONDITION OF THE PROPERTY (OR PROPERTIES) REFERENCED HEREIN OR AS TO THE ACCURACY OR COMPLETENESS OF THE INFORMATION CONTAINED HEREIN, AND SAME IS SUBMITTED SUBJECT TO ERRORS, OMISSIONS, CHANGE OF PRICE, RENTAL OR OTHER CONDITIONS, WITHDRAWAL WITHOUT NOTICE, AND TO ANY SPECIAL LISTING CONDITIONS IMPOSED BY THE PROPERTY OWNER(S). ANY PROJECTIONS, OPINIONS OR ESTIMATES ARE SUBJECT TO UNCERTAINTY AND DO NOT SIGNIFY CURRENT OR FUTURE PROPERTY PERFORMANCE.



30



Property owned by St. Paul Fire and Marine Insurance Company
a wholly owned subsidiary of the Travelers Companies, Inc.