

FOR SUBLEASE

TC ENERGY CENTER

700 LOUISIANA ST., HOUSTON, TX 77002



High-end build out, Class A Sublease Space
Floor 42: 8,130 RSF



PROPERTY HIGHLIGHTS

AVAILABLE	IMMEDIATELY
NET RATE	NEGOTIABLE
EST. 2025 OPEX	\$16.25/RSF + 3% MANAGEMENT FEE
FURNITURE	NEGOTIABLE
BALCONY	ACCESS AVAILABLE
SUBLEASE TERM	THROUGH NOVEMBER 30, 2027
PARKING	ALLEY THEATER GARAGE: UNRESERVED: \$100/SPACE/MONTH RESERVED: \$200/SPACE/MONTH
TI ALLOWANCE	AS-IS
FF&E	AVAILABLE
COMMISSION	4% ON PRIMARY SUBLEASE TERM

BUILDING AMENITIES

- CONFERENCE CENTER
- FITNESS CENTER
- COFFEE BAR
- LOCATED IN THE HEART OF THE THEATRE DISTRICT
- DIRECT ACCESS TO THE DOWNTOWN TUNNEL SYSTEM OFFERING SEVERAL RETAIL AND DINING AMENITIES



RECEPTION



ELEVATOR LOBBY EXPOSURE



OFFICE



WORKSTATIONS

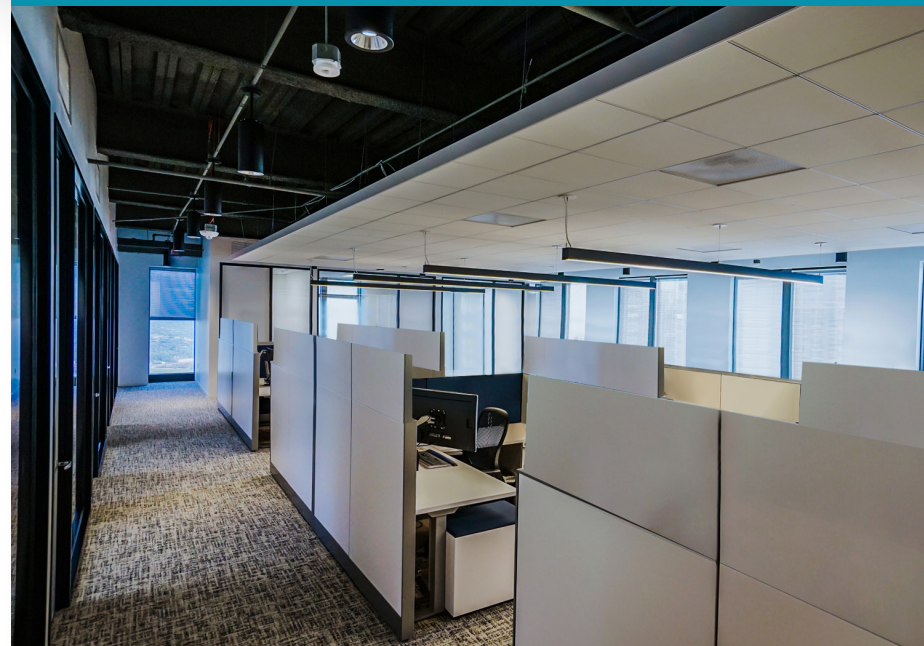

CONFERENCE ROOM



HUDDLE ROOM



KITCHEN/LOUNGE AREA



LOUNGE AREA



FLOOR 42: 8,130 RSF

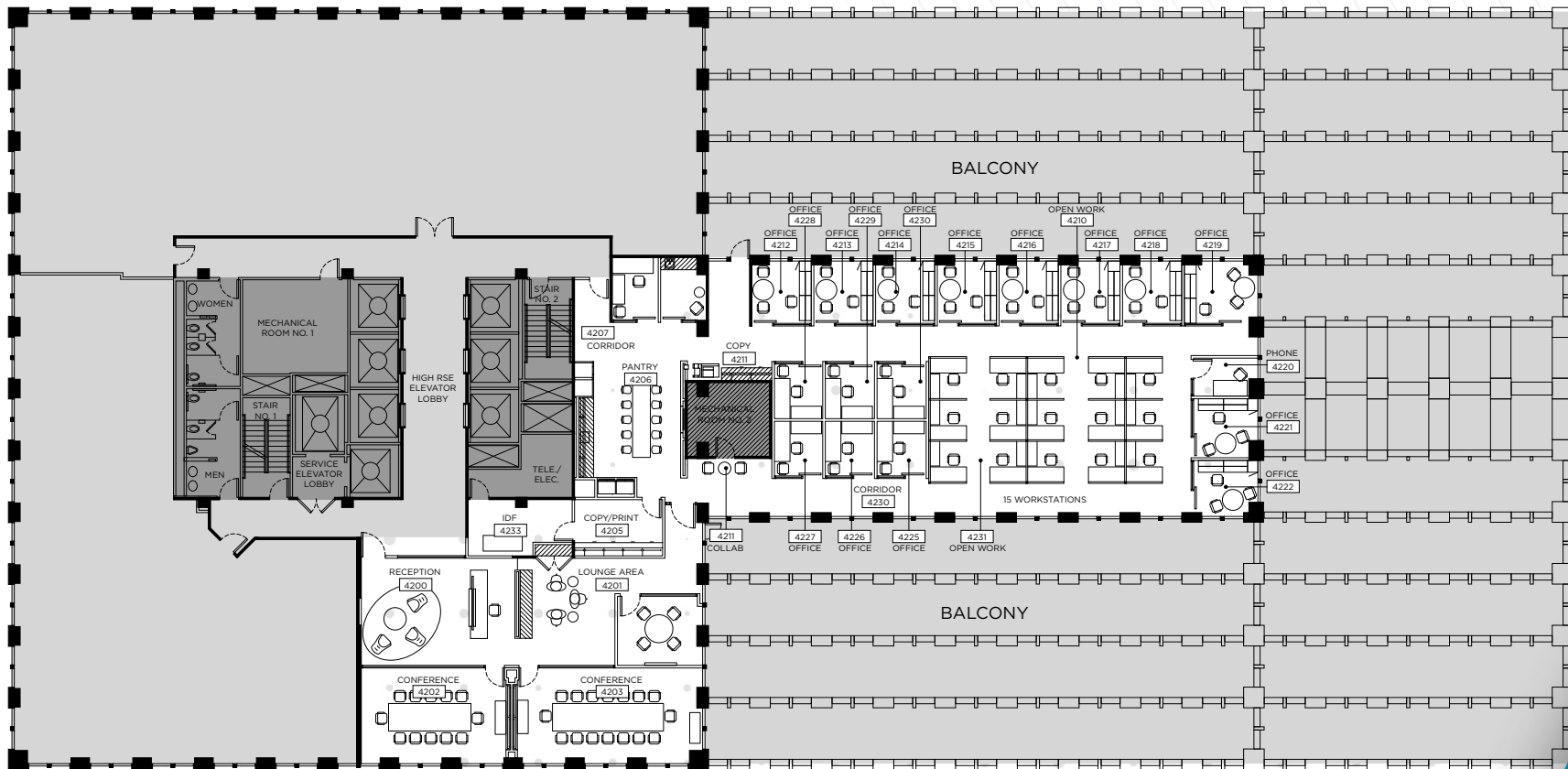

CONFIGURATION

- 18 Private offices
- 15 Workstations
- 2 Conference rooms
- 1 Huddle room
- 2 copy/print areas
- Wellness room
- Coffee Bar/loung area
- Large Kitchen/break room
- Formal reception



For more information, please contact:

Morgan Colt
Executive Managing Director
+1 713 331 1787
morgan.relyea@cushwake.com

1330 Post Oak Blvd.
Houston, Texas 77056
+1 713 877 1700
cushmanwakefield.com

©2025 Cushman & Wakefield. All rights reserved. The information contained in this communication is strictly confidential. This information has been obtained from sources believed to be reliable but has not been verified. NO WARRANTY OR REPRESENTATION, EXPRESS OR IMPLIED, IS MADE AS TO THE CONDITION OF THE PROPERTY (OR PROPERTIES) REFERENCED HEREIN OR AS TO THE ACCURACY OR COMPLETENESS OF THE INFORMATION CONTAINED HEREIN, AND SAME IS SUBMITTED SUBJECT TO ERRORS, OMISSIONS, CHANGE OF PRICE, RENTAL OR OTHER CONDITIONS, WITHDRAWAL WITHOUT NOTICE, AND TO ANY SPECIAL LISTING CONDITIONS IMPOSED BY THE PROPERTY OWNER(S). ANY PROJECTIONS, OPINIONS OR ESTIMATES ARE SUBJECT TO UNCERTAINTY AND DO NOT SIGNIFY CURRENT OR FUTURE PROPERTY PERFORMANCE.

