

FOR SUBLEASE

**10828 NW AIRWORLD DRIVE
KANSAS CITY, MO**



10828 NW AIRWORLD DRIVE

16,689 SF

**FULLY FURNISHED OFFICE SUBLEASE AVAILABLE
AT 10828 NW AIRWORLD DRIVE.**

4600 Madison Avenue, Suite 800
Kansas City, MO 64112
Main +1 816 2210 2200
Fax +1 913 273 1398
cushmanwakefield.com



Rare opportunity for an immediate, move in ready solution for organizations seeking professional office space with minimal capital investment. Located in Kansas City's Northland submarket, the property provides convenient access to I 29, KCI Airport, and major business corridors.

Property Information

- Lease term expires **August 2, 2035**
- **16,689 SF** fully furnished second floor office space
- **Sublease rate: \$10.00 PSF full service gross**
- Immediate occupancy available
- Ample & Secure, gated parking

Office Features

- Private offices
- Conference rooms
- Open work areas
- Kitchenette
- Modern, functional layout
- Turn key occupancy with existing furnishings

Location Highlights

- Easy access to **I-29**
- Close proximity to **Kansas City International Airport**
- Strong surrounding labor pool
- Nearby dining, hotels, and business services
- Located within a professionally maintained office park

Ideal Uses

- Non profits and community organizations
- Administrative or back office operations
- Professional services users
- Cost conscious office users seeking furnished space

FOR SUBLEASE
10828 NW Airworld Drive | Kansas City, MO



Floor Plans

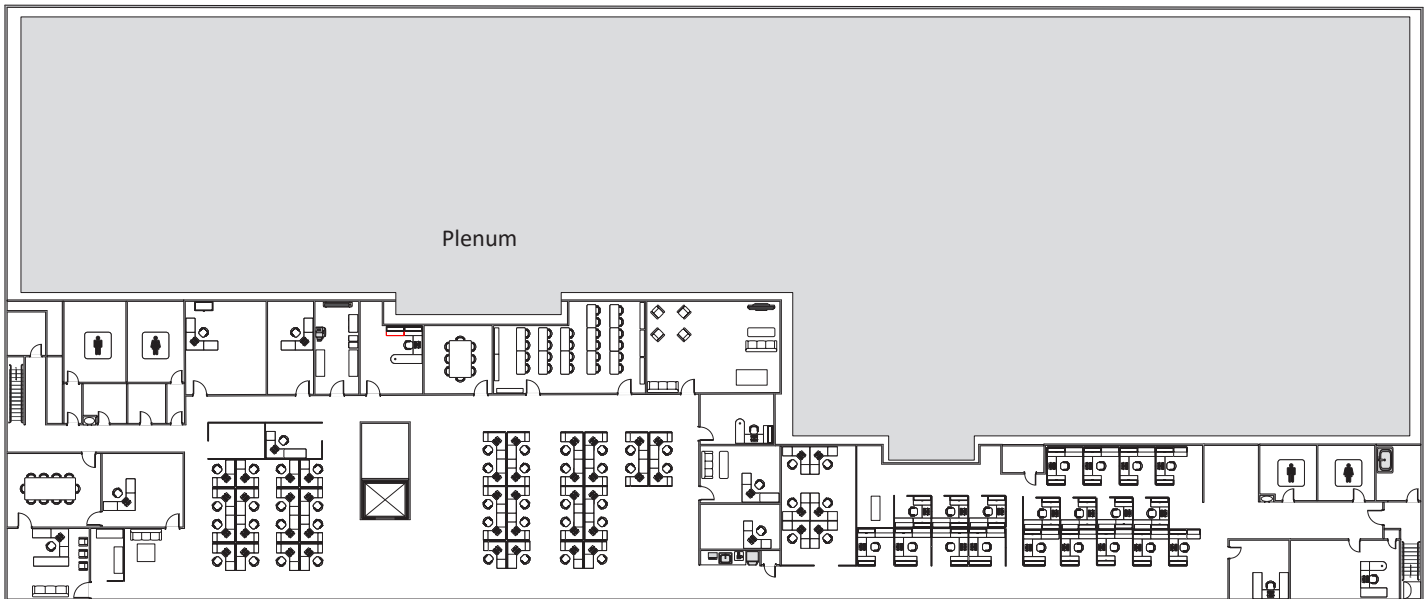
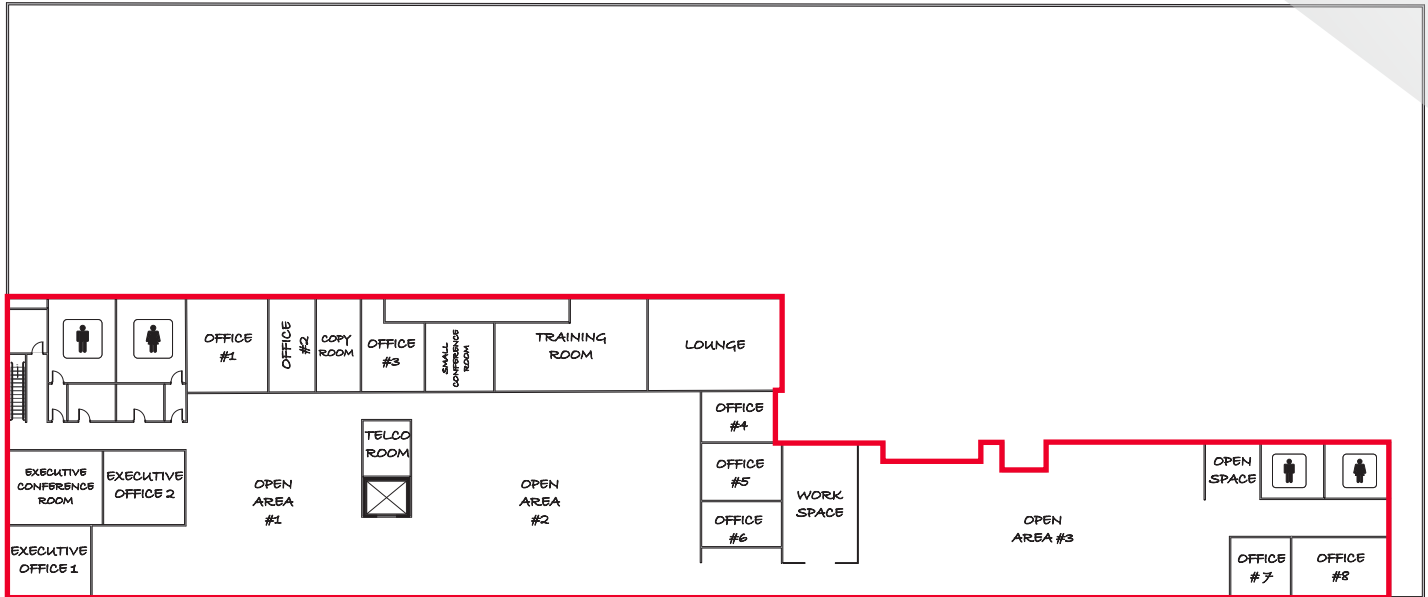

Location Aerial



For more information, please contact:

MARTY GILCHRIST, CCIM
Senior Associate
Direct: +1 816 216 5655
Mobile: +1 316 393 0703
Fax: +1 816 842 2798
marty.gilchrist@cushwake.com

4600 Madison Avenue, Suite 800
Kansas City, MO 64112
Main +1 816 221 2200
Fax +1 913 273 1398

cushmanwakefield.com