



HIGH-VISIBILITY RETAIL UNITS FOR LEASE

626, 646, 654 SEYMOUR STREET

VANCOUVER, BC



**CUSHMAN &
WAKEFIELD**

626, 646, 654, SEYMOUR STREET

Vancouver, BC



Cushman & Wakefield is pleased to offer three prime retail units for lease at 654, 646, and 626 Seymour Street. These highly visible spaces are located in a high-traffic area with excellent frontage along Seymour Street and ample street and parking lot options.

Positioned in the heart of downtown Vancouver, these properties are just steps from major SkyTrain stations and bus stops, Pacific Centre shopping mall, top-tier hotels, and entertainment. This central location offers exceptional exposure and convenience, making it ideal for businesses looking to expand or maximize their retail potential.

PROPERTY DETAILS

626 SEYMOUR	2,635 SF
646 SEYMOUR	2,000 SF
654 SEYMOUR	2,058 SF
LEASE RATE	Contact Listing Agent
AVAILABLE	Immediately

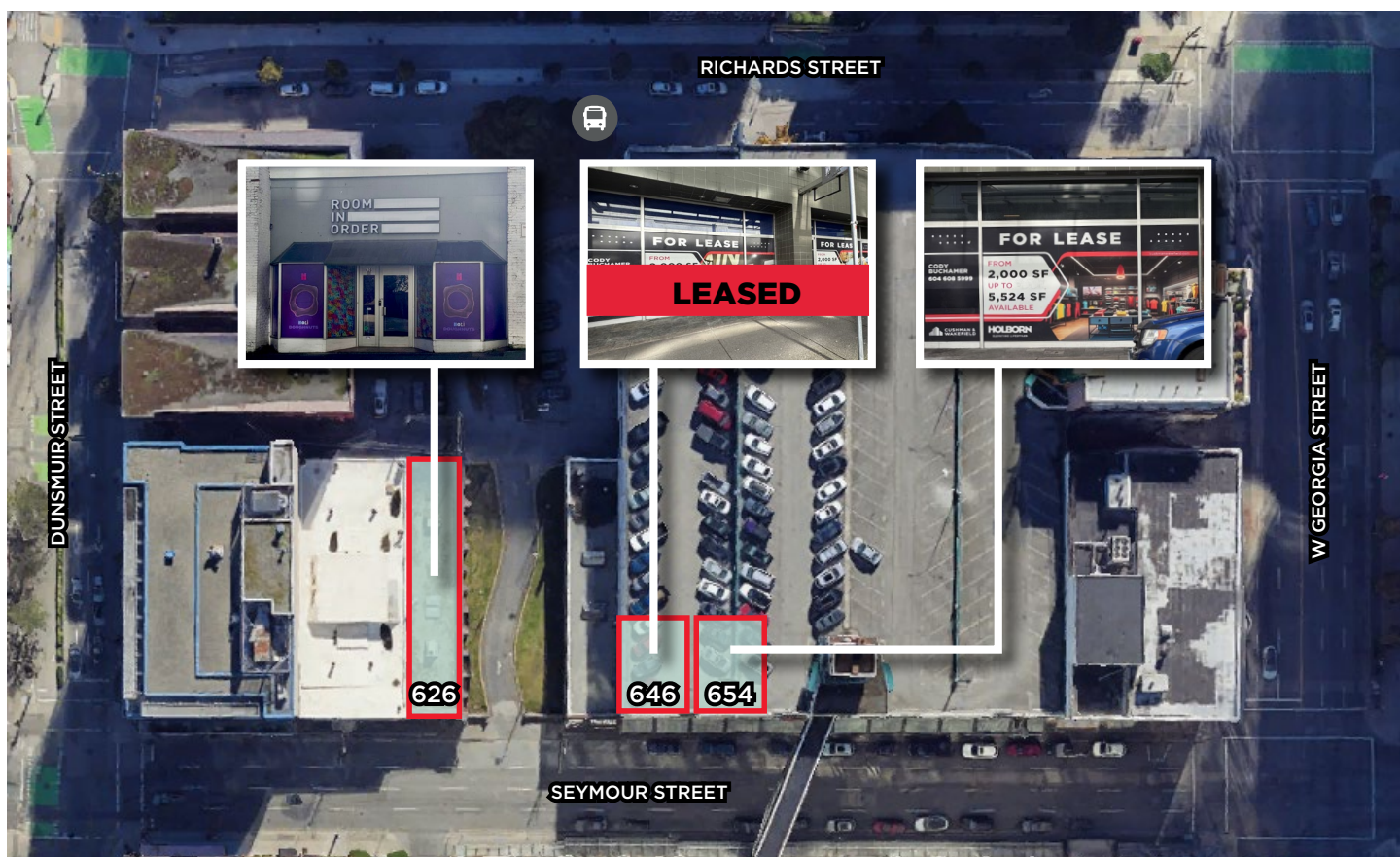

626, 646, 654, SEYMOUR STREET Vancouver, BC

654 FLOOR PLAN

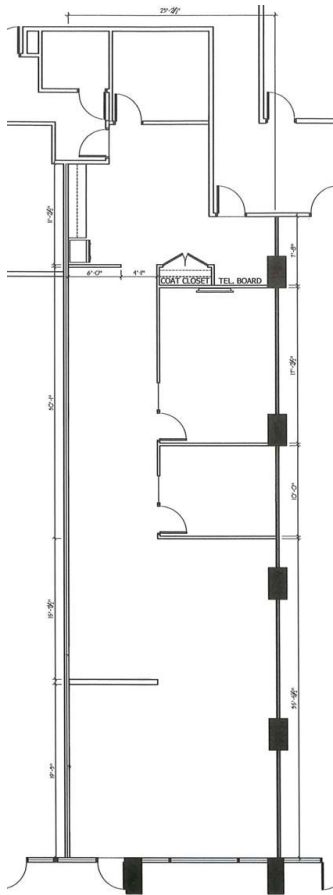

626 SEYMOUR STREET

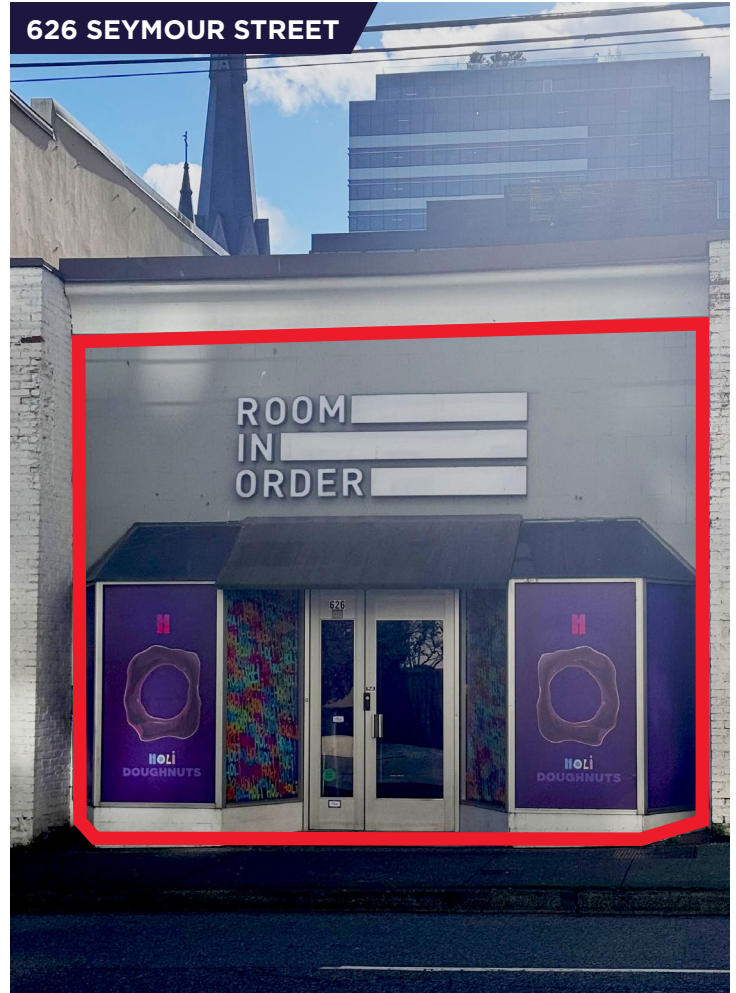

646 SEYMOUR STREET



654 SEYMOUR STREET

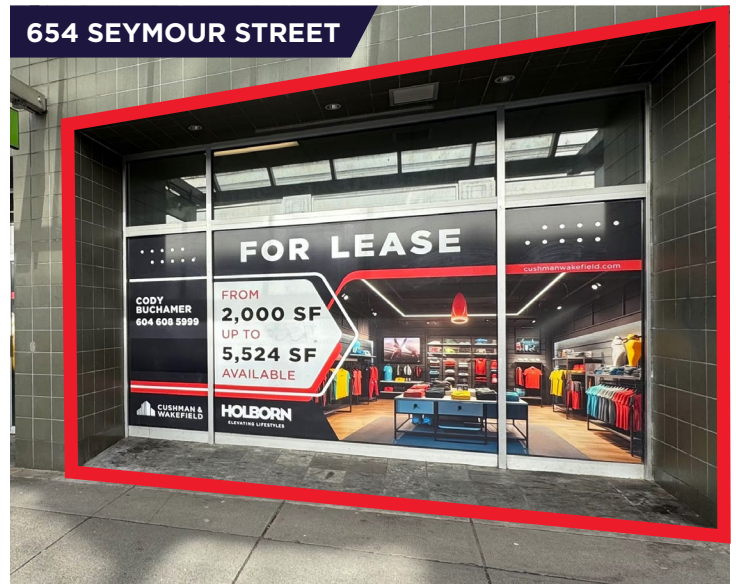

626, 646, 654, SEYMOUR STREET

Vancouver, BC

AMENITIES MAP

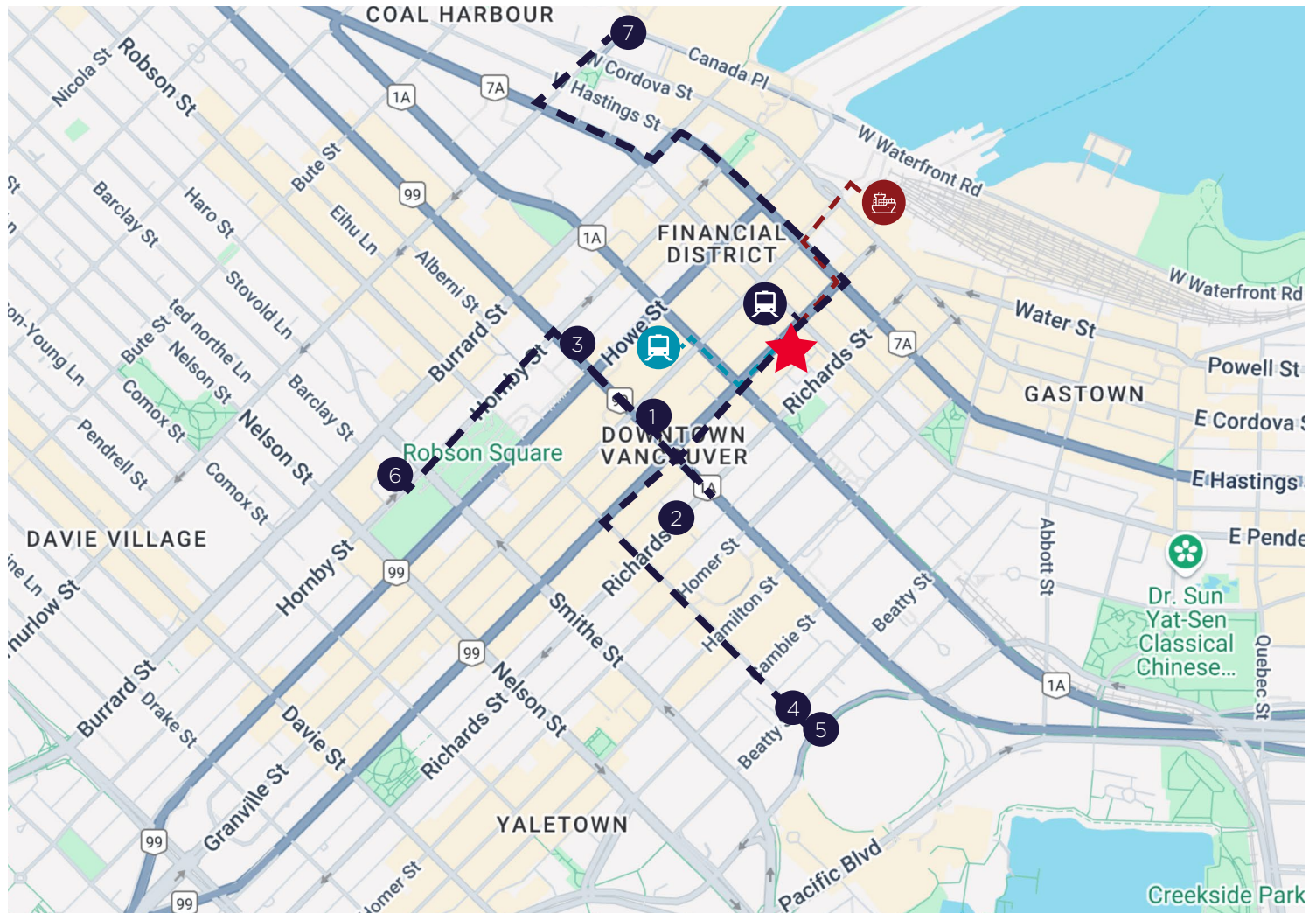

WALK TIME

- | | |
|------------------------|------------|
| 1. Pacific Centre | 3 minutes |
| 2. Café Medina | 4 minutes |
| 3. Hotel Georgia | 5 minutes |
| 4. Robson Street | 10 minutes |
| 5. BC Place | 11 minutes |
| 6. Earls Kitchen & Bar | 11 minutes |
| 7. Cactus Club | 15 minutes |



Granville SkyTrain

1 minute



City Centre SkyTrain

4 minutes



Waterfront Station

10 minutes



PLEASE CONTACT LISTING AGENT FOR MORE INFORMATION:

CODY BUCHAMER

Personal Real Estate Corporation
Associate Vice President
+1 604 608 5999
cody.buchamer@cushwake.com

700 West Georgia Street, Suite 1200
Pacific Centre, Vancouver, V7Y 1A1
+1 604 683 3111
cushmanwakefield.ca

©2025 Cushman & Wakefield. All rights reserved. The information contained in this communication is strictly confidential. This information has been obtained from sources believed to be reliable but has not been verified. NO WARRANTY OR REPRESENTATION, EXPRESS OR IMPLIED, IS MADE AS TO THE CONDITION OF THE PROPERTY (OR PROPERTIES) REFERENCED HEREIN OR AS TO THE ACCURACY OR COMPLETENESS OF THE INFORMATION CONTAINED HEREIN, AND SAME IS SUBMITTED SUBJECT TO ERRORS, OMISSIONS, CHANGE OF PRICE, RENTAL OR OTHER CONDITIONS, WITHDRAWAL WITHOUT NOTICE, AND TO ANY SPECIAL LISTING CONDITIONS IMPOSED BY THE PROPERTY OWNER(S). ANY PROJECTIONS, OPINIONS OR ESTIMATES ARE SUBJECT TO UNCERTAINTY AND DO NOT SIGNIFY CURRENT OR FUTURE PROPERTY PERFORMANCE.