

FOR SUBLEASE **OLYMPIC INDUSTRIAL 2**

2990 Olympic Industrial | Atlanta, GA 30339

PROPERTY FEATURES



Listing Type:	Sublease
Building RBA:	128,056
Sublease SF:	22,940
Sublease Term Thru:	2/28/2027
Configuration:	Front Load
Docks / Drive-Ins:	4 / 1
Clear Height:	19'
Column Spacing:	36' x 30'
Rail:	Yes
Parking:	9 Auto Spaces



LOCATION MAP

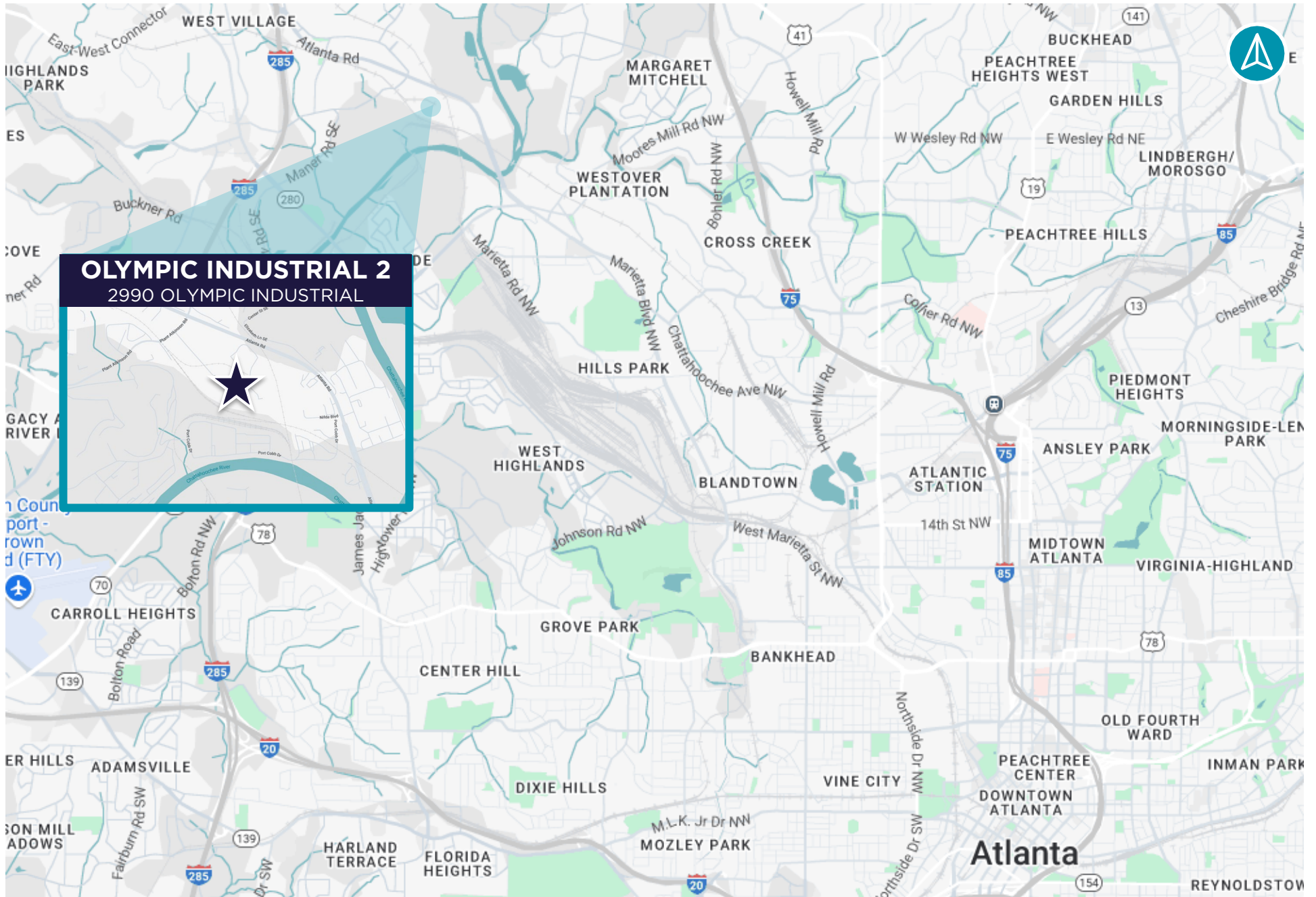

FLOORPLAN

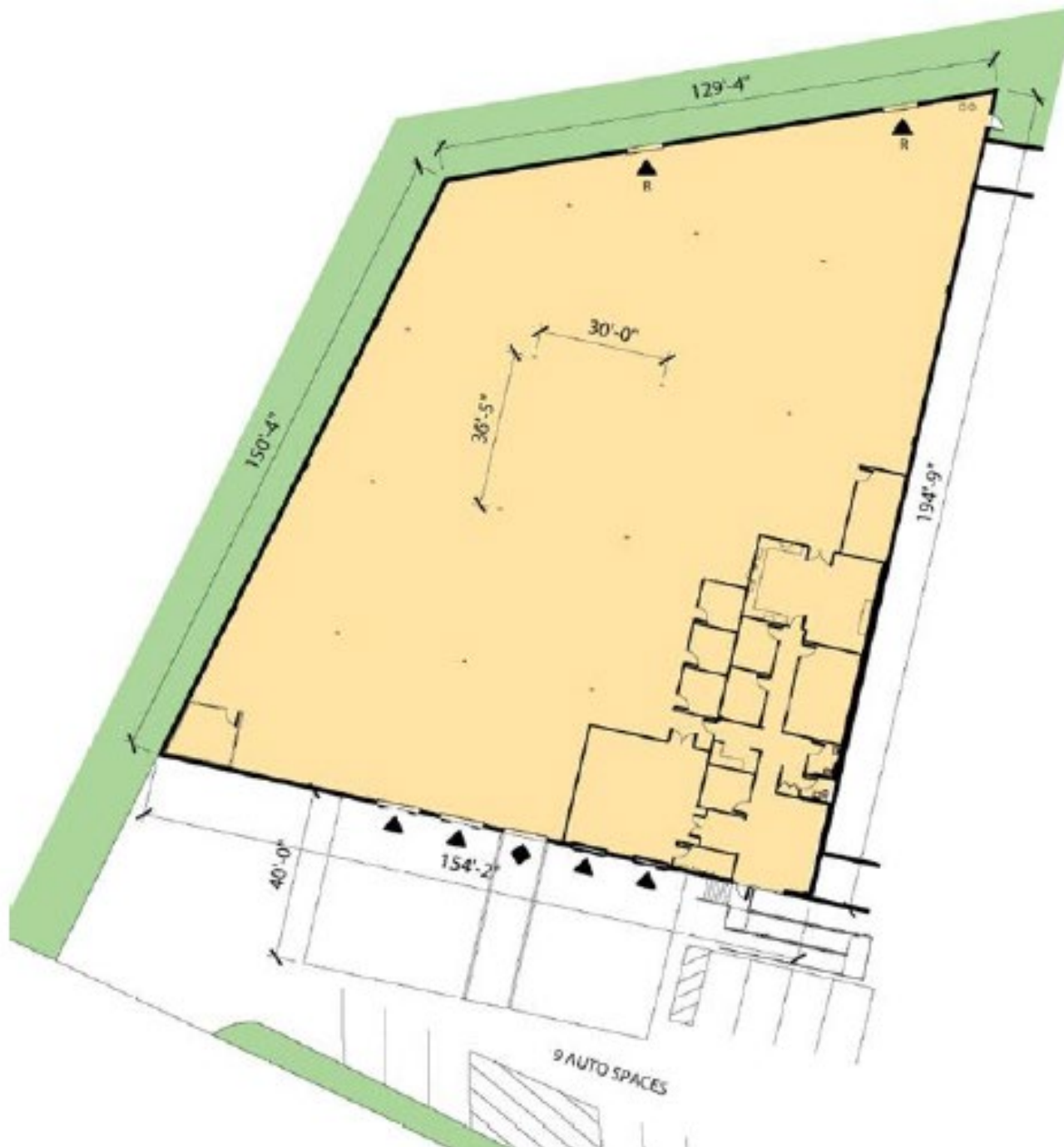

LEGEND:

- ▲ DOCK DOOR
- ▲ L DOCK DOOR W/LEVELER
- ◆ DRIVE-IN DOOR
- ▲ G ON-GRADE DOOR
- ▲ R RAIL DOOR
- LAND
- LEASED AREA
- VACANT AREA







CONTACT

Lisa B. Pittman, SIOR
Executive Director
+1 404 309 5309
lisa.pittman@cushwake.com

Palmer Clark
Senior Associate
+1 706 817 2357
palmer.clark@cushwake.com

