



FOR LEASE

950
LAKE
DRIVE
EAST

Chanhassen, MN 55317





PROPERTY HIGHLIGHTS

- Owned by Nicola Wealth
- Heavy power available
- Easy access to Hwy 5, Hwy 212, and Hwy 41
- Climate controlled warehouse and production area
- Many area amenities nearby

LAKE DRIVE : FEATURES

ADDRESS	950 Lake Dr. E, Chanhassen
BUILDING TOTAL SF	192,171 SF Total
CLEAR HEIGHT	24' - 26'
YEAR BUILT	1988/2001
LEASE RATES	Negotiable
2025 ESTIMATED TAX & CAM	\$1.29 PSF Tax \$1.78 PSF CAM \$3.07 PSF Total
POWER	3,500A/480V 3P Heavy
COLUMN	30' x 40'

VACANCIES

SUITE	950
AVAILABILITY	36,332 SF Office 3,589 SF 2nd Level Office <u>152,250 SF Warehouse</u> 192,171 SF Total

SUITE 950

36,332 SF OFFICE

152,250 SF WAREHOUSE

3,589 SF 2ND LEVEL OFFICE

192,171 SF TOTAL

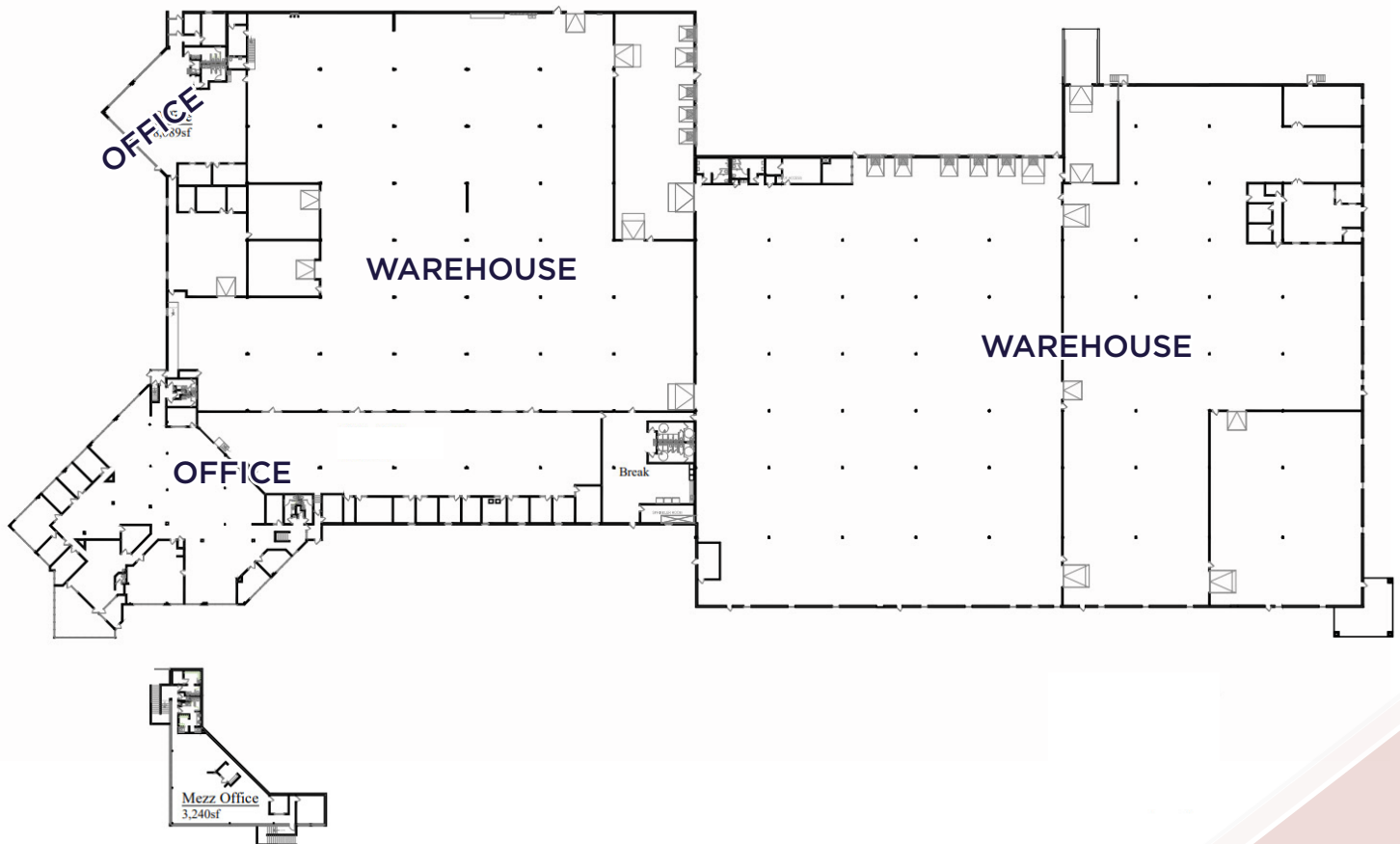

[illegible]

PHOTOS





FOR MORE INFORMATION, PLEASE CONTACT:

KRIS SMELTZER

Executive Managing Director
+1 952 837 8575
kris.smeltzer@cushwake.com

HUDSON BROTHEN

Executive Director
+1 952 893 8261
HUDSON.BROTHEN@cushwake.com

CUSHMAN & WAKEFIELD

3500 American Boulevard W, Suite 200
Minneapolis, MN 55431
cushmanwakefield.com



©2024 Cushman & Wakefield. All rights reserved. The information contained in this communication is strictly confidential. This information has been obtained from sources believed to be reliable but has not been verified. NO WARRANTY OR REPRESENTATION, EXPRESS OR IMPLIED, IS MADE AS TO THE CONDITION OF THE PROPERTY (OR PROPERTIES) REFERENCED HEREIN OR AS TO THE ACCURACY OR COMPLETENESS OF THE INFORMATION CONTAINED HEREIN, AND SAME IS SUBMITTED SUBJECT TO ERRORS, OMISSIONS, CHANGE OF PRICE, RENTAL OR OTHER CONDITIONS, WITHDRAWAL WITHOUT NOTICE, AND TO ANY SPECIAL LISTING CONDITIONS IMPOSED BY THE PROPERTY OWNER(S). ANY PROJECTIONS, OPINIONS OR ESTIMATES ARE SUBJECT TO UNCERTAINTY AND DO NOT SIGNIFY CURRENT OR FUTURE PROPERTY PERFORMANCE.