

FOR SUBLEASE 25,409 SF

1065 NATIONAL DR

SACRAMENTO, CA



CUSHMAN &
WAKEFIELD

PROPERTY HIGHLIGHTS

Building Size:	77,663 SF
Space Available:	25,409 SF
Office Area:	2,000 SF with Restroom
Site Area:	4 AC
Clear Height:	±17-20'
Loading Doors:	2 DH / 1 GL
Electrical:	110/208 Volt
Zoning:	M1 Light Industrial Zoning
Parking:	2 : 1,000
Lease Rate:	\$0.60 psf NNN
Current Tenant:	Rise Against Hunger International Non-Profit Organization



FLOOR PLAN

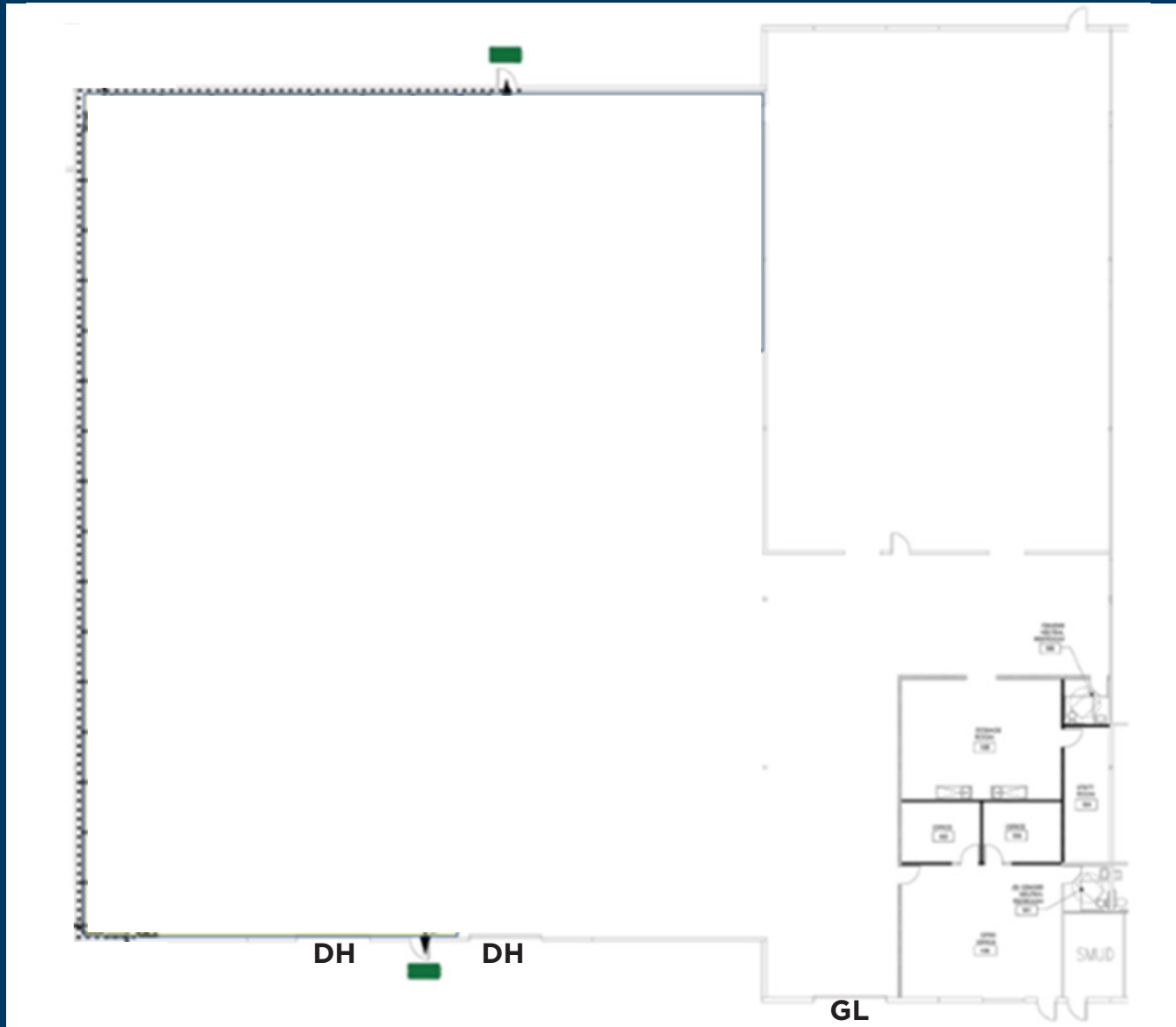



CONTACT

LENNY GOLD

Director

+1 916 288 4443

lenny.gold@cushwake.com



**CUSHMAN &
WAKEFIELD**