



FOR LEASE | 5,840 SF

POST OAK BUSINESS CENTER

1231-A NORTH POST OAK, HOUSTON, TX 77055



CUSHMAN &
WAKEFIELD

POST OAK BUSINESS CENTER

1231-A NORTH POST OAK, HOUSTON, TX 77055

| | | | |
|-----------------------|----------|-----------------|---|
| TOTAL AVAILABLE AREA: | 5,840 SF | DRIVE-IN DOORS: | 1 |
| OFFICE AREA: | 949 SF | DOCK DOORS: | 1 |
| WAREHOUSE AREA: | 4,891 SF | | |
| CLEAR HEIGHT: | 18' | | |



POST OAK BUSINESS CENTER

1231-A NORTH POST OAK, HOUSTON, TX 77055

SITE PLAN

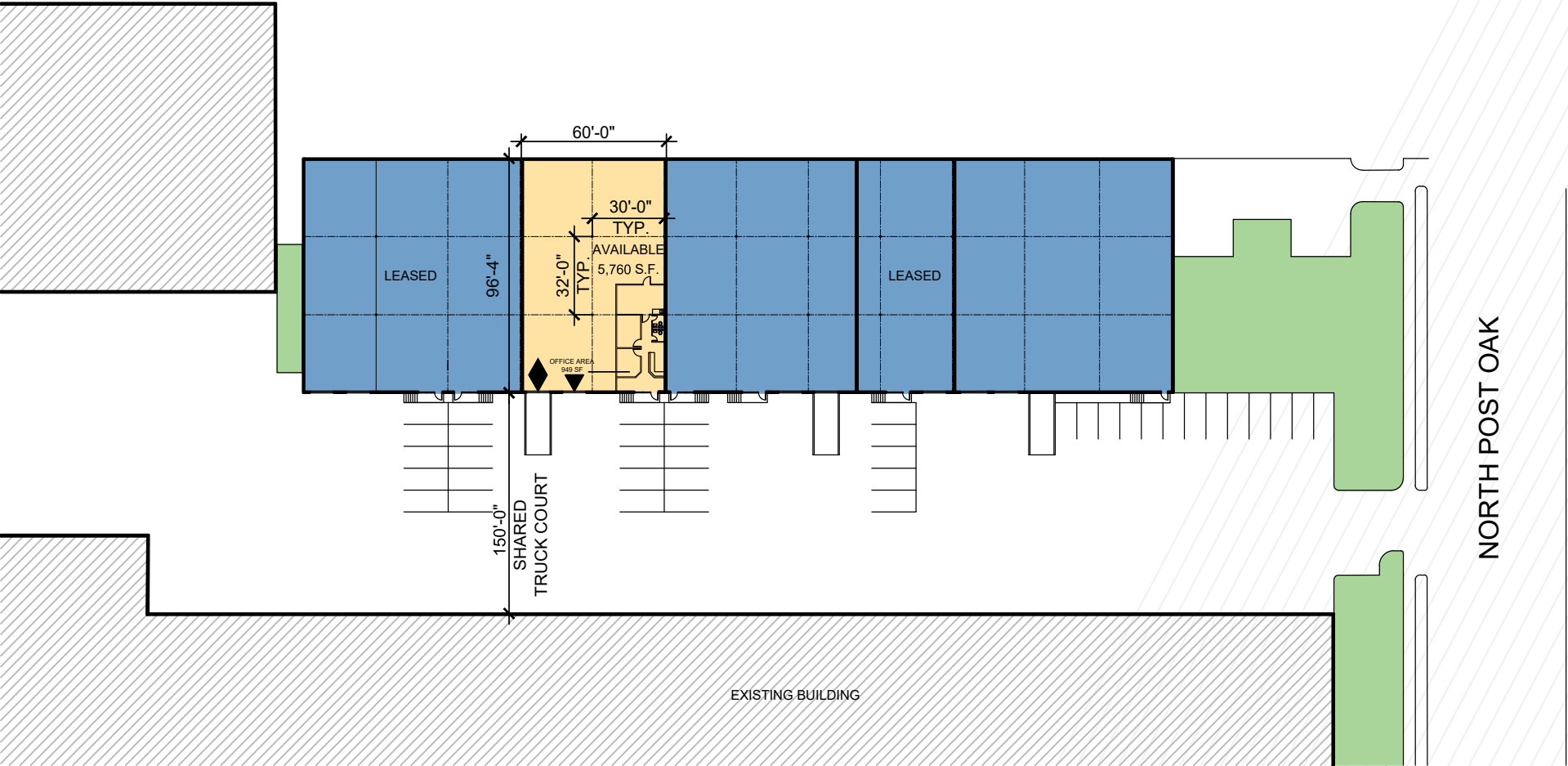

- LEASED AREA
- AVAILABLE AREA
- DOCK POSITION
- DRIVE-IN DOOR

POST OAK BUSINESS CENTER

1231-A NORTH POST OAK, HOUSTON, TX 77055

OFFICE AND WAREHOUSE PLAN 5,840 SF

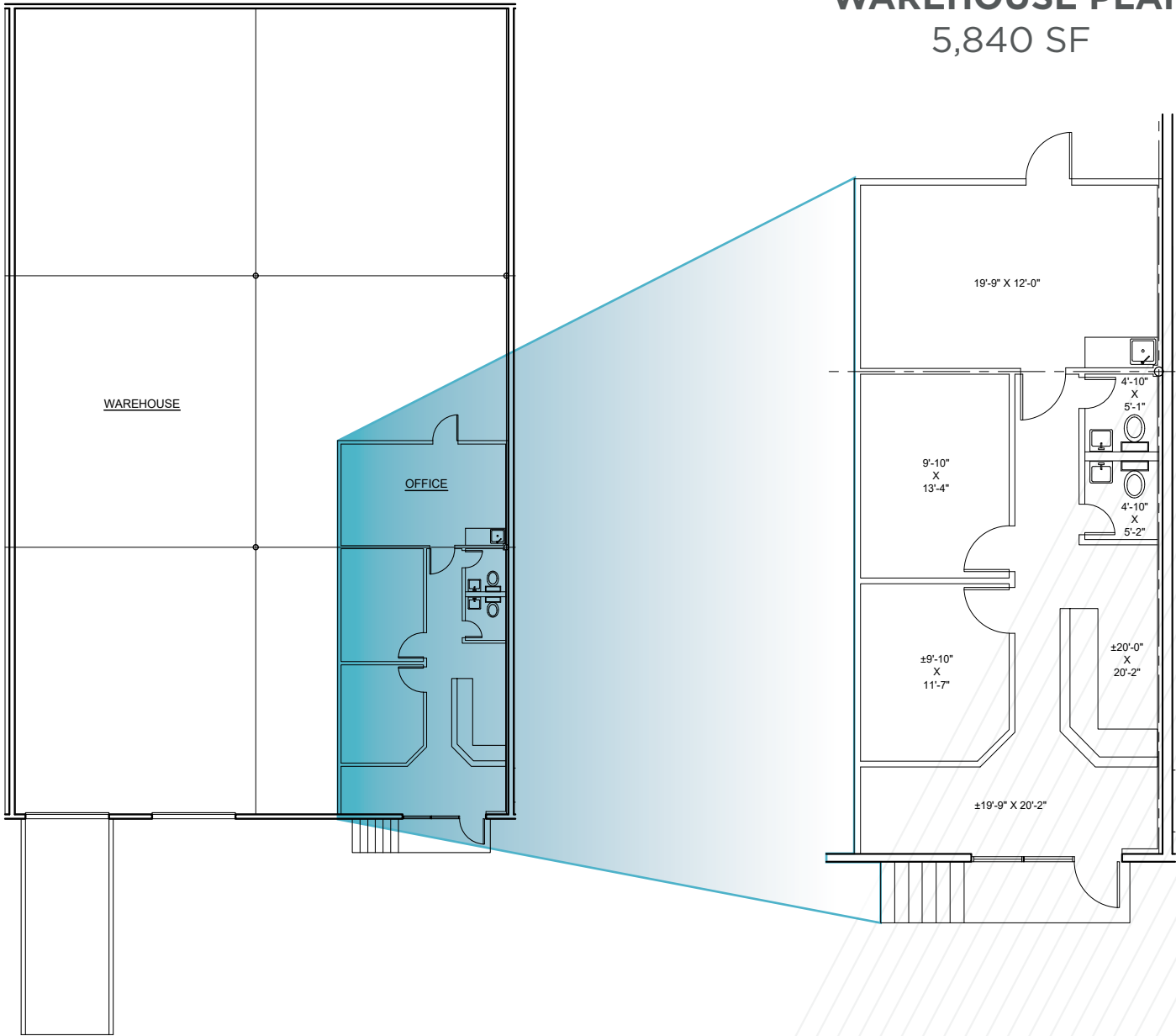

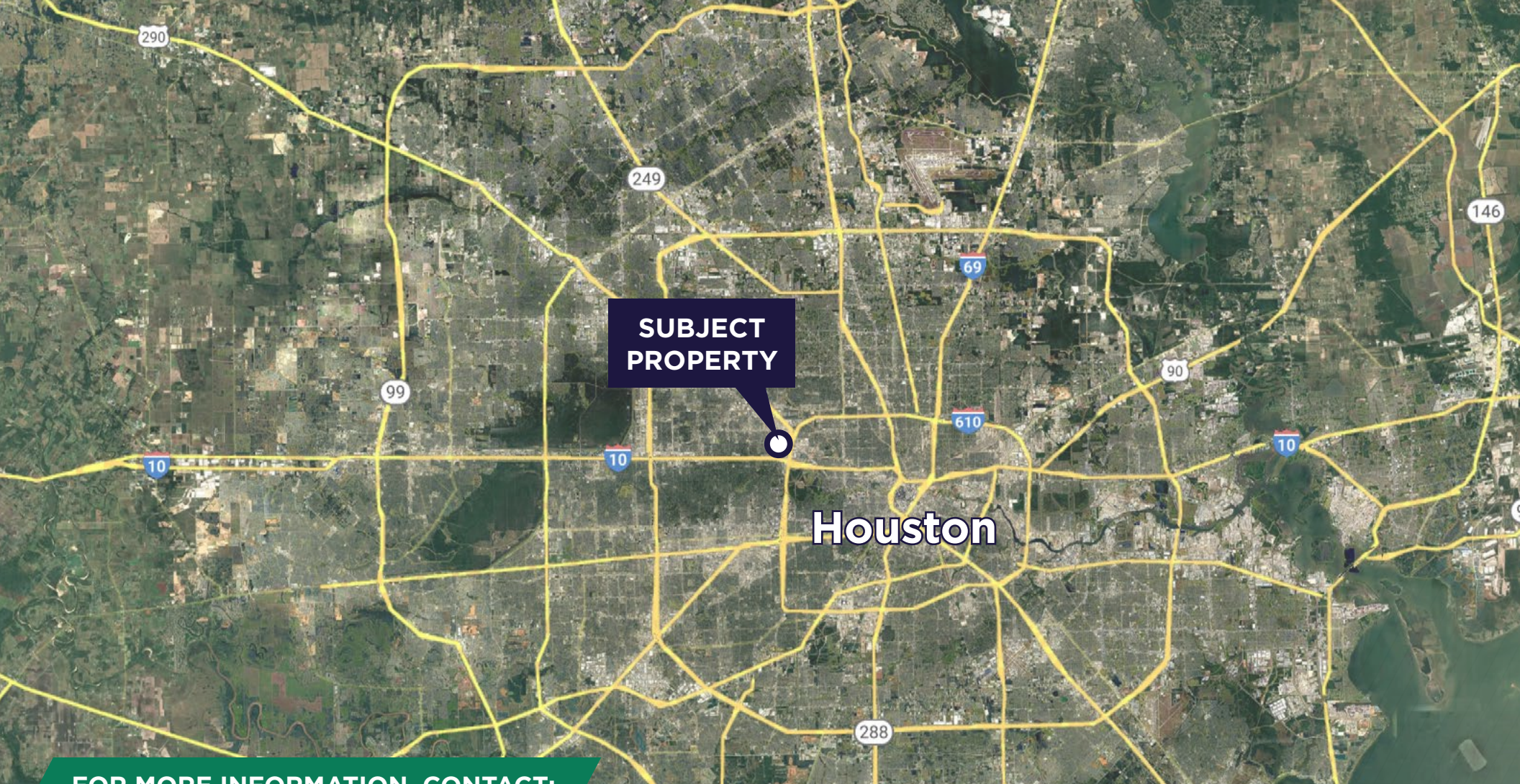

**SUBJECT
PROPERTY**

Houston

FOR MORE INFORMATION, CONTACT:

STEPHEN THOMAS SCHNEIDAU
Associate
+1 713 260 0219
stephentomas.schneidau@cushwake.com

STEPHEN SCHNEIDAU
Vice Chair
+1 713 963 2822
stephen.schneidau@cushwake.com

©2025 Cushman & Wakefield. All rights reserved. The information contained in this communication is strictly confidential. This information has been obtained from sources believed to be reliable but has not been verified. NO WARRANTY OR REPRESENTATION, EXPRESS OR IMPLIED, IS MADE AS TO THE CONDITION OF THE PROPERTY (OR PROPERTIES) REFERENCED HEREIN OR AS TO THE ACCURACY OR COMPLETENESS OF THE INFORMATION CONTAINED HEREIN, AND SAME IS SUBMITTED SUBJECT TO ERRORS, OMISSIONS, CHANGE OF PRICE, RENTAL OR OTHER CONDITIONS, WITHDRAWAL WITHOUT NOTICE, AND TO ANY SPECIAL LISTING CONDITIONS IMPOSED BY THE PROPERTY OWNER(S). ANY PROJECTIONS, OPINIONS OR ESTIMATES ARE SUBJECT TO UNCERTAINTY AND DO NOT SIGNIFY CURRENT OR FUTURE PROPERTY PERFORMANCE.





**SUBJECT
PROPERTY**

The image is an aerial photograph of a commercial district. A dark purple callout box with a white 'G' icon points to a specific property. The property is situated between W 12th Street to the north and Awty School Lane to the south. To the east of the property is Post Oak Road, and further east is W Loop N Freeway. To the west of the property is a residential area with a large sports field. The map is overlaid with green lines and text labels for the streets.

W 12TH STREET

U.S. 290 HOV

610

W LOOP N FREEWAY

POST OAK ROAD

AWTY SCHOOL LANE

FOR MORE INFORMATION, CONTACT:

STEPHEN SCHNEIDAU

Vice Chair

+1 713 963 2822

stephen.schneidau@cushwake.com

STEPHEN THOMAS SCHNEIDAU

Associate

+1 713 260 0219

stephentomas.schneidau@cushwake.com

©2025 Cushman & Wakefield. All rights reserved. The information contained in this communication is strictly confidential. This information has been obtained from sources believed to be reliable but has not been verified. NO WARRANTY OR REPRESENTATION, EXPRESS OR IMPLIED, IS MADE AS TO THE CONDITION OF THE PROPERTY (OR PROPERTIES) REFERENCED HEREIN OR AS TO THE ACCURACY OR COMPLETENESS OF THE INFORMATION CONTAINED HEREIN, AND SAME IS SUBMITTED SUBJECT TO ERRORS, OMISSIONS, CHANGE OF PRICE, RENTAL OR OTHER CONDITIONS, WITHDRAWAL WITHOUT NOTICE, AND TO ANY SPECIAL LISTING CONDITIONS IMPOSED BY THE PROPERTY OWNER(S). ANY PROJECTIONS, OPINIONS OR ESTIMATES ARE SUBJECT TO UNCERTAINTY AND DO NOT SIGNIFY CURRENT OR FUTURE PROPERTY PERFORMANCE.



**CUSHMAN &
WAKEFIELD**



PROLOGIS®

POST OAK

1231-A NORTH POST OAK, HOUSTON, TX 77055

TOTAL AVAILABLE AREA: 5,840 SF

OFFICE AREA: 949 SF

WAREHOUSE AREA: 4,891 SF

CLEAR HEIGHT: 18'

DOCK DOORS: 1

DRIVE-IN DOORS: 1

