

COMMERCIAL LAND AT JL. DR. IR. H. SOEKARNO SURABAYA, EAST JAVA

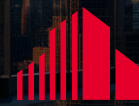

**CUSHMAN &
WAKEFIELD**

LOCATION MAP

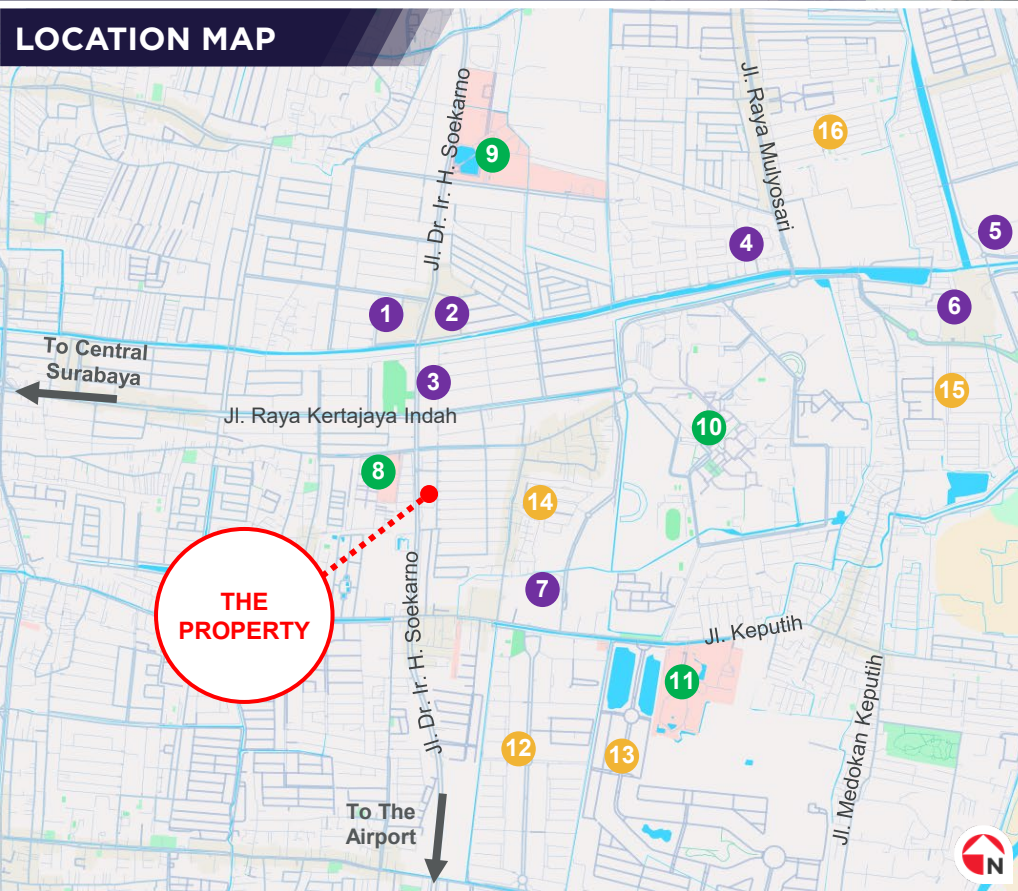

● COMMERCIAL / APARTMENT

1. Galaxy Residence
2. Galaxy Mall
3. Oakwood Hotel & Residence
4. Grand Dharmahusada Lagoon
5. Educuity Apartment
6. Pakuwon City Mall & Apartment
7. Puncak Kertajaya Apartment

● PUBLIC FACILITY

8. RSUD Haji
9. Airlangga University (UNAIR)
10. Sepuluh Nopember Institute of Technology (ITS)
11. Hang Tuah University

● LANDED RESIDENTIAL

12. Galaxy Bumi Permai
13. Puri Galaxy
14. Kertajaya Indah Regency
15. Laguna Regency
16. Kalisari Permai

PROPERTY DESCRIPTION

- The Property is strategically located on Jl. Dr. Ir. H. Soekarno, just 20 minutes drive from the central Surabaya and 25 minutes drive from Juanda International Airport.
- Situated within a well-established and vibrant area, surrounded by residential estates, offices, apartments, and leading educational institutions.
- Located ± 1.5 km to Galaxy Mall, ± 4.0 km to Pakuwon City Mall, ± 1.8 km to ITS and ± 3.0 km to UNAIR.
- Ideally suited for development as hospital, school, retail, or mixed-use establishment.

PROPERTY DETAILS

LAND AREA	• Lot A : 7,213 sm
	• Lot B : 8,280 sm
LAND TITLE	SHGB
TOWN PLANNING	Zoning : Commercial (K-6) Site Coverage : 60% Plot Ratio : 4.8
ASKING PRICE	IDR 35 million psm plus VAT
LOCATION	• Lot A : Google Maps
	• Lot B : Google Maps

LAND PLOT



For more information
please contact:



Mina Ondang
Director, Investment

+(62) 811 820 9500
Mina.Ondang@ap.cushwake.com

COMMERCIAL LAND AT JL. DR. IR. H. SOEKARNO SURABAYA, EAST JAVA

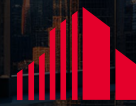

**CUSHMAN &
WAKEFIELD**

ATR/BPN - LOT A



**For more information
please contact:**



Mina Ondang
Director, Investment

+(62) 811 820 9500
Mina.Ondang@ap.cushwake.com

COMMERCIAL LAND AT JL. DR. IR. H. SOEKARNO SURABAYA, EAST JAVA

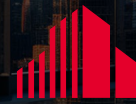

**CUSHMAN &
WAKEFIELD**

ATR/BPN - LOT B

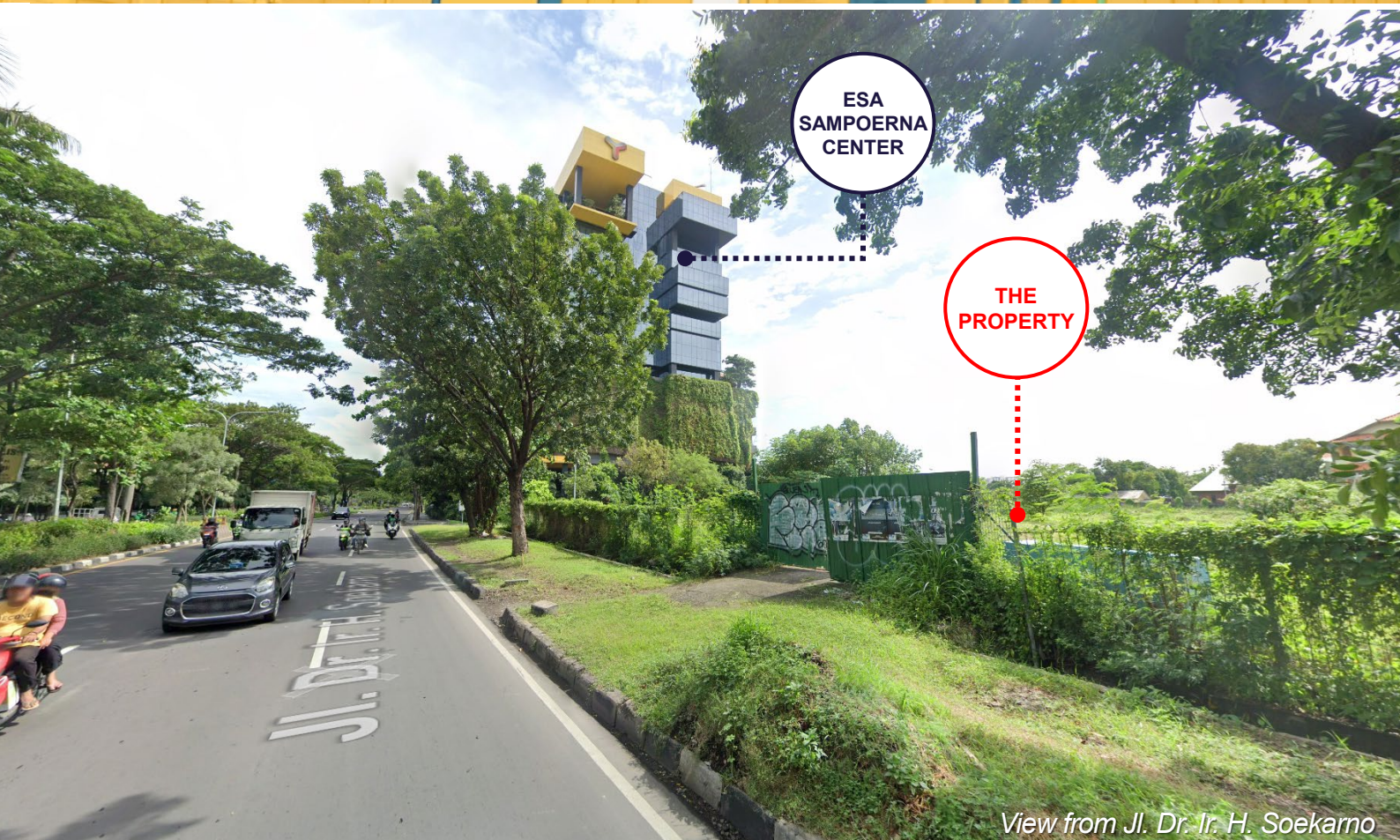
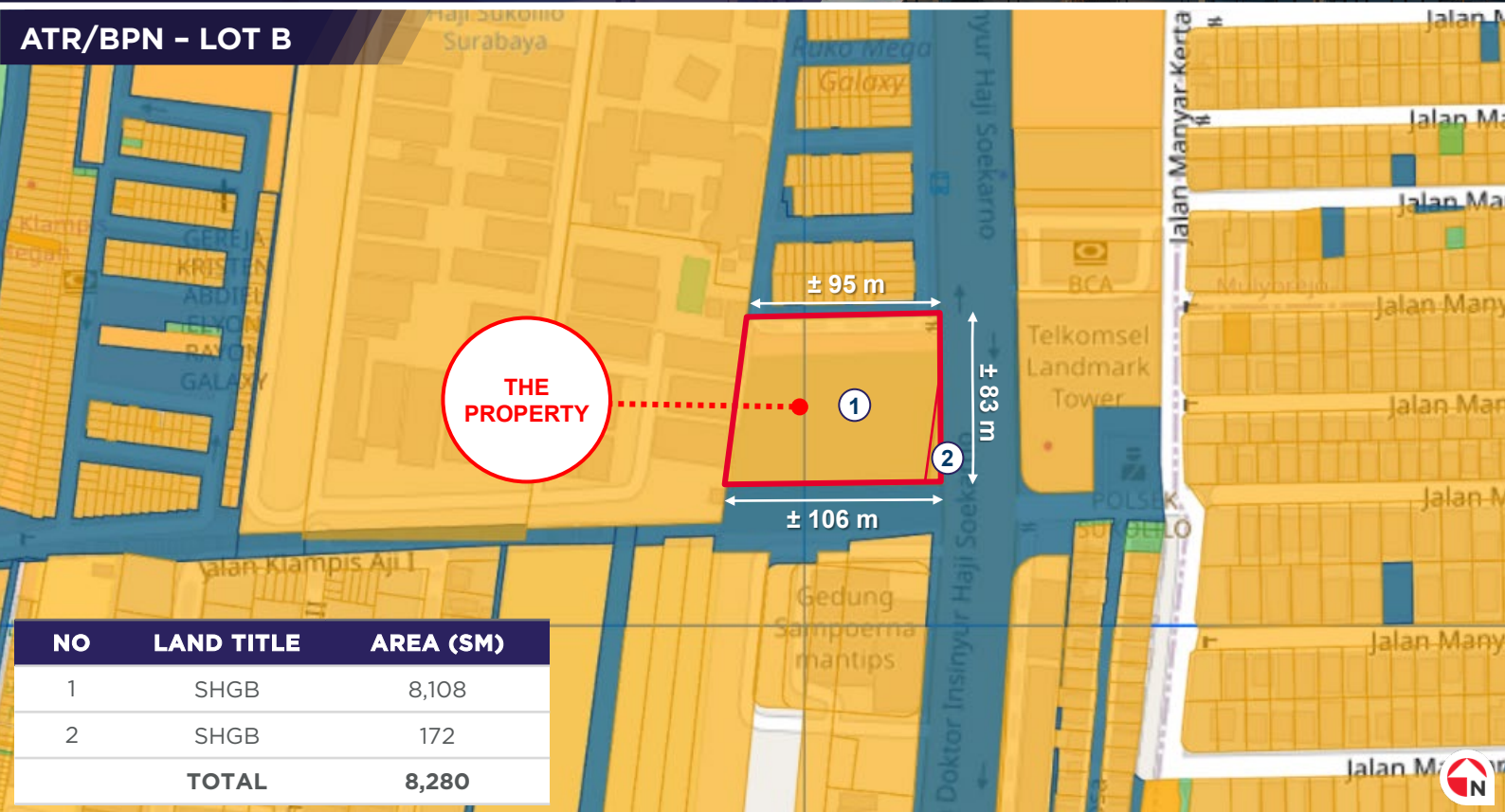

View from Jl. Dr. Ir. H. Soekarno

**For more information
please contact:**



Mina Ondang
Director, Investment

+(62) 811 820 9500
Mina.Ondang@ap.cushwake.com