

250

BRYANT STREET

26,078 SF FOR LEASE



250 BRYANT STREET, MOUNTAIN VIEW, CA



250
BRYANT STREET

PROPERTY HIGHLIGHTS



CLASS A 3-STORY OFFICE BUILDING LOCATED IN THE HEART OF DOWNTOWN MOUNTAIN VIEW



A PERFECT MIXTURE OF 10' DROP CEILING HEIGHT & ABUNDANT EXPOSED CEILING WITH $\pm 14.5'$ SLAB TO SLAB



3 BLOCKS TO CALTRAIN, LIGHT RAIL, AND MOUNTAIN VIEW TRANSIT CENTER



EASY ACCESS TO HIGHWAYS 85, 101, 237, 280



FORMER HOME TO WHATSAPP, FACEBOOK & TIKTOK



AVAILABLE IMMEDIATELY



WALKING DISTANCE TO OVER 100 RESTAURANTS BETWEEN EL CAMINO REAL AND CALTRAIN STATION

ON-SITE AMENITIES

With a host of modern, on-site amenities, 250 Bryant sets a new standard for workplace excellence as the premier Class A office building in downtown Mountain View.



PLUG & PLAY



BREAK ROOM



MODERN LOBBY



EXCLUSIVE, SECURE PARKING

250
BRYANT STREET

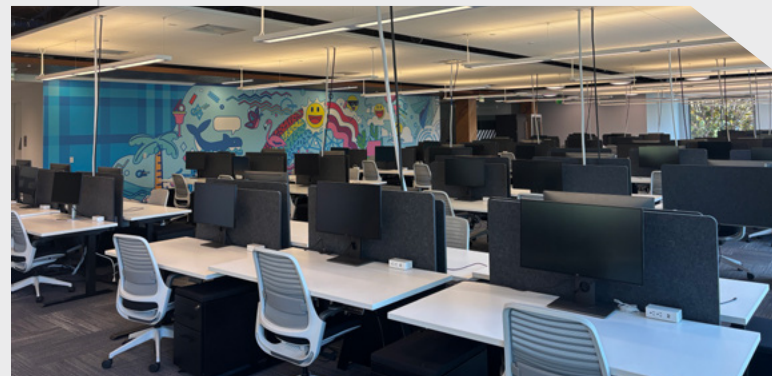

SECOND FLOOR FLOOR PLAN

250
BRYANT STREET

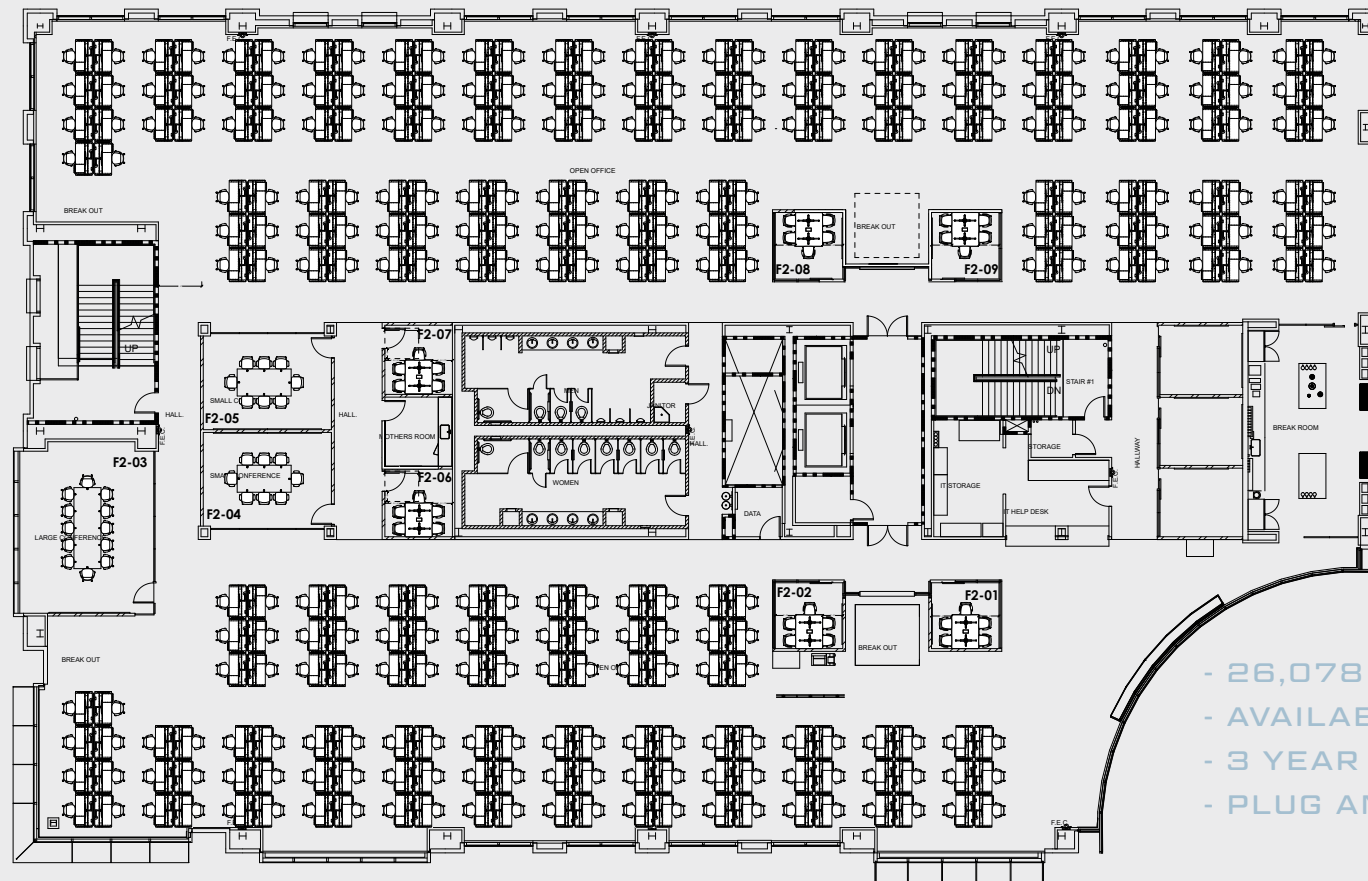

- 26,078 SF
- AVAILABLE IMMEDIATELY
- 3 YEAR LEASE PREFERRED
- PLUG AND PLAY

SECOND FLOOR

250
BRYANT STREET



AMENITY MAP

250

BRYANT STREET

101

85

237

82

82

MOUNTAIN
VIEW

HOTELS

1. Hotel Strata
2. Hotel Zico
3. Hampton Inn & Suites Mountain View
4. Hotel Vue

RESTAURANTS

1. Cascal
2. Sushi Tomi
3. Amici's
4. Oren's Hummus
5. Vaso Azzurro Ristorante
6. Maison Alyzee
7. Monte Carlo
8. Superhot Hotpot & Korean BBQ
9. Hummus Mediterranean Kitchen
10. Doppio Zero
11. Blue Line Pizza
12. Crepevine
13. Taqueria La Espuela
14. Eureka!
15. Steins Beer Garden & Restaurant
16. Limon
17. Ludwig's Biergarten
18. Pokeworks
19. Poke Bar
20. Udon Mugizo
21. Mantra



SUNNYVALE

TRANSIT MAP

SAN ANTONIO
CALTRAIN STATION

MOUNTAIN VIEW
CALTRAIN STATION
VTA STATION

250
BRYANT STREET

MOUNTAIN VIEW

7 MIN WALK
(0.5 MI)

SUNNYVALE
CALTRAIN STATION

LAWRENCE
CALTRAIN STATION

— VTA Light Rail

— Caltrain Route & Stops

Moffett Field

LOS ALTOS

SUNNYVALE



82

101

101

85

237

237

101

82

280

85

82

250

BRYANT STREET

26,078 SF FOR LEASE

250 BRYANT STREET, MOUNTAIN VIEW, CA

DAVID HIEBERT

Vice Chairman
+1 650 320 0250
david.hiebert@cushwake.com
LIC #01189320

DAN PERSYN

Executive Managing Director
+1 650 320 0255
dan.persyn@cushwake.com
Lic #01184798

SOFIA LUNDELL

Senior Associate
+1 650 320 0220
sofia.lundell@cushwake.com
License #02201946

525 University Ave, Suite 220
Palo Alto, California 94301
main +1 650 852 1200
fax +1 650 816 8560
cushmanwakefield.com



**CUSHMAN &
WAKEFIELD**

**SMITH
DEVELOPMENT**