

# 3030

## KUTZTOWN RD

### READING, PENNSYLVANIA

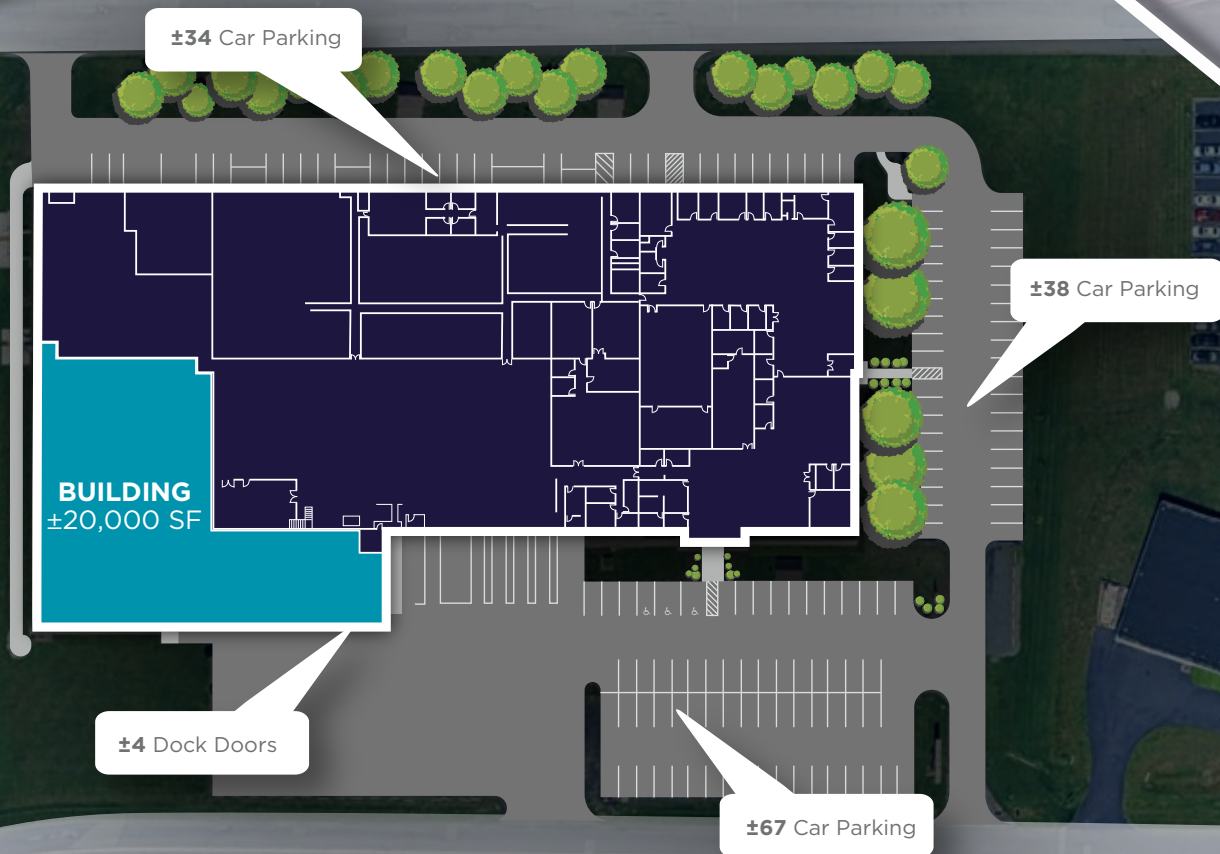

**±20,000 SF**  
AVAILABLE FOR LEASE



**Gerry Blinebury**  
Executive Vice Chair  
+1 717 231 7291  
gerry.blinebury@cushwake.com

**Hunter Kessell**  
Director  
+1 610 589 0639  
hunter.kessell@cushwake.com

**Collin Potter**  
Director  
+1 717 231 7460  
collin.potter@cushwake.com



Cushman & Wakefield Copyright 2025. No warranty or representation, express or implied, is made to the accuracy or completeness of the information contained herein, and same is submitted subject to errors, omissions, change of price, rental or other conditions, withdrawal without notice, and to any special listing conditions imposed by the property owner(s). As applicable, we make no representation as to the condition of the property (or properties) in question.





**3030**  
**KUTZTOWN RD**  
READING, PENNSYLVANIA

**amazon**

**CALDERA**  
MANUFACTURING GROUP

**222**  
BUSINESS

**61**

**222**  
BUSINESS

**12**

**12**

**Stone Pointe**  
CORPORATE CENTER  
**CDS**  
LOGISTICS & HOME SERVICES

**TAB**  
INDUSTRIAL TRAILER

**FedEx**  
Ground

**.4 Miles**

**1.1 Miles**

To 222 Business: .4 miles  
To Route 12: 1.1 miles  
To Interstate 78: 15 miles  
To Allentown: 31 miles

To New Jersey: 40 miles  
To Harrisburg: 65 miles  
To Philadelphia: 65 miles  
To New York City: 119 miles

# SPECS

Total Available SF	±20,000 SF	Dock Doors	4 Dock Doors
Office	±1,000 SF	Drive-In Doors	2 (12'x16') Drive-In Doors
Configuration	Single-Side Load	Car Parking Spaces	±139 Spaces
Clear Height	24' Clear	Trailer Parking Spaces	±17 Spaces
Lighting	LED Lighting Package	Fire Protection	Wet System

**Gerry Blinebury**  
Executive Vice Chair  
+1 717 231 7291  
gerry.blinebury@cushwake.com

**Hunter Kessell**  
Director  
+1 610 589 0639  
hunter.kessell@cushwake.com

**Collin Potter**  
Director  
+1 717 231 7460  
collin.potter@cushwake.com

**NS DEVELOPMENT**  
**CUSHMAN & WAKEFIELD**

Cushman & Wakefield Copyright 2025. No warranty or representation, express or implied, is made to the accuracy or completeness of the information contained herein, and same is submitted subject to errors, omissions, change of price, rental or other conditions, withdrawal without notice, and to any special listing conditions imposed by the property owner(s). As applicable, we make no representation as to the condition of the property (or properties) in question.