

# 5300 E. ADAMO DR. | TAMPA, FL 33619

22,252 SF  
AVAILABLE FOR LEASE



LISA ROSS, SIOR

Senior Director  
+1 813 424 3211  
lisa.ross@cushwake.com

TREY CARSWELL, SIOR

Senior Director  
+1 813 204 5314  
trey.carswell@cushwake.com



5300 E. ADAMO DR. | TAMPA, FL 33619

22,252 SF  
AVAILABLE FOR LEASE

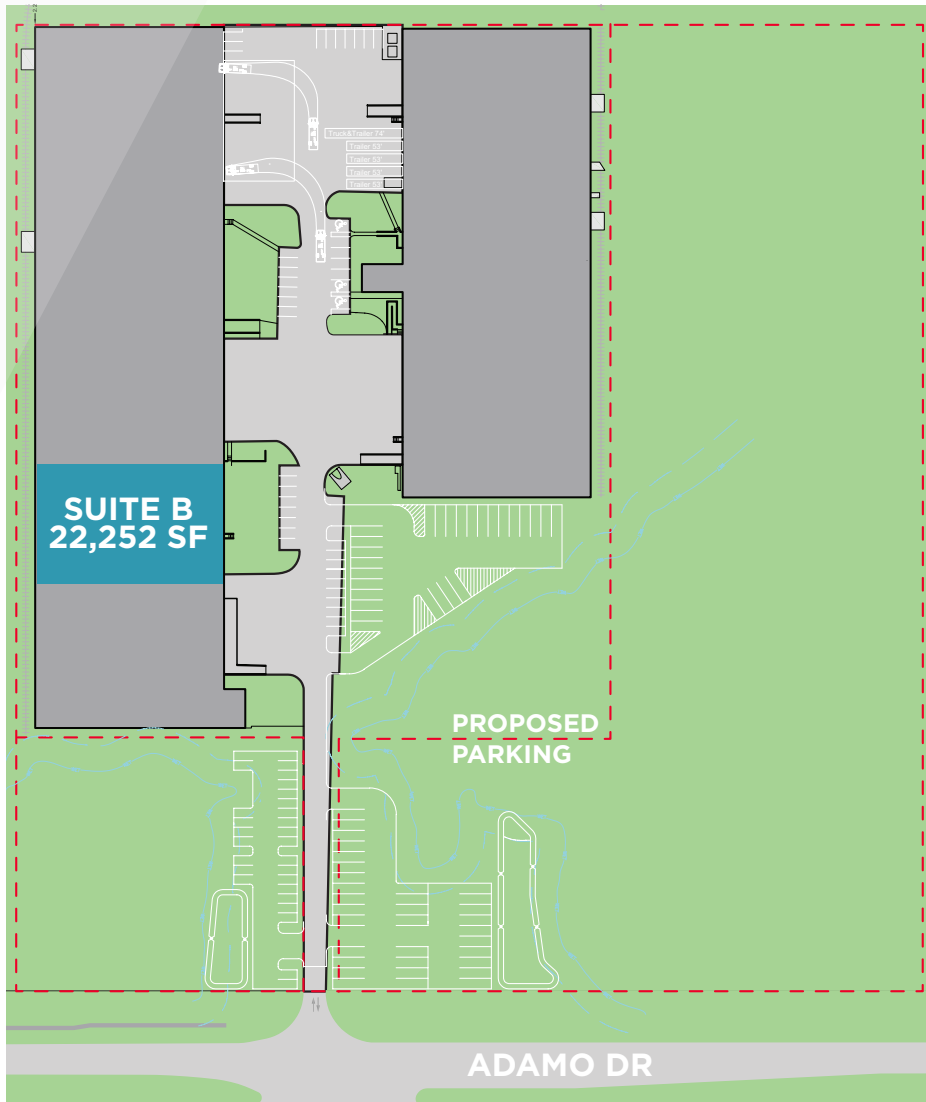

**28'  
CLEAR HEIGHT**



**DOCK HIGH &  
DRIVE-IN DOORS**



**FIRE  
SUPPRESSION**

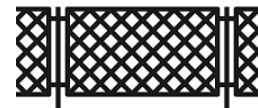

**100% FENCED**

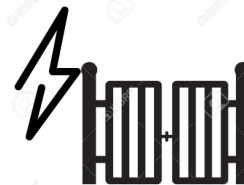

**ELECTRIC  
GATE**

LISA ROSS, SIOR

Senior Director

+1 813 424 3211

[lisa.ross@cushwake.com](mailto:lisa.ross@cushwake.com)

TREY CARSWELL, SIOR

Senior Director

+1 813 204 5314

[trey.carswell@cushwake.com](mailto:trey.carswell@cushwake.com)



**CUSHMAN &  
WAKEFIELD**



**ALPHA  
INDUSTRIAL  
PROPERTIES**

# 5300 E. ADAMO DR. | TAMPA, FL 33619

SUITE B: 22,252 SF

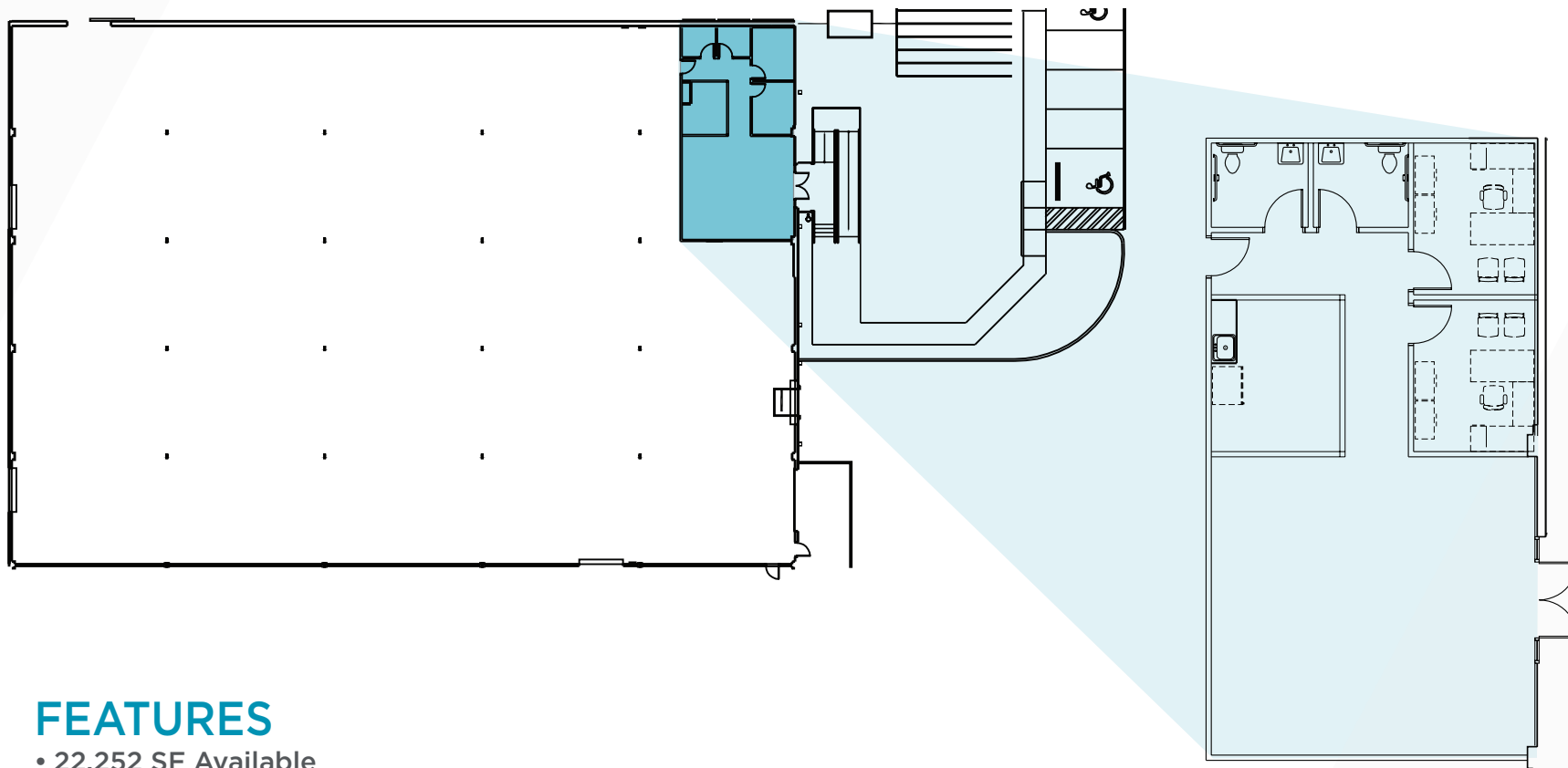

## FEATURES

- 22,252 SF Available
- 3 Dock High Doors
- (1) Oversized Door 20'w X 10'h
- 28' Clear Height
- 160' Truck Court
- Approx 1,070 SF of Newly Constructed Office Space with Glass Entry

LISA ROSS, SIOR

Senior Director

+1 813 424 3211

[lisa.ross@cushwake.com](mailto:lisa.ross@cushwake.com)

TREY CARSWELL, SIOR

Senior Director

+1 813 204 5314

[trey.carswell@cushwake.com](mailto:trey.carswell@cushwake.com)





# 5300 E. ADAMO DR. | TAMPA, FL 33619

22,252 SF  
IMMEDIATELY AVAILABLE  
FOR LEASE



**LISA ROSS, SIOR**

Senior Director

+1 813 424 3211

[lisa.ross@cushwake.com](mailto:lisa.ross@cushwake.com)

**TREY CARSWELL, SIOR**

Senior Director

+1 813 204 5314

[trey.carswell@cushwake.com](mailto:trey.carswell@cushwake.com)



**CUSHMAN &  
WAKEFIELD**



**ALPHA  
INDUSTRIAL  
PROPERTIES**

©2020 Cushman & Wakefield. The depiction in the included photograph of any person, entity, sign, logo or property, other than Cushman & Wakefield's client and the property offered by Cushman & Wakefield, is incidental only, and is not intended to connote any affiliation, connection, association, sponsorship or approval by or between that which is incidentally depicted and Cushman & Wakefield or its client. This listing shall not be deemed an offer to lease, sublease or sell such property; and, in the event of any transaction for such property, no commission shall be earned by or payable to any cooperating broker except if otherwise provided pursuant to the express terms, rates and conditions of Cushman & Wakefield's agreement with its principal, if, as and when such commission (if any) is actually received from such principal. (A copy of the rates and conditions referred to above with respect to this property is available upon request.)