

5300 E. ADAMO DR. | TAMPA, FL 33619

18,614 SF
AVAILABLE FOR LEASE



LISA ROSS, SIOR

Managing Director

+1 813 424 3211

lisa.ross@cushwake.com

TREY CARSWELL, SIOR

Managing Director

+1 813 204 5314

trey.carswell@cushwake.com

SAM KOROLOS

Senior Associate

+1 704-989-1327

sam.korolos@cushwake.com

MELISSA WATTERWORTH

Associate

+1 813 465 7942

melissa.watterworth@cushwake.com



**CUSHMAN &
WAKEFIELD**

OXFORD

5300 E. ADAMO DR. | TAMPA, FL 33619

18,614 SF
AVAILABLE FOR LEASE

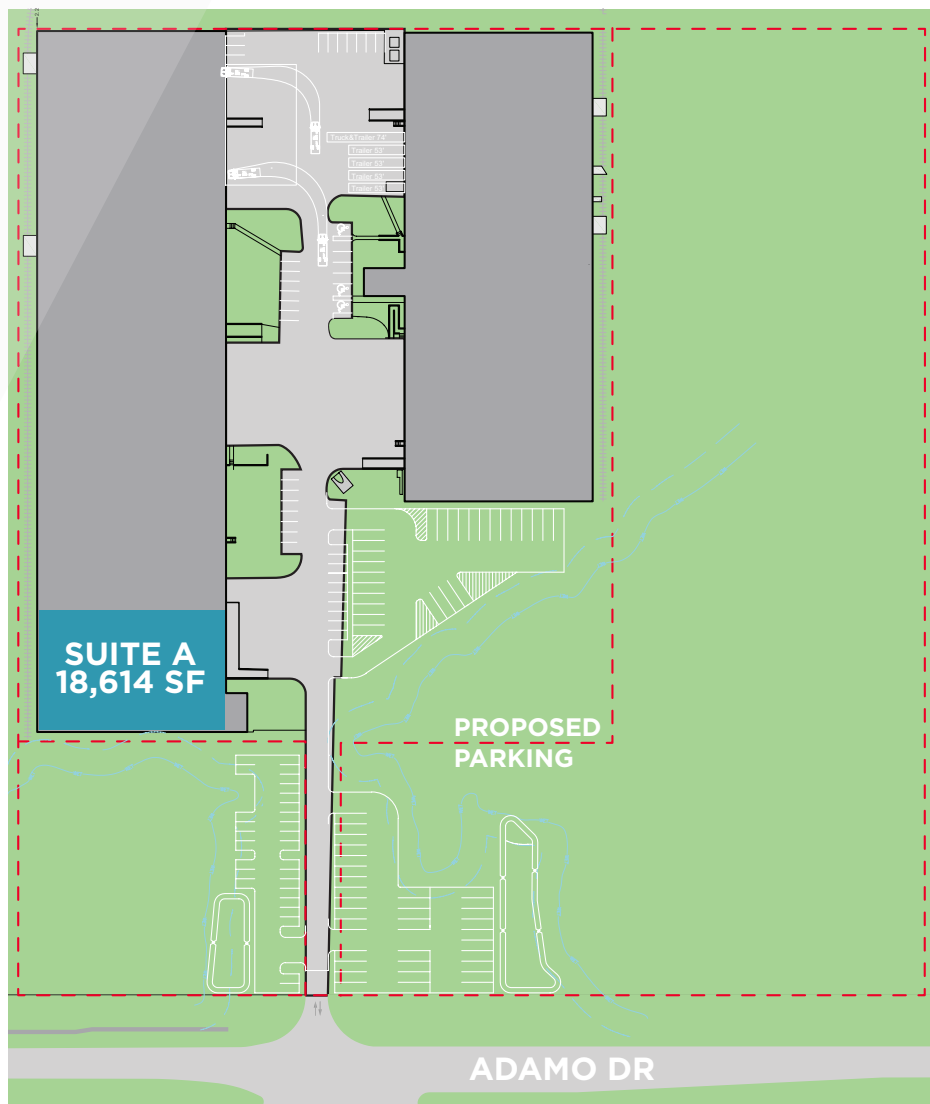

**28'
CLEAR HEIGHT**



**DOCK HIGH &
DRIVE-IN DOORS**



**FIRE
SUPPRESSION**

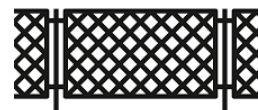

100% FENCED

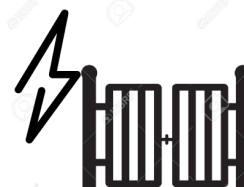

**ELECTRIC
GATE**



SUITE A: 18,614 SF

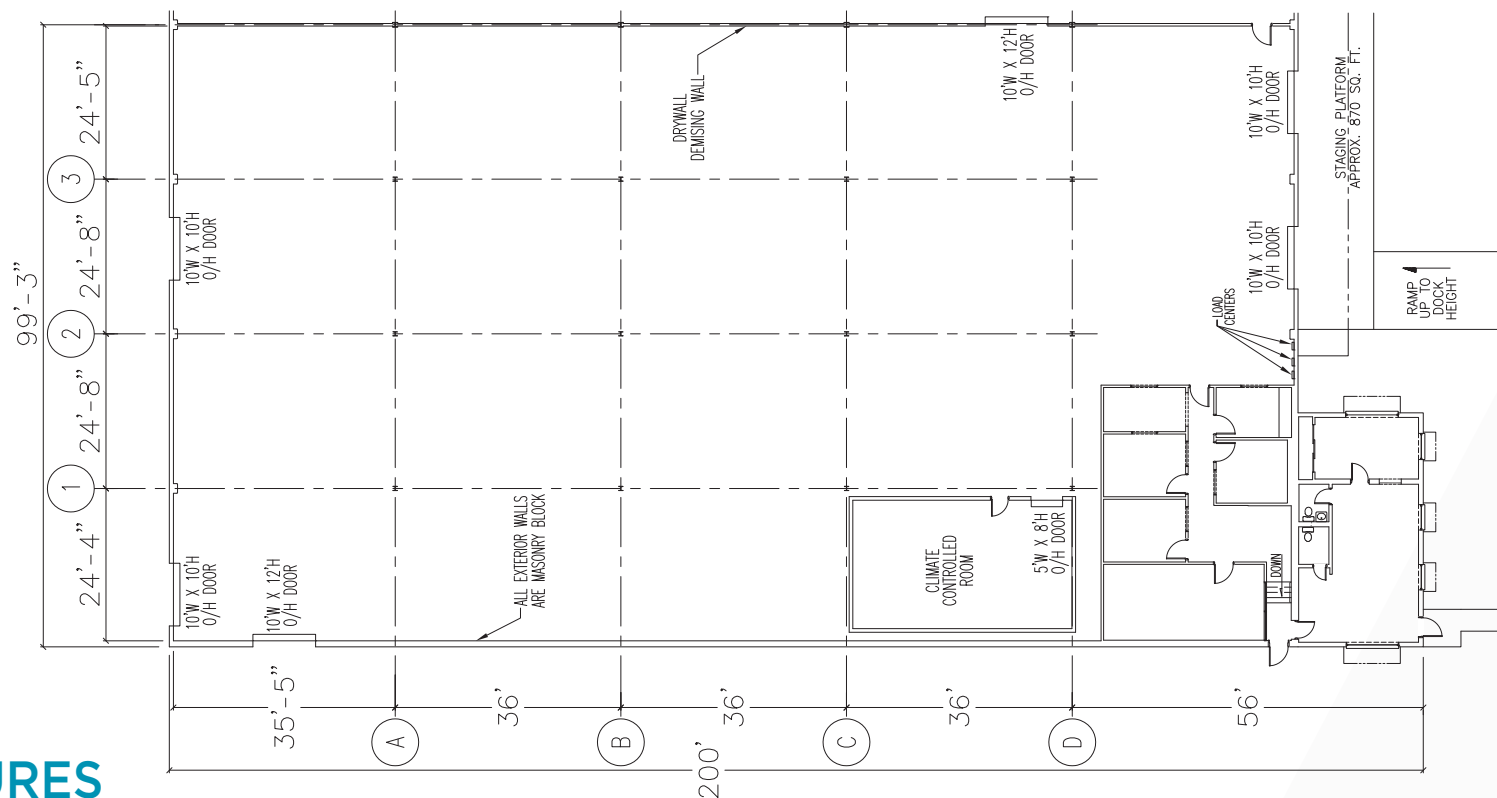

FEATURES

- 18,614 SF Available
- 2 Dock High Doors
- 1 Ramp
- 28' Clear Height
- LED Lighting
- 2,746 SF Office

5300 E. ADAMO DR. | TAMPA, FL 33619

Ju

18,614 SF
AVAILABLE FOR LEASE
JULY 1, 2025



LISA ROSS, SIOR

Managing Director

+1 813 424 3211

lisa.ross@cushwake.com

TREY CARSWELL, SIOR

Managing Director

+1 813 204 5314

trey.carswell@cushwake.com

SAM KOROLOS

Senior Associate

+1 704-989-1327

sam.korolos@cushwake.com

MELISSA WATTERWORTH

Associate

+1 813 465 7942

melissa.watterworth@cushwake.com



**CUSHMAN &
WAKEFIELD**

OXFORD

©2020 Cushman & Wakefield. The depiction in the included photograph of any person, entity, sign, logo or property, other than Cushman & Wakefield's client and the property offered by Cushman & Wakefield, is incidental only, and is not intended to connote any affiliation, connection, association, sponsorship or approval by or between that which is incidentally depicted and Cushman & Wakefield or its client. This listing shall not be deemed an offer to lease, sublease or sell such property; and, in the event of any transaction for such property, no commission shall be earned by or payable to any cooperating broker except if otherwise provided pursuant to the express terms, rates and conditions of Cushman & Wakefield's agreement with its principal, if, as and when such commission (if any) is actually received from such principal. (A copy of the rates and conditions referred to above with respect to this property is available upon request.)