



FirstService
Credit Union

16430
PARK TEN PLACE
HOUSTON, TX

PROPERTY FEATURES



110,408 SF
OFFICE BUILDING



8,367 SF
AVAILABLE



3.5/1,000 SF
PARKING RATIO



\$22.50 PSF/YR
(GROSS)
LEASE RATE



\$11.66 PSF/YR.
OPEX



SECURITY GUARD
ON-SITE



ON-SITE
PROPERTY
MANAGEMENT



NEW
CONFERRING
CENTER



NEW
FITNESS CENTER



NEW
COFFEE BAR



16430
PARK TEN PLACE
HOUSTON, TX

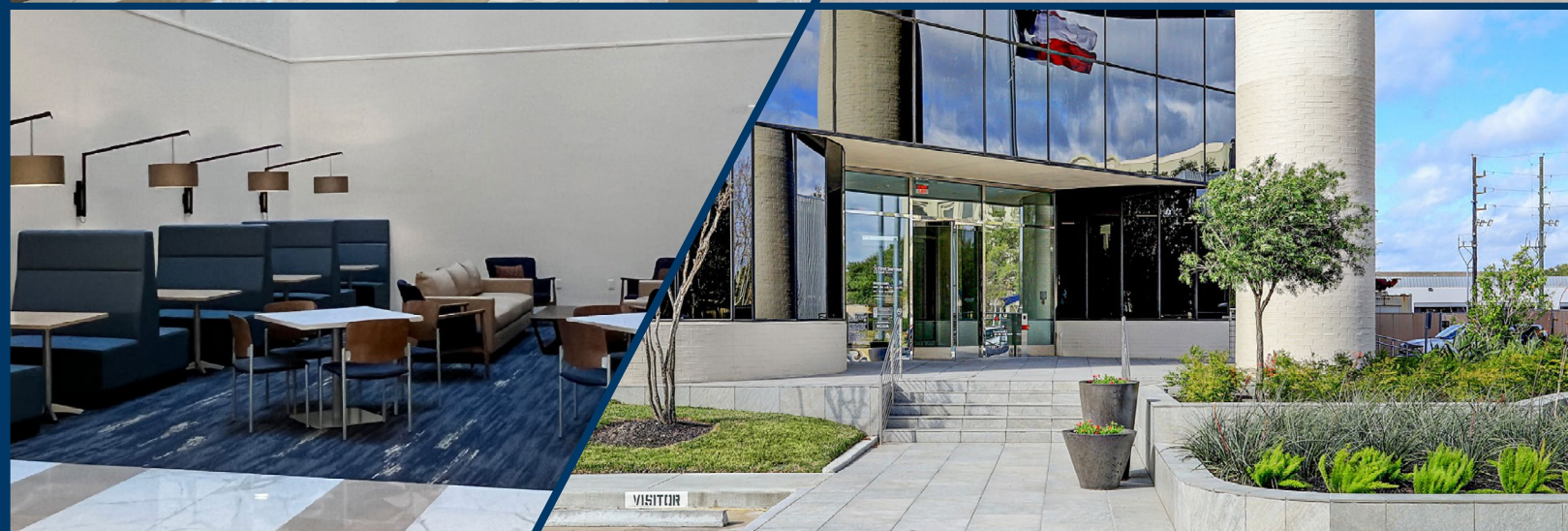

16430

PARK TEN PLACE
HOUSTON, TX

FOR LEASING INFORMATION CONTACT

ROBERT LACOURE

Senior Director
+1 832 919 8425
robert.lacoure@cushwake.com

JILL NESLONEY

Director
+1 832 699 3001
jill.nesloney@cushwake.com

BRYCE ADAMS

Associate
+1 832 919 8424
bryce.adams@cushwake.com

©2023 Cushman & Wakefield. All rights reserved. The information contained in this communication is strictly confidential. This information has been obtained from sources believed to be reliable but has not been verified. NO WARRANTY OR REPRESENTATION, EXPRESS OR IMPLIED, IS MADE AS TO THE CONDITION OF THE PROPERTY (OR PROPERTIES) REFERENCED HEREIN OR AS TO THE ACCURACY OR COMPLETENESS OF THE INFORMATION CONTAINED HEREIN, AND SAME IS SUBMITTED SUBJECT TO ERRORS, OMISSIONS, CHANGE OF PRICE, RENTAL OR OTHER CONDITIONS, WITHDRAWAL WITHOUT NOTICE, AND TO ANY SPECIAL LISTING CONDITIONS IMPOSED BY THE PROPERTY OWNER(S). ANY PROJECTIONS, OPINIONS OR ESTIMATES ARE SUBJECT TO UNCERTAINTY AND DO NOT SIGNIFY CURRENT OR FUTURE PROPERTY PERFORMANCE.

845 Texas Ave., Ste 4050
Houston, TX 77021
Direct +1 713 877 1700

cushmanwakefield.com