

FOR LEASE

## Post Park Business Center

8719-8861 Boehning Lane, Indianapolis, IN 46219



### PROPERTY HIGHLIGHTS

Excellent visibility; west building fronts I-70

Dock and drive-in access

Clear height: 20' - 24'

Double row parking

Easy access to I-70 and I-465 via Post Road

Zoned CS

Wet sprinkler system

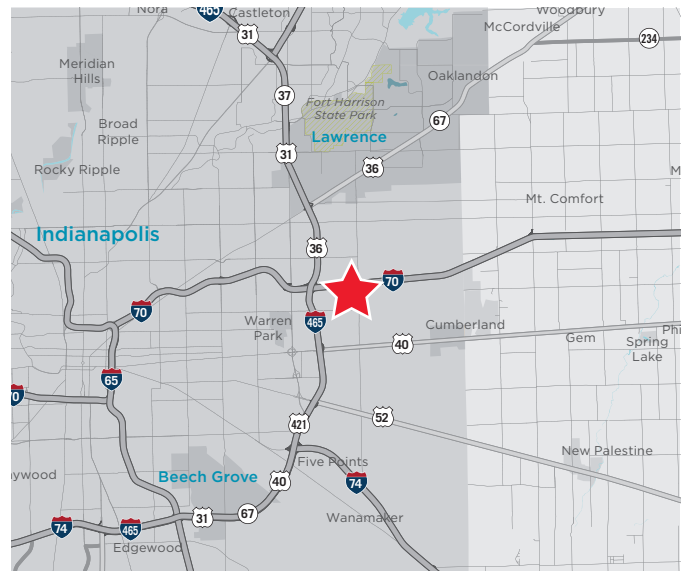

#### KEVIN W. ARCHER

Senior Director  
+1 317 218 7217  
kevin.archer@cushwake.com

#### TODD T. VANNATTA, SIOR

Executive Director  
+1 317 639 0455  
todd.vannatta@cushwake.com



**CUSHMAN &  
WAKEFIELD**

cushmanwakefield.com

FOR LEASE

## Post Park Business Center

8719-8861 Boehning Lane, Indianapolis, IN 46219

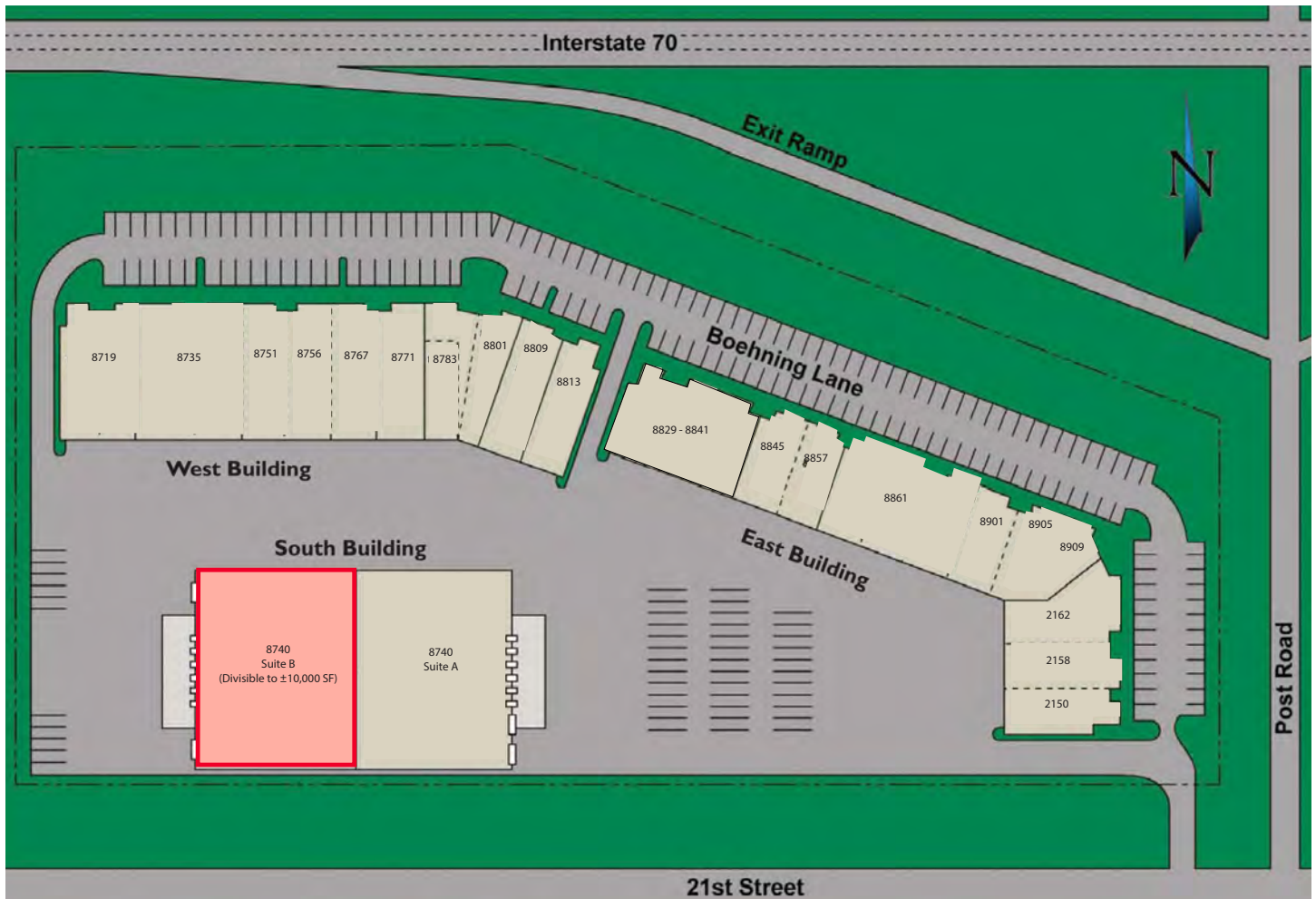

### Space Available

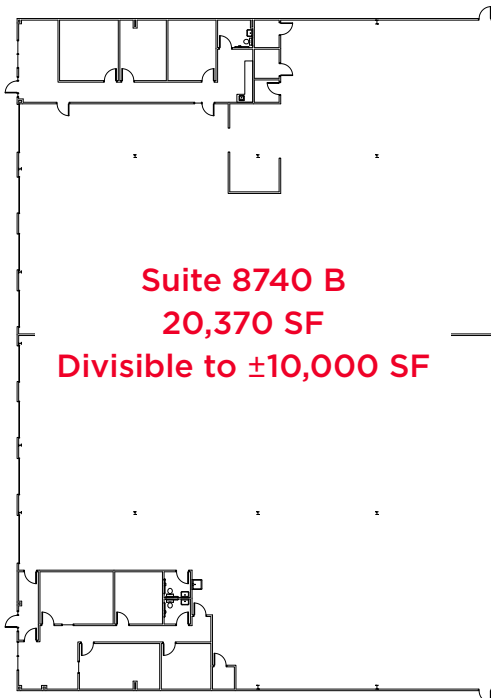

<b>Suite:</b>	8740 B
<b>Total SF:</b>	20,370 SF
<b>Office SF:</b>	2,694 SF
<b>Docks / D-I:</b>	6 / 2
<b>Clear Height:</b>	20' - 24'
<b>Base Rate/SF:</b>	\$7.25/SF
<b>OPEX:</b>	\$2.90
<b>Monthly Rent:</b>	\$17,229.63



FOR LEASE

## Post Park Business Center

8719-8861 Boehning Lane, Indianapolis, IN 46219

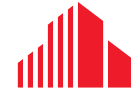

**CUSHMAN &  
WAKEFIELD**

### Aerial



#### KEVIN W. ARCHER

Senior Director

+1 317 218 7217

kevin.archer@cushwake.com

#### TODD T. VANNATTA, SIOR

Executive Director

+1 317 639 0455

todd.vannatta@cushwake.com

One American Square, Suite 1800  
Indianapolis, IN 46282

Main +1 317 639 0515

Fax +1 317 639 0504

**cushmanwakefield.com**