

FOR SALE OR LEASE | ±38,900 SF

TOWER
INVESTMENTS



WATCH PROPERTY VIDEO

- Heavy Power - 3 Phase/480V/5,400 Amps
- Climate Controlled Facility - Potential for Cold Storage
- Flexible Zoning Uses
- Excellent Freeway Visibility & Access

612 EAST MARKET STREET
STOCKTON, CA

[View Site Specific COVID-19 Prevention Plan](#)

©2021 Cushman & Wakefield. No warranty or representation, expressed or implied, is made to the accuracy or completeness of the information contained herein, and same is submitted subject to errors, omissions, change of price, rental or other conditions, withdrawal without notice, and to any special listing conditions imposed by the property owner(s). As applicable, we make no representation as to the condition of the property (or properties) in question.

 CUSHMAN &
WAKEFIELD

STEVE DUNN
Senior Director
+1 209 425 3973
steve.dunn@cushwake.com
Lic # 01410812

FOR
SALE OR LEASE

±38,900 SF WAREHOUSE/PRODUCTION FACILITY
612 E MARKET STREET | STOCKTON, CA



Contact Broker for Pricing Information

Property Features	
APN:	149-220-260
Parcel Size:	±2.11 Acres
Total Building Size:	±38,900 SF; Expandable to ±43,300 SF
Office Size:	±5,000 SF
Power:	3 Phase/480V/5,400 Amps
Fire Sprinklers:	Yes
Auto Parking:	On-site & Additional Parking Nearby
Trailer Parking:	Yes
Zoning:	Commercial Downtown (CD)

Property Highlights	
<ul style="list-style-type: none">±38,900 SF Multi-level warehouse building suitable for production, distribution, and storage - potential expansion to ±43,300 SFHeavy Power to the building - 3 Phase/480V/5,400 AmpsClimate controlled facility - potential for cold storage useClear span high ceilings across warehouse floorLarge freight elevator5 dock-high doors; 3 grade-level doorsPotential conversion for a 12' x 18' grade-level doorGated + secured facilityConvenient Downtown Stockton location with direct access to CA Hwy 4 - within close proximity to the CA Hwy 99, I-5, Port of Stockton, Stockton Metro Airport, and nearby intermodal rail facilities	



Building Specs				
	A	B	C	D (2nd Floor Office)
Area SF:	±20,000 SF	±4,400 SF	±9,000 SF	±5,200 SF
Dimensions:	150' x 133'	33' x 133'	68' x 133'	-
Clear Height:	25'	50'	29'	-
Dock Doors:	3	-	2	-
Grade Level Doors:	3	1 Potential Door	-	-
Power:	1,350 Amps	1,600 Amps	2,400 Amps	-
Expansion:	±4,400 SF			

**FOR
SALE OR LEASE**

±38,900 SF WAREHOUSE/PRODUCTION FACILITY
612 E MARKET STREET | STOCKTON, CA



Potential Permitted Uses - Commercial Downtown (CD)

Potential Permitted (P) Uses per City of Stockton Development Code for Commercial Downtown (CD):

- Food & Beverage Product Manufacturing
- Hand Craft & Fabric Manufacturing
- Cannabis Testing Laboratory
- Printing & Publishing
- Wholesaling & Distribution
- Auditoriums, Meeting Halls & Theaters
- Vocational & Technical Schools
- Equipment Repair & Maintenance Testing
- Vehicle Repair & Maintenance Training
- Auto Parts Sales
- Motion Picture Production
- Parking Facilities
- Health & Fitness Facilities
- Ambulance Services
- Clinics & Laboratories
- Medical Related Facilities

Other uses allowed with Commission Use Permit (C), Land Development Permit (L) or Administrative Use Permit (A). Please refer to the [City of Stockton Allowable Land Uses & Permit Requirements](#) on the City of Stockton website.

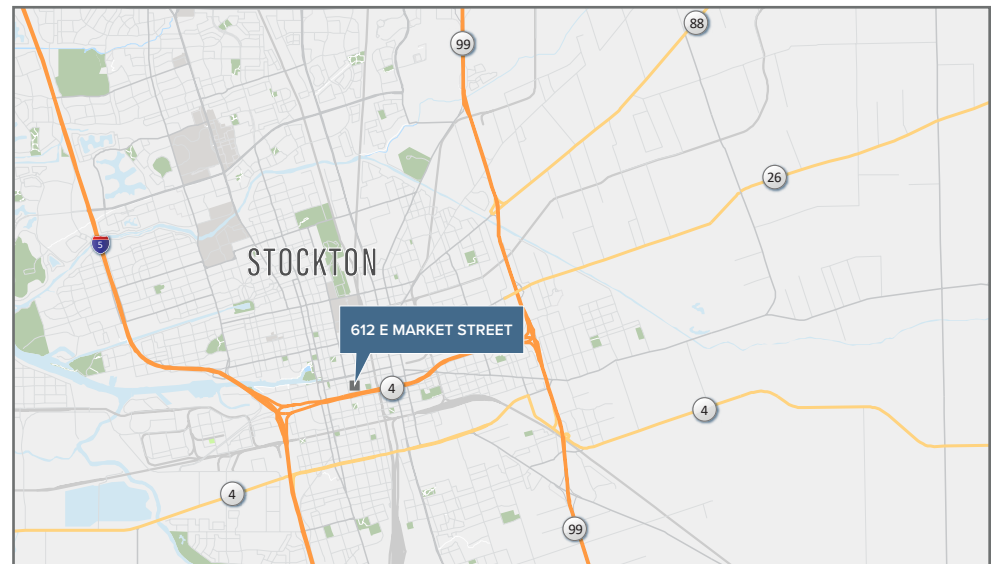

FOR
SALE OR LEASE

±38,900 SF WAREHOUSE/PRODUCTION FACILITY
612 E MARKET STREET | STOCKTON, CA



Site Plan



FOR
SALE OR LEASE

±38,900 SF WAREHOUSE/PRODUCTION FACILITY
612 E MARKET STREET | STOCKTON, CA



Site Plan

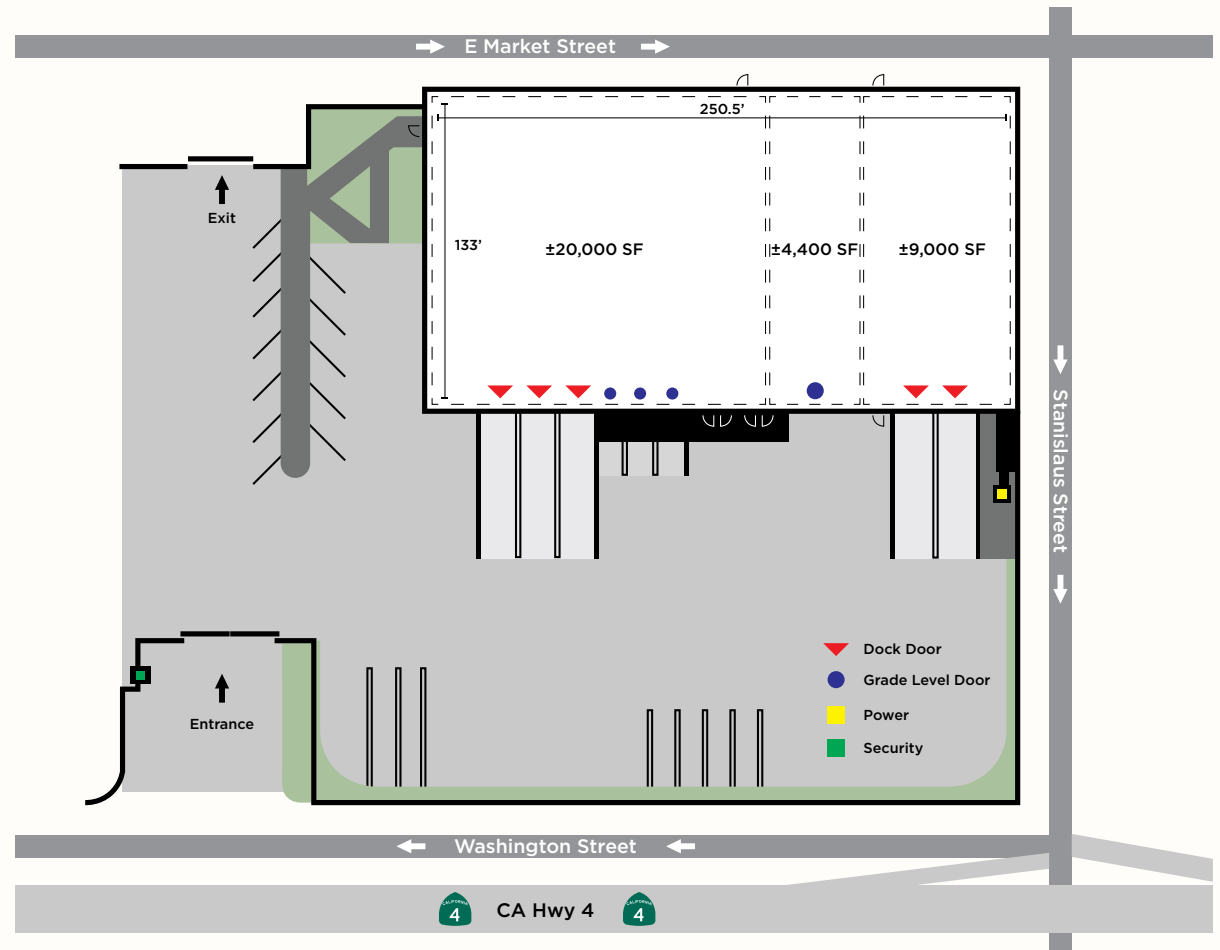

FOR
SALE OR LEASE

±38,900 SF WAREHOUSE/PRODUCTION FACILITY
612 E MARKET STREET | STOCKTON, CA



Floor Plan - First Floor

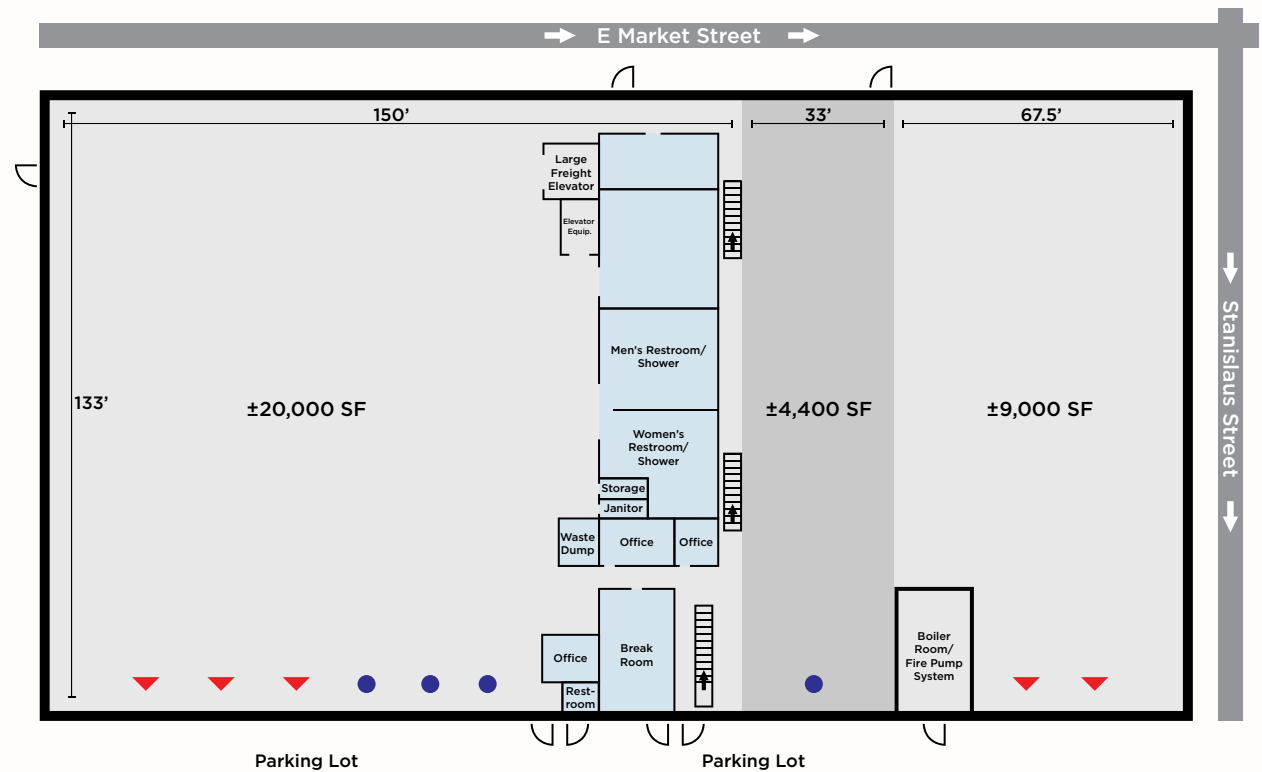

FOR
SALE OR LEASE

±38,900 SF WAREHOUSE/PRODUCTION FACILITY
612 E MARKET STREET | STOCKTON, CA



Floor Plan - Second Floor

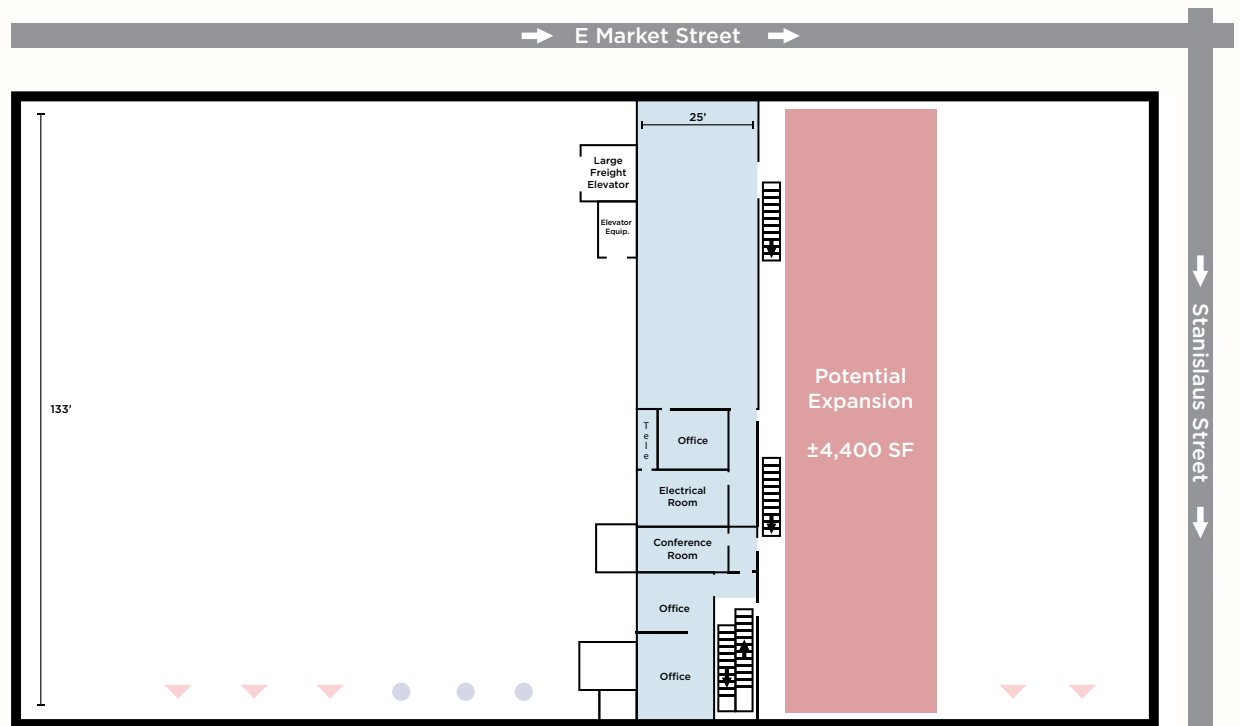



FOR SALE OR LEASE

612 EAST MARKET STREET
STOCKTON, CA

Exclusively Listed By:

STEVE DUNN

Senior Director

+1 209 425 3973

steve.dunn@cushwake.com

Lic # 01410812



[View Site Specific COVID-19 Prevention Plan](#)

©2021 Cushman & Wakefield. No warranty or representation, expressed or implied, is made to the accuracy or completeness of the information contained herein, and same is submitted subject to errors, omissions, change of price, rental or other conditions, withdrawal without notice, and to any special listing conditions imposed by the property owner(s). As applicable, we make no representation as to the condition of the property (or properties) in question.