



FOR LEASE

ENTERPRISE INDUSTRIAL PARK

317, 320, 325, 328, 329, AND 336 HABERSHAM RD, HIGH POINT, NC 27260



ENTERPRISE INDUSTRIAL PARK

317, 320, 325, 328, 329, AND 336 HABERSHAM RD, HIGH POINT, NC 27260

LOCATOR MAP

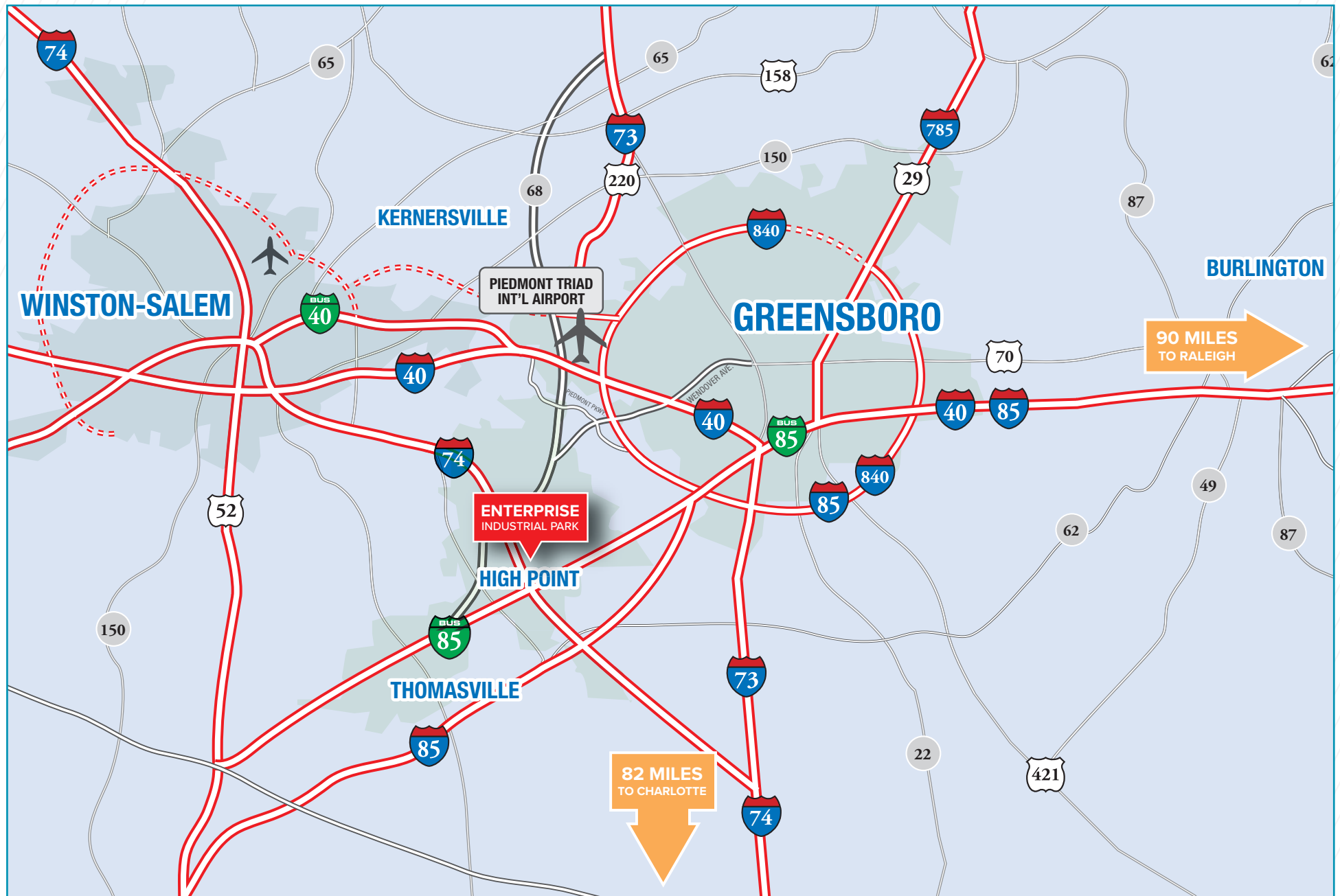

ENTERPRISE INDUSTRIAL PARK

317, 320, 325, 328, 329, AND 336 HABERSHAM RD, HIGH POINT, NC 27260

LOCATION AERIAL



ENTERPRISE INDUSTRIAL PARK

317, 320, 325, 328, 329, AND 336 HABERSHAM RD, HIGH POINT, NC 27260

AVAILABILITY



ENTERPRISE INDUSTRIAL PARK

317, 320, 325, 328, 329, AND 336 HABERSHAM RD, HIGH POINT, NC 27260

SPACE AVAILABILITY

317 HABERSHAM ROAD

SUITE 103 & 105
+/- 14,663 SF
Available 04/30/23

SUITE 103
+/- 4,888 SF

SUITE 105
+/- 9,775 SF

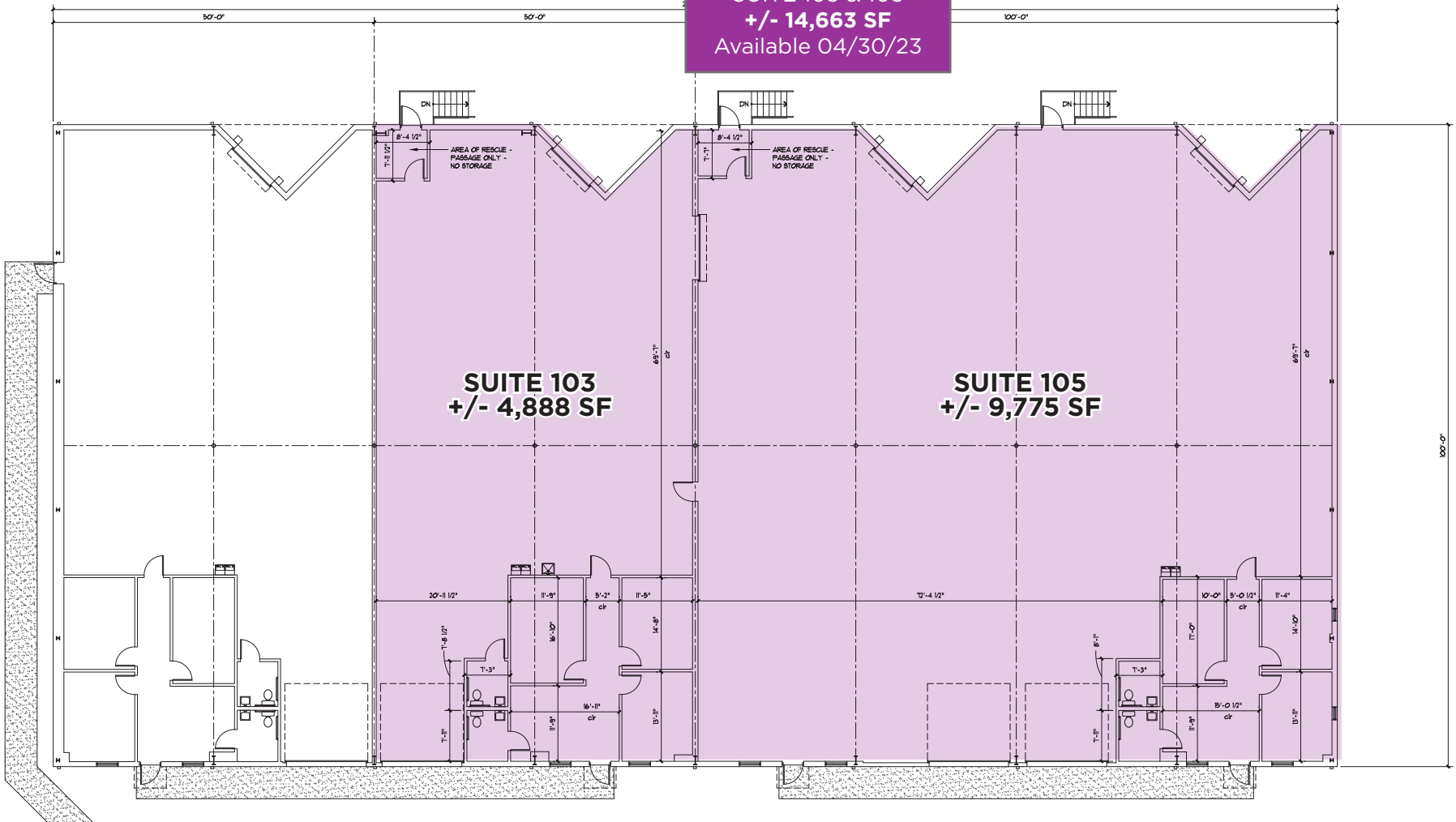

317, 320, 325, 328, 329, AND 336 HABERSHAM RD, HIGH POINT, NC 27260

320 HABERSHAM ROAD

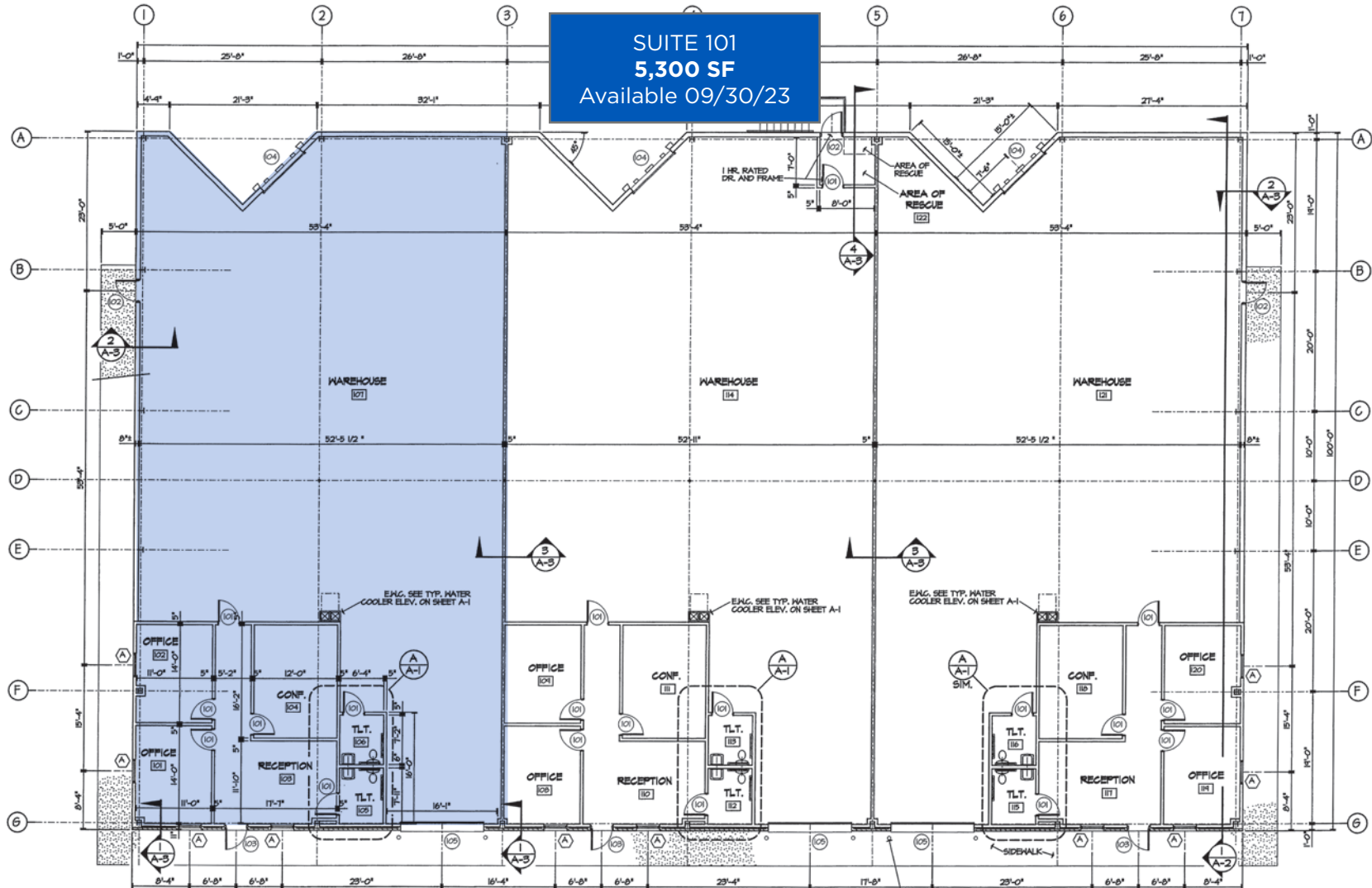

ENTERPRISE INDUSTRIAL PARK

317, 320, 325, 328, 329, AND 336 HABERSHAM RD, HIGH POINT, NC 27260

SPACE AVAILABILITY

325 HABERSHAM ROAD

SUITE 105
10,700 SF
Available 03/31/23

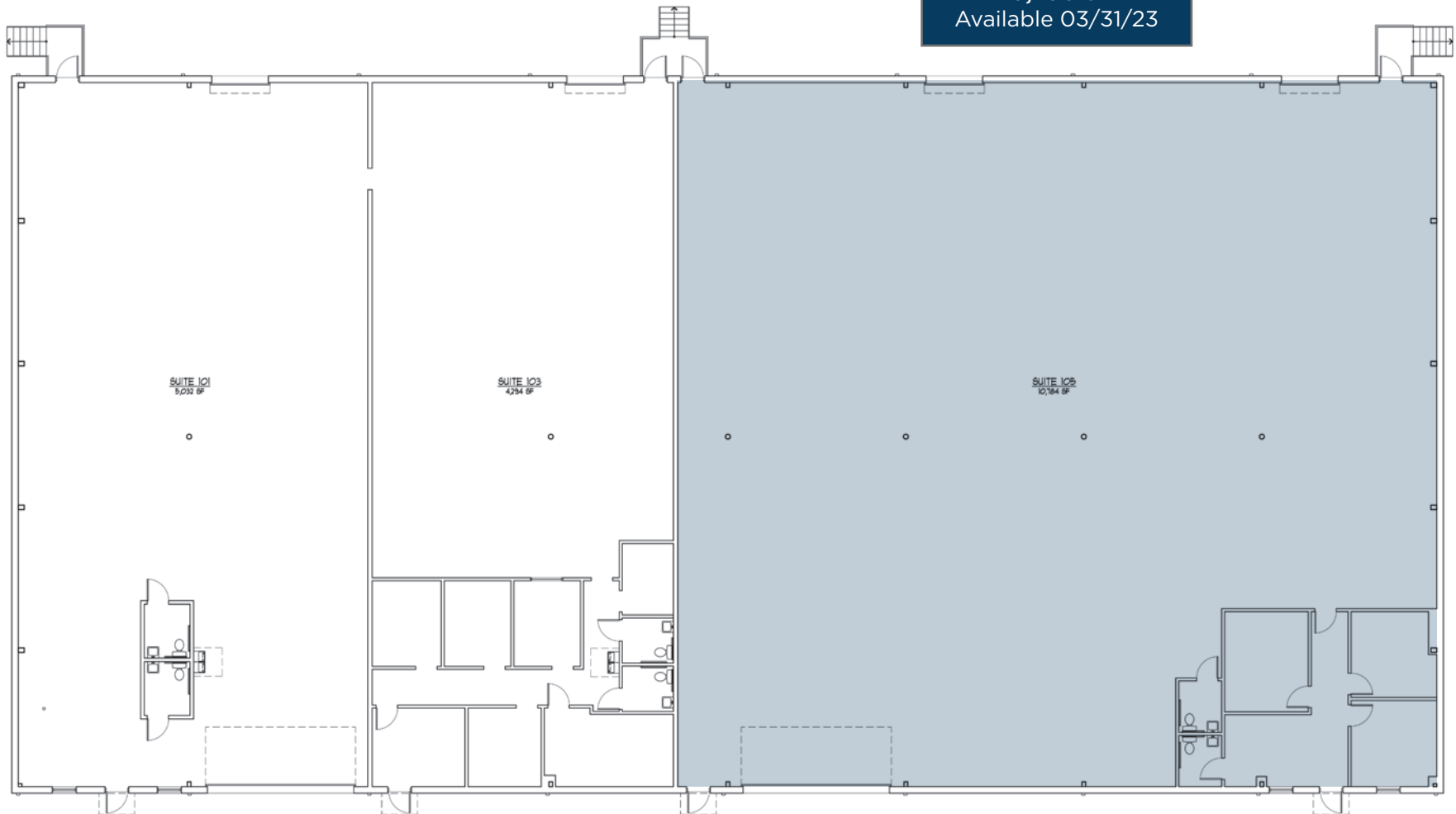

ENTERPRISE INDUSTRIAL PARK

317, 320, 325, 328, 329, AND 336 HABERSHAM RD, HIGH POINT, NC 27260

SPACE AVAILABILITY

328 HABERSHAM ROAD

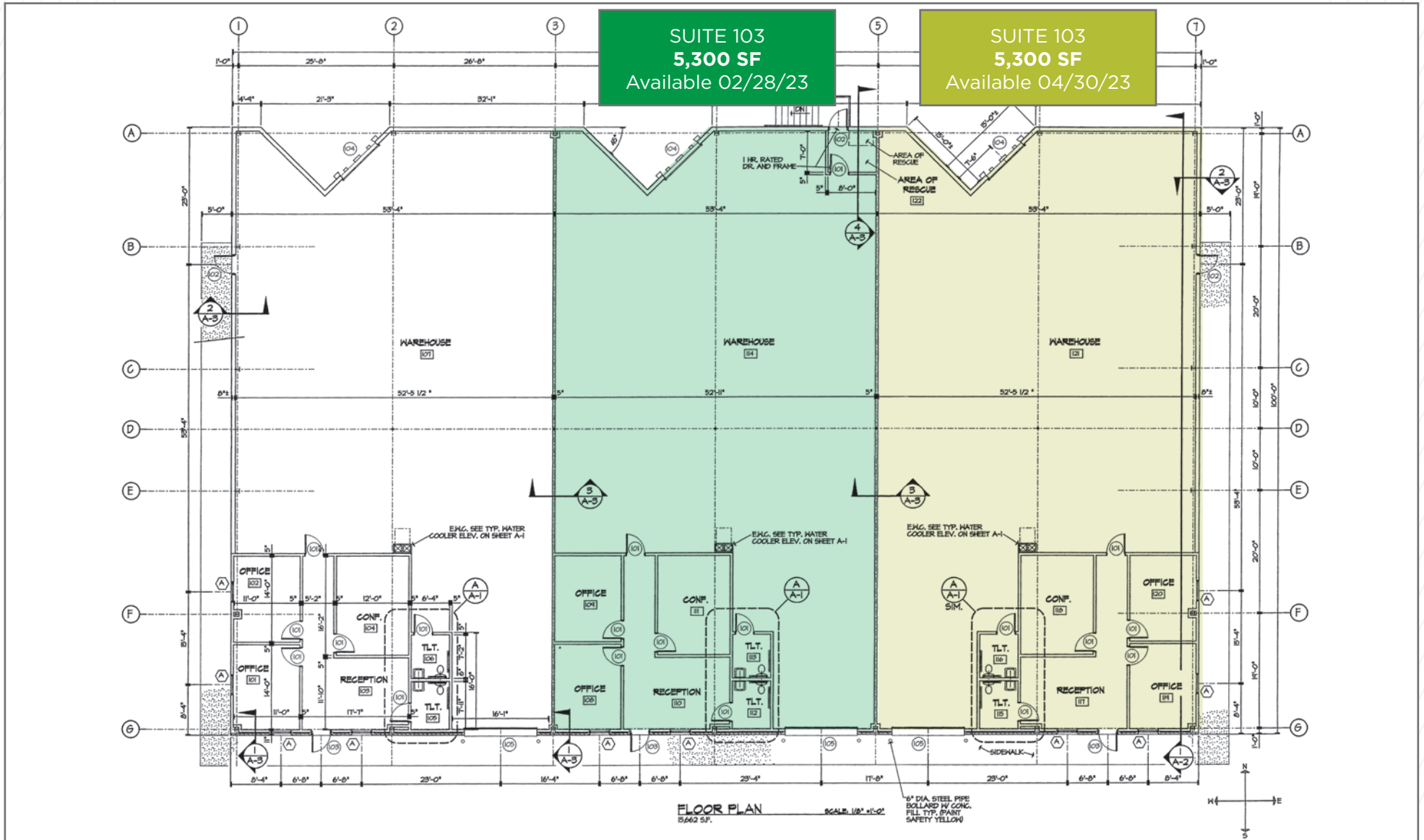

317, 320, 325, 328, 329, AND 336 HABERSHAM RD, HIGH POINT, NC 27260

329 HABERSHAM ROAD

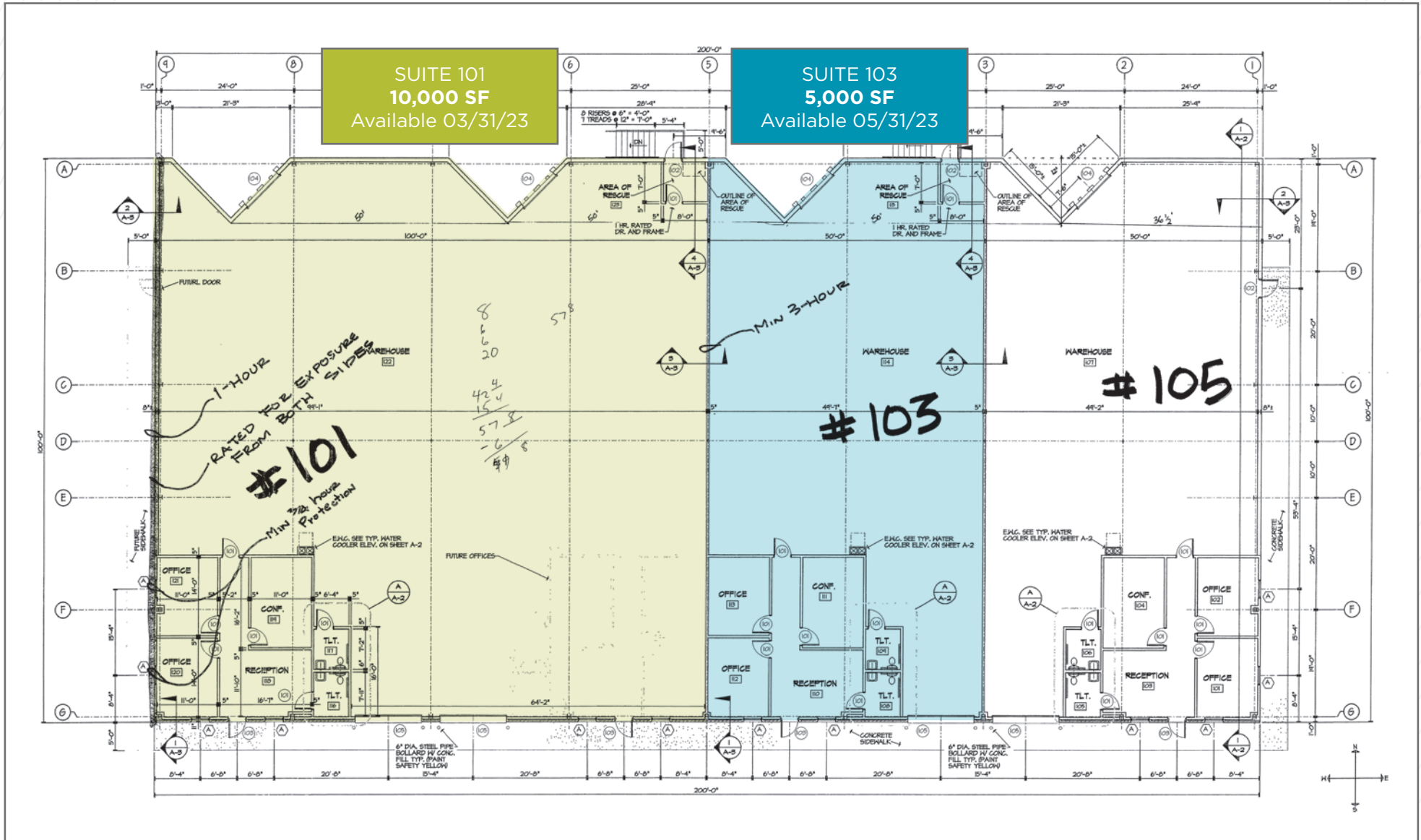

ENTERPRISE INDUSTRIAL PARK

317, 320, 325, 328, 329, AND 336 HABERSHAM RD, HIGH POINT, NC 27260

BUILDING 317



Size:	20,000 SF
Clear Height:	24'
Column Spacing:	25' x 48'
Dock-high Doors:	Three (3)
Drive-in Doors:	Three (3)

BUILDING 320



Size:	15,900 SF
Clear Height:	24'
Column Spacing:	25' x 48'
Dock-high Doors:	Three (3)
Drive-in Doors:	Three (3)

BUILDING 325



Size:	20,000 SF
Clear Height:	24'
Column Spacing:	25' x 48'
Dock-high Doors:	Four (4)
Drive-in Doors:	Two (2)

BUILDING 328



Size:	15,900 SF
Clear Height:	24'
Column Spacing:	25' x 48'
Dock-high Doors:	Three (3)
Drive-in Doors:	Three (3)

BUILDING 329



Size:	20,000 SF
Clear Height:	24'
Column Spacing:	25' x 48'
Dock-high Doors:	Four (4)
Drive-in Doors:	Four (4)

BUILDING 336



Size:	12,000 SF
Clear Height:	24'
Column Spacing:	25' x 48'
Dock-high Doors:	Four (4)
Drive-in Doors:	Two (2)

ENTERPRISE INDUSTRIAL PARK

317, 320, 325, 328, 329, AND 336 HABERSHAM RD, HIGH POINT, NC 27260

FOR MORE INFORMATION, CONTACT:

RYAN CONBOY, SIOR

Senior Director

+1 336 821 3832

ryan.conboy@cushwake.com

JORDAN MITCHELL

Senior Associate

+1 336 201 0495

jordan.mitchell@cushwake.com

©2023 Cushman & Wakefield. All rights reserved. The material in this presentation has been prepared solely for information purposes, and is strictly confidential. Any disclosure, use, copying or circulation of this presentation (or the information contained within it) is strictly prohibited, unless you have obtained Cushman & Wakefield's prior written consent. The views expressed in this presentation are the views of the author and do not necessarily reflect the views of Cushman & Wakefield. Neither this presentation nor any part of it shall form the basis of, or be relied upon in connection with any offer, or act as an inducement to enter into any contract or commitment whatsoever. NO REPRESENTATION OR WARRANTY IS GIVEN, EXPRESS OR IMPLIED, AS TO THE ACCURACY OF THE INFORMATION CONTAINED WITHIN THIS PRESENTATION, AND CUSHMAN & WAKEFIELD IS UNDER NO OBLIGATION TO SUBSEQUENTLY CORRECT IT IN THE EVENT OF ERRORS.

