



**END CAP SPACE | AVAILABLE DECEMBER 1, 2025**

**19,698 SF For Lease**

612 Territorial Drive, Bolingbrook, Illinois



For more information, contact:

**JASON WEST, SIOR**

Executive Vice Chair  
+1 847 518 3210

[jason.west@cushwake.com](mailto:jason.west@cushwake.com)

**SEAN HENRICK, SIOR**

Vice Chair  
+1 847 518 3215

[sean.henrick@cushwake.com](mailto:sean.henrick@cushwake.com)

**RYAN KLINK**

Managing Director  
+1 847 518 3211

[ryan.klink@cushwake.com](mailto:ryan.klink@cushwake.com)



Cushman & Wakefield  
9500 W Bryn Mawr Ave  
Rosemont, IL 60018  
[cushmanwakefield.com](http://cushmanwakefield.com)

No warranty or representation, expressed or implied, is made as to the accuracy of the information contained herein, and same is submitted subject to error and omission.

END CAP SPACE | AVAILABLE DECEMBER 1, 2025

## 19,698 SF For Lease

612 Territorial Drive, Bolingbrook, Illinois



## Property Overview

### CLASS-A INDUSTRIAL BUILDING WITHIN I-55 SUBMARKET

Situated in one of Chicago's most sought-after industrial submarkets, the I-55 Industrial Corridor, the property benefits from unmatched interstate access, proximity to a deep labor pool, access to an abundance of amenities, and low Will County taxes.

### PROPERTY HIGHLIGHTS

- Immediate access to two I-55 four-way interchanges
- Professionally owned and managed property
- Surrounded by local amenities



# 19,698 SF For Lease

612 Territorial Drive, Bolingbrook, Illinois

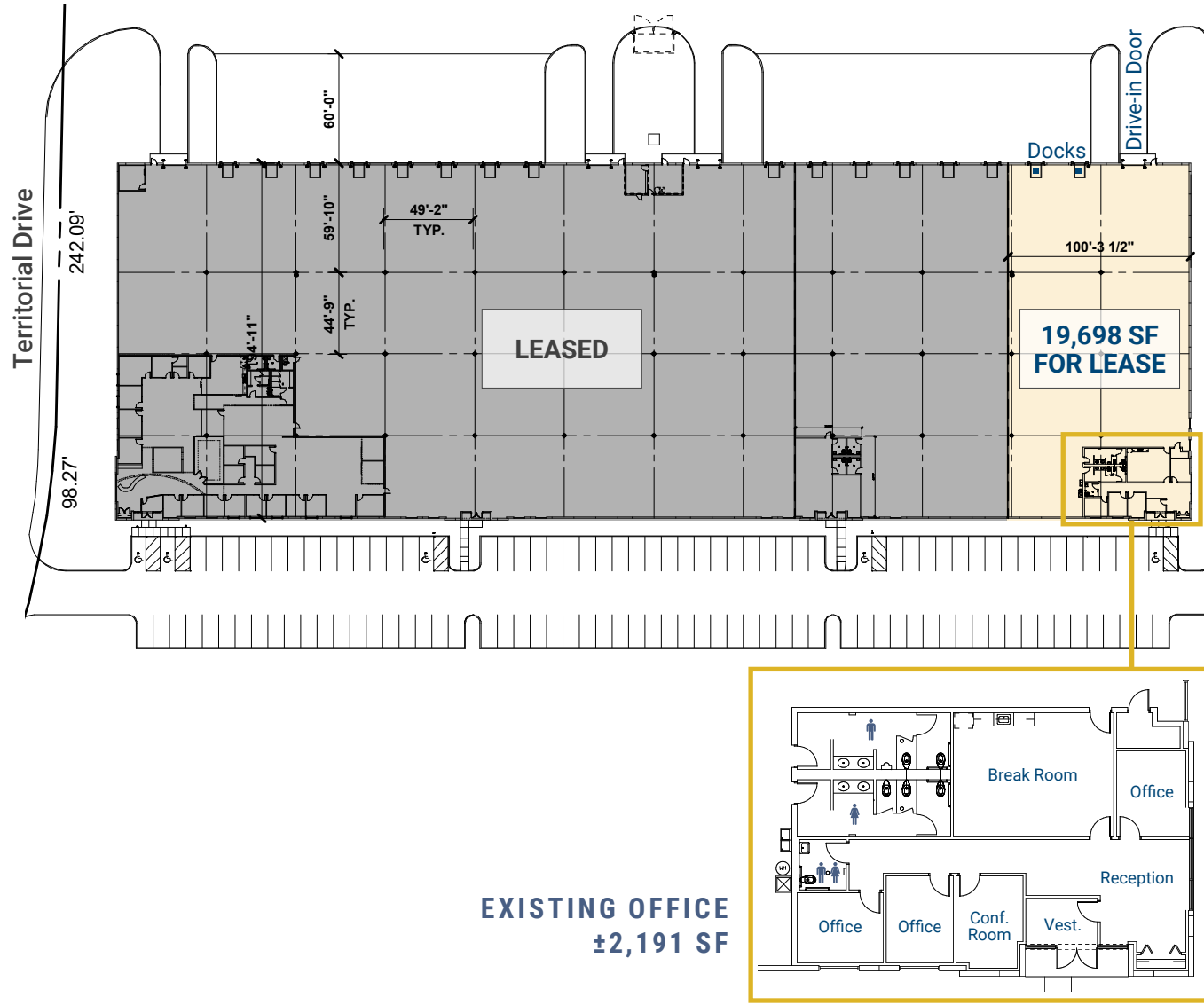

## PROPERTY FEATURES

Total Building Size	115,158 SF
Site Size	±6.34 acres
Available Space	19,698 SF (end cap)
Office	±2,191 SF
Ceiling Height	30'
Bay Spacing	50' x 45'
Car Parking	Pro rata share (approx. 23 spaces)
Docks	Two (2)
Drive-in Doors	One (1)
Lease Rate	Subject to offer
Available	12/1/2025

END CAP SPACE | AVAILABLE DECEMBER 1, 2025



19,698 SF For Lease

612 Territorial Drive, Bolingbrook, Illinois

## Location Overview



Cushman & Wakefield | 9500 W Bryn Mawr Ave | [cushmanwakefield.com](https://cushmanwakefield.com)

No warranty or representation, expressed or implied, is made as to the accuracy of the information contained herein, and same is submitted subject to error and omission.



END CAP SPACE | AVAILABLE DECEMBER 1, 2025



## 19,698 SF For Lease

612 Territorial Drive, Bolingbrook, Illinois

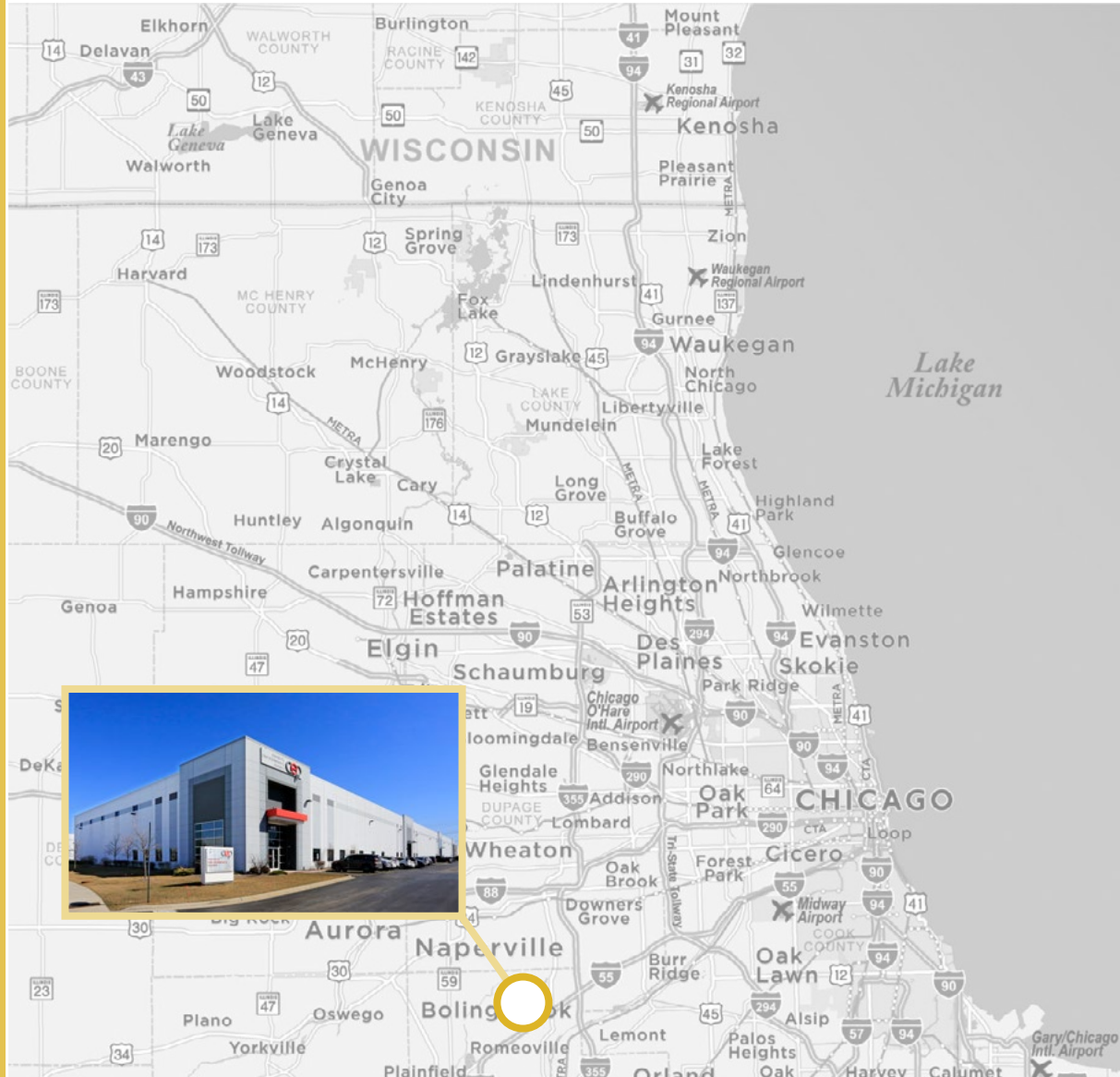

### LOCATION HIGHLIGHTS

- Territorial Business Campus
- Immediate Access to Major Routes
- Near I-355 and I-294
- Close Proximity to Area Amenities
- Access to Labor from Chicago and Joliet

2.3 miles

to I-55/IL-53 4-Way Interchange

2.8 miles

to I-55/Weber Road 4-Way Interchange

23.0 miles

to Joliet

30.6 miles

to Downtown Chicago

Cushman & Wakefield | 9500 W Bryn Mawr Ave | [cushmanwakefield.com](http://cushmanwakefield.com)

No warranty or representation, expressed or implied, is made as to the accuracy of the information contained herein, and same is submitted subject to error and omission.



END CAP SPACE | AVAILABLE DECEMBER 1, 2025



# 19,698 SF For Lease

612 Territorial Drive, Bolingbrook, Illinois

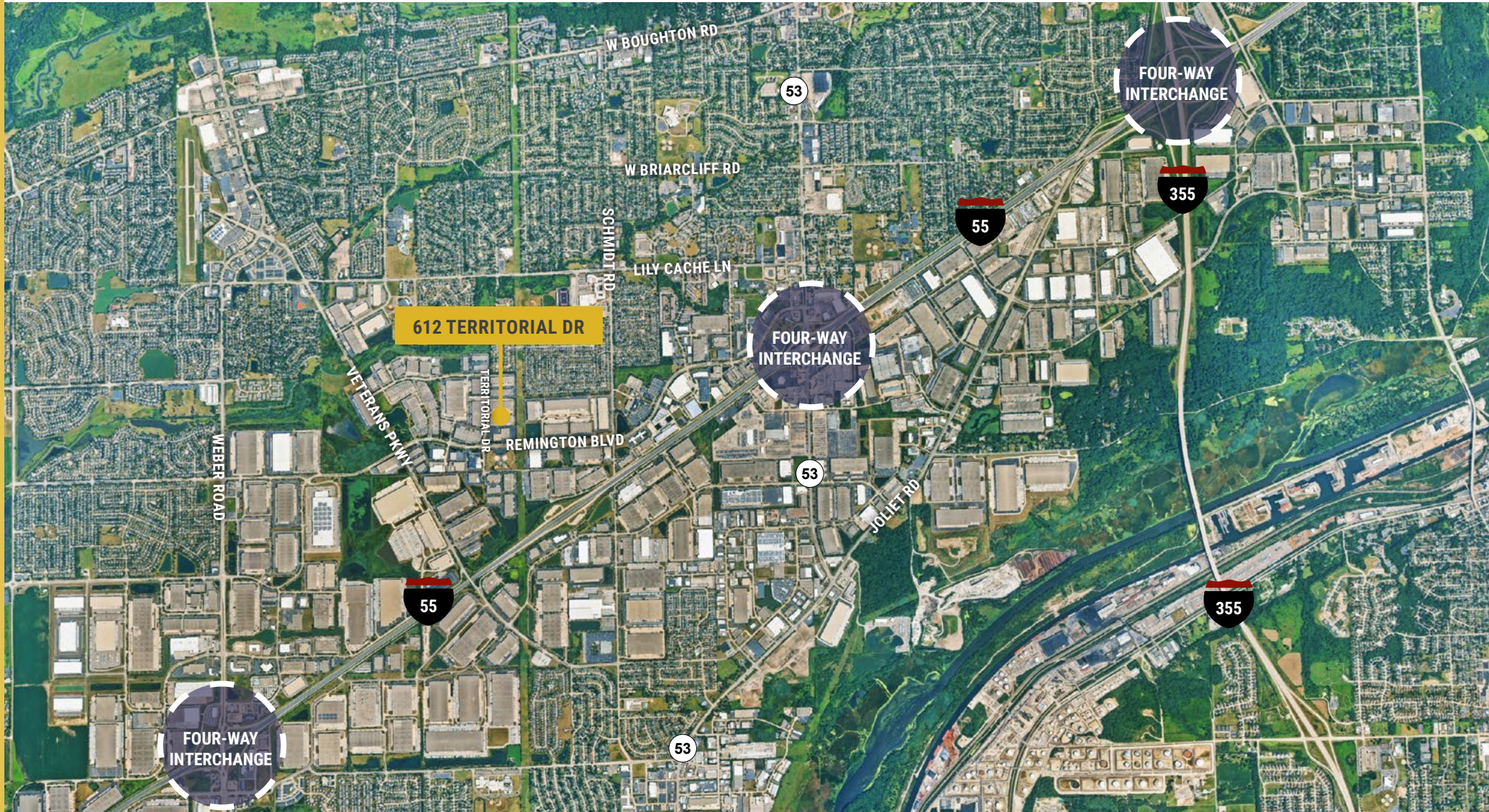

Cushman & Wakefield | 9500 W Bryn Mawr Ave | [cushmanwakefield.com](https://cushmanwakefield.com)

No warranty or representation, expressed or implied, is made as to the accuracy of the information contained herein, and same is submitted subject to error and omission.