

HUB TOWER

FOR LEASE

Hub Tower

699 Walnut Street
Des Moines, IA 50309

[VIEW PROPERTY VIDEO](#)



**CUSHMAN &
WAKEFIELD**

Iowa Commercial Advisors

PROPERTY HIGHLIGHTS

LEASE RATE: \$20.00 FSG

AVAILABILITY: 2,127 SF - 70,416 SF

- Class A Office Building
- Conveniently located on the Des Moines skywalk
- Staffed security on site
- Key card elevator access
- Access to underground or covered parking
- Several sized conference rooms suites available for use (at no cost) that can seat 20, 40 or 100 persons
- Access to EMC corporate campus, amenities including state of the art workout and shower facilities and the corporate cafeteria (for monthly fee).
- In-house design team to help determine your best fit for any of our office offerings.
- Competitive Tenant Improvement packages of Turn-key Solutions for seamless buildout.
- Corporate partners to get competitive pricing for all build-outs.

Year Built

1985

Number of Floors

20

Load Factor

1.18

Building Size

314,214

[VIEW PROPERTY VIDEO](#)



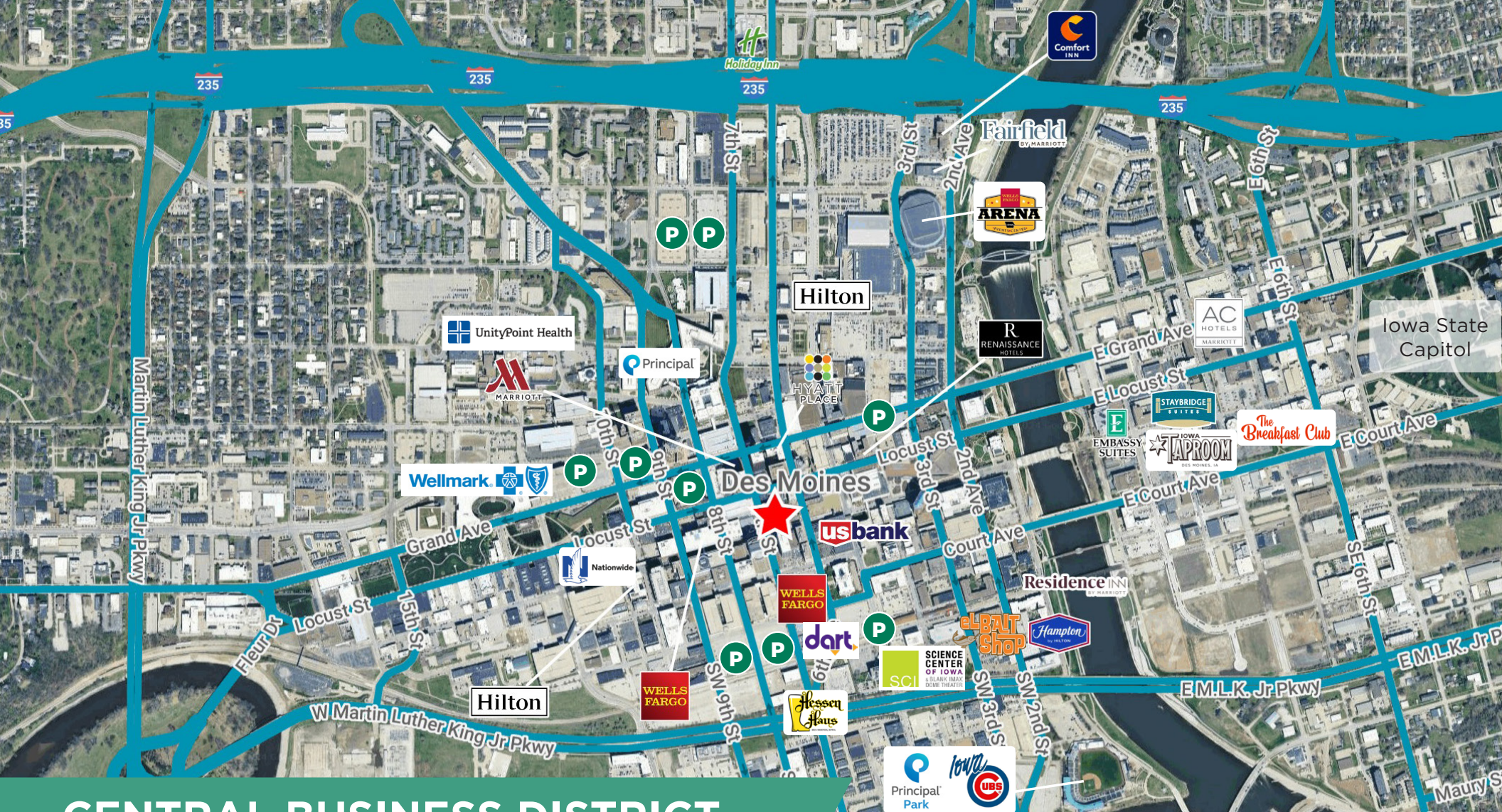

CENTRAL BUSINESS DISTRICT

Des Moines is the capital and most populous city in Iowa, with a current population, of approximately 210,381 (2023) people. Des Moines is a major center of the US insurance industry and has a sizable financial services base. The trade area for the Des Moines Metropolitan area is approximately 950,000 people, which represents 33% of the state's population. Downtown Des Moines Residential population is approximately 9,307.

DEMOGRAPHICS

	1 MILE	3 MILE	5 MILE
POPULATION	11,078	97,126	207,793
AVG HOUSEHOLD INCOME	\$93,079	\$82,344	\$93,459
WORKFORCE	54,158	122,025	175,331



FRONT ENTRANCE

COMMON AREA





SUITE 350

SPACE AVAILABLE: 12,147 RSF
LEASE RATE: \$20.00 FSG

SUITE HIGHLIGHTS:

- Kitchenette
- 12 Executive perimeter offices
- 1 Large conference room
- 3 Breakout rooms or additional offices
- Approximately 46 workstations
- Tenant Improvement allowance negotiable

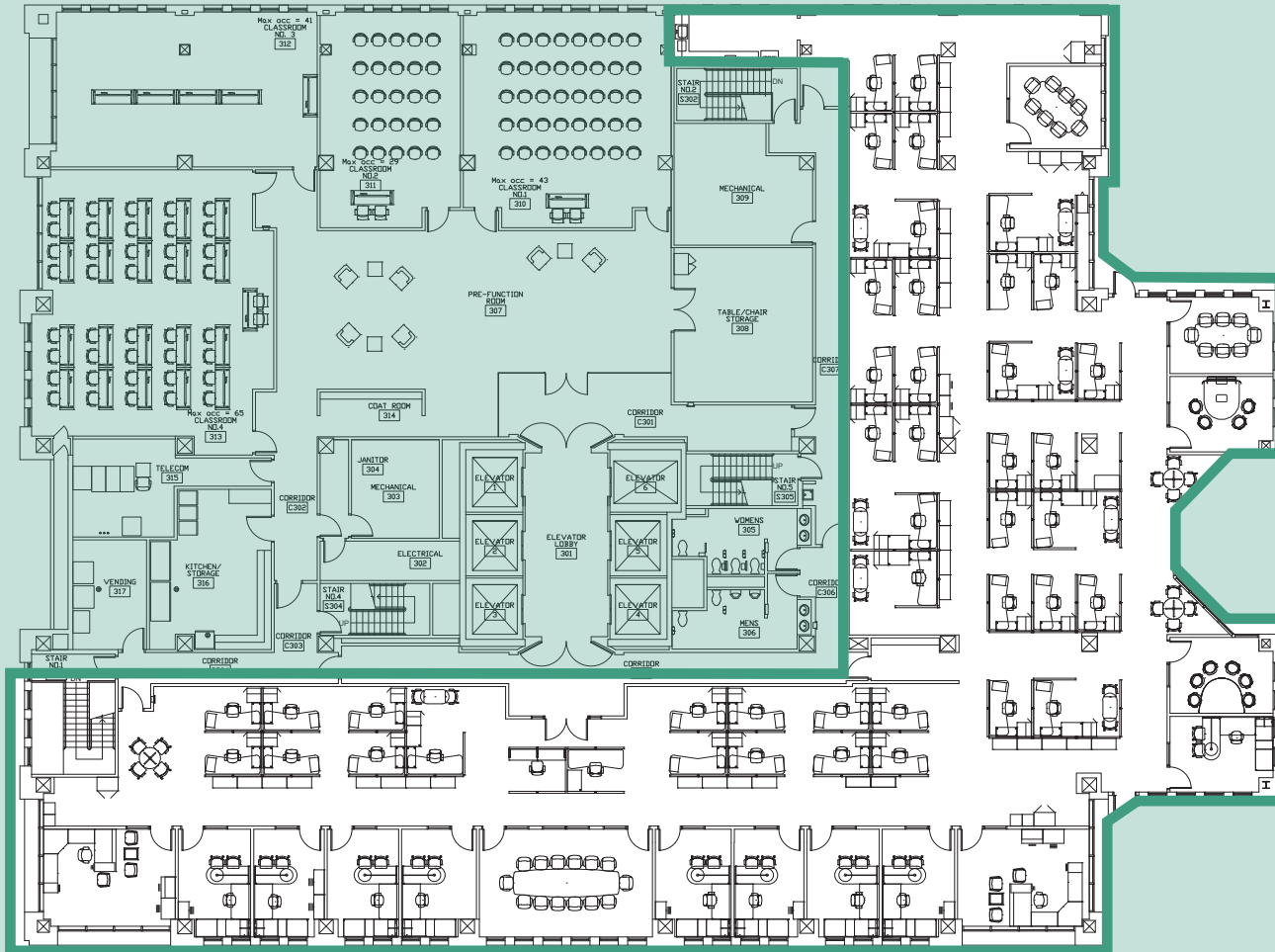

5TH FLOOR

SPACE AVAILABLE: 16,533 RSF
LEASE RATE: \$20.00 FSG

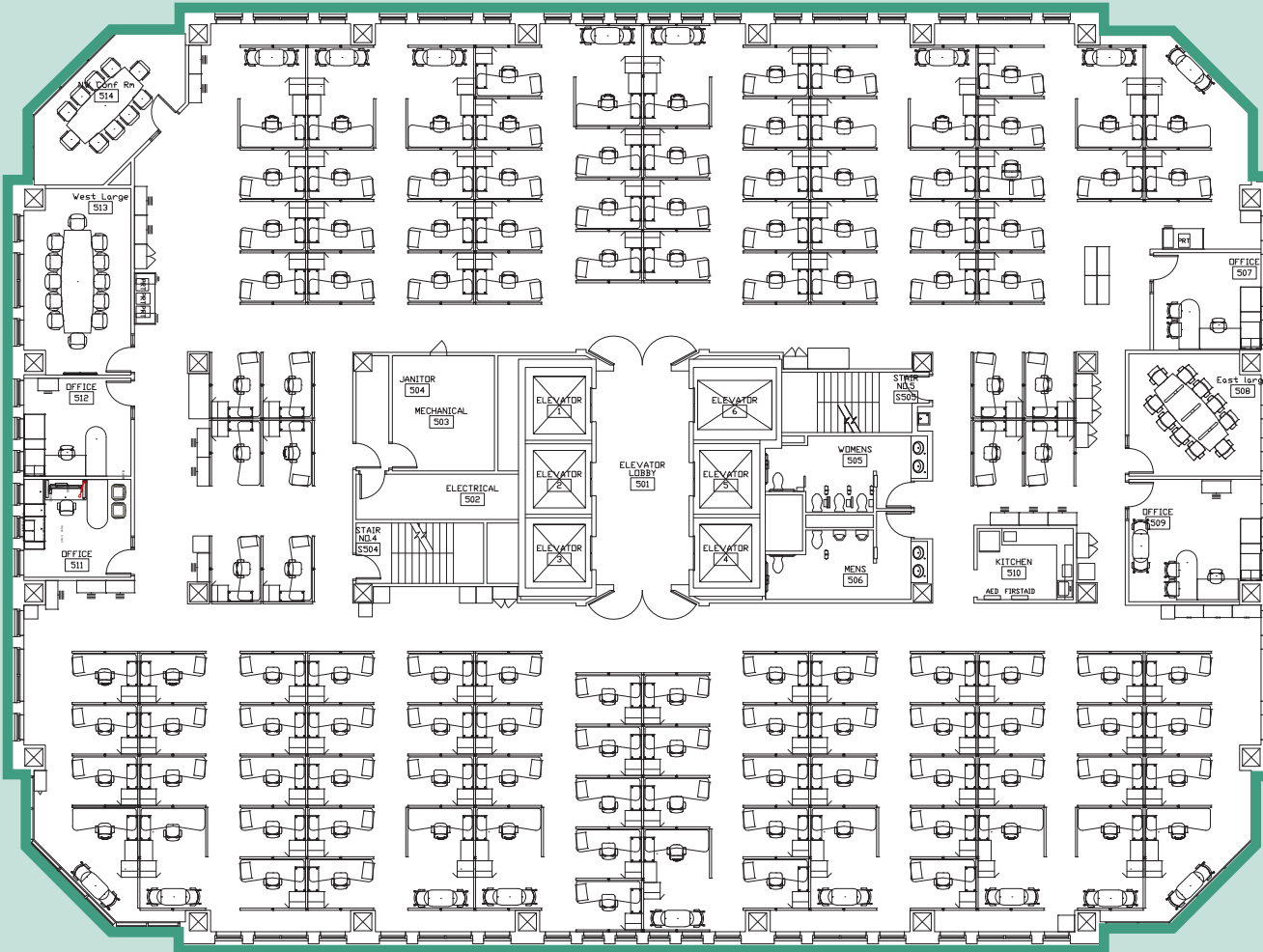

SUITE HIGHLIGHTS:

- Private his/hers restrooms
- 4 Executive offices
- 3 Large conference rooms
- Kitchenette
- 100+ Work station capacity
- Open floor layout
- Tenant Improvement allowance negotiable

SUITE 900

SPACE AVAILABLE: 16,533 RSF
LEASE RATE: \$20.00 FSG

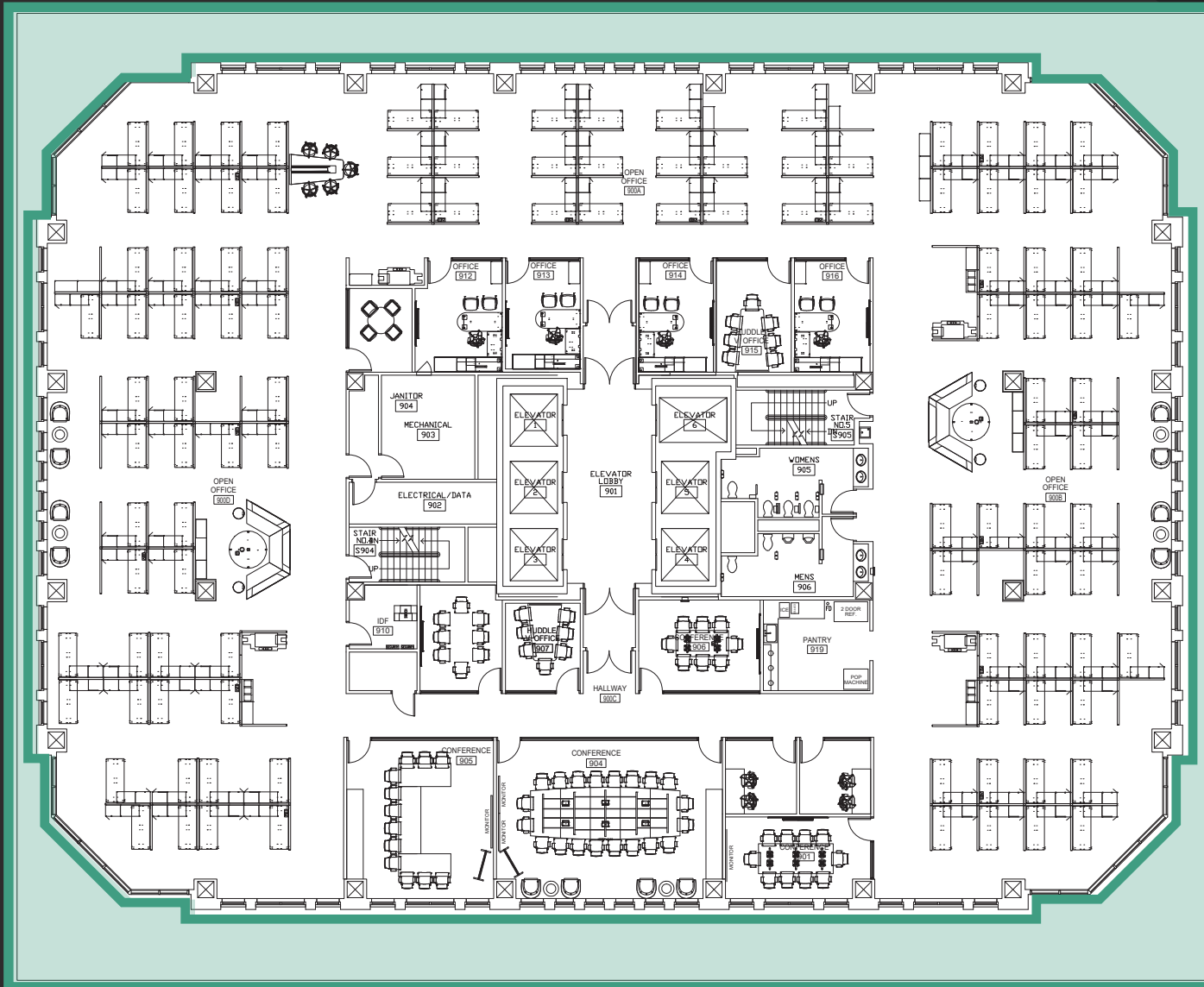

SUITE HIGHLIGHTS:

- Pantry/kitchenette
- 11 Interior offices or huddle rooms
- 4 Different sized conference rooms
- Open space available with abundant natural light
- Private his/hers restrooms
- Tenant Improvement allowance negotiable

SUITE 1000

SPACE AVAILABLE: 16,533 RSF
LEASE RATE: \$20.00 FSG

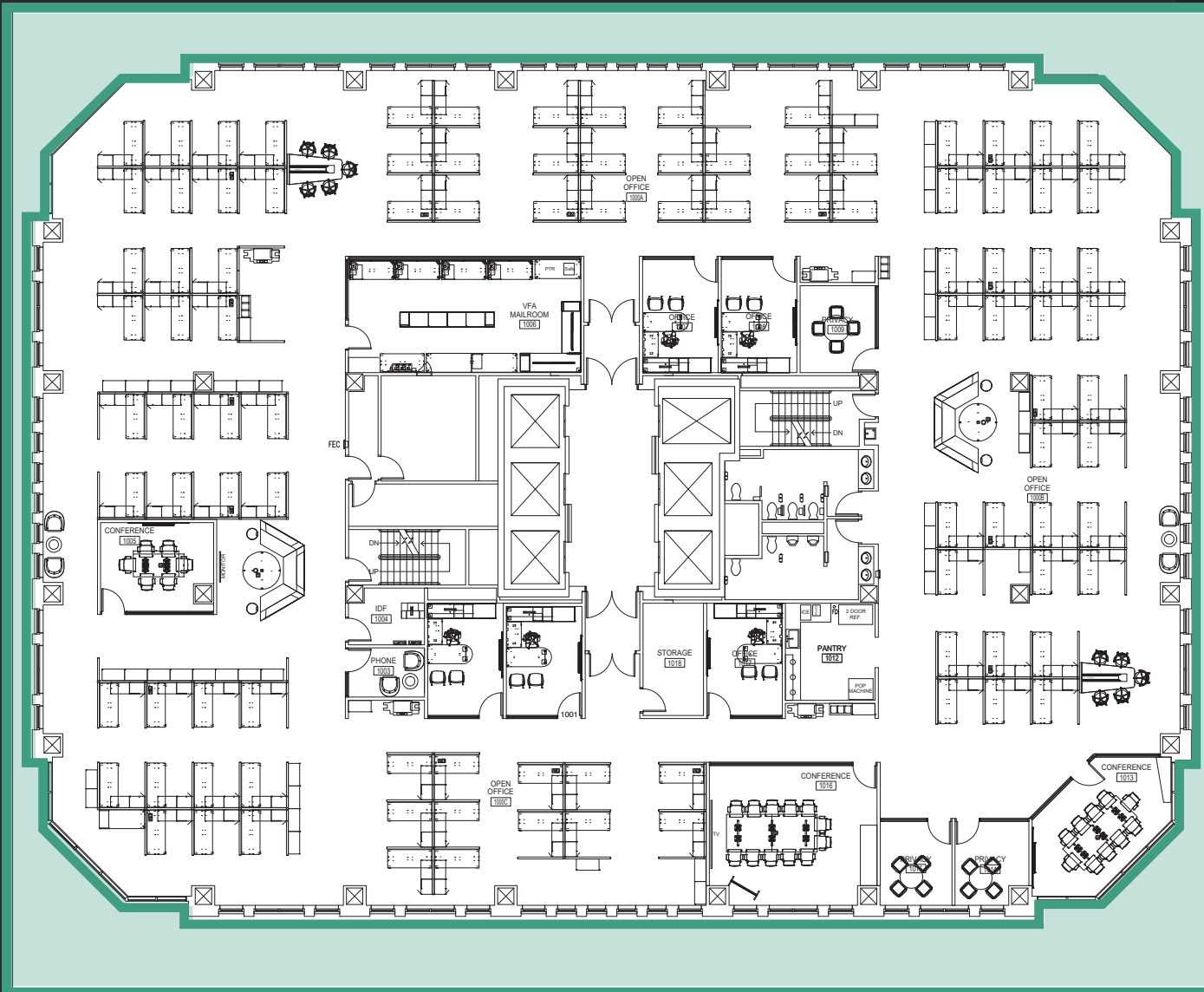

SUITE HIGHLIGHTS:

- Pantry/kitchenette
- 5 Interior offices
- 4 Privacy rooms/offices
- 3 Large conference rooms
- Mailroom
- Storage
- Data closet
- Open space available with abundant natural light
- Private his/hers restrooms
- Tenant Improvement allowance negotiable

SUITE 1200

SPACE AVAILABLE: 9,277 RSF
LEASE RATE: \$20.00 FSG

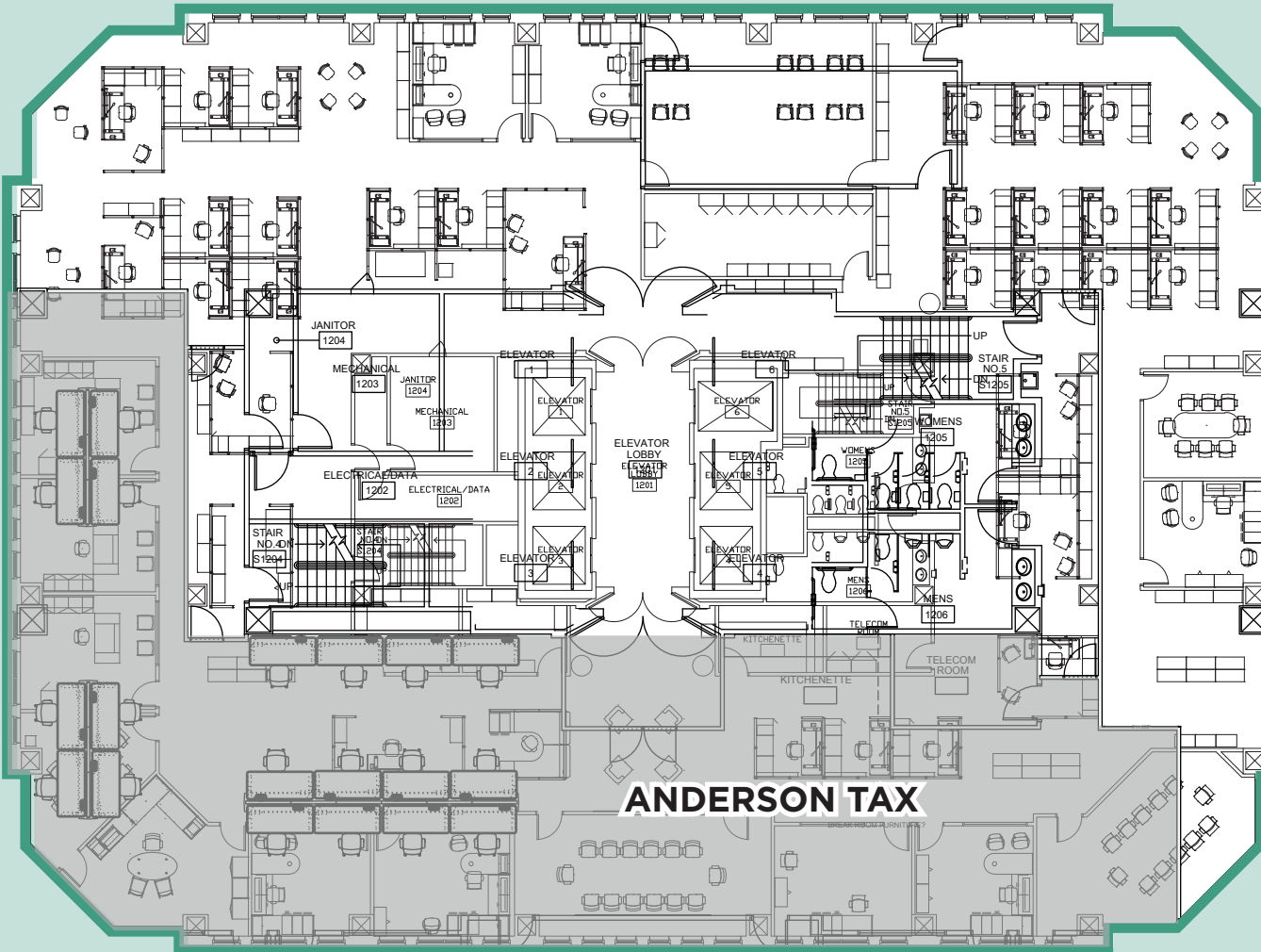

SUITE HIGHLIGHTS:

- 4 Perimeter offices
- 1 Large conference room
- Open space available with abundant natural light
- Tenant Improvement allowance negotiable

13TH FLOOR

SPACE AVAILABLE:

Suite 1320: Lease Pending

Suite 1350: 6,080 RSF

LEASE RATE: \$20.00 FSG

SUITE 1320 HIGHLIGHTS:

- 3 Private offices
- Data room
- Large storage closet
- Reception area
- Space available with abundant natural light
- Tenant Improvement allowance negotiable

SUITE 1350 HIGHLIGHTS:

- Large lobby area
- Data closet
- Pantry/kitchenette
- File storage/ storage room
- 4 Large offices
- Large conference room
- Open space available with abundant natural light
- Tenant Improvement allowance negotiable

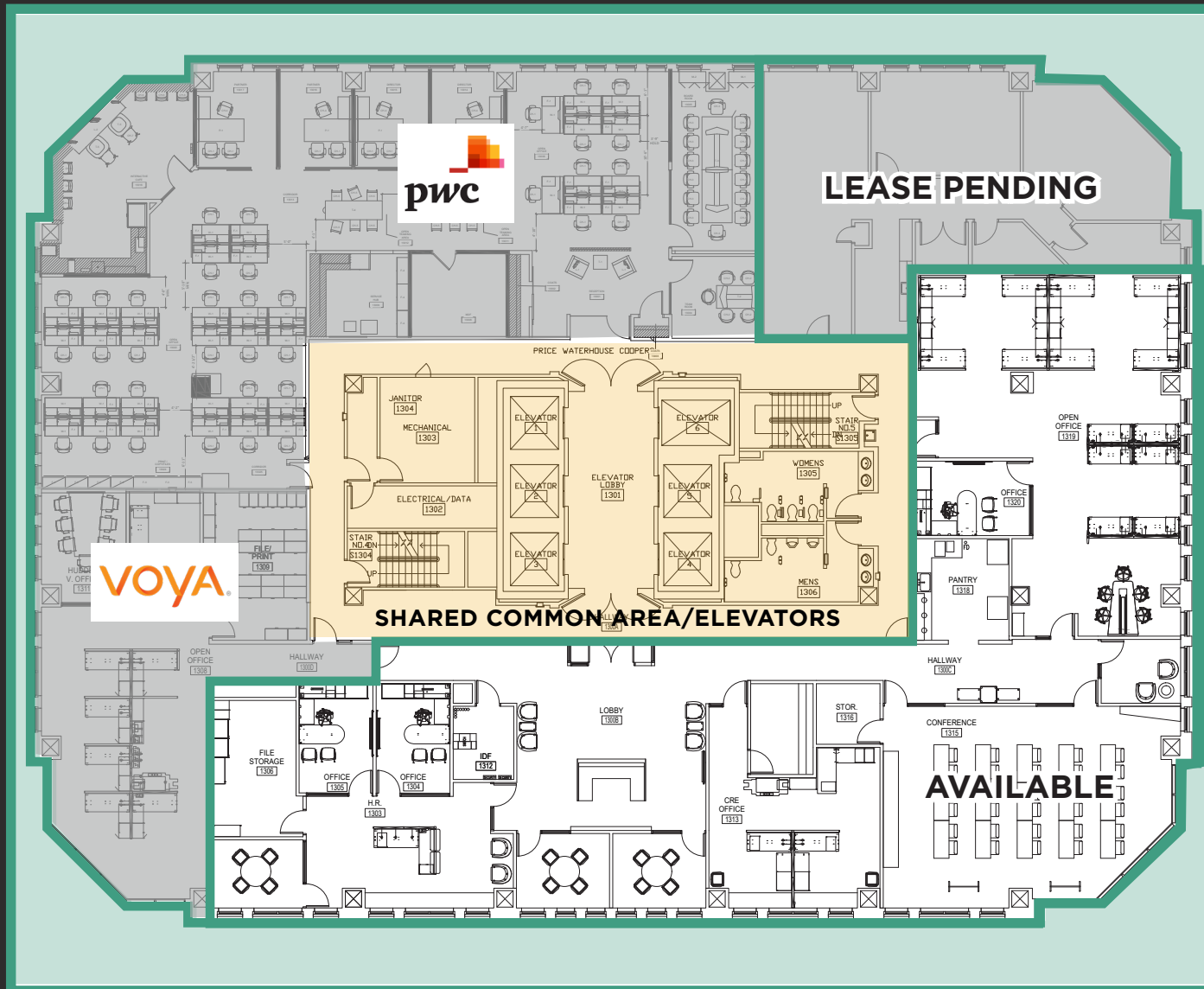

15TH FLOOR

SPACE AVAILABLE: Contiguous 116,533 RSF

Suite 1520: 5,580 RSF

Suite 1500: 10,812 RSF

LEASE RATE: \$20.00 FSG

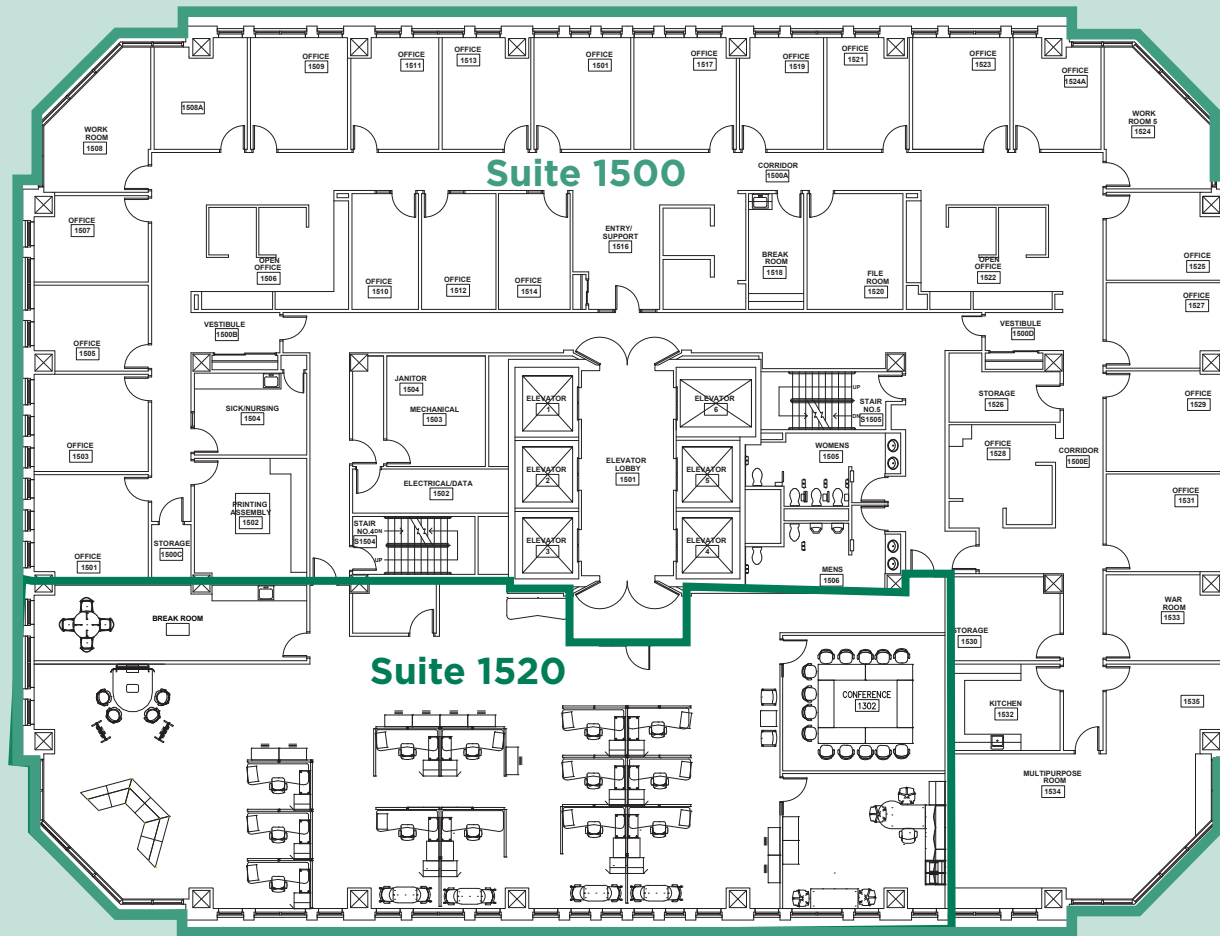

SUITE 1500 HIGHLIGHTS:

- Former law firm space
- 21 Executive perimeter offices
- 3 Interior offices
- Kitchenette
- Break room
- Nursing room
- Mail room
- Data room
- Tenant Improvement allowance negotiable

SUITE 1520 HIGHLIGHTS:

- 2 Executive offices
- Kitchenette/break room
- Open space available with abundant natural light
- Tenant Improvement allowance negotiable

16TH FLOOR

SPACE AVAILABLE: 16,533 RSF
LEASE RATE: \$20.00 FSG

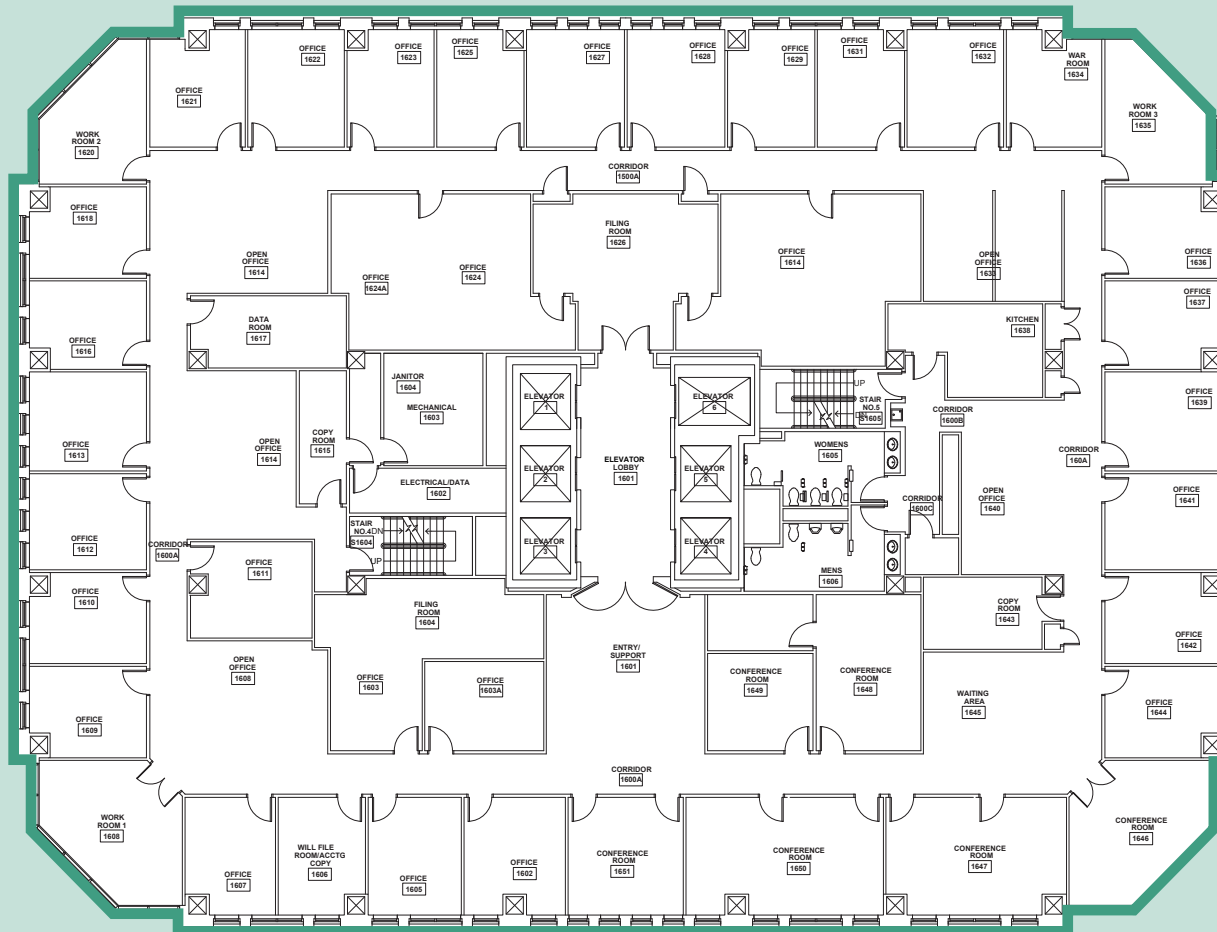

SUITE HIGHLIGHTS:

- Lobby area
- 27 Perimeter offices
- 5 Large conference rooms
- Private his/hers restrooms
- Data room
- Kitchenette
- Several interior office layouts available
- Filing/mail room
- Tenant Improvement allowance negotiable

18TH FLOOR

SPACE AVAILABLE: Contiguous 12,357 RSF

Suite 1850: 4,722 RSF

Suite 1875: 7,635 RSF

LEASE RATE: \$20.00 FSG

SUITE 1850 HIGHLIGHTS:

- Shared common restrooms
- Flexible buildout available
- Open space available with abundant natural light
- Tenant Improvement allowance negotiable

SUITE 1875 HIGHLIGHTS:

- Shared common restrooms
- 5 Executive offices
- Open space available with abundant natural light
- Tenant Improvement allowance negotiable

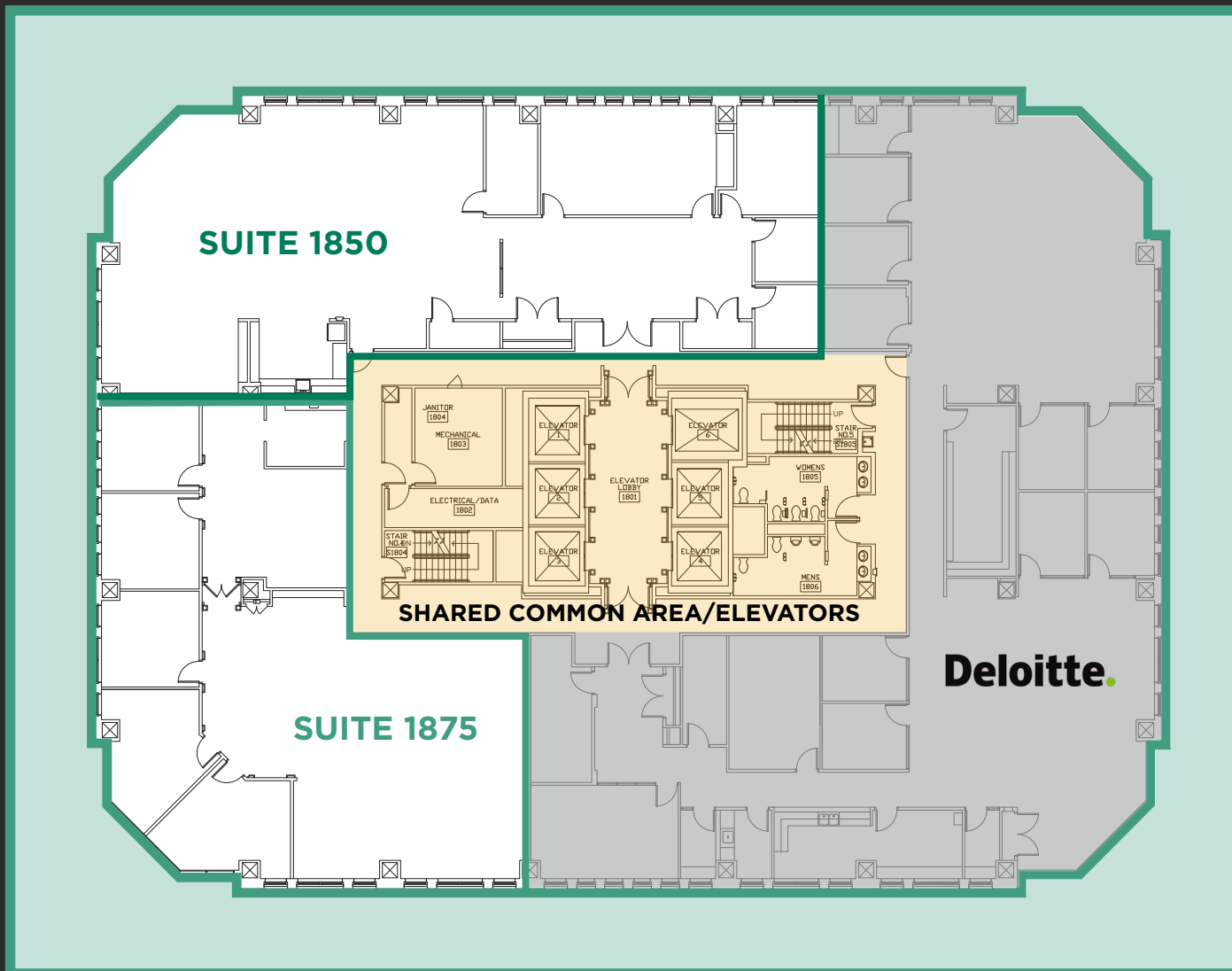

HUB TOWER

CONTACT

JOHN VIGGERS, CCIM, CPM, CRE

Senior Vice President

+1 515 778 2605

jviggers@iowaca.com

MARK E. TIMMINS, J.D.

Vice President

+1 515 988 2765

mtimmins@iowaca.com

JORDAN BOUSLOG

Vice President

+1 515 402 9131

jbouslog@iowaca.com



Iowa Commercial Advisors

3737 Woodland Avenue, Suite 100
West Des Moines, IA 50266
Main +1 515 309 4002
Fax +1 515 309 4040
iowacommercialadvisors.com

VIEW PROPERTY VIDEO

Independently Owned and Operated / A Member of the Cushman & Wakefield Alliance

©2025 Cushman & Wakefield. All rights reserved. The information contained in this communication is strictly confidential. This information has been obtained from sources believed to be reliable but has not been verified. No warranty or representation, express or implied, is made as to the condition of the property (or properties) referenced herein or as to the accuracy or completeness of the information contained herein, and same is submitted subject to errors, omissions, change of price, rental or other conditions, withdrawal without notice, and to any special listing conditions imposed by the property owner(s). Any projections, opinions or estimates are subject to uncertainty and do not signify current or future property performance.