



UNION CROSS INDUSTRIAL CENTER

WINSTON-SALEM, NC



**UP TO ±300,000 SF
AVAILABLE Q3 2026**

Property Features

Adjacent Tenants	Ziehl Abegg, Herbalife, Caterpillar, Bunzl, Southern Carlson, Excel Door
Electric	Duke Energy
Natural Gas	Piedmont Natural Gas
Water	City of Winston-Salem
Sewer	City of Winston-Salem
Telecom	AT&T and Spectrum
Zoning	Light Industrial (LI)

Transportation

- Less than 1 mile to I-40 and less than 2 miles to I-74
- Less than 2 miles to Future Winston Salem Urban Loop interchange via I-40
- 15 minutes from Piedmont Triad International Airport
- 5 Minutes from Smith-Reynolds Airport

Building	4245 Envision Dr Under Construction	Building #6 Proposed	Building #7 Proposed
Total SF	±300,000 SF	±270,000 SF	±50,000 SF
Acres	±21.70	±27.02	±12.80
Parking	±130	±316	±68
Lease Rate	Call for Rate	Call for Rate	Call for Rate
TICAM	TBD	TBD	TBD
Zoning	LI	LI	LI
Clear Height	36'	36'	28'
Loading	±54 Docks	±43 Docks	±10 Docks
Drive-In Doors	TBD	TBD	TBD
Column Spacing	50 x 50	50 x 50	50 x 50
Electrical Service	TBD	TBD	TBD

CORPORATE NEIGHBORS



FUTURE WINSTON SALEM LOOP

BUILDING 7



BUILDING 6



4245 ENVISION DR



Ridgewood Rd

High Point Rd

Glenn Hill Rd

Temple School Rd

Union Cross Rd

High Point Rd

Union Cross Rd

SITE PLAN

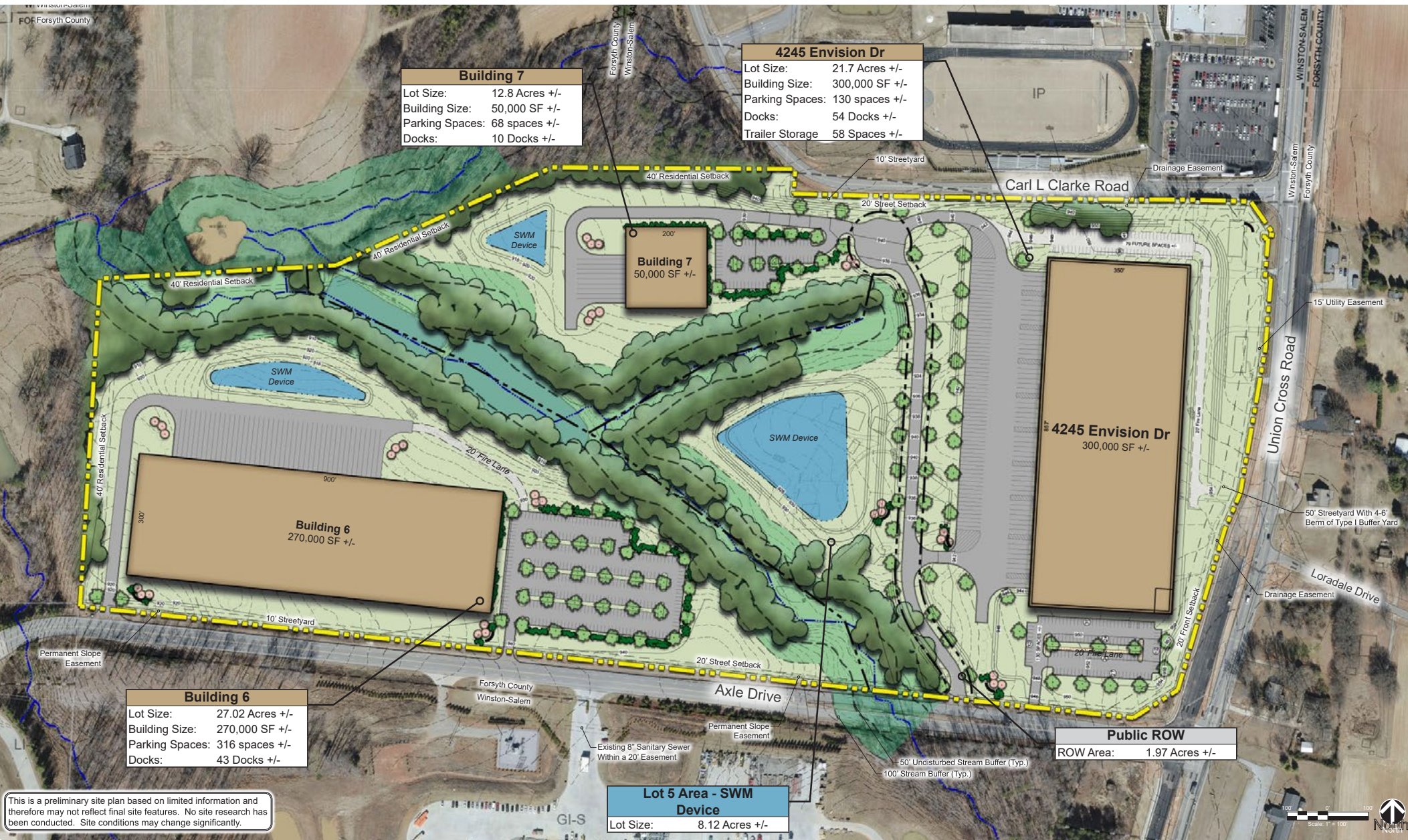

This is a preliminary site plan based on limited information and therefore may not reflect final site features. No site research has been conducted. Site conditions may change significantly.

Property Overview

- Electrical, water/sewage, natural gas, and telecommunication infrastructure onsite.
- Phase I ESA, wetlands delineation, threatened and endangered species study, historical and archaeological survey, and geotechnical assessments have been completed.

Location Overview

- 100 miles west of Raleigh and 80 miles northeast of Charlotte.
- Winston-Salem is Forsyth's largest city and North Carolina's 5th largest in population.
- Companies with HQs in Winston-Salem include Hanesbrands, Truliant Federal Credit Union, Novant Health, Reynolds American and others.
- Winston-Salem is home to Wake Forest University, Winston-Salem State University, UNC School of the Arts and Salem College.

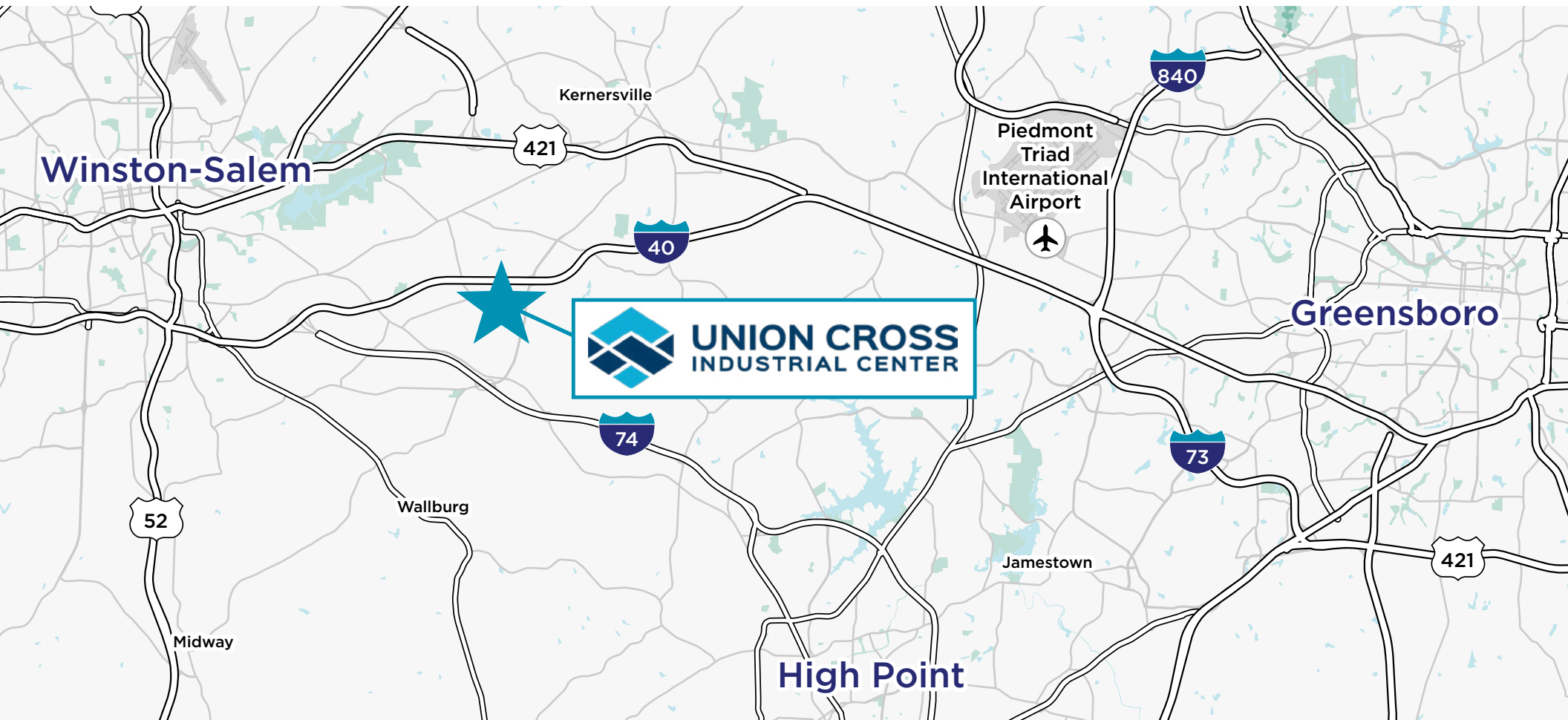



**For More Information,
Please Contact:**

Jason Ofsanko
Executive Director
+1 336 812 3300
jason.ofsanko@cushwake.com

Bobby Finch
Executive Managing Director
+1 336 812 3303
bobby.finch@cushwake.com

©2026 Cushman & Wakefield. All rights reserved. The information contained in this communication is strictly confidential. This information has been obtained from sources believed to be reliable but has not been verified. NO WARRANTY OR REPRESENTATION, EXPRESS OR IMPLIED, IS MADE AS TO THE CONDITION OF THE PROPERTY (OR PROPERTIES) REFERENCED HEREIN OR AS TO THE ACCURACY OR COMPLETENESS OF THE INFORMATION CONTAINED HEREIN, AND SAME IS SUBMITTED SUBJECT TO ERRORS, OMISSIONS, CHANGE OF PRICE, RENTAL OR OTHER CONDITIONS, WITHDRAWAL WITHOUT NOTICE, AND TO ANY SPECIAL LISTING CONDITIONS IMPOSED BY THE PROPERTY OWNER(S). ANY PROJECTIONS, OPINIONS OR ESTIMATES ARE SUBJECT TO UNCERTAINTY AND DO NOT SIGNIFY CURRENT OR FUTURE PROPERTY PERFORMANCE.