

**1819 TURNING BASIN DRIVE, SUITE 900**  
**HOUSTON, TX 77029**



**25,368 SF | FOR LEASE**

The property 1819 Turning Basin Drive is an ideal dock-high, front-load industrial facility for distribution users in Houston's Inner East submarket. The Property has tremendous ingress/ egress to/from the 610 Loop with dedicated on/off ramps and is located two miles south of 1-10, which offers convenient access to the Port of Houston.

### PROPERTY SPECIFICATIONS

Available Space:	25,368 SF
Office Space:	1,278 SF
Total Building Size:	65,494 SF
Submarket:	Southeast Houston
Ceiling Height:	18'
Dock High Doors:	9
Ramps:	1
Sprinkler:	Non-ESFR

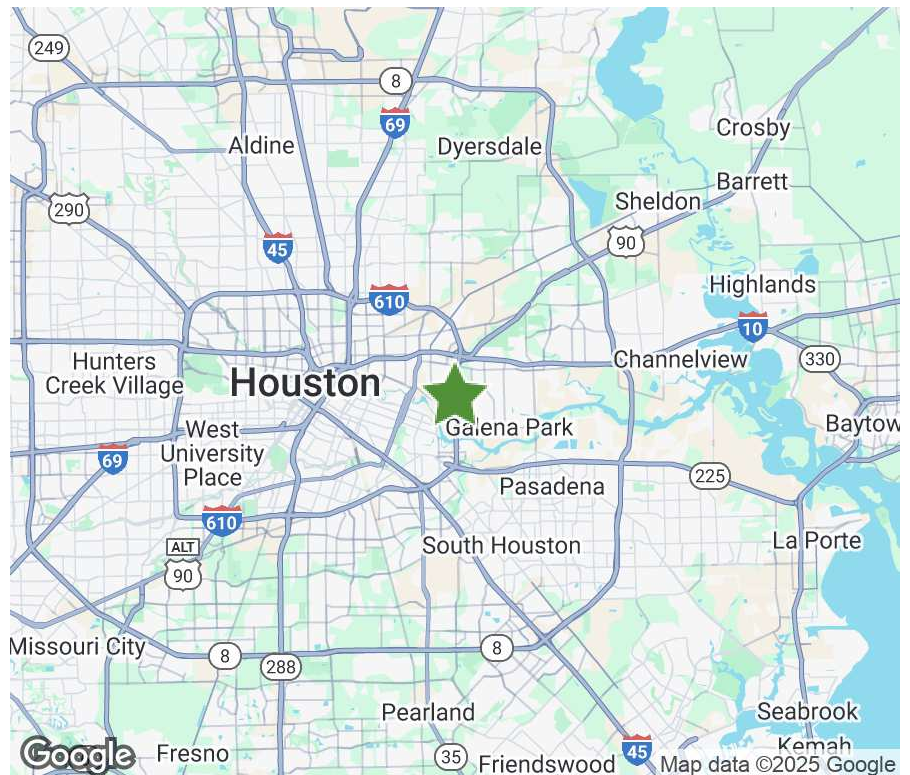

# 1819 TURNING BASIN DRIVE, SUITE 900

25,368 SF | FOR LEASE

## FLOOR PLAN

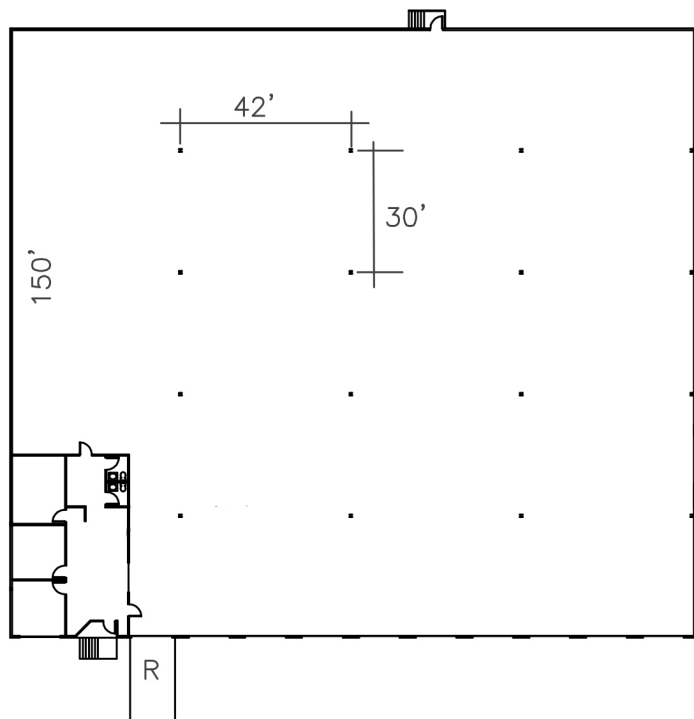

**Suite 900**  
25,368 S.F. Total / 1,278 S.F. Office Area

## BROKER CONTACT

### David Munson, SIOR

Cushman & Wakefield  
713.913.5473  
david.munson@cushwake.com

### Garrett Thomas

Cushman & Wakefield  
713.260.0244  
Garrett.Thomas@cushwake.com



## OWNER CONTACT

### Jake Allen

Regional Manager  
312.344.4331  
jallen@FIRT.com

