



RENT STARTING AT \$4.00 PSF

FOR LEASE
3700 - 78 AVENUE SE
CALGARY, AB



3700 - 78 AVENUE SE

CALGARY, AB

Property Details

District:	Foothills
Zoning:	I-G (Industrial General)
Parking:	Ample - at no cost
Year Built:	1980
Building Class:	B
Available:	Immediately

Comments

- Ample free parking
- Excellent access to Barlow, Glenmore and Deerfoot Trail
- Close proximity to retail amenities



Lease Particulars

Suite 225:	957 SF
Suite 237:	1,202 SF
Suite 260:	2,902 SF
Asking Rate:	\$4.00 PSF with escalations
Op. Costs:	\$10.18 PSF (2025 est.) (excludes in-suite janitorial and waste removal)



3700 - 78 AVENUE SE
CALGARY, AB

Second Floor Plan

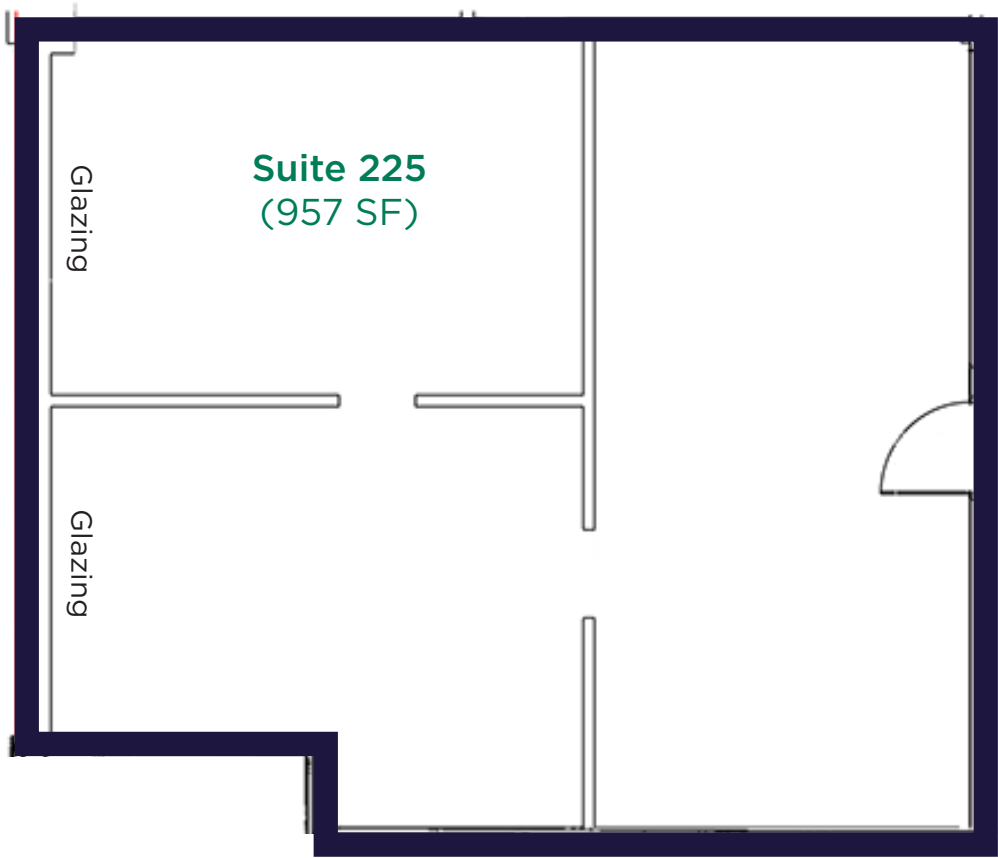

*Not to scale, not exactly as shown.

3700 - 78 AVENUE SE CALGARY, AB

Second Floor Plan

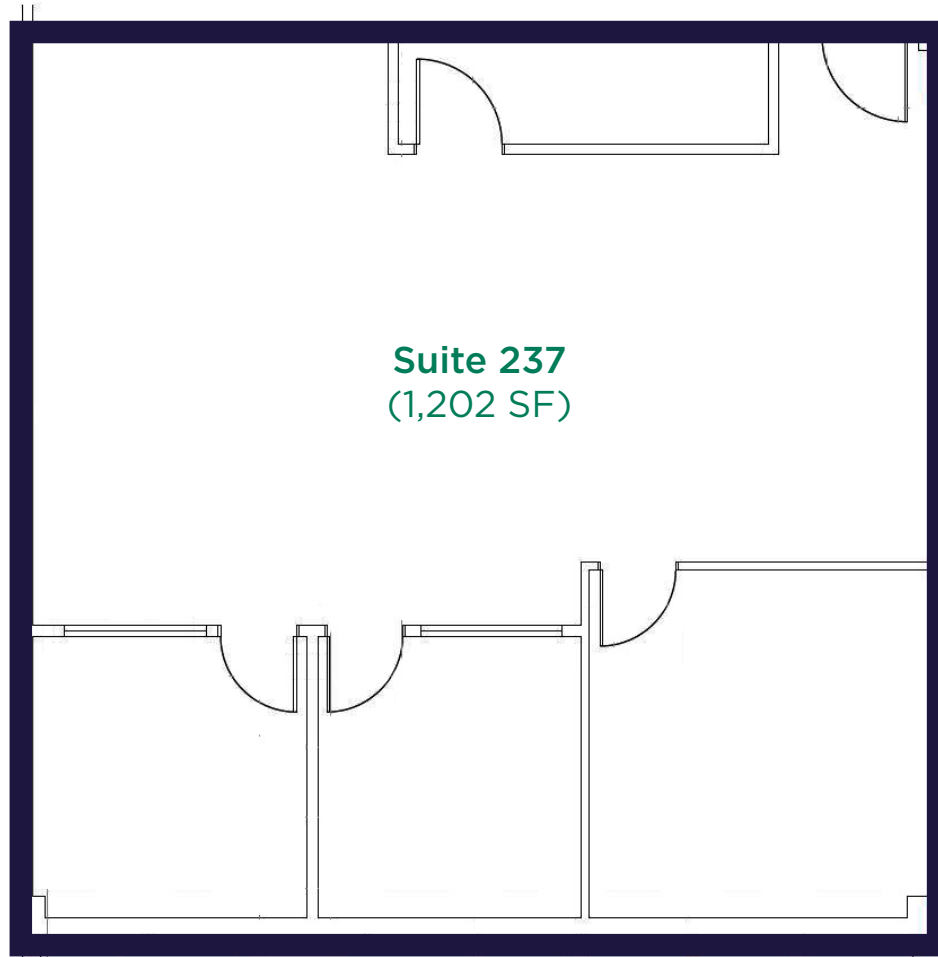

*Not to scale, not exactly as shown.

3700 - 78 AVENUE SE
CALGARY, AB

Second Floor Plan

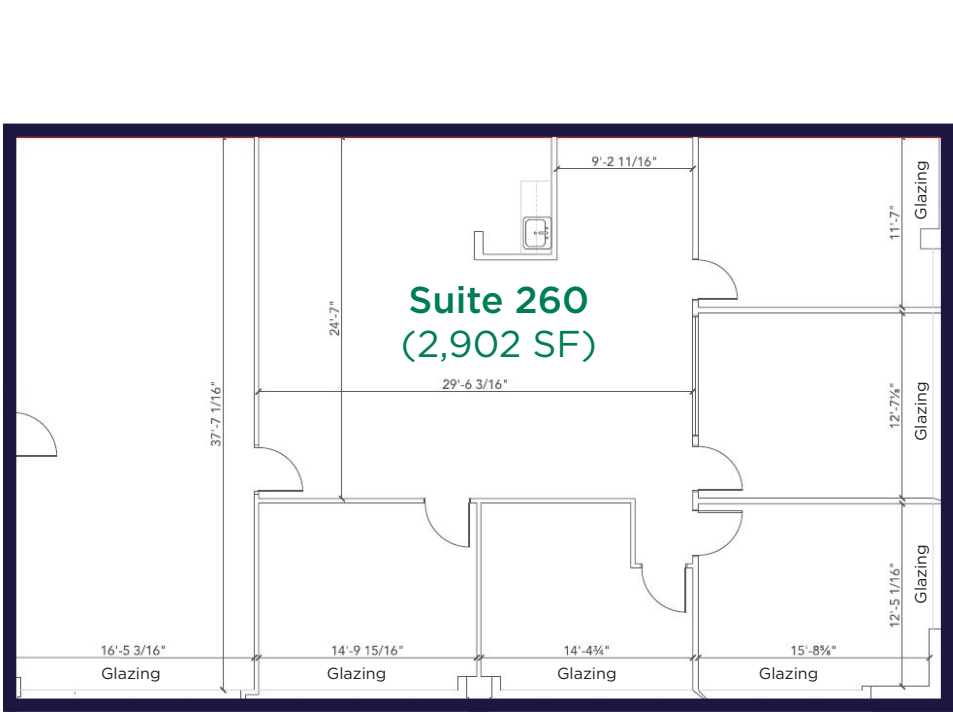

*Not to scale, not exactly as shown.

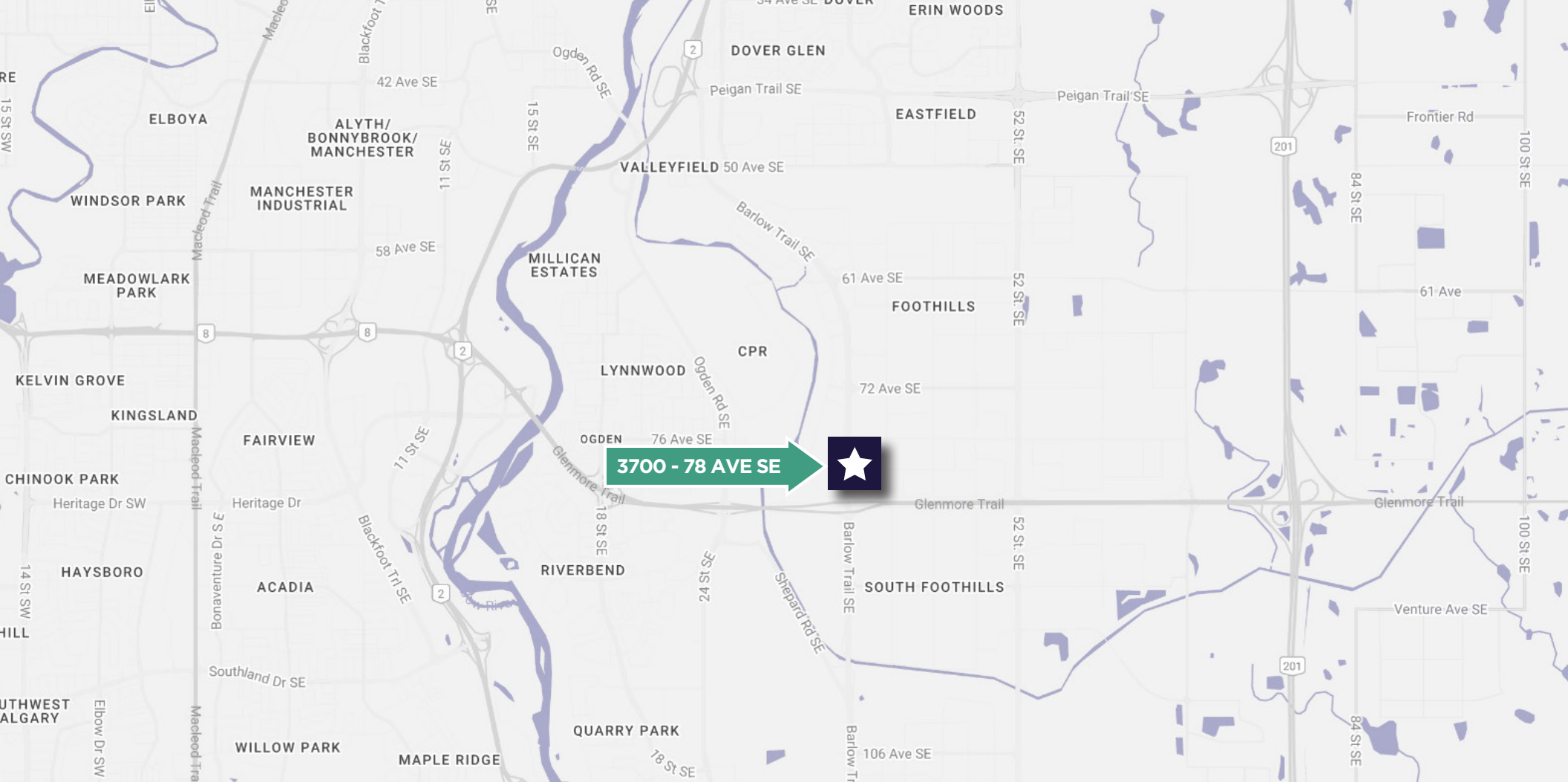

FOR MORE INFORMATION, CONTACT

SEAN FERGUSON
Associate Vice President
Industrial Sales & Leasing
+1 403 615 1893
sean.ferguson@cushwake.com

ALAN FARLEY
Associate Vice President
Industrial Sales & Leasing
+1 403 797 5024
alan.farley@cushwake.com

Cushman & Wakefield ULC
Bow Valley Square IV
250 - 6th Ave SW, Suite 2400
Calgary, AB T2P 3H7
cushmanwakefield.com

©2025 Cushman & Wakefield. All rights reserved. The information contained in this communication is strictly confidential. This information has been obtained from sources believed to be reliable but has not been verified. NO WARRANTY OR REPRESENTATION, EXPRESS OR IMPLIED, IS MADE AS TO THE CONDITION OF THE PROPERTY (OR PROPERTIES) REFERENCED HEREIN OR AS TO THE ACCURACY OR COMPLETENESS OF THE INFORMATION CONTAINED HEREIN, AND SAME IS SUBMITTED SUBJECT TO ERRORS, OMISSIONS, CHANGE OF PRICE, RENTAL OR OTHER CONDITIONS, WITHDRAWAL WITHOUT NOTICE, AND TO ANY SPECIAL LISTING CONDITIONS IMPOSED BY THE PROPERTY OWNER(S). ANY PROJECTIONS, OPINIONS OR ESTIMATES ARE SUBJECT TO UNCERTAINTY AND DO NOT SIGNIFY CURRENT OR FUTURE PROPERTY PERFORMANCE.

