



2ND FLOOR OFFICE SPACES AVAILABLE



# Emerald Flex Building

9543 West Emerald Street  
Boise, Idaho 83704

652 TO 3,678 SF

## PROPERTY HIGHLIGHTS

Suite 204	2,886 SF
Suite 205	652 SF
Combined	3,678 SF (Hallway included)
Lease Rate	\$18.00/SF FSEJ
Total Building	23,356 SF
Lot Size	1.528 Acres
Zoning	City-of-Boise M-1D
Amenities	Fiber Optic Internet Service, New Elevator, Easy I84 Access, Near Boise Towne Square Mall
Parking	Ample - On-Site Parking
LockBox	Yes, On Vacant Suites



### BREE WELLS

Director  
Office | Capital Markets  
+1 208 287 9492  
bree.wells@cushwake.com

### JENNIFER MCENTEE

Senior Director  
Office | Capital Markets  
+1 208 287 9495  
jennifer.mcentee@cushwake.com

### BRAYDON TORRES

Associate  
Office | Capital Markets  
+1 208 207 9485  
braydon.torres@cushwake.com

999 W MAN ST. SUITE 1300, BOISE, IDAHO 83702  
CUSHMANWAKEFIELD.COM

©2025 Cushman & Wakefield. All rights reserved. The information contained in this communication is strictly confidential. This information has been obtained from sources believed to be reliable but has not been verified. No warranty or representation, express or implied, is made as to the condition of the property (or properties) referenced herein or as to the accuracy or completeness of the information contained herein, and same is submitted subject to errors, omissions, change of price, rental or other conditions, withdrawal without notice, and to any special listing conditions imposed by the property owner(s). Any projections, opinions or estimates are subject to uncertainty and do not signify current or future property performance.



# Emerald Flex Building Space

9543 West Emerald Street, Boise, Idaho 83704

562 TO 3,678 SF FOR LEASE



## SECOND FLOOR LAYOUT

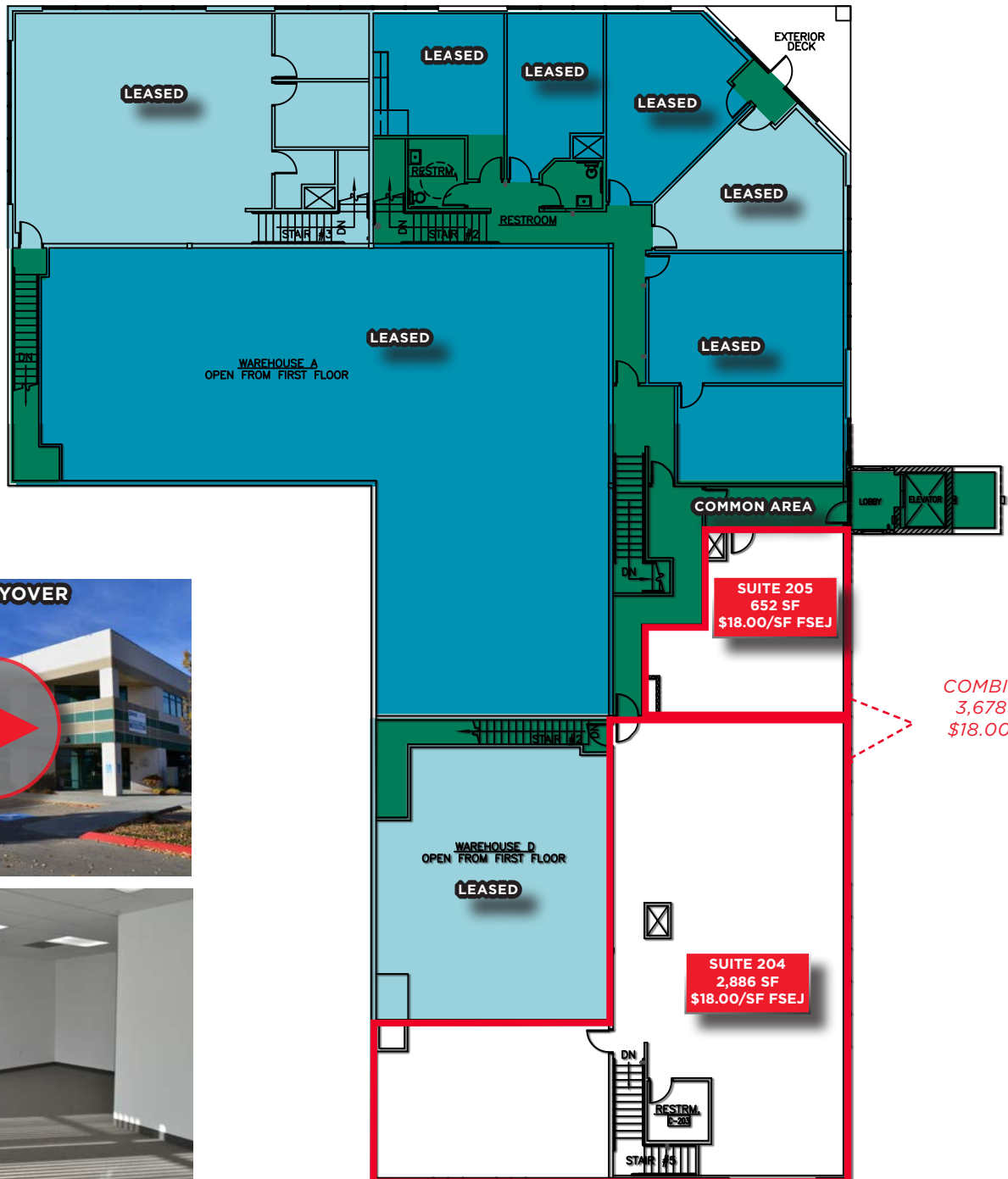



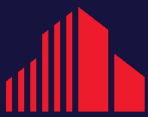

CUSHMAN &  
WAKEFIELD

# Emerald Flex Building Space

9543 West Emerald Street, Boise, Idaho 83704

396 TO 3,678 SF FOR LEASE



## AERIAL/LOCATION MAP

