

FOR LEASE

SOUTHGATE SHOPPING CENTRE

45905 YALE ROAD, CHILLIWACK, BC

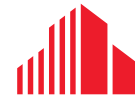

CUSHMAN &
WAKEFIELD



3 SPACES AVAILABLE:

1,254 SF - FULLY FIXTURED RESTAURANT

1,883 SF - FULLY FIXTURED MEDICAL CLINIC

2,500 SF/C4 ZONE - SHOPPING CENTRE

#41 1,254 SF



#36 2,500 SF



#50 1,883 SF



1,592

NUMBER OF
BUSINESSES
within 3 km



19,557

2020 DAYTIME WORKING
POPULATION ESTIMATE
within 3 km



42.6

MEDIAN AGE
within 3 km



\$70,293

AVERAGE
HOUSEHOLD INCOME
within 5 km



DRIVE TIMES

TRANS CANADA HIGHWAY
(HWY 1)

7 MINUTES

Eric Walker

Associate Vice President

+1 604 608 5998

eric.walker@cushwake.com

Suite 1200 - 700 West Georgia Street

PO Box 10023, Pacific Centre

Vancouver, BC V7Y 1A1

+1 604 683 3111

cushmanwakefield.ca

E.&O.E.: This communication is not intended to cause or induce breach of an existing agency agreement. The information contained herein was obtained from sources which we deem reliable and, while thought to be correct, is not guaranteed by Cushman & Wakefield ULC PRJ0628173 (04/23/bg)

©2025 Cushman & Wakefield. All rights reserved. The information contained in this communication is strictly confidential. This information has been obtained from sources believed to be reliable but has not been verified. NO WARRANTY OR REPRESENTATION, EXPRESS OR IMPLIED, IS MADE AS TO THE CONDITION OF THE PROPERTY (OR PROPERTIES) REFERENCED HEREIN OR AS TO THE ACCURACY OR COMPLETENESS OF THE INFORMATION CONTAINED HEREIN, AND SAME IS SUBMITTED SUBJECT TO ERRORS, OMISSIONS, CHANGE OF PRICE, RENTAL OR OTHER CONDITIONS, WITHDRAWAL WITHOUT NOTICE, AND TO ANY SPECIAL LISTING CONDITIONS IMPOSED BY THE PROPERTY OWNER(S). ANY PROJECTIONS, OPINIONS OR ESTIMATES ARE SUBJECT TO UNCERTAINTY AND DO NOT SIGNIFY CURRENT OR FUTURE PROPERTY PERFORMANCE.

FOR LEASE

SOUTHGATE SHOPPING CENTRE

45905 YALE ROAD, CHILLIWACK, BC

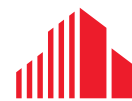

CUSHMAN &
WAKEFIELD

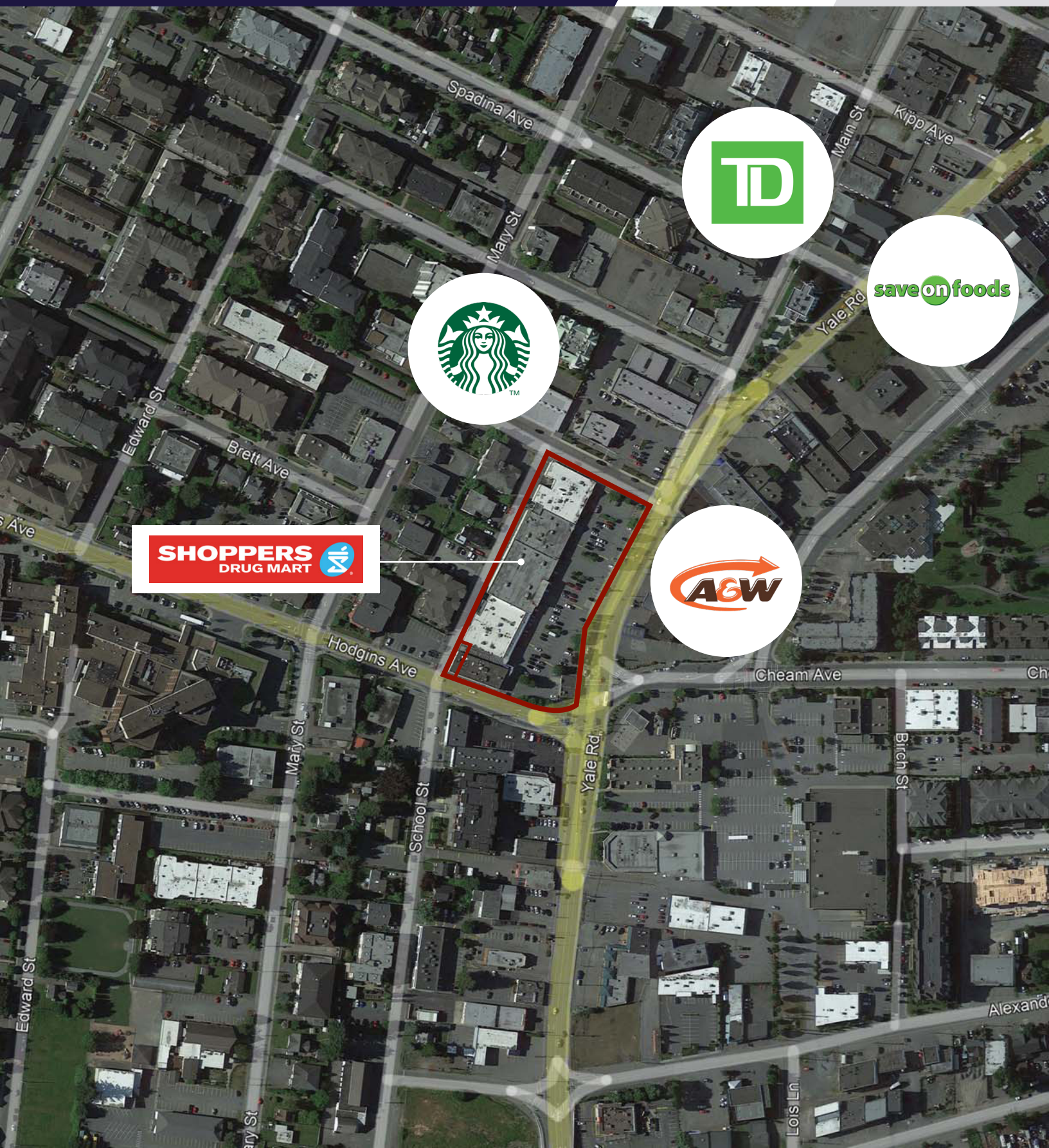

save on foods

SHOPPERS
DRUG MART



FOR LEASE

SOUTHGATE SHOPPING CENTRE

45905 YALE ROAD, CHILLIWACK, BC

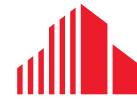

CUSHMAN &
WAKEFIELD

SITE PLAN

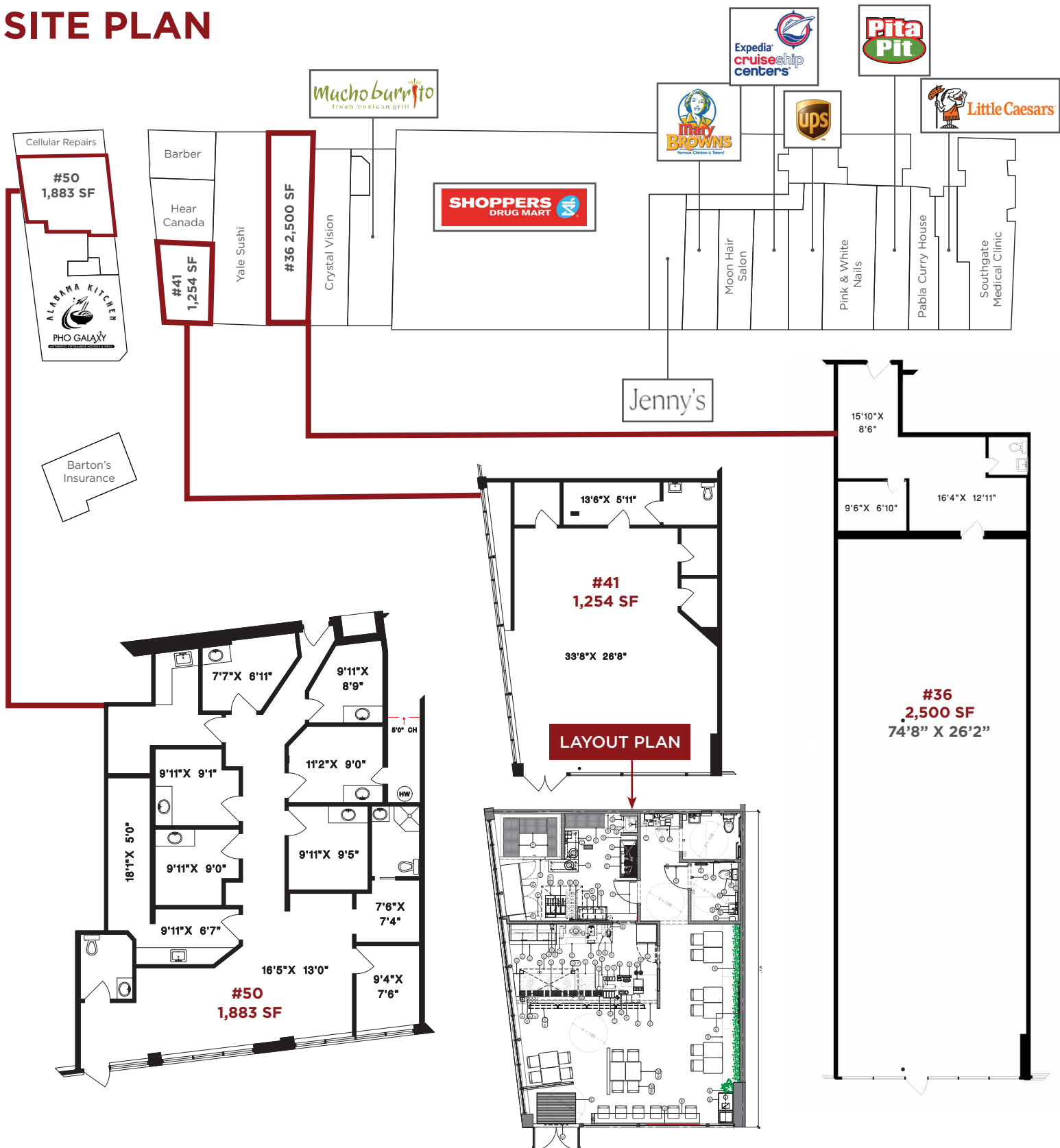

FOR LEASE

SOUTHGATE SHOPPING CENTRE

45905 YALE ROAD, CHILLIWACK, BC

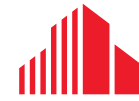

CUSHMAN &
WAKEFIELD

AVAILABLE	AREA	RENT	ADDITIONAL RENT	GROSS MONTHLY OCCUPANCY COSTS
UNIT 36	2,500 SF	Starting at \$30.00 psf, net	\$14.75 psf Property Mgmt: 5% of RENT	\$9,635.42 (before GST & Utilities)
UNIT 41	1,254 SF	Starting at \$35.00 psf, net	\$14.75 psf Property Mgmt: 5% of RENT	\$5,467.58 (before GST & Utilities)
UNIT 50	1,883 SF	Starting at \$19.00 psf, net	\$14.75 psf Property Mgmt: 5% of RENT	\$5,300.43 (before GST & Utilities)

PYLON SIGN

\$150/month one double-sided panel

ZONING

The **C4 (SHOPPING CENTRE) ZONE** consists of land which, owing to its location adjacent to one or more arterial roads with convenient access is suitable for general and vehicular oriented retail commercial consisting of stores which rely on central common off-street parking, provided within the development.

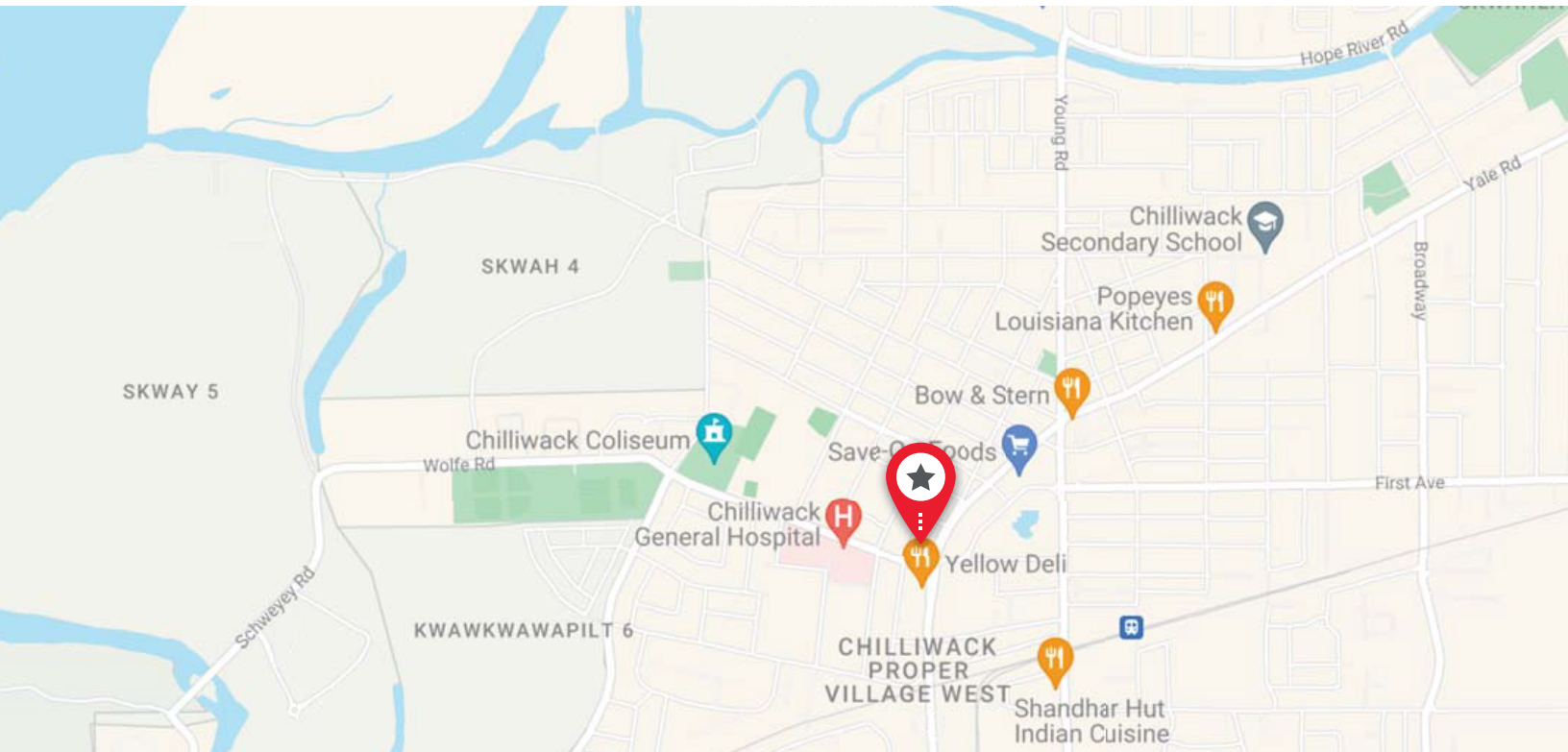

For more information, please contact:

Eric Walker

Associate Vice President
+1 604 608 5998
eric.walker@cushwake.com

Suite 1200-700 West Georgia Street
PO Box 10023, Pacific Centre
Vancouver, BC V7Y 1A1
+1 604 683 3111
cushmanwakefield.ca

E.&O.E.: This communication is not intended to cause or induce breach of an existing agency agreement. The information contained herein was obtained from sources which we deem reliable and, while thought to be correct, is not guaranteed by Cushman & Wakefield ULC PRJ0628173 (04/23/bg)

©2025 Cushman & Wakefield. All rights reserved. The information contained in this communication is strictly confidential. This information has been obtained from sources believed to be reliable but has not been verified. NO WARRANTY OR REPRESENTATION, EXPRESS OR IMPLIED, IS MADE AS TO THE CONDITION OF THE PROPERTY (OR PROPERTIES) REFERENCED HEREIN OR AS TO THE ACCURACY OR COMPLETENESS OF THE INFORMATION CONTAINED HEREIN, AND SAME IS SUBMITTED SUBJECT TO ERRORS, OMISSIONS, CHANGE OF PRICE, RENTAL OR OTHER CONDITIONS, WITHDRAWAL WITHOUT NOTICE, AND TO ANY SPECIAL LISTING CONDITIONS IMPOSED BY THE PROPERTY OWNER(S). ANY PROJECTIONS, OPINIONS OR ESTIMATES ARE SUBJECT TO UNCERTAINTY AND DO NOT SIGNIFY CURRENT OR FUTURE PROPERTY PERFORMANCE.