

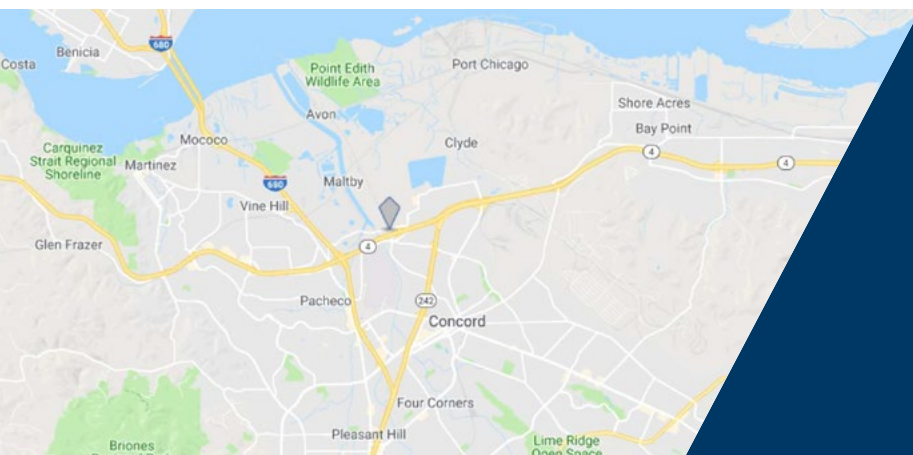

# CONCORD BUSINESS PARK



TONY BINSWANGER, SIOR  
*Executive Director*  
925.627.2482  
[Tony.Binswanger@cushwake.com](mailto:Tony.Binswanger@cushwake.com)  
LIC#01861701

TIM SCHMID  
*Director*  
925.627.2886  
[Tim.Schmid@cushwake.com](mailto:Tim.Schmid@cushwake.com)  
LIC#01847650

BO HARKINS  
*Director*  
925.627.2481  
[Bo.Harkins@cushwake.com](mailto:Bo.Harkins@cushwake.com)  
LIC#01943785

[VIEW SITE SPECIFIC COVID-19 PREVENTION PLAN](#)

Owned by:





# CONCORD BUSINESS PARK

**±141,792 square feet** of high end, well landscaped business park. The park consists of **five (5) concrete tilt-up office/warehouse buildings** that offers a wide range of sizes and configurations with **grade level loading doors**, ample parking/staging with 360 degree park access. Strategically **located near Highway 4** with great visibility, allowing for **quick access to i-680, Highway 4, and 242.**

Owned by:





[\\*Click available space to view floorplans](#)

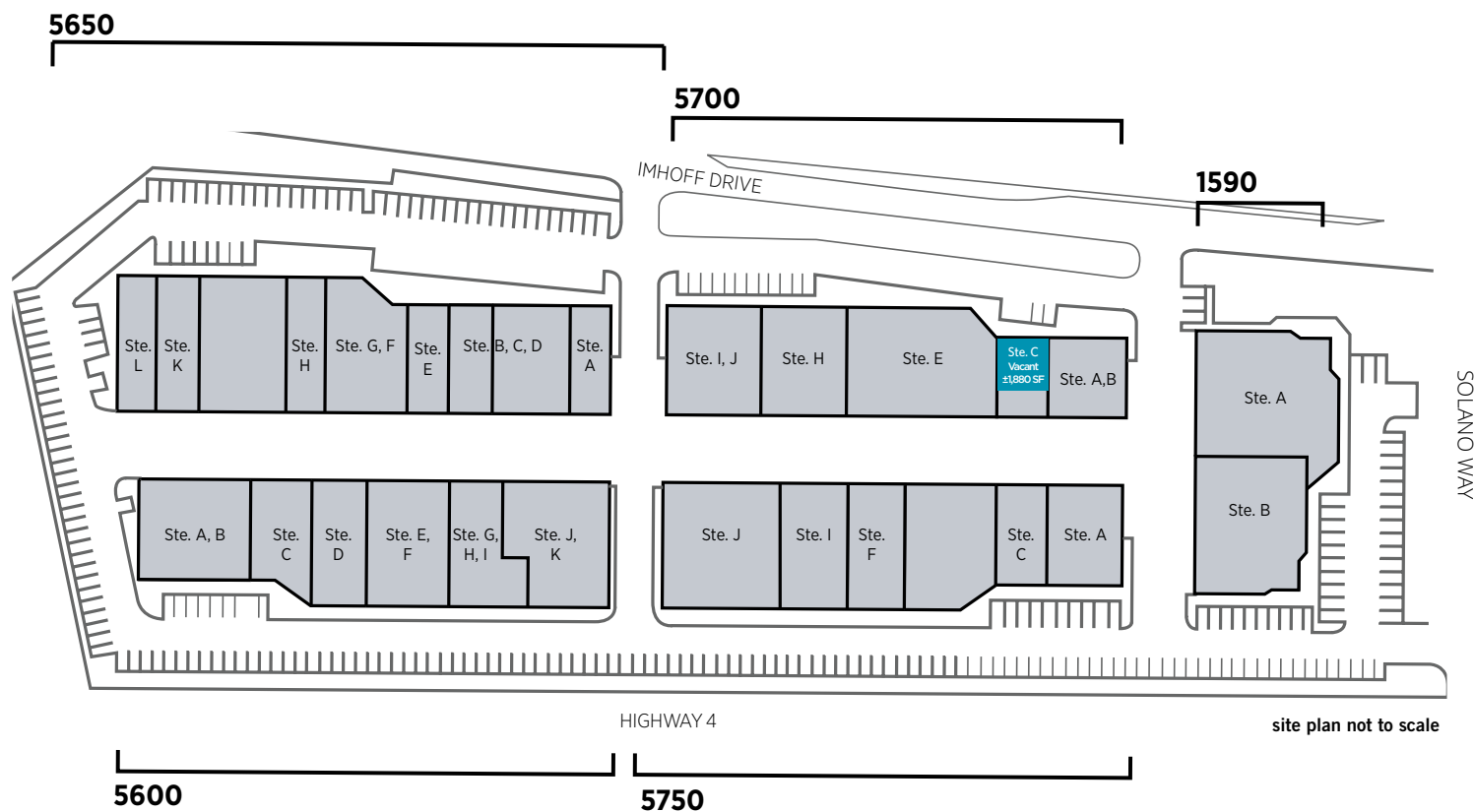

# CONCORD BUSINESS PARK

TONY BINSWANGER, SIOR  
Executive Director  
925.627.2482  
Tony.Binswanger@cushwake.com  
LIC#01861701

TIM SCHMID  
Director  
925.627.2886  
Tim.Schmid@cushwake.com  
LIC#01847650

BO HARKINS  
Director  
925.627.2481  
Bo.Harkins@cushwake.com  
LIC#01943785

Owned by:



## 5700 Imhoff Drive - Suite C

±1,880 SF

- Warehouse Only
- One (1) Grade Level door
- ±16-18' clear height
- 120/208 volt 3 phase power

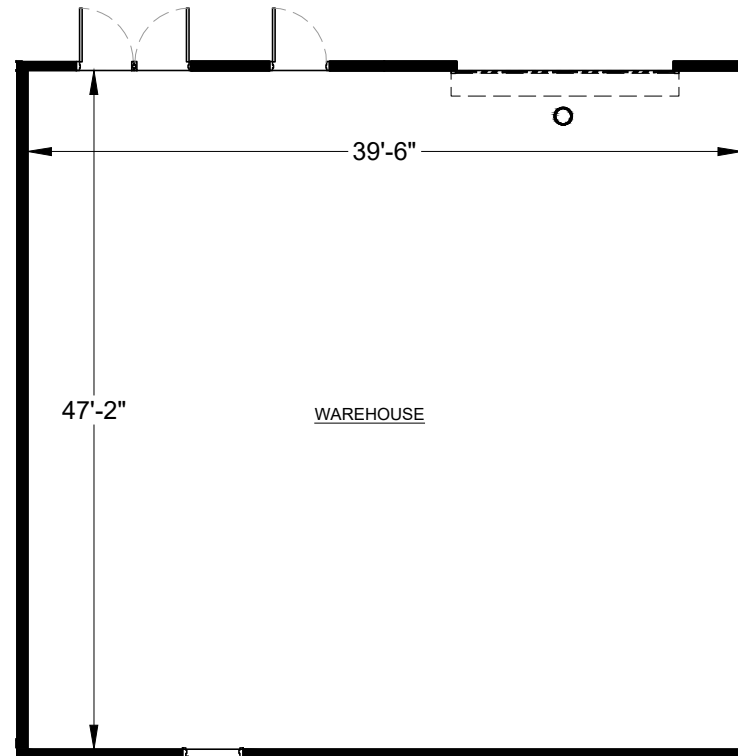

# CONCORD BUSINESS PARK

TONY BINSWANGER, SIOR  
*Executive Director*  
925.627.2482  
Tony.Binswanger@cushwake.com  
LIC#01861701

TIM SCHMID  
*Director*  
925.627.2886  
Tim.Schmid@cushwake.com  
LIC#01847650

BO HARKINS  
*Director*  
925.627.2481  
Bo.Harkins@cushwake.com  
LIC#01943785

Owned by:

