

# 758 COLUMBIA ROAD

PLAINFIELD, IN 46168

37,148 SF- 74,528 SF  
FOR SUBLEASE



**CUSHMAN &  
WAKEFIELD**

# 758 COLUMBIA ROAD PLAINFIELD, IN 46168

## PROPERTY HIGHLIGHTS

- Available November 1, 2025
- Sublease through December 31, 2029
- 28' ceiling height
- 50' x 50' column spacing
- 2025 OPEX is \$2.28/SF
- Fully climate-controlled space
- Docks with levelers
- 1,600 A/480V/3 Phase
- Large drive-in doors
- Multiple cranes can be available



# 758 COLUMBIA ROAD PLAINFIELD, IN 46168

## SITE PLAN

- Unit #199
- 37,148 SF
- +/- 3,300 SF Office
- 3 dock doors
- 1 drive-in door
- Air conditioned warehouse

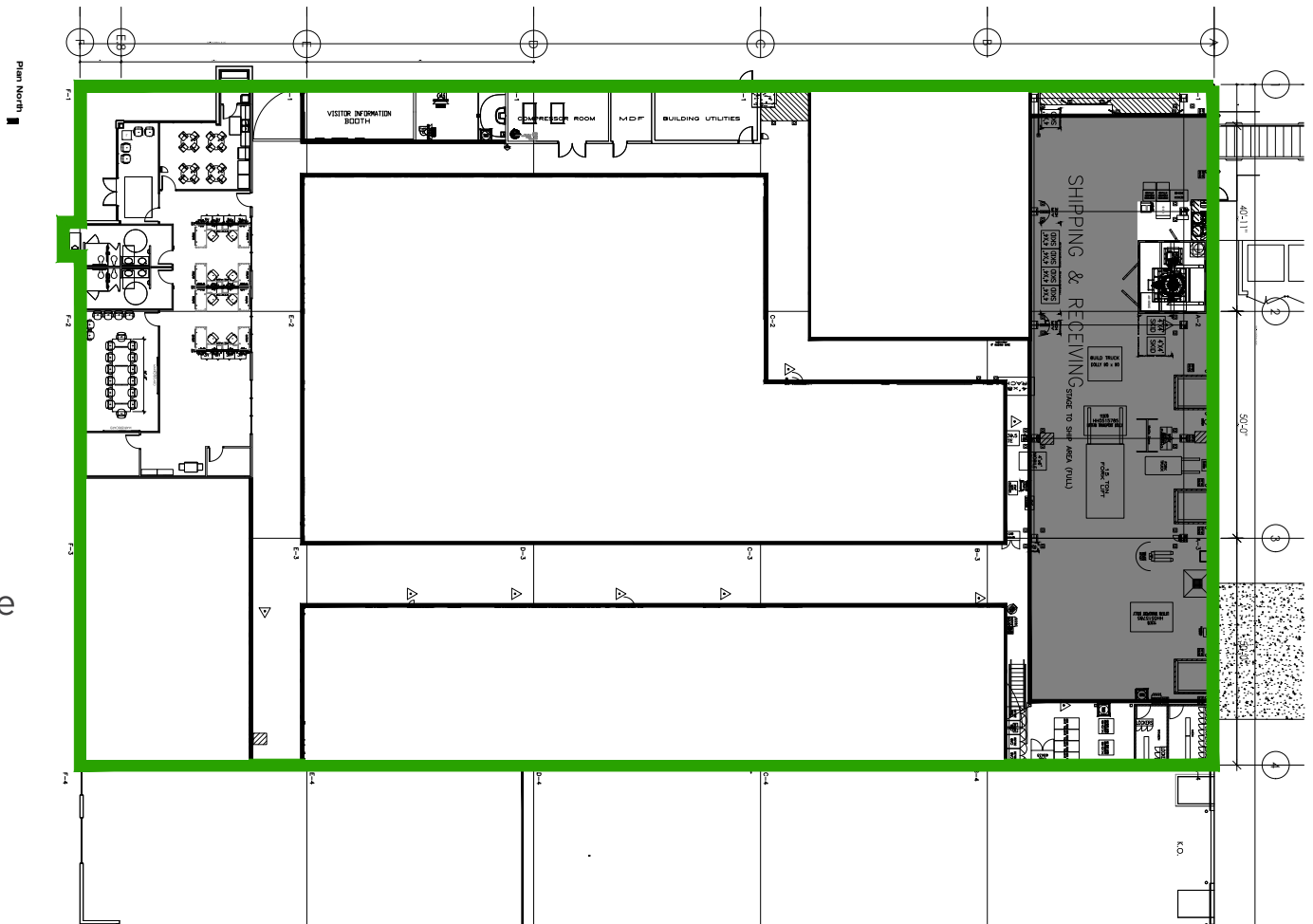

# 758 COLUMBIA ROAD PLAINFIELD, IN 46168

## SITE PLAN

- Unit #141
- 37,380 SF
- +/- 3,750 SF Office
- 4 dock doors
- 1 drive-in door
- Air conditioned warehouse

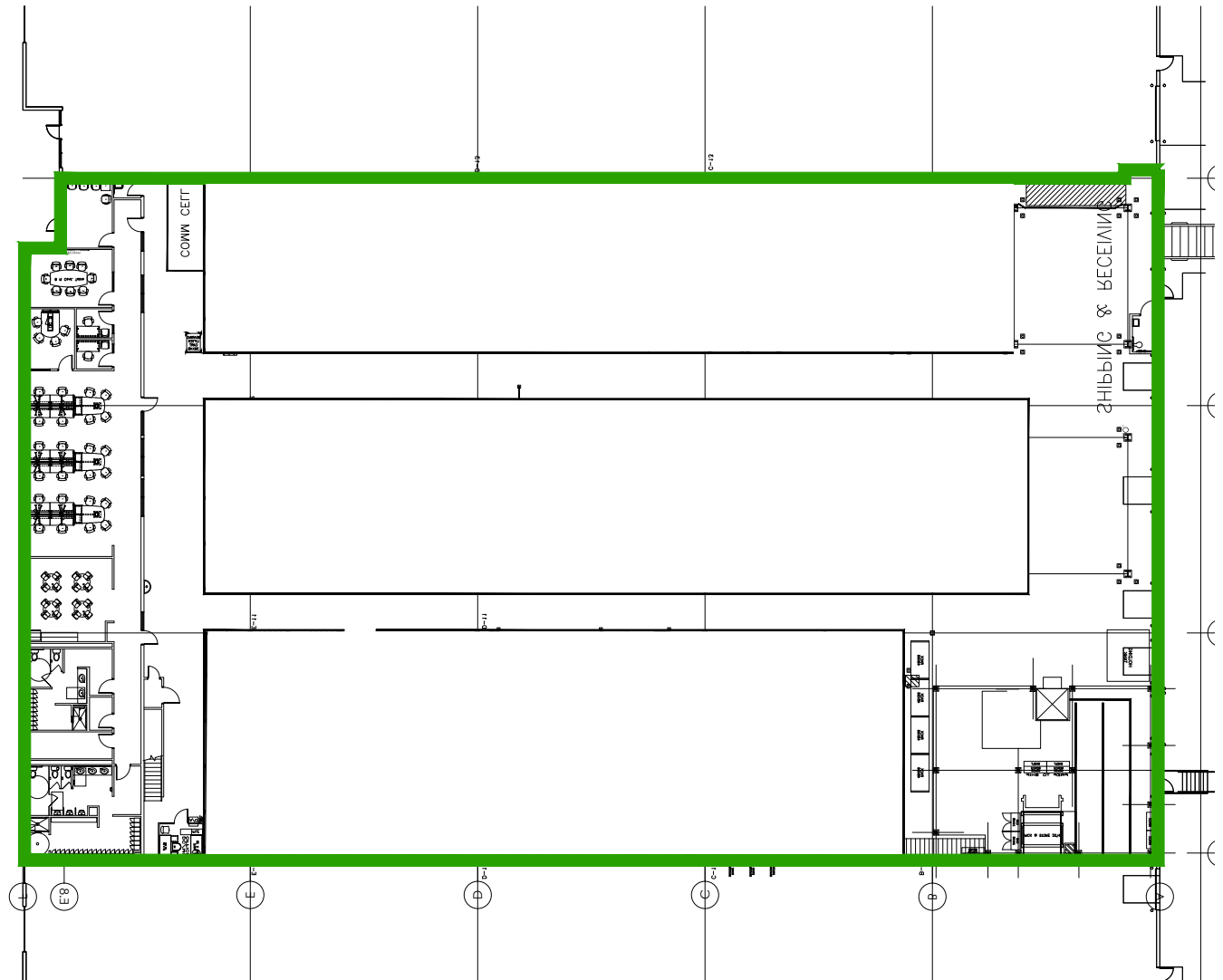



# 758 COLUMBIA ROAD PLAINFIELD, IN 46168

## SITE MAP

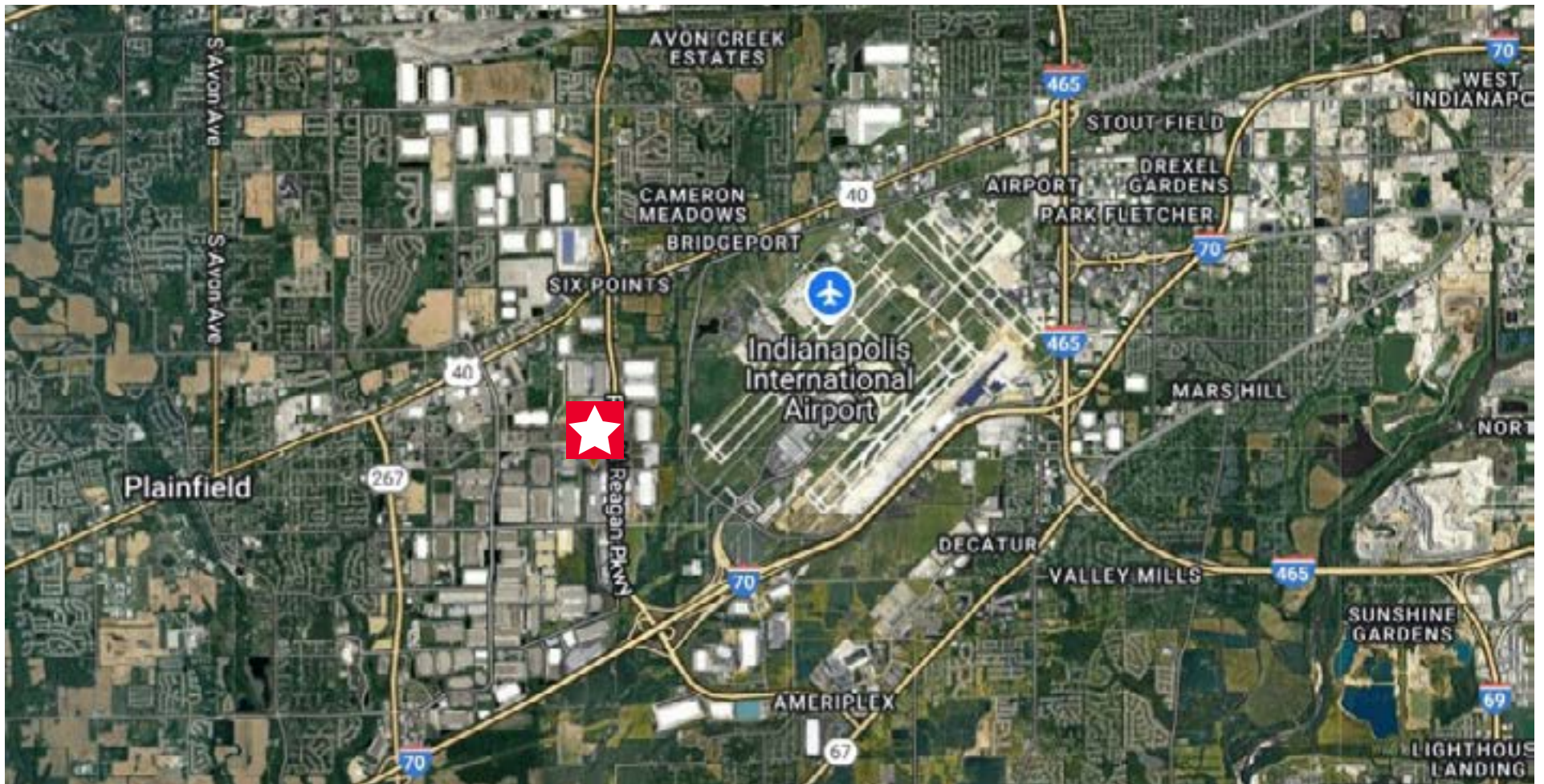





**FOR MORE INFORMATION, CONTACT:**

Kevin Archer  
Senior Director  
+1 317 218 7217  
[kevin.archer@cushwake.com](mailto:kevin.archer@cushwake.com)

Megan Cuvelier  
Director  
+1 317 352 5422  
[megan.cuvelier@cushwake.com](mailto:megan.cuvelier@cushwake.com)

Cushman & Wakefield  
One American Square, Suite 1800,  
Indianapolis, IN 46282  
[cushmanwakefield.com](http://cushmanwakefield.com)

©2025 Cushman & Wakefield. All rights reserved. The information contained in this communication is strictly confidential. This information has been obtained from sources believed to be reliable but has not been verified. NO WARRANTY OR REPRESENTATION, EXPRESS OR IMPLIED, IS MADE AS TO THE CONDITION OF THE PROPERTY (OR PROPERTIES) REFERENCED HEREIN OR AS TO THE ACCURACY OR COMPLETENESS OF THE INFORMATION CONTAINED HEREIN, AND SAME IS SUBMITTED SUBJECT TO ERRORS, OMISSIONS, CHANGE OF PRICE, RENTAL OR OTHER CONDITIONS, WITHDRAWAL WITHOUT NOTICE, AND TO ANY SPECIAL LISTING CONDITIONS IMPOSED BY THE PROPERTY OWNER(S). ANY PROJECTIONS, OPINIONS OR ESTIMATES ARE SUBJECT TO UNCERTAINTY AND DO NOT SIGNIFY CURRENT OR FUTURE PROPERTY PERFORMANCE.