



# 9455 CABOT DRIVE

MIRAMAR, SAN DIEGO, CALIFORNIA 92126

**25K BROKER BONUS**

Qualified Lease of 9455 - 200, 300 or 400  
Commencing by 3/31/2026



21,750 - 81,670 SQUARE FEET OF DISTRIBUTION SPACE AVAILABLE FOR LEASE



**BRANT ABERG, SIOR**  
858.546.5464  
brant.aberg@cushwake.com  
CA LIC. 01773573

**RYAN DOWNING, SIOR**  
858.546.5416  
ryan.downing@cushwake.com  
CA LIC. 01955032





# 9455 CABOT DRIVE

MIRAMAR, SAN DIEGO, CALIFORNIA 92126

## PROPERTY FEATURES:

- EASY ACCESS TO THE 5, 15 & 805 FREEWAYS VIA MIRAMAR ROAD
- APPROXIMATELY 1.6 MILES TO I-15
- PROPERTY ACCESS VIA CABOT DRIVE OFF MIRAMAR ROAD
- DOCK AND GRADE LEVEL LOADING
- VERY RESPONSIVE & STRONG INSTITUTIONAL OWNERSHIP AND PROPERTY MANAGEMENT

## BUILDING SPECIFICATIONS:

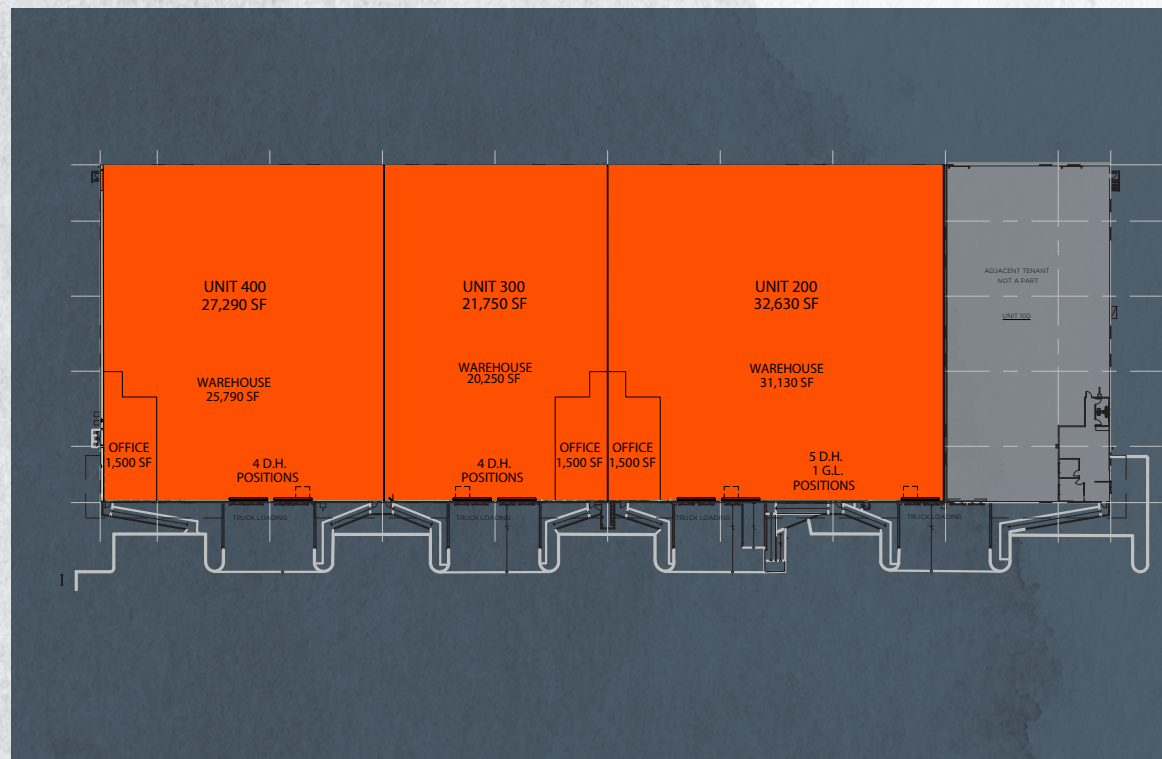

CLEAR HEIGHT

**±22' - 24'**

ZONING

**IL-2-1**

BAY DEPTH

**179'**

FIRE SPRINKLERS

**ESFR K-17**

COLUMN SPACING

**40' X 60'**

ACCESSIBILITY

**VIA CABOT DR.  
& ARJONS DR**



PROPERTY OVERVIEW

# 9455 CABOT DRIVE

MIRAMAR, SAN DIEGO, CALIFORNIA 92126

## SUITE SPECIFICATIONS

- SUITES CAN BE LEASED SEPARATELY OR COMBINED
- AVAILABLE NOW
- INDIVIDUAL SUITES: \$1.75 PSF NNN
- COMBINED SUITES: \$1.70 PSF NNN
- ±\$0.36 PSF NNNS

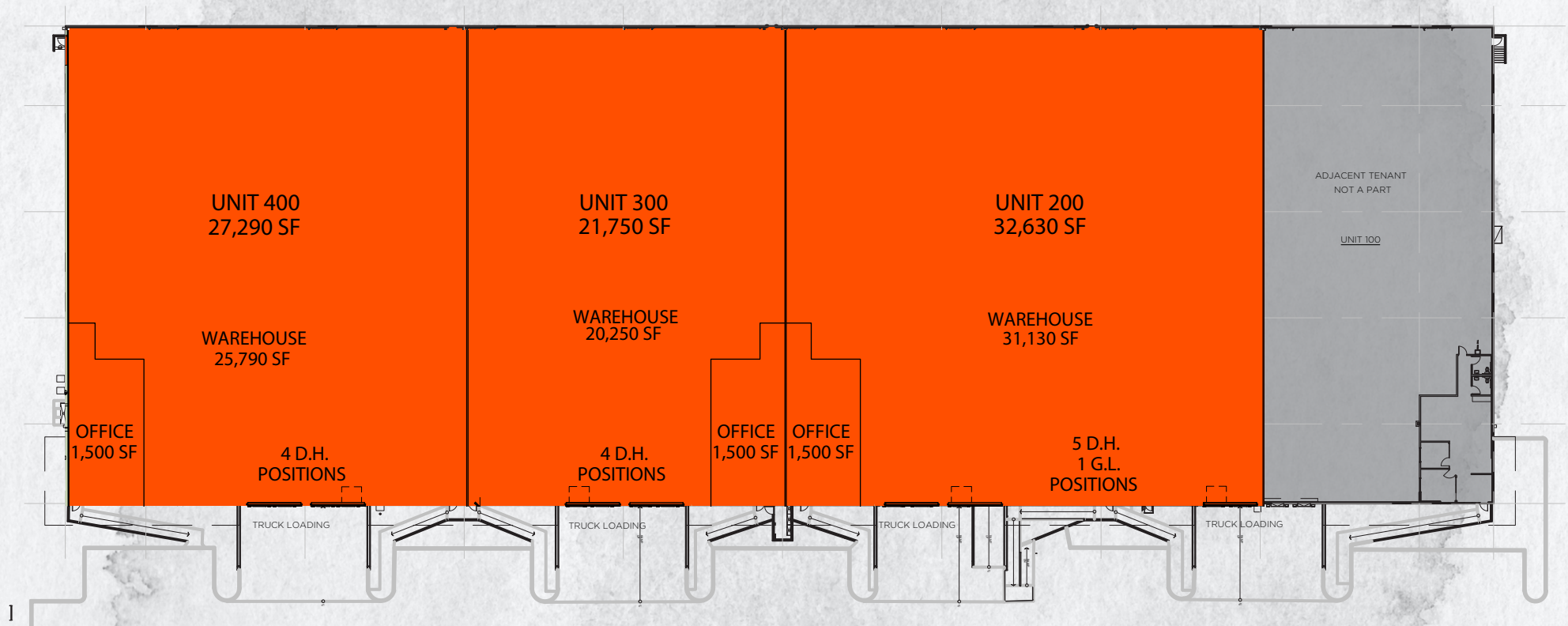

# 9455 CABOT DRIVE

MIRAMAR, SAN DIEGO, CALIFORNIA 92126

## SUITE SPECIFICATIONS

- SUITES CAN BE LEASED SEPARATELY OR COMBINED
- AVAILABLE NOW
- INDIVIDUAL SUITES: \$1.75 PSF NNN
- COMBINED SUITES: \$1.70 PSF NNN
- ±\$0.36 PSF NNNS

### UNIT 200

32,630 SF  
5% OFFICE  
5 DOCK HIGH POSITIONS  
1 GRADE LEVEL RAMP

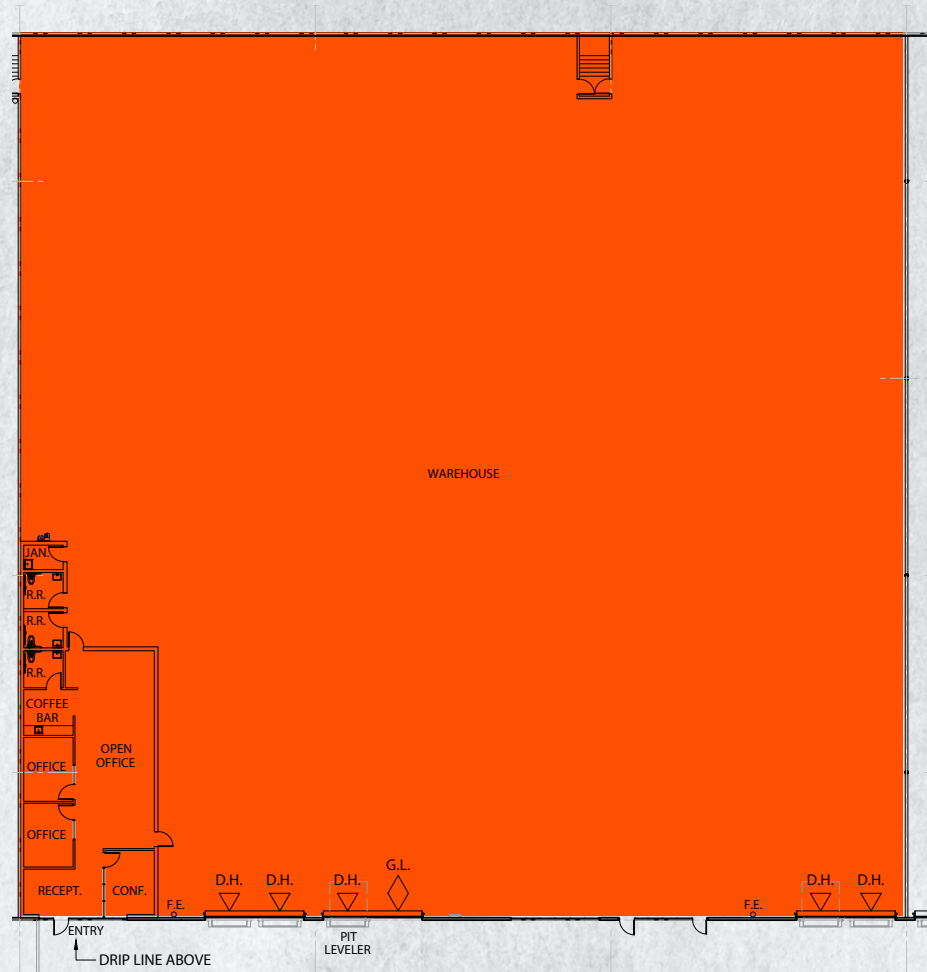

### 25K BROKER BONUS

Qualified Lease of 9455 - 200, 300 or 400  
Commencing by 3/31/2026



# PROPERTY OVERVIEW

# 9455 CABOT DRIVE

MIRAMAR, SAN DIEGO, CALIFORNIA 92126

## SUITE SPECIFICATIONS

- SUITES CAN BE LEASED SEPARATELY OR COMBINED
- AVAILABLE NOW
- INDIVIDUAL SUITES: \$1.75 PSF NNN
- COMBINED SUITES: \$1.70 PSF NNN
- ±\$0.36 PSF NNNS

### UNIT 300

21,750 SF  
7% OFFICE  
4 DOCK HIGH POSITIONS

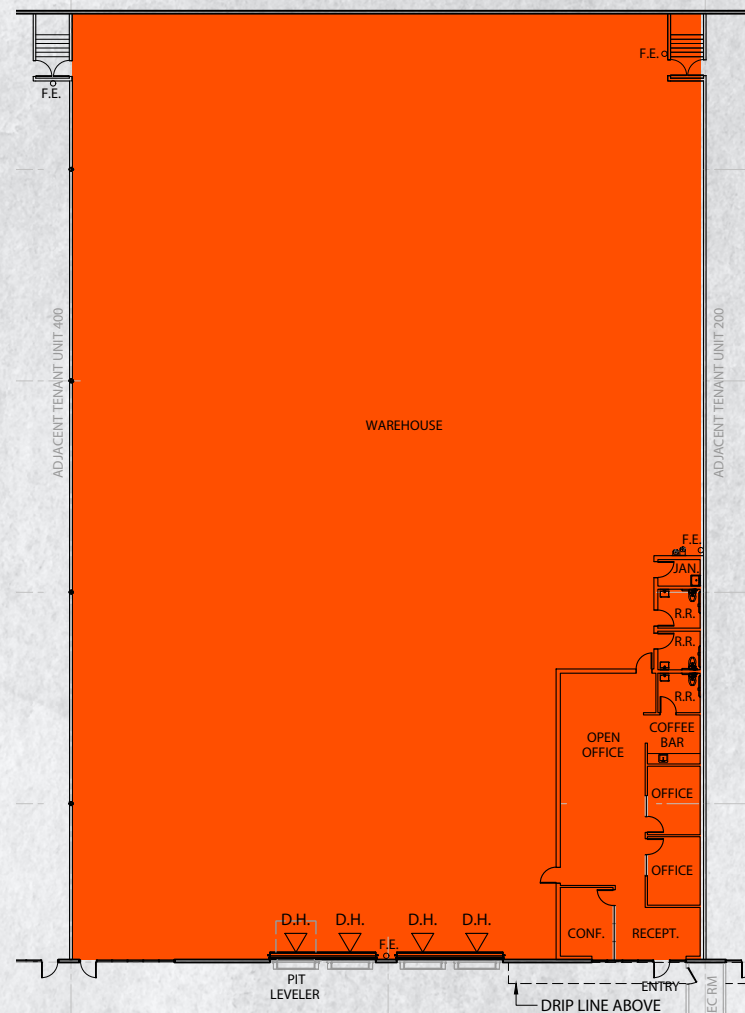

### **25K BROKER BONUS**

Qualified Lease of 9455 - 200, 300 or 400  
Commencing by 3/31/2026



# PROPERTY OVERVIEW

# 9455 CABOT DRIVE

MIRAMAR, SAN DIEGO, CALIFORNIA 92126

## SUITE SPECIFICATIONS

- SUITES CAN BE LEASED SEPARATELY OR COMBINED
- AVAILABLE NOW
- INDIVIDUAL SUITES: \$1.75 PSF NNN
- COMBINED SUITES: \$1.70 PSF NNN
- ±\$0.36 PSF NNNS

### UNIT 400

27,290 SF  
6% OFFICE  
4 DOCK HIGH POSITIONS

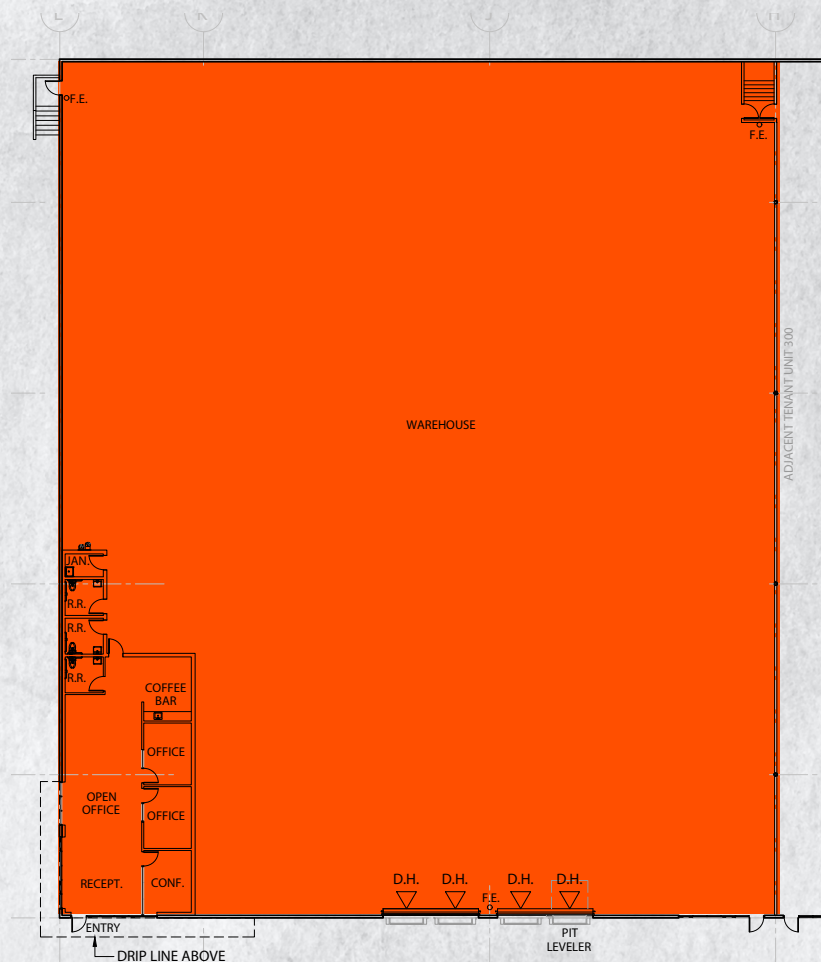

**25K BROKER BONUS**  
Qualified Lease of 9455 - 200, 300 or 400  
Commencing by 3/31/2026



# PROPERTY OVERVIEW

# 9455 CABOT DRIVE

MIRAMAR, SAN DIEGO, CALIFORNIA 92126



# 9455 CABOT DRIVE

MIRAMAR, SAN DIEGO, CALIFORNIA 92126



- |                      |                               |                            |                                       |                         |                           |                                    |                          |                                 |                      |
|----------------------|-------------------------------|----------------------------|---------------------------------------|-------------------------|---------------------------|------------------------------------|--------------------------|---------------------------------|----------------------|
| 1<br>IHOP Restaurant | 5<br>Zavaro Mobil             | 9<br>Spice Corner          | 13<br>Ann's Alterations and Tailoring | 17<br>KFC and Taco Bell | 20<br>Dave's Famous Cafe  | 23<br>Pro Star Wireless of Miramar | 27<br>Denny's Restaurant | 31<br>AMPM                      | 35<br>Ale Smith      |
| 2<br>Miramar Shell   | 6<br>Scripps Miramar Car Wash | 10<br>California Thai Cafe | 14<br>Dixieline Pro Build             | 18<br>McDonald's        | 21<br>Miramar Pizza       | 24<br>San Diego Wine Co.           | 28<br>Togo's             | 32<br>Chevron Station           | 36<br>Ballast Point  |
| 3<br>Chin's Szechwan | 7<br>24 Hour Fitness          | 11<br>SUBWAY               | 15<br>Pastalini                       | 19<br>Miramar Cafe      | 22<br>Roberto's Taco Shop | 25<br>Quiznos                      | 29<br>Carl's Jr          | 33<br>Discount Tire Co.         | 37<br>UTC Mall       |
| 4<br>Carl's Jr       | 8<br>AMPM                     | 12<br>Miramar West Shell   | 16<br>Sima's Grill and Deli           |                         |                           | 26<br>Starbucks                    | 30<br>Office Depot       | 34<br>Miramar 76 Service Center | 38<br>Sorrento Court |



## NEIGHBORHOOD AMENITIES

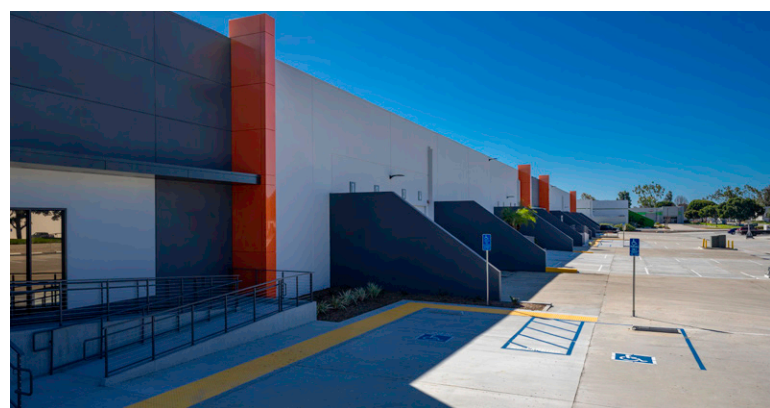

# 9455 CABOT DRIVE

MIRAMAR, SAN DIEGO, CALIFORNIA 92126



CUSHMAN &  
WAKEFIELD



Rexford  
Industrial

BRANT ABERG, SIOR

858.546.5464

[brant.aberg@cushwake.com](mailto:brant.aberg@cushwake.com)

CA LIC. 01773573

RYAN DOWNING, SIOR

858.546.5416

[ryan.downing@cushwake.com](mailto:ryan.downing@cushwake.com)

CA LIC. 01955032