

**WAREHOUSE AND OFFICE  
FOR LEASE**

**±3,325 SF AND ±9,163 SF AVAILABLE**



**STEVEN LEONARD**

Managing Director  
+1 415 722 1080  
steven.leonard@cushwake.com  
Lic #00909604

**BRIAN FOSTER**

Executive Director  
+1 415 451 2437  
brian.foster@cushwake.com  
Lic #01393059

**TREVOR BUCK**

Executive Managing Director  
+1 415 451 2436  
trevor.buck@cushwake.com  
Lic #01255462

**1600 CORPORATE CIRCLE**

**PETALUMA, CA 94954**

# 1600 CORPORATE CIRCLE

OFFICE/WAREHOUSE AVAILABLE

## HIGHLIGHTS

- ±3,325 SF and ±9,163 SF available
- Power: 1,600 amps 277/480 V
- Sprinklers
- Dock loaded
- Grade level loading doors
- Open ceilings
- Floor to ceiling glass
- En suite restrooms
- 3/1,000 parking ratio
- High visibility location with signage potential
- Adjacent to Shollenberger Park with walking paths

### STEVEN LEONARD

Managing Director  
+1 415 722 1080  
steven.leonard@cushwake.com  
Lic #00909604

### BRIAN FOSTER

Executive Director  
+1 415 451 2437  
brian.foster@cushwake.com  
Lic #01393059

### TREVOR BUCK

Executive Managing Director  
+1 415 451 2436  
trevor.buck@cushwake.com  
Lic #01255462





# 1600 CORPORATE CIRCLE

CREATIVE OFFICE/FLEX SPACE AVAILABLE

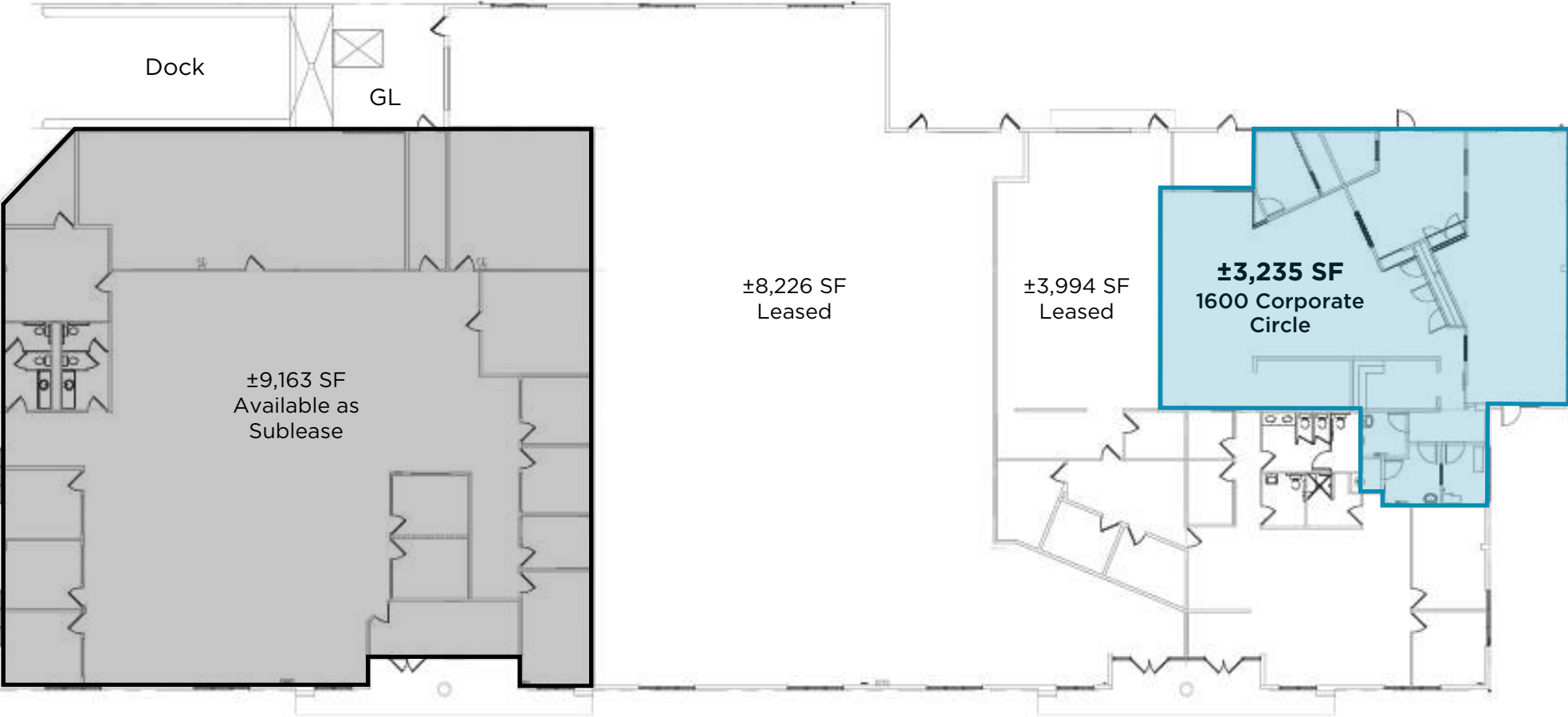

**STEVEN LEONARD**  
Managing Director  
+1 415 722 1080  
steven.leonard@cushwake.com  
Lic #00909604

**BRIAN FOSTER**  
Executive Director  
+1 415 451 2437  
brian.foster@cushwake.com  
Lic #01393059

**TREVOR BUCK**  
Executive Managing Director  
+1 415 451 2436  
trevor.buck@cushwake.com  
Lic #01255462

©2025 Cushman & Wakefield. All rights reserved. The material in this presentation has been prepared solely for information purposes, and is strictly confidential. Any disclosure, use, copying or circulation of this presentation (or the information contained within it) is strictly prohibited, unless you have obtained Cushman & Wakefield's prior written consent. The views expressed in this presentation are the views of the author and do not necessarily reflect the views of Cushman & Wakefield. Neither this presentation nor any part of it shall form the basis of, or be relied upon in connection with any offer, or act as an inducement to enter into any contract or commitment whatsoever. NO REPRESENTATION OR WARRANTY IS GIVEN, EXPRESS OR IMPLIED, AS TO THE ACCURACY OF THE INFORMATION CONTAINED WITHIN THIS PRESENTATION, AND CUSHMAN & WAKEFIELD IS UNDER NO OBLIGATION TO SUBSEQUENTLY CORRECT IT IN THE EVENT OF ERRORS.

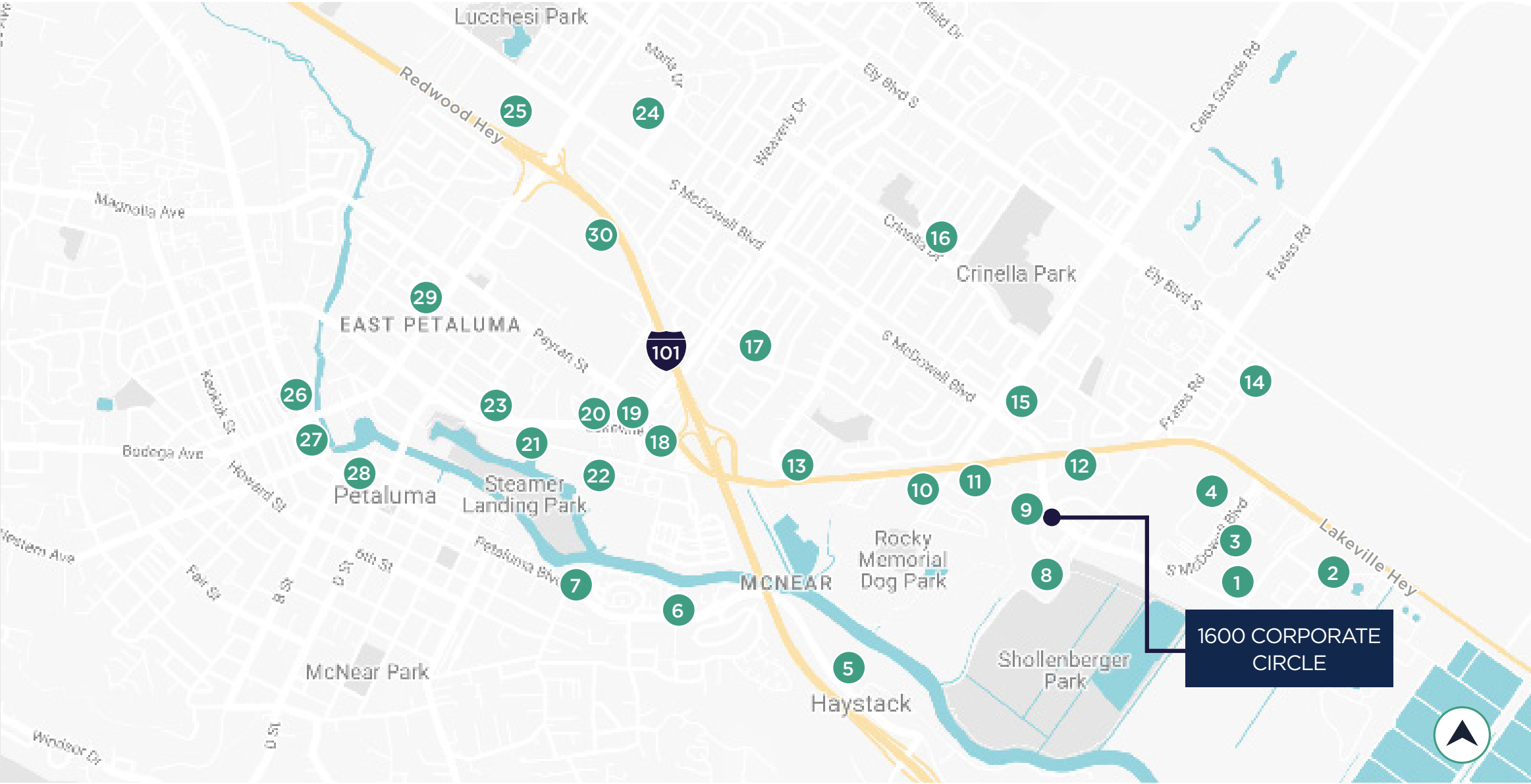

- |                                   |                           |                               |                               |                                  |
|-----------------------------------|---------------------------|-------------------------------|-------------------------------|----------------------------------|
| 1. Petaluma Valley Dental         | 6. TruckMax USA           | 14. Southgate Park            | 20. Anna's Seafood            | 26. Brewsters Beer Garden        |
| 2. Kaiser Health Plan Pharmacy    | 7. Mr. Mom's Cafe         | 15. Johnson Classic Car Sales | 21. Touchless Car Wash        | 27. Della Fattoria Downtown Café |
| 3. 7 Up Bottling Co-San Francisco | 8. FrontRow               | 16. Pet Lovers Pet Care       | 22. North Bay Animal Services | 28. Boulevard 14 Cinema          |
| 4. FedEx Ship Center              | 9. Miyoko's               | 17. JT's Mom & Pop Wines      | 23. Hampton Inn Petaluma      | 29. Whole Foods Market           |
| 5. Public Storage                 | 10. Petaluma Self Storage | 18. In-N-Out Burger           | 24. Safeway                   | 30. Sprouts Farmers Market       |
|                                   | 11. Anytime Fitness       | 19. McDonald's                | 25. Trader Joe's              |                                  |
|                                   | 12. PUB Republic          |                               |                               |                                  |
|                                   | 13. Hello Ortho           |                               |                               |                                  |

# AREA AMENITIES