



**\$5,000 BROKER BONUS
— SIGN BY 4/30/26**

TEXAS TOWER

845 TEXAS AVENUE
HOUSTON, TEXAS

HIGH-RISE ELEVATOR BANK

SUBLEASE SPACE

**FLOOR 38
3,124 SF**

**SPEC SUITE
NOW COMPLETE**



FLOORPLAN

SPACE ECONOMICS

Available Space	Partial Floor 38 - 3,124 RSF
Available & Term	Flexible Terms Available Now through April 30, 2037.
Rental Rate	Negotiable
2025 Estimated OPEX	\$20.59/RSF + 3% management fee
Parking	1.5/1,000 RSF Unserved @ \$250/space/month
Condition	Fully Built out with some furniture included (<i>furniture in common area and all chairs are shown as an example and not included</i>). Underfloor HVAC for efficiency.

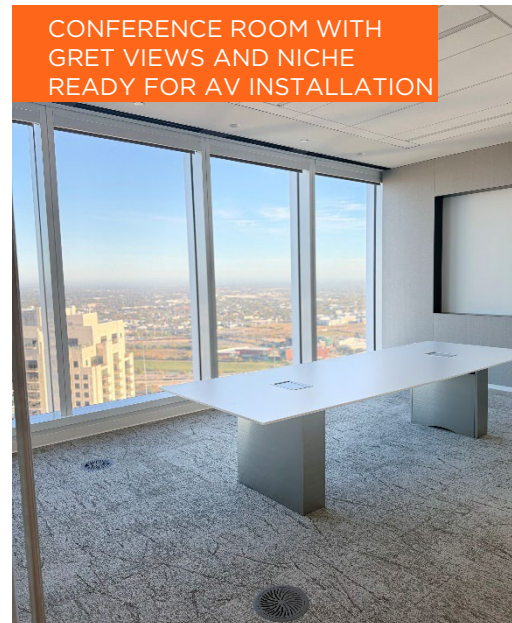
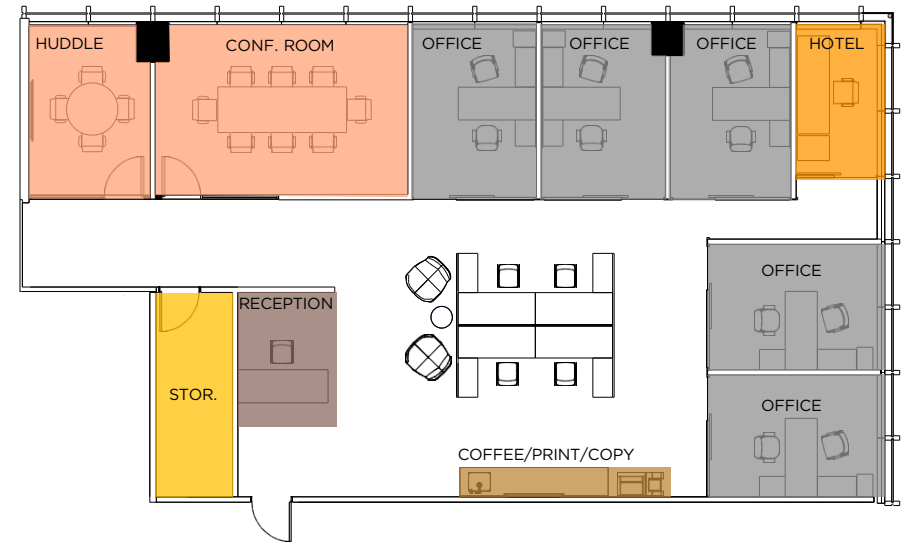

PROPERTY HIGHLIGHTS & BUILDING AMENITIES



TENANT LOUNGE



MEETING ROOMS

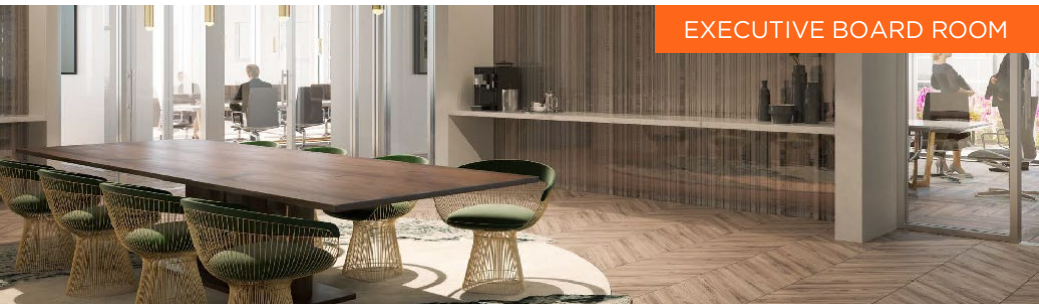

EXECUTIVE BOARD ROOM

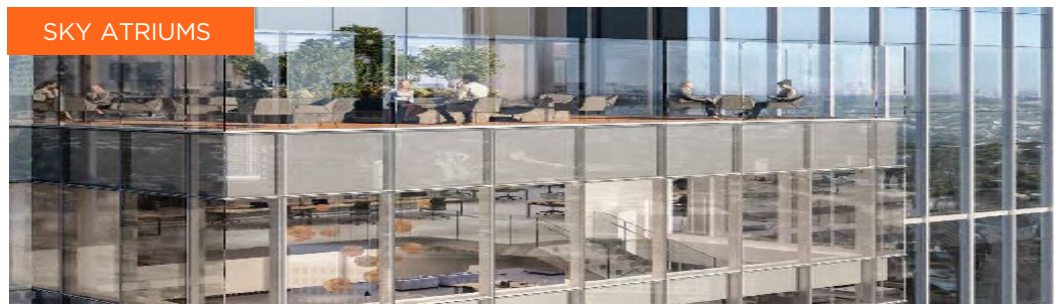

SKY ATRIUMS

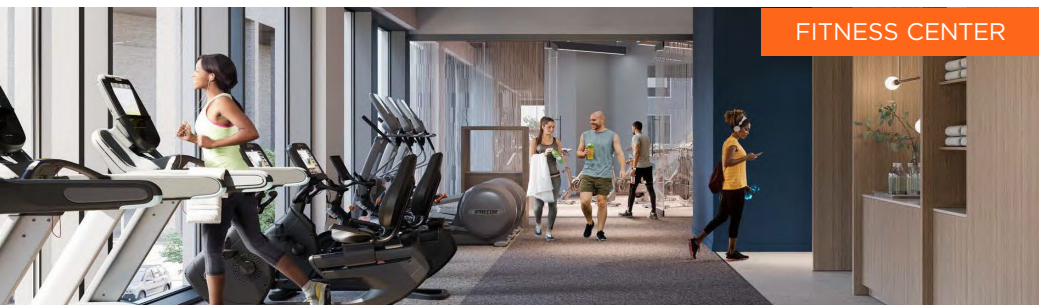

FITNESS CENTER

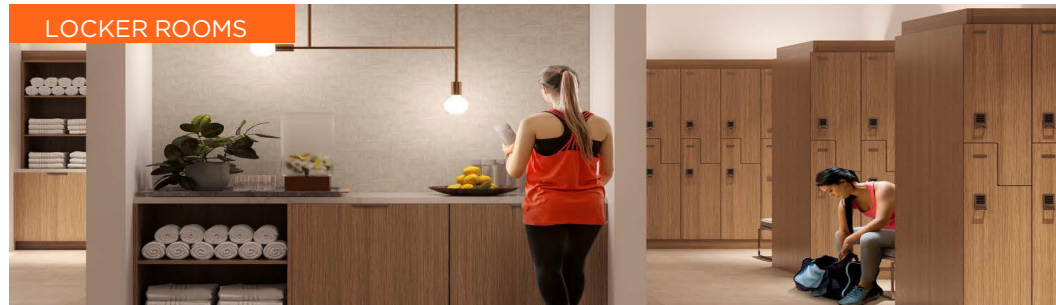

LOCKER ROOMS



NEIGHBORHOOD-LIKE FOOD & BEVERAGE



STREET LEVEL RETAIL



CONTACT

MORGAN RELYEA COLT

+1 713 331 1787

morgan.relyea@cushwake.com

DAVID G. GUION

+1 713 963 2810

david.guion@cushwake.com

TIM D. RELYEA

+1 713 877 8752

tim.relyea@cushwake.com



©2026 Cushman & Wakefield. All rights reserved. The information contained in this communication is strictly confidential. This information has been obtained from sources believed to be reliable but has not been verified. NO WARRANTY OR REPRESENTATION, EXPRESS OR IMPLIED, IS MADE AS TO THE CONDITION OF THE PROPERTY (OR PROPERTIES) REFERENCED HEREIN OR AS TO THE ACCURACY OR COMPLETENESS OF THE INFORMATION CONTAINED HEREIN, AND SAME IS SUBMITTED SUBJECT TO ERRORS, OMISSIONS, CHANGE OF PRICE, RENTAL OR OTHER CONDITIONS, WITHDRAWAL WITHOUT NOTICE, AND TO ANY SPECIAL LISTING CONDITIONS IMPOSED BY THE PROPERTY OWNER(S). ANY PROJECTIONS, OPINIONS OR ESTIMATES ARE SUBJECT TO UNCERTAINTY AND DO NOT SIGNIFY CURRENT OR FUTURE PROPERTY PERFORMANCE.