

AVAILABLE FOR LEASE

1212 RIVERSIDE AVE.

FORT COLLINS, COLORADO 80524



3 MONTHS FREE RENT

10,405 SF AVAILABLE

LEASE RATE: \$11.00-\$13.00/SF NNN
NNN: \$3.50/SF

POTENTIAL USES

RESEARCH
MANUFACTURING

SHOWROOM
OFFICE/RETAIL

1212 Riverside Avenue is located just east of downtown Fort Collins and just west of I-25. This building is a functional, open plan with many uses, affordable, and close to numerous amenities. Recent renovations amplify the prominent visibility and establish this building to be a distinguished Fort Collins address. With the modern addition of high ceilings with exposed metal deck and HVAC, new windows offering 2nd level views of the Poudre River, downtown Fort Collins and the Front Range mountains, and cutting-edge materials, you will want to be a part of this exciting opportunity. This property is located on Riverside Avenue near the intersection of Lemay Avenue and Riverside Avenue.



1212 RIVERSIDE AVE. FORT COLLINS, COLORADO 80524

Conceptual Floor Plans

BUILDING SIZE	42,189 SF
SITE SIZE	92,296 SF
AVAILABLE	10,405 Total SF
DIVISIBLE	2,182 SF
YOC/YOR	1974/2020
PARKING SPACES	33 + Over 200 spaces of overflow parking next door and across the street
ZONING	Industrial District
RAIL SERVED	Rail spur
POWER	277/480 Volts, 1,200 Amps
WATER TAP	2 Inch
LOADING DOCK	Yes

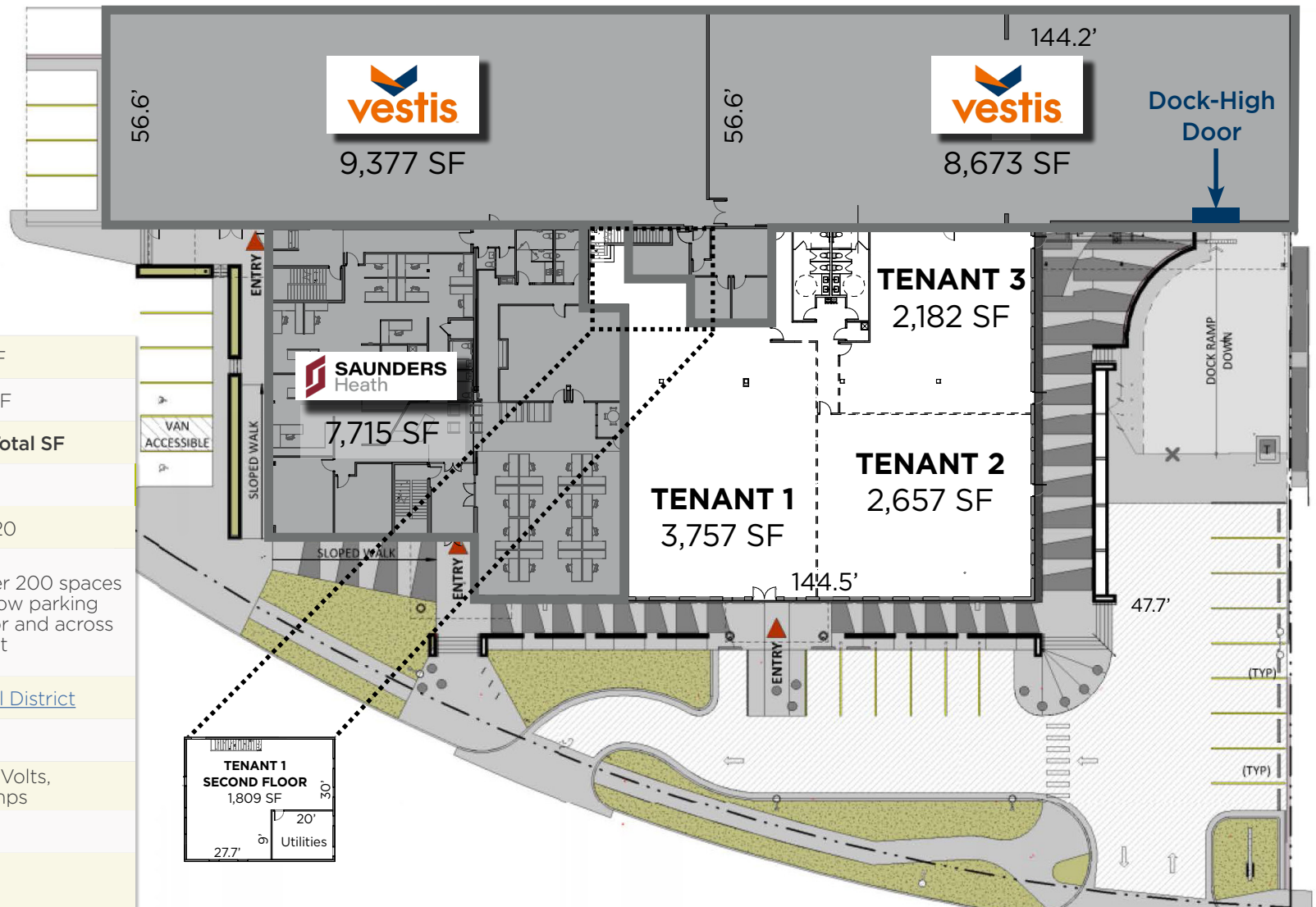

1212 RIVERSIDE AVE. FORT COLLINS, COLORADO 80524



FOR MORE INFORMATION, PLEASE CONTACT:

NATE HECKEL

Managing Director

+1 970 267 7724

nate.heckel@cushwake.com

TYLER MURRAY

Senior Director

+1 970 267 7404

tyler.murray@cushwake.com

AKI PALMER

Executive Managing Director

+1 970 267 7727

aki.palmer@cushwake.com

TY MASHEK

Senior Associate

+1 303 525 3125

ty.mashek@cushwake.com

772 Whalers Way, Suite 200
Fort Collins, Colorado 80525

T +1 970 776 3900

F +1 970 267 7419

cushmanwakefield.com