

210 N. PENDLETON STREET

HIGH POINT, NC 27260

±108,000 SF
AVAILABLE FOR LEASE



Property Overview

Building Size	± 108,650 SF
Office Size	± 6,400 SF
Year Built	1999
Ceiling Height	32'
Dock High Doors	Six (6) 8' x 10' w/Pit-Levelers
Drive-In Doors	One (1) 12' x 14'

Column Spacing	35' 0" x 40' 8" 45' 7" x 47' 0"
Sprinkler	ESFR
Roof Type	Ballasted EPDM rubber membrane roof
Lighting Fixtures	Motion sensing T-5 high-bay fluorescent lighting
HVAC System	In-place air rotation system

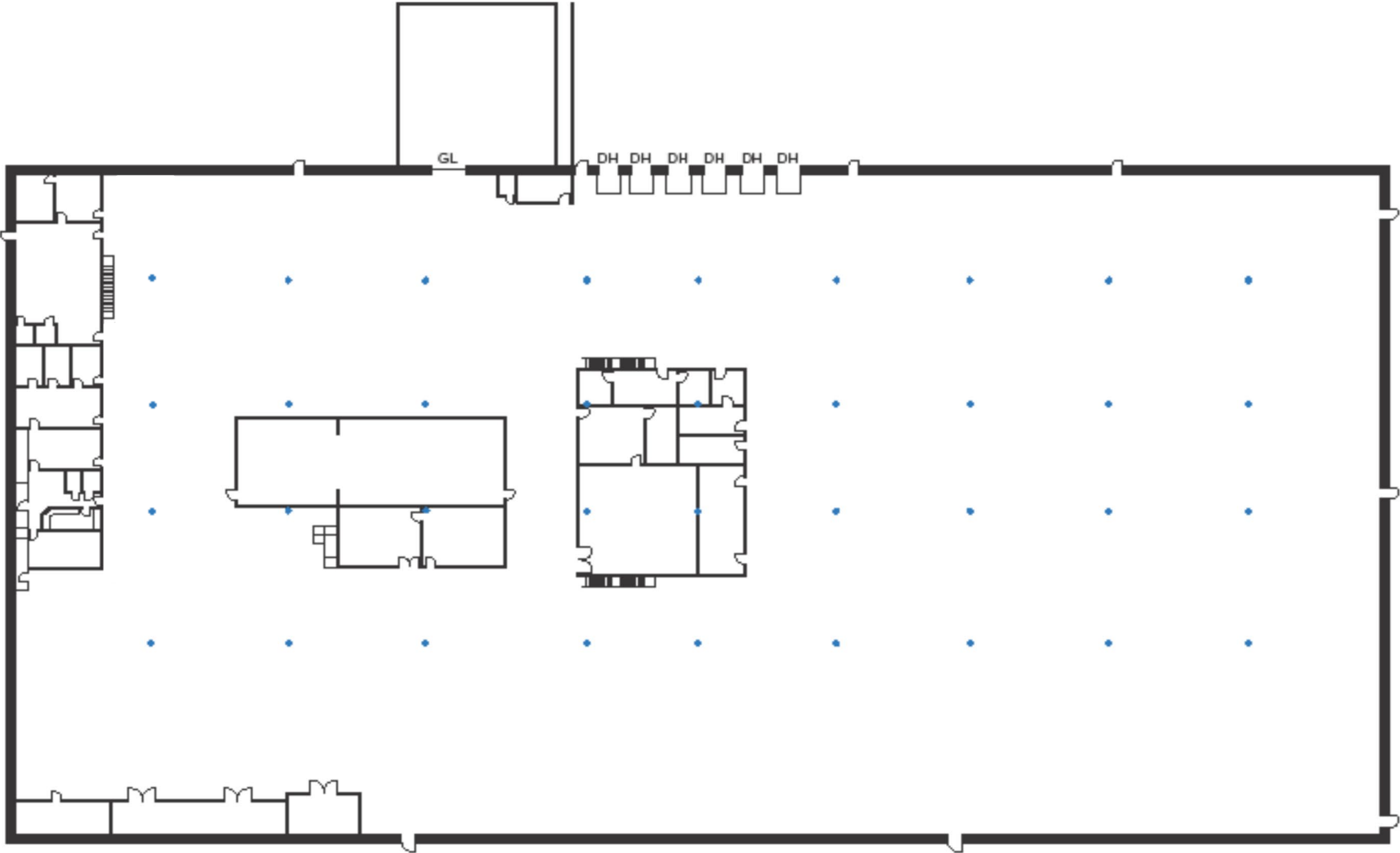

Building Images

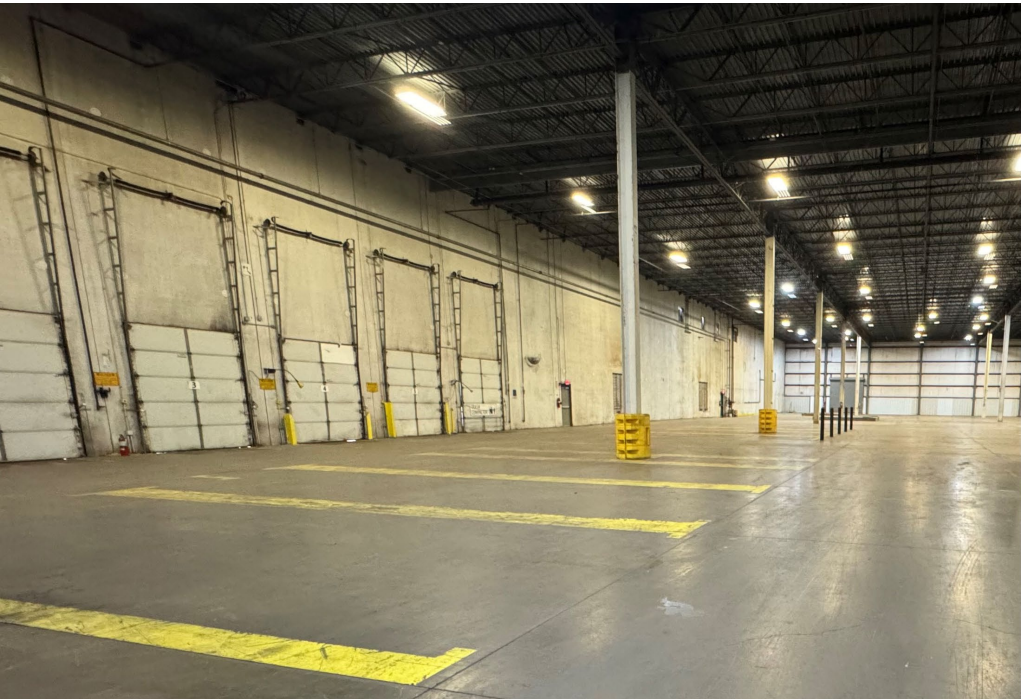
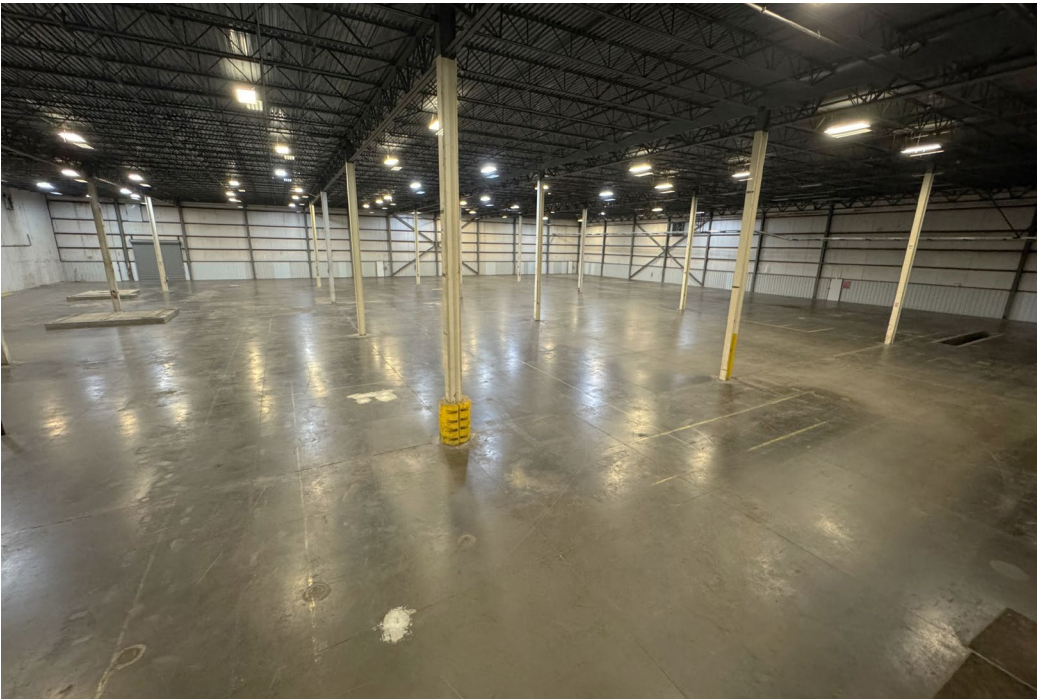

Location Map

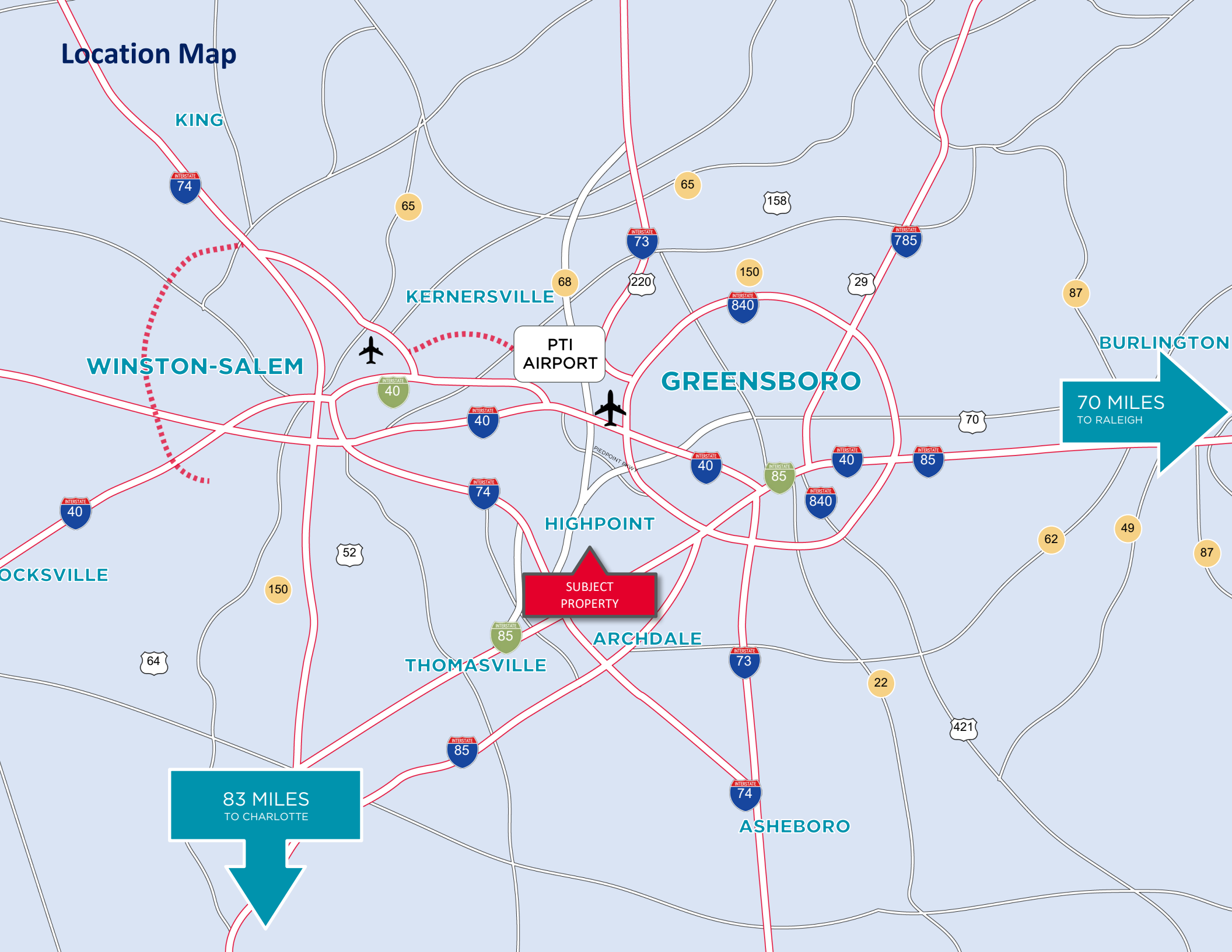

Corporate Neighbors



210 N. PENDLETON STREET

HIGH POINT, NC 27260



For More Information, Please Contact:

JORDAN MITCHELL

Senior Director

+1 336 201 0495

jordan.mitchell@cushwake.com

JASON OFSANKO

Executive Director

+1 336 812 3300

jason.ofsanko@cushwake.com

RYAN CONBOY, SIOR

Managing Director

+1 336 821 3832

ryan.conboy@cushwake.com

628 Green Valley Road, Suite 202, Greensboro, NC 27408 | +1 336 668 9999 | cushmanwakefield.com



©2025 Cushman & Wakefield. All rights reserved. The information contained in this communication is strictly confidential. This information has been obtained from sources believed to be reliable but has not been verified. NO WARRANTY OR REPRESENTATION, EXPRESS OR IMPLIED, IS MADE AS TO THE CONDITION OF THE PROPERTY (OR PROPERTIES) REFERENCED HEREIN OR AS TO THE ACCURACY OR COMPLETENESS OF THE INFORMATION CONTAINED HEREIN, AND SAME IS SUBMITTED SUBJECT TO ERRORS, OMISSIONS, CHANGE OF PRICE, RENTAL OR OTHER CONDITIONS, WITHDRAWAL WITHOUT NOTICE, AND TO ANY SPECIAL LISTING CONDITIONS IMPOSED BY THE PROPERTY OWNER(S). ANY PROJECTIONS, OPINIONS OR ESTIMATES ARE SUBJECT TO UNCERTAINTY AND DO NOT SIGNIFY CURRENT OR FUTURE PROPERTY PERFORMANCE.