

15,167 SF Available at High Image Office/Industrial Building with Climate Controlled Warehouse

For Lease | 5335 Avion Park Drive, Highland Heights, Ohio 44143



5335 Avion Park Drive

- 7,000 SF of fully air-conditioned and sprinklered warehouse space and 8,167 SF of office
- Located next to the Cuyahoga County Airport
- Minutes from I-271 & I-90
- Proximity to shopping, dining and lodging amenities on Wilson Mills Road
- Located near highly skilled workforce

Lease Rate: \$8.25/SF NNN



Availability

Available Space	15,167 SF Total 8,167 SF Office 7,000 SF Warehouse
Year Built (Reno)	1994
Dock w/ Leveler	One (1) - 8'x10'
Drive-In Door	One (1) - 10'x12'
Clear Height	16'
Power	400A/480V/3P

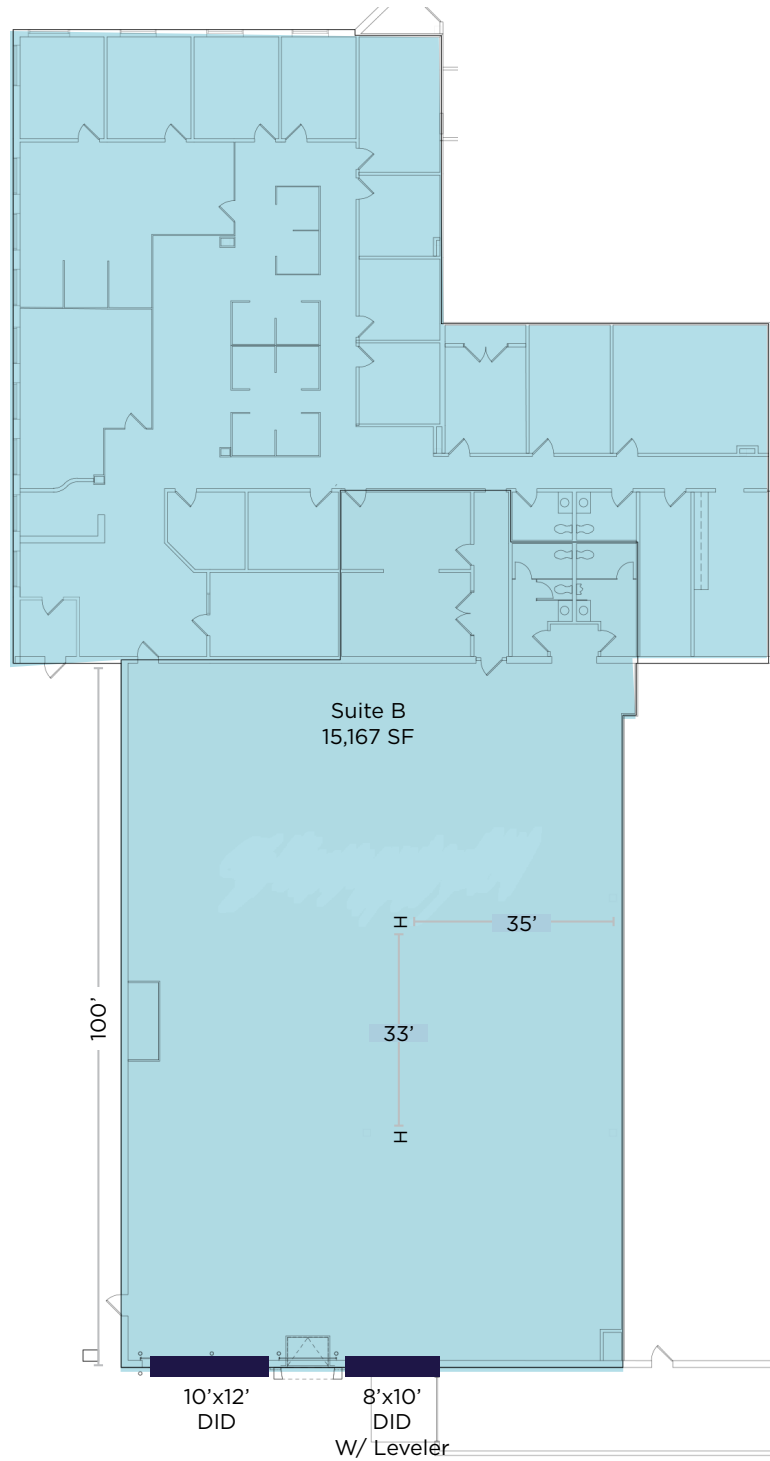

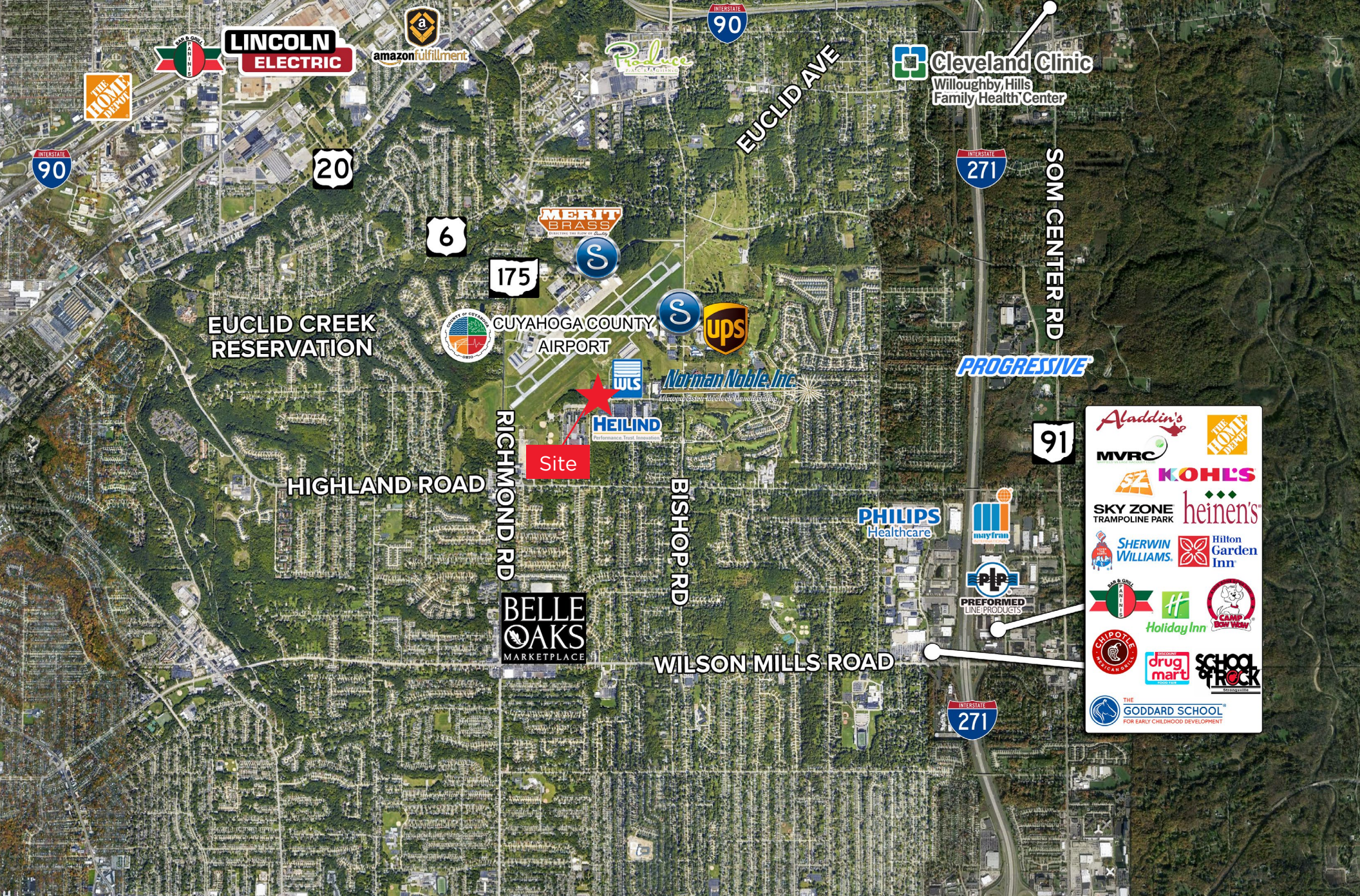

225,689
Population
(2025 | 5 Mile)

41.9
Median Age
(2025 | 5 Mile)

104,088
Households
(2025 | 5 Mile)

\$94,298
Household Income
(2025 | 5 Mile)

8,871
Total Businesses
(2025 | 5 Mile)

106,922
Total Employees
(2025 | 5 Mile)

**5335 AVION PARK DRIVE
HIGHLAND HEIGHTS, OHIO 44143**

GEORGE J. POFOK, CCIM, SIOR

Principal

gpofok@crescorealestate.com

+1 216 525 1469

RICO A PIETRO, SIOR

Principal

rpietro@crescorealestate.com

+1 216 525 1473

ROBBY MARTINELLI

Associate

rmartinelli@crescorealestate.com

+1 216 232 4104



Cushman & Wakefield | CRESCO
6100 Rockside Woods Blvd, Suite 200
Cleveland, Ohio 44131

crescorealestate.com

©2025 Cushman & Wakefield. All rights reserved. The information contained in this communication is strictly confidential. This information has been obtained from sources believed to be reliable but has not been verified. NO WARRANTY OR REPRESENTATION, EXPRESS OR IMPLIED, IS MADE AS TO THE CONDITION OF THE PROPERTY (OR PROPERTIES) REFERENCED HEREIN OR AS TO THE ACCURACY OR COMPLETENESS OF THE INFORMATION CONTAINED HEREIN, AND SAME IS SUBMITTED SUBJECT TO ERRORS, OMISSIONS, CHANGE OF PRICE, RENTAL OR OTHER CONDITIONS, WITHDRAWAL WITHOUT NOTICE, AND TO ANY SPECIAL LISTING CONDITIONS IMPOSED BY THE PROPERTY OWNER(S). ANY PROJECTIONS, OPINIONS OR ESTIMATES ARE SUBJECT TO UNCERTAINTY AND DO NOT SIGNIFY CURRENT OR FUTURE PROPERTY PERFORMANCE.

