



1702 CUMING STREET

OMAHA, NE 68102

4,000 SF Available For Lease



PROPERTY HIGHLIGHTS

Downtown retail opportunity for lease at 17th and Cuming Street, with designated off-street parking perfect for a boutique, service user or a light flex user. The space is equipped with a garage door for convenient deliveries.



PROPERTY DETAILS

Lease Rate:	\$17.00 PSF NNN	Year Built/Renovated:	1906/2015
Total Building Size:	6,400 SF	Clearance Height:	18'
Available SF:	4,000 SF	HVAC	14 Ton (Rooftop Unit)
Operating Expenses:	\$7.50 PSF	Total Site Area:	0.21 AC (9,148 SF)
Date Available:	8/1/2025	Zoning:	DS-ACI-1 (PL)

FLOOR PLAN

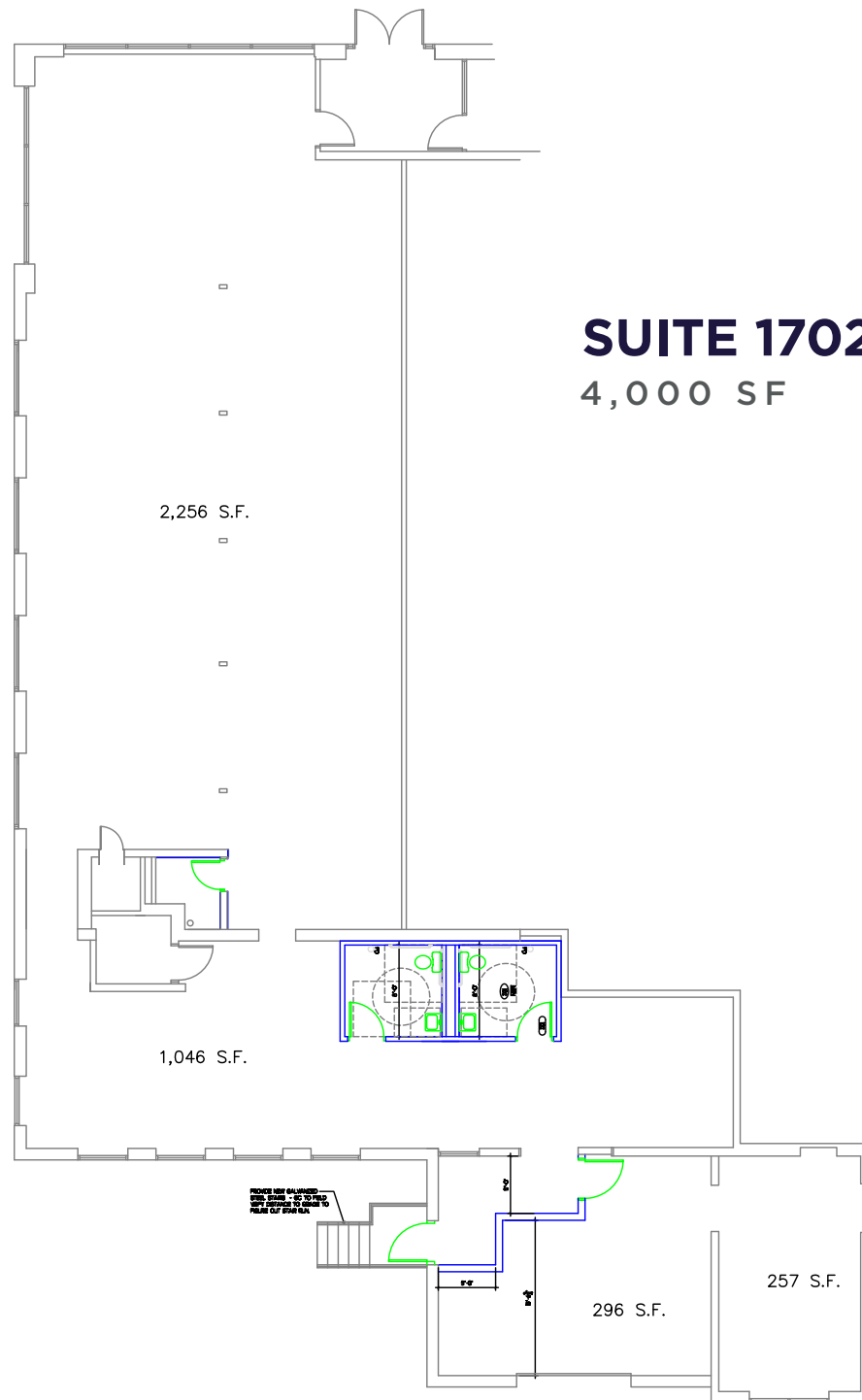

** Floor plan measurements are approximate and are for illustration purposes only.

EXTERIOR PHOTOS



PARKING

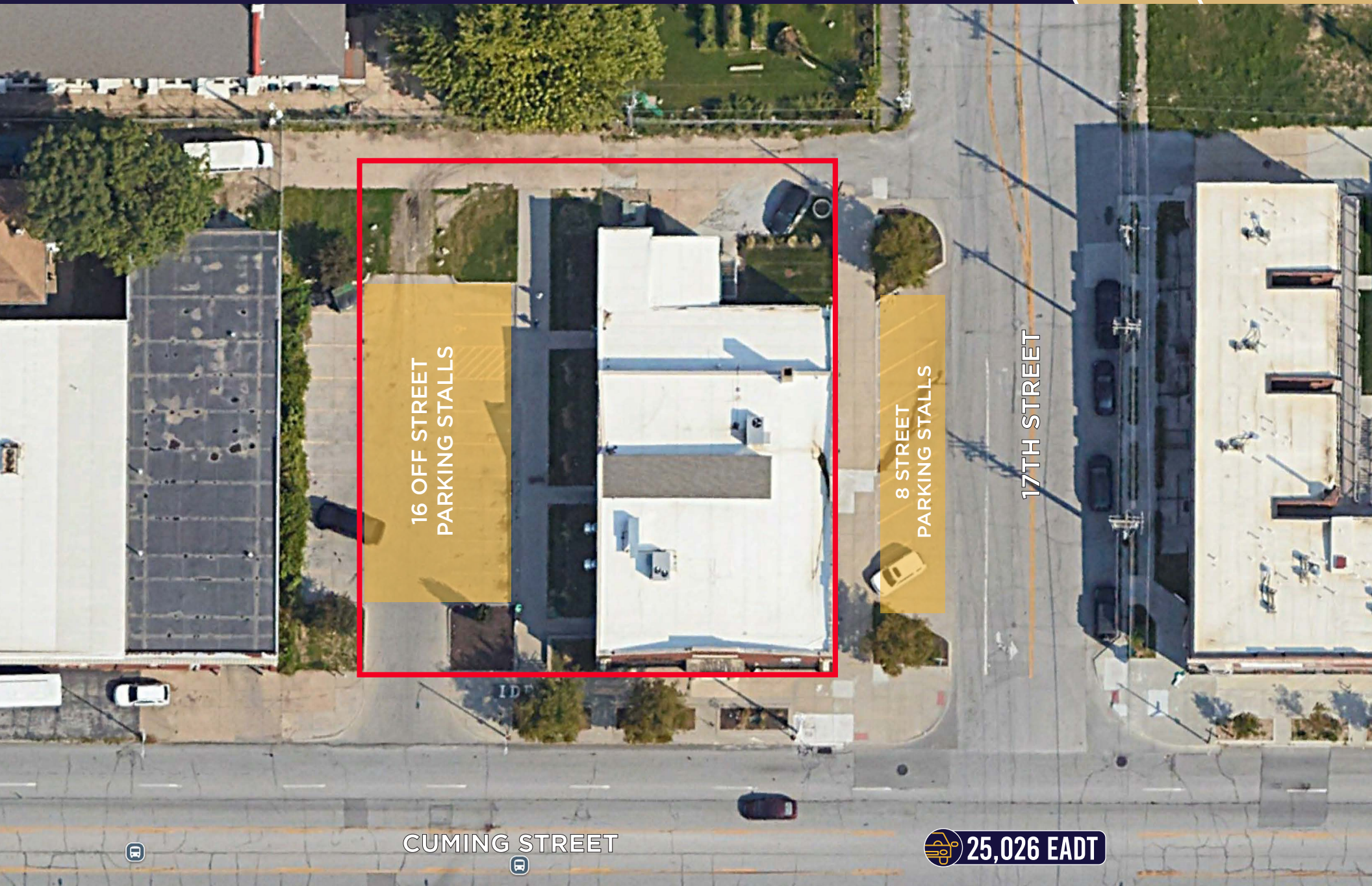

16 OFF STREET
PARKING STALLS

8 STREET
PARKING STALLS

17TH STREET

CUMING STREET

25,026 EADT

AERIAL MAP



BOYS & GIRLS CLUBS



metro



MILLWORK
COMMONS



CUMMING STREET



SITE



Kiewit



CHI Health Center
OMAHA



Creighton
UNIVERSITY



MIDTOWN
CROSSING



Omaha World-Herald



THE
CAPITOL
DISTRICT



INTERSTATE
480



INTERSTATE
480



INTERSTATE
75



**CUSHMAN &
WAKEFIELD**

LUND
COMPANY

For more information, please contact:

Holly Jones

Director of Retail Services
+1 402 548 4038
holly.jones@lundco.com

Trey MacKnight

Associate
+1 402 548 4079
trey.macknight@lundco.com

450 Regency Parkway, Suite 200
Omaha, NE 68114
+1 402 393 8811
lundco.com

Independently Owned and Operated / A Member of the Cushman & Wakefield Alliance

©2024 Cushman & Wakefield. All rights reserved. The information contained in this communication is strictly confidential. This information has been obtained from sources believed to be reliable but has not been verified. NO WARRANTY OR REPRESENTATION, EXPRESS OR IMPLIED, IS MADE AS TO THE CONDITION OF THE PROPERTY (OR PROPERTIES) REFERENCED HEREIN OR AS TO THE ACCURACY OR COMPLETENESS OF THE INFORMATION CONTAINED HEREIN, AND SAME IS SUBMITTED SUBJECT TO ERRORS, OMISSIONS, CHANGE OF PRICE, RENTAL OR OTHER CONDITIONS, WITHDRAWAL WITHOUT NOTICE, AND TO ANY SPECIAL LISTING CONDITIONS IMPOSED BY THE PROPERTY OWNER(S). ANY PROJECTIONS, OPINIONS OR ESTIMATES ARE SUBJECT TO UNCERTAINTY AND DO NOT SIGNIFY CURRENT OR FUTURE PROPERTY PERFORMANCE.