

1540

1555

RIVER PARK DRIVE
SACRAMENTO, CA

PROPERTY HIGHLIGHTS

- Completely renovated and revitalized office park
- Excellent proximity to numerous retail & dining amenities
- Great access to Business 80 & Highway 160
- Conference facilities
- Spaces built out for immediate occupancy
- Featured spaces contain private outdoor balconies
- 4.00/1,000 SF parking ratio

SPENCER NIELSEN

Director
+1 916 288 4531
spencer.nielsen@cushwake.com
CA LIC #01964163

SEAN MULLEN

Managing Director
+1 916 288 4811
sean.mullen@cushwake.com
CA LIC #01845406



1540, 1555 RIVER PARK DRIVE | SACRAMENTO, CA

1540 RIVER PARK DRIVE

1ST FLOOR

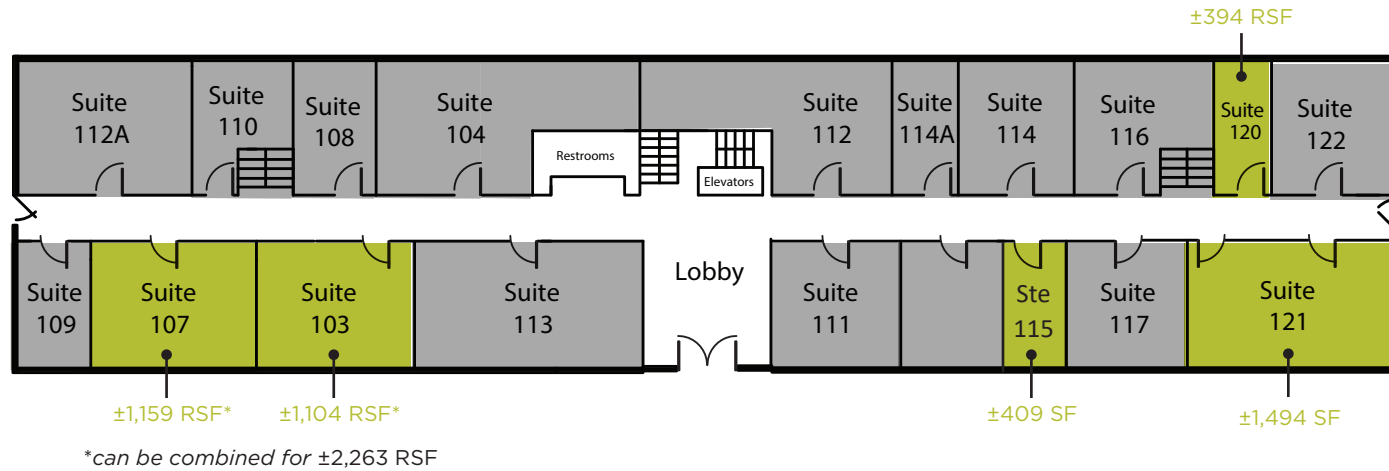

2ND FLOOR

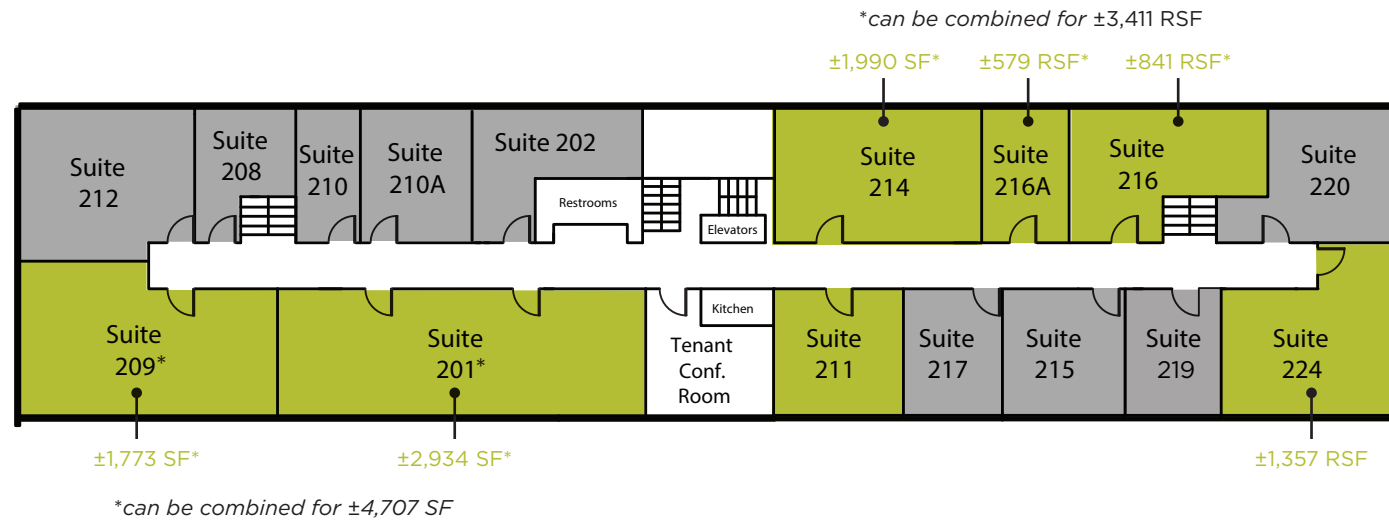

AVAILABLE FOR LEASE **LEASED**

SPENCER NIELSEN

Director
+1 916 288 4531
spencer.nielsen@cushwake.com
CA LIC #01964163

SEAN MULLEN

Managing Director
+1 916 288 4811
sean.mullen@cushwake.com
CA LIC #01845406



The floor plan of the second floor is divided into two main sections by a central horizontal corridor (Lobby). The top section contains Suite 100A on the left, Suite 100 in the center, and Suites 102-108 on the right. The bottom section contains Suite 101 on the left, Suite 103, Suite 105, Suite 107, and Suite 109 on the right. A central vertical corridor (Lobby) runs through the middle of the floor, containing an elevator and restrooms. The rooms are shaded gray, and the corridors are white.

1ST FLOOR

2ND FLOOR

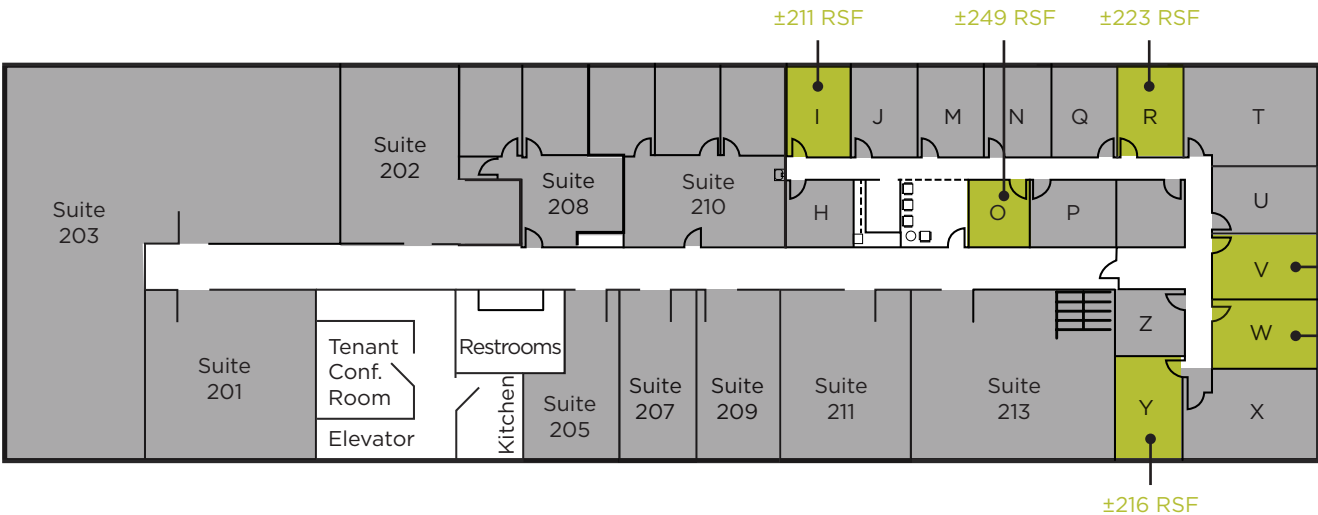

 **AVAILABLE FOR LEASE**  **LEASED**

Director
+1 916 288 4531
spencer.nielsen@cushwake.com
CA LIC #01964163

Managing Director
+1 916 288 4811
sean.mullen@cushwake.com
CA LIC #01845406



1540, 1555 RIVER PARK DRIVE | SACRAMENTO, CA

PROPERTY PHOTOS



SPENCER NIELSEN

Director
+1 916 288 4531
spencer.nielsen@cushwake.com
CA LIC #01964163

SEAN MULLEN

Managing Director
+1 916 288 4811
sean.mullen@cushwake.com
CA LIC #01845406



1540, 1555 RIVER PARK DRIVE | SACRAMENTO, CA



SPENCER NIELSEN

Director
+1 916 288 4531
spencer.nielsen@cushwake.com
CA LIC #01964163

SEAN MULLEN

Managing Director
+1 916 288 4811
sean.mullen@cushwake.com
CA LIC #01845406



SPENCER NIELSEN | DIRECTOR

+1 916 288 4531

spencer.nielsen@cushwake.com

CA LIC #01964163

SEAN MULLEN | MANAGING DIRECTOR

+1 916 288 4811

sean.mullen@cushwake.com

CA LIC #01845406

400 Capitol Mall, Suite 1800

Sacramento, CA 95814

+1 916 288 4800

cushmanwakefield.com

1540