

3274 GREY HAWK COURT

Condo Q, Carlsbad, CA



FOR SALE

INDUSTRIAL CONDO

4,389 RSF



PROPERTY HIGHLIGHTS



GREY HAWK BUSINESS CENTER



±4,389 Square Foot
Industrial Condo



Clear Height: Est. 16'



12'X12' Grade Level Roll-Up
Loading Door



Parking Ratio
3.0 / 1,000 SF



Fully Sprinklered



Zoning: P-M



Located in Highly Desirable
Bressi Ranch Carlsbad
Submarket



Built in 2006



Power: 3-Phase, 400 Amps



Sale Price:
Call Broker For Details

*Power specs to be independently verified

3274 GREY HAWK COURT, CONDO Q, CARLSBAD, CA

SITE PLAN



FLOOR PLAN

4,389 SF

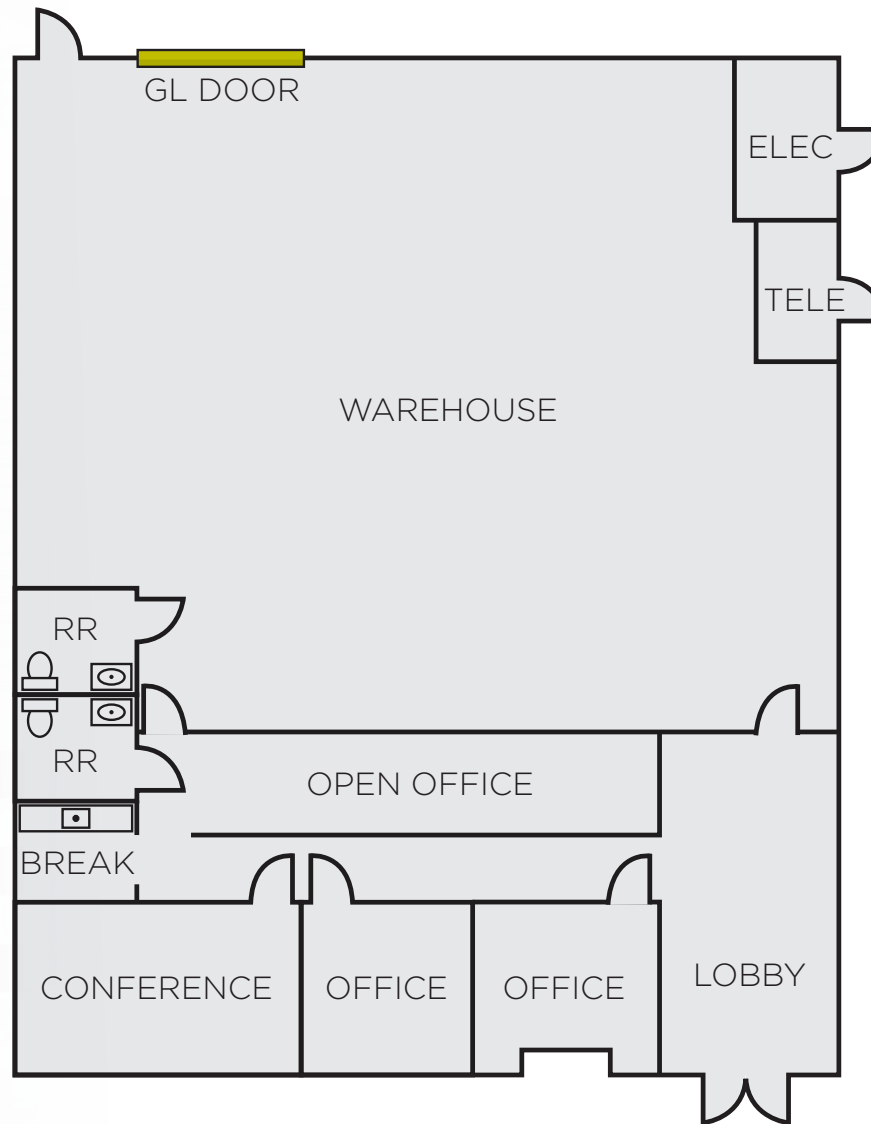

PHOTOS



LOCATION



3274 GREY HAWK COURT, CONDO Q, CARLSBAD, CA

DRIVE TIMES & CORPORATE NEIGHBORS



DRIVE TIMES

6 Minutes to Palomar Airport
12 Minutes to Hwy-78
15 Minutes to I-5
40 Minutes to San Diego Airport

45 Minutes to Downtown San Diego
50 Minutes to Orange County
55 Minutes to International Border

3274 GREY HAWK COURT, CONDO Q //// CARLSBAD

FOR SALE

**FOR MORE
INFORMATION
CONTACT BROKER:**

TYLER STEMLEY

760.908.4270

tyler.stemley@cushwake.com

Lic. No.02003867

©2025 Cushman & Wakefield. All rights reserved. The information contained in this communication is strictly confidential. This information has been obtained from sources believed to be reliable but has not been verified. NO WARRANTY OR REPRESENTATION, EXPRESS OR IMPLIED, IS MADE AS TO THE CONDITION OF THE PROPERTY (OR PROPERTIES) REFERENCED HEREIN OR AS TO THE ACCURACY OR COMPLETENESS OF THE INFORMATION CONTAINED HEREIN, AND SAME IS SUBMITTED SUBJECT TO ERRORS, OMISSIONS, CHANGE OF PRICE, RENTAL OR OTHER CONDITIONS, WITHDRAWAL WITHOUT NOTICE, AND TO ANY SPECIAL LISTING CONDITIONS IMPOSED BY THE PROPERTY OWNER(S). ANY PROJECTIONS, OPINIONS OR ESTIMATES ARE SUBJECT TO UNCERTAINTY AND DO NOT SIGNIFY CURRENT OR FUTURE PROPERTY PERFORMANCE.

