



7220

TRADE STREET

For Sublease

Plug & Play Lab Space



7220

TRADE STREET



Project Highlights

- Plug & play lab space
- Available March 1, 2025
- \$2.65/SF +U
- 2,767 - 6,862 SF Available
- Lease term through October 2026

EVAN CASSOLATO

858 546 5473
 evan.cassolato@cushwake.com
 CA Lic. #02055707

ANNIKA LUND

858 558 5640
 annika.lund@cushwake.com
 CA Lic. #02228297



12830 El Camino Real, Suite 100
 San Diego, CA 92130
 T (858) 452-6500
 F (858) 630-6320
 cushmanwakefield.com

7220

TRADE STREET

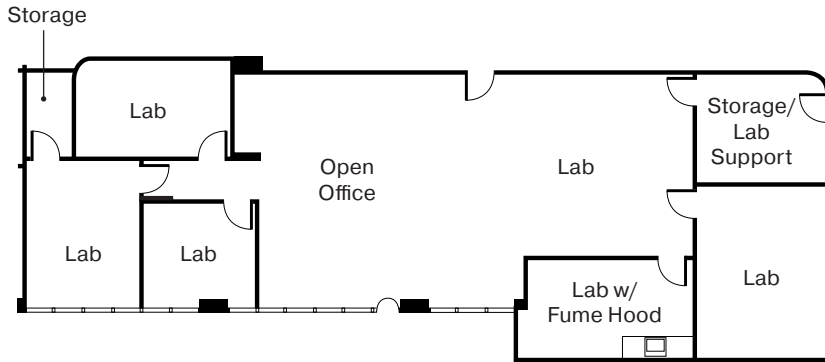

Suite 330 Highlights

- 2,767 SF
- Plug & play lab space with term through October 2026
- 5 Lab support rooms featuring dedicated exhaust, 1 fume hood & 2 sinks
- Lab equipment & FF&E optional
- Open office with 10+ cubicles
- Storage
- Can be leased with Suite 340 for a total of 6,682 SF

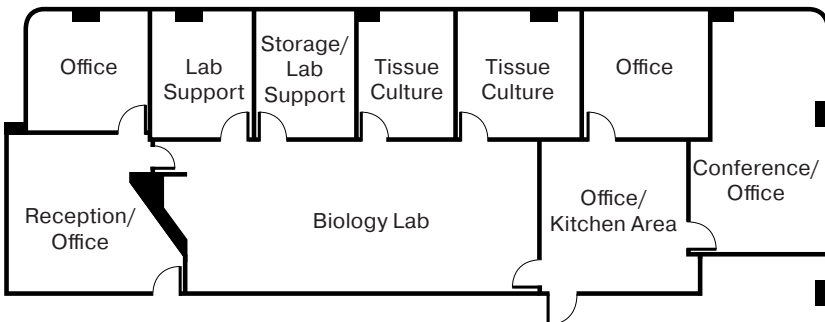

Suite 340 Highlights

- 4,095 SF
- Plug & play lab space with term through October 2026
- Lab equipment & FF&E optional
- 3 Rows of biology benching
- 1 fume hood & 1 sink
- 4 lab support / tissue culture rooms
- Office & conferencing space with AV technology
- Break area / kitchen
- Reception
- Storage
- Can be leased with Suite 330 for a total of 6,682 SF

EVAN CASSOLATO

858 546 5473
 evan.cassolato@cushwake.com
 CA Lic. #02055707

ANNIKA LUND

858 558 5640
 annika.lund@cushwake.com
 CA Lic. #02228297



12830 El Camino Real, Suite 100
 San Diego, CA 92130
 T (858) 452-6500
 F (858) 630-6320
 cushmanwakefield.com

7220

TRADE STREET

Suite 330



EVAN CASSOLATO

858 546 5473

evan.cassolato@cushwake.com

CA Lic. #02055707

ANNIKA LUND

858 558 5640

annika.lund@cushwake.com

CA Lic. #0228297



12830 El Camino Real, Suite 100
San Diego, CA 92130
T (858) 452-6500
F (858) 630-6320
cushmanwakefield.com

7220

TRADE STREET

Suite 340



EVAN CASSOLATO

858 546 5473

evan.cassolato@cushwake.com

CA Lic. #02055707

ANNIKA LUND

858 558 5640

annika.lund@cushwake.com

CA Lic. #0228297



12830 El Camino Real, Suite 100
San Diego, CA 92130
T (858) 452-6500
F (858) 630-6320
cushmanwakefield.com

©2025 Cushman & Wakefield. All rights reserved. The information contained in this communication is strictly confidential. This information has been obtained from sources believed to be reliable but has not been verified. NO WARRANTY OR REPRESENTATION, EXPRESS OR IMPLIED, IS MADE AS TO THE CONDITION OF THE PROPERTY (OR PROPERTIES) REFERENCED HEREIN OR AS TO THE ACCURACY OR COMPLETENESS OF THE INFORMATION CONTAINED HEREIN, AND SAME IS SUBMITTED SUBJECT TO ERRORS, OMISSIONS, CHANGE OF PRICE, RENTAL OR OTHER CONDITIONS, WITHDRAWAL WITHOUT NOTICE, AND TO ANY SPECIAL LISTING CONDITIONS IMPOSED BY THE PROPERTY OWNER(S). ANY PROJECTIONS, OPINIONS OR ESTIMATES ARE SUBJECT TO UNCERTAINTY AND DO NOT SIGNIFY CURRENT OR FUTURE PROPERTY PERFORMANCE.