

*Available January 1, 2026*



**FOR LEASE – ±100,000 SF**

**1104 PIEDMONT HIGHWAY**

*Piedmont, SC 29673*



# PROPERTY FEATURES

## 1104 PIEDMONT HIGHWAY

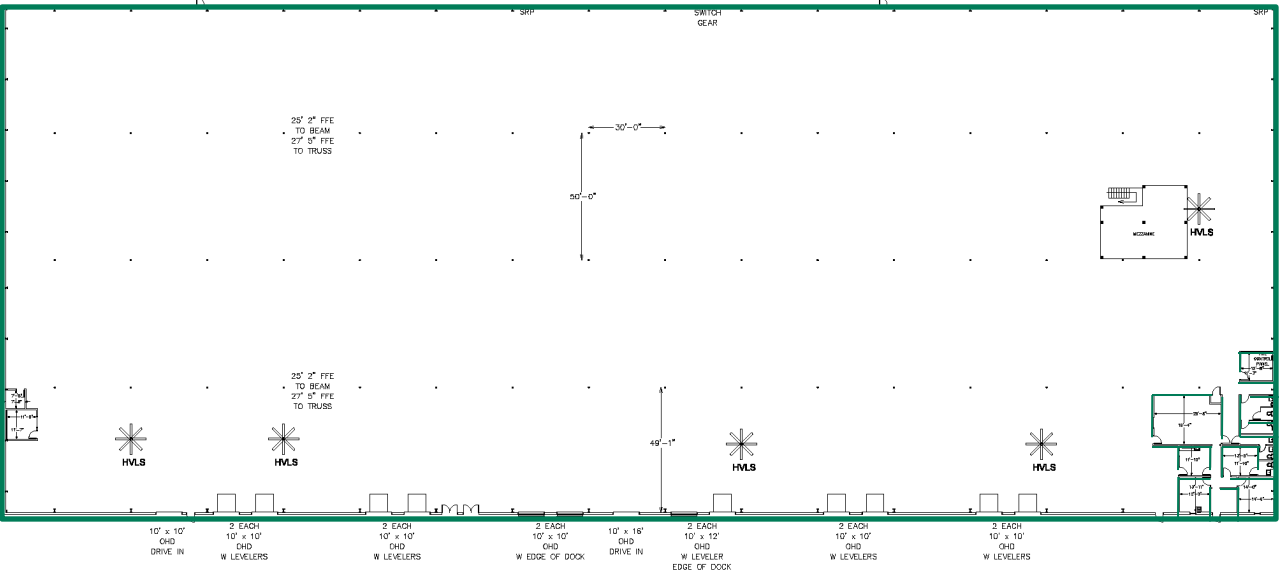

BUILDING SIZE:	±100,000 SF
SPACE AVAILABLE:	±100,000 SF
OFFICE AREA:	± 2,000 SF
SITE AREA:	24.15 AC
CLEAR HEIGHT:	21'-29'
DOCK DOORS:	6 (10'x12'); 6 (10'x10')
DRIVE-INS:	1 (10'x16'); 1 (10'x10')
PARKING:	25
YEAR BUILT:	1995 (Renov. 1997)
COLUMN SPACING:	50' x 30'
SPRINKLER:	ESFR
ELECTRICAL:	3phase
LEASE RATE:	Call brokers for details





# LOCATION MAP

## 1104 PIEDMONT HIGHWAY

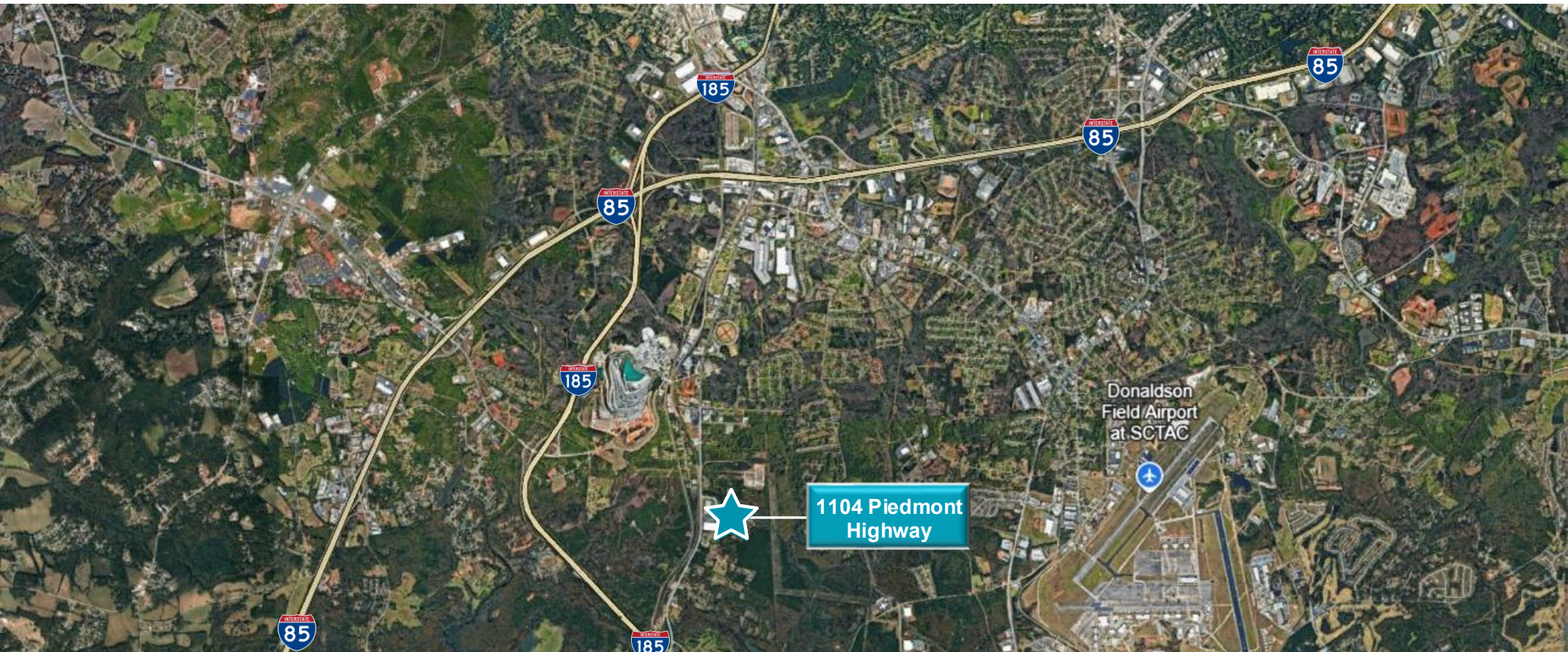

DEMOGRAPHICS 10 MILES

**343,407**  
POPULATION

**139,511**  
HOUSEHOLDS

**\$86,608**  
AVG HH INCOME

Nearby  
Neighbors





# PROXIMITY MAP

## 1104 PIEDMONT HIGHWAY

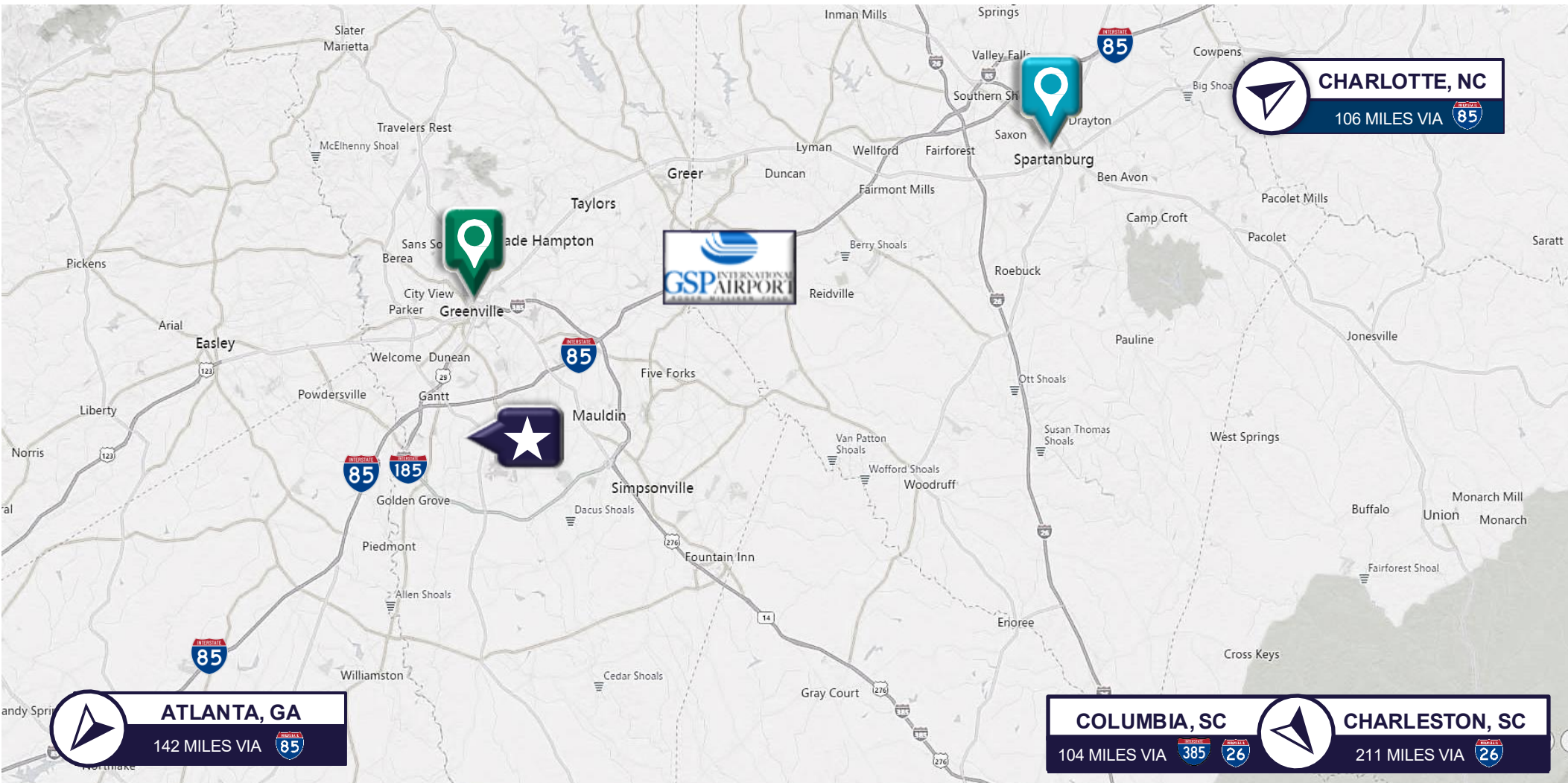

### MILEAGE & DRIVE TIME



**GREENVILLE**



7.2 MILES VIA SC-20 N



13 MINS VIA SC-20 N



**GREENVILLE-SPARTANBURG  
INTERNATIONAL AIRPORT (GSP)**



16.9 MILES VIA I-85 N



18 MINS VIA I-85 N



**SPARTANBURG**



35.7 MILES VIA I-85 N



39 MINS VIA I-85 N





## FOR MORE INFORMATION, CONTACT:

**KACIE JACKSON, SIOR**

Senior Director

+1 864 370 8193

[kacie.jackson@cushwake.com](mailto:kacie.jackson@cushwake.com)

**ELLIOTT FAYSSOUX, SIOR**

Senior Director

+1 864 370 8190

[elliott.fayssoux@cushwake.com](mailto:elliott.fayssoux@cushwake.com)

**DREW WALTERS**

Associate

+1 864 704 1345

[andrew.walters@cushwake.com](mailto:andrew.walters@cushwake.com)

©2025 Cushman & Wakefield. All rights reserved. The information contained in this communication is strictly confidential. This information has been obtained from sources believed to be reliable but has not been verified. NO WARRANTY OR REPRESENTATION, EXPRESS OR IMPLIED, IS MADE AS TO THE CONDITION OF THE PROPERTY (OR PROPERTIES) REFERENCED HEREIN OR AS TO THE ACCURACY OR COMPLETENESS OF THE INFORMATION CONTAINED HEREIN, AND SAME IS SUBMITTED SUBJECT TO ERRORS, OMISSIONS, CHANGE OF PRICE, RENTAL OR OTHER CONDITIONS, WITHDRAWAL WITHOUT NOTICE, AND TO ANY SPECIAL LISTING CONDITIONS IMPOSED BY THE PROPERTY OWNER(S). ANY PROJECTIONS, OPINIONS OR ESTIMATES ARE SUBJECT TO UNCERTAINTY AND DO NOT SIGNIFY CURRENT OR FUTURE PROPERTY PERFORMANCE.

