

80-90 TIVERTON COURT

Markham, Ontario

 CUSHMAN &
WAKEFIELD



AVAILABLE SPACE

80 Tiverton Court

~~100 - LEASED~~

101 - 6,013 SF

~~200 - LEASED~~

~~205 - LEASED~~

300 - 12,629 SF

301 - 3,100 SF

601 - 5,521 SF

701 - 7,893 SF

~~702 - LEASED~~

703 - 3,250 SF

801 - 2,500 SF

~~803A - LEASED~~

90 Tiverton Court

~~Unit 100 - LEASED~~

Asking Rent: \$16.00

Additional Rent: \$12.75



Newly Renovated Lobby



Food Service Provider Onsite



Parking 4:1,000 SF
Underground Parking Available



Fitness Centre with Squash Court

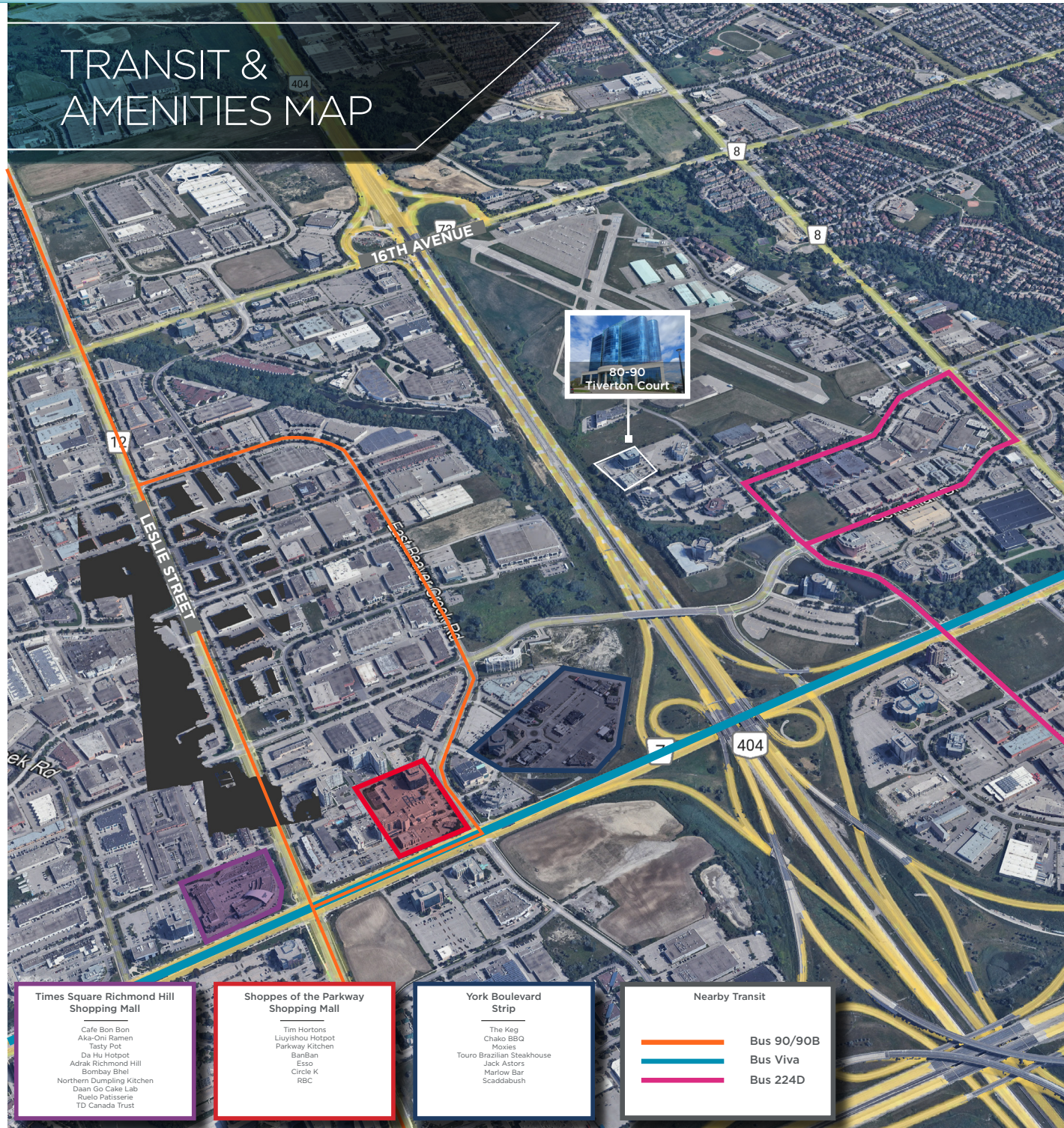



Suite 100: 5,624 SF

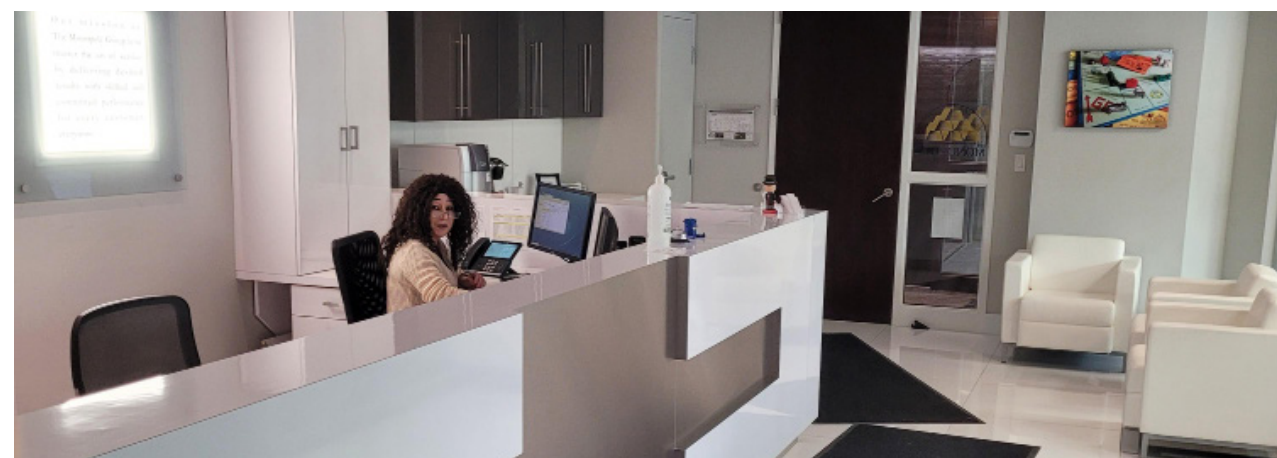
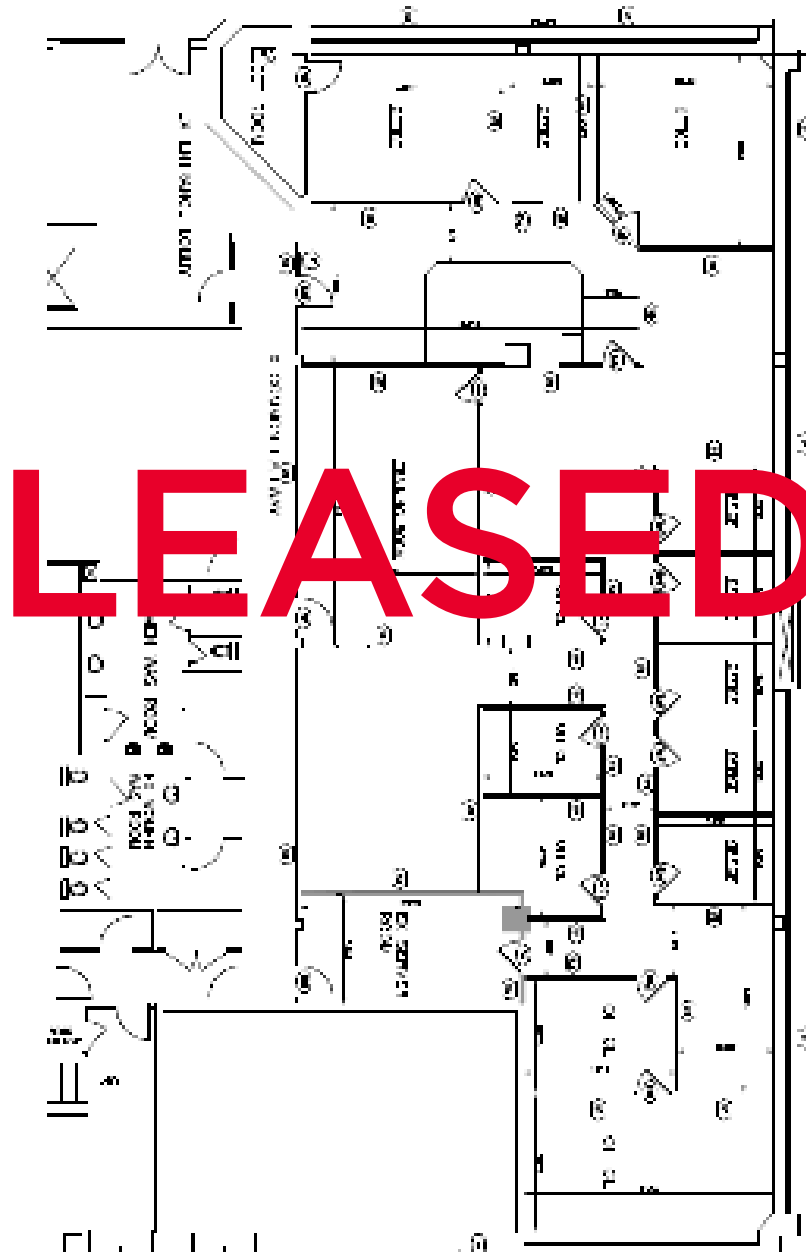

80-90 Tiverton Court

Markham, Ontario



For more information please contact:

ZARKO STOJANOVIC*

Vice President

D: 416-756-5440

M: 416-219-0716

Zarko.Stojanovic@cushwake.com

CUSHMAN & WAKEFIELD ULC, BROKERAGE

1500 Don Mills Road, Suite #401

Toronto, Ontario

M3B3K4

©2025 Cushman & Wakefield ULC, Brokerage. All rights reserved. The information contained in this communication is strictly confidential. This information has been obtained from sources believed to be reliable but has not been verified. NO WARRANTY OR REPRESENTATION, EXPRESS OR IMPLIED, IS MADE AS TO THE CONDITION OF THE PROPERTY (OR PROPERTIES) REFERENCED HEREIN OR AS TO THE ACCURACY OR COMPLETENESS OF THE INFORMATION CONTAINED HEREIN, AND SAME IS SUBMITTED SUBJECT TO ERRORS, OMISSIONS, CHANGE OF PRICE, RENTAL OR OTHER CONDITIONS, WITHDRAWAL WITHOUT NOTICE, AND TO ANY SPECIAL LISTING CONDITIONS IMPOSED BY THE PROPERTY OWNER(S). ANY PROJECTIONS, OPINIONS OR ESTIMATES ARE SUBJECT TO UNCERTAINTY AND DO NOT SIGNIFY CURRENT OR FUTURE PROPERTY PERFORMANCE. *Sales Representative **Broker