

# FOR LEASE

## Lilburn Corporate Park

11600-11601 Lilburn Park Road / St.Louis, MO



## 16,830 SF FLEX WAREHOUSE AVAILABLE

- Total Building Area:** 49,195 SF
- Total Available Area:** ±16,830 SF
- Office Area:** ±13,464 SF
- Clear Height:** 17'
- Loading:** Four (4) Docks, One (1) Drive-In
- Sprinkler:** Wet System
- Parking:** 2.8/1,000 SF
- Location:** Centrally located and within minutes of I-270. Surrounded by hotels, restaurants, and other amenities.
- Lease Rate:** **\$13.75/SF NNN**

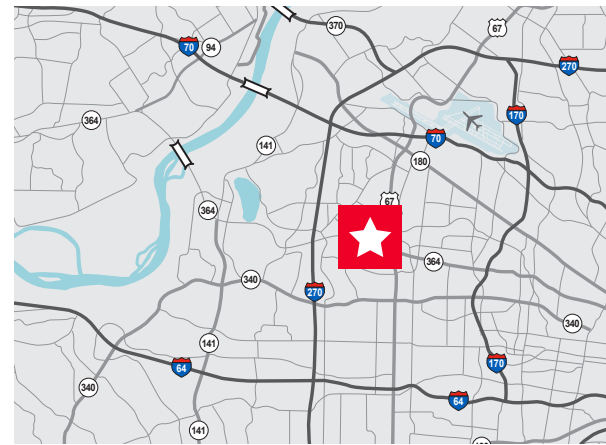

### Contact

MATT EASTIN, SIOR, CCIM  
+1 314 746 0350  
matt.eastin@cushwake.com

ED LAMPITT, SIOR, CCIM  
+1 314 746 0383  
ed.lampitt@cushwake.com

**OWNED BY:**



Investment & Management Co.

**LEASED BY:**



# FOR LEASE Lilburn Corporate Park

11600-11601 Lilburn Park Road / St.Louis, MO



## FLOOR PLAN

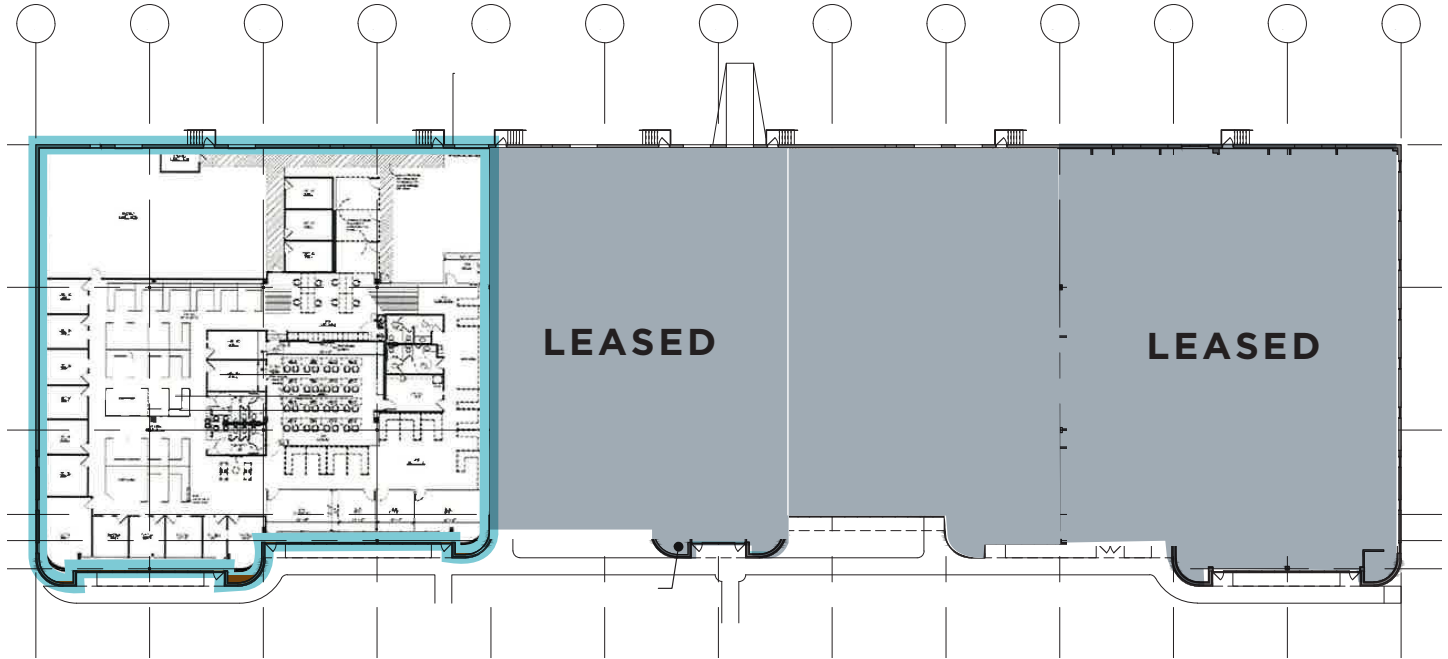

## AERIAL



## Contact

**MATT EASTIN, SIOR, CCIM**  
+1 314 746 0350  
matt.eastin@cushwake.com

**ED LAMPITT, SIOR, CCIM**  
+1 314 746 0383  
ed.lampitt@cushwake.com

©2025 Cushman & Wakefield. All rights reserved. The information contained in this communication is strictly confidential. This information has been obtained from sources believed to be reliable but has not been verified. No warranty or representation, express or implied, is made as to the condition of the property (or properties) referenced herein or as to the accuracy or completeness of the information contained herein, and same is submitted subject to errors, omissions, change of price, rental or other conditions, withdrawal without notice, and to any special listing conditions imposed by the property owner(s). Any projections, opinions or estimates are subject to uncertainty and do not signify current or future property performance.