

FOR LEASE

Lilburn Corporate Park

11600-11601 Lilburn Park Road / St.Louis, MO



AVAILABLE 1/1/26

16,830 SF FLEX WAREHOUSE AVAILABLE

Total Building Area:	49,195 SF
Total Available Area:	±16,830 SF
Office Area:	±13,464 SF
Clear Height:	17'
Loading:	Four (4) Docks, One (1) Drive-In
Sprinkler:	Wet System
Parking:	2.8/1,000 SF
Location:	Centrally located and within minutes of I-270. Surrounded by hotels, restaurants, and other amenities.

Lease Rate: **\$13.75/SF NNN**

Contact

MATT EASTIN, SIOR, CCIM
+1 314 746 0350
matt.eastin@cushwake.com

CHRISTY WIRTH, SIOR, CCIM
+1 314 813 9524
christy.wirth@cushwake.com

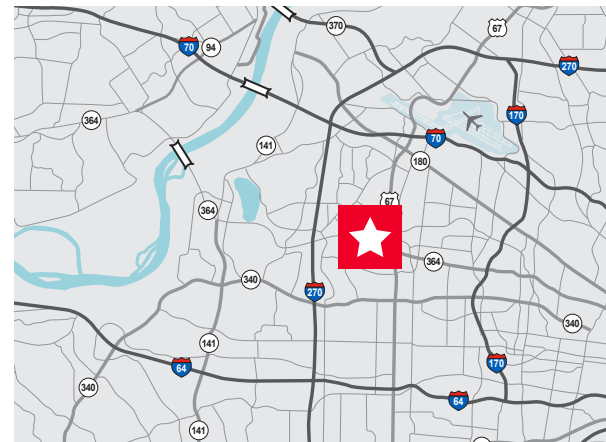

OWNED BY:

GLEN UNA

Investment & Management Co.

LEASED BY:

CUSHMAN & WAKEFIELD

FOR LEASE Lilburn Corporate Park

11600-11601 Lilburn Park Road / St.Louis, MO



FLOOR PLAN

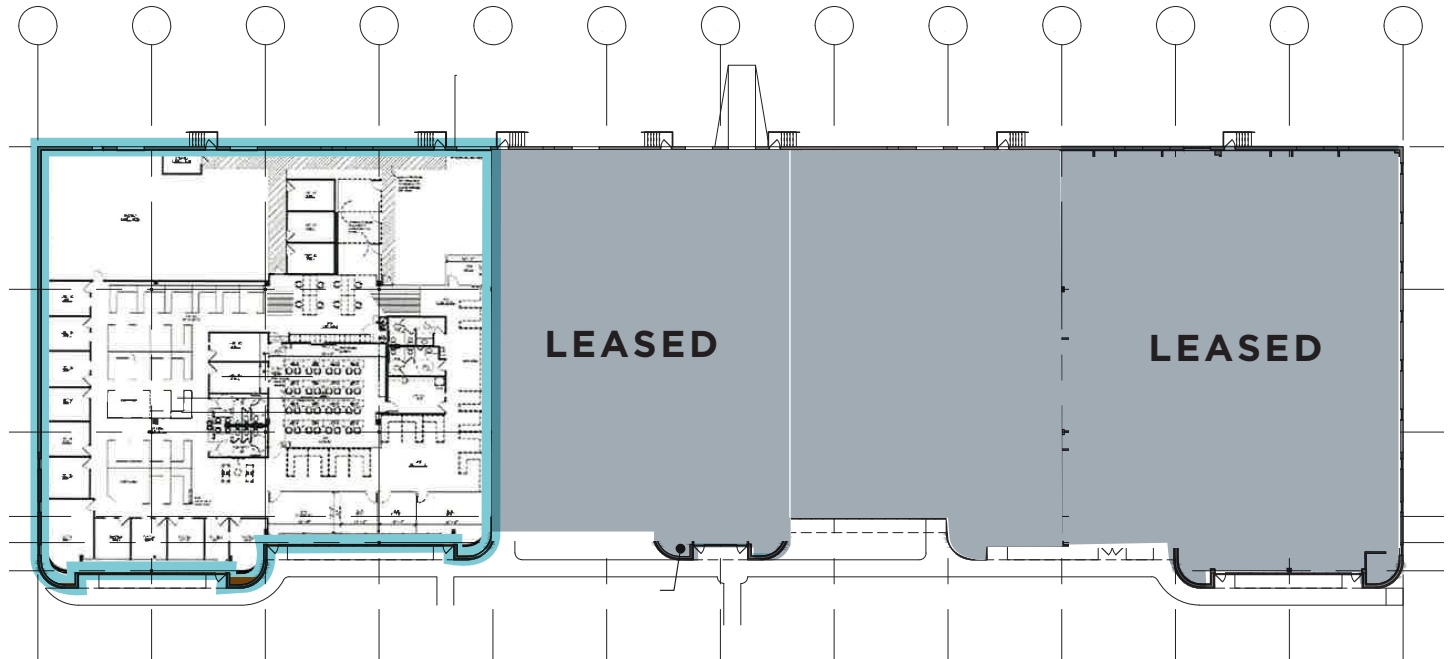

AERIAL



Contact

MATT EASTIN, SIOR, CCIM
+1 314 746 0350
matt.eastin@cushwake.com

CHRISTY WIRTH, SIOR, CCIM
+1 314 813 9524
christy.wirth@cushwake.com

©2025 Cushman & Wakefield. All rights reserved. The information contained in this communication is strictly confidential. This information has been obtained from sources believed to be reliable but has not been verified. No warranty or representation, express or implied, is made as to the condition of the property (or properties) referenced herein or as to the accuracy or completeness of the information contained herein, and same is submitted subject to errors, omissions, change of price, rental or other conditions, withdrawal without notice, and to any special listing conditions imposed by the property owner(s). Any projections, opinions or estimates are subject to uncertainty and do not signify current or future property performance.