



**CUSHMAN &  
WAKEFIELD**

## SPACE AVAILABLE COMMERCE PARK PLAZA

4850-4890 DUFF DRIVE  
WEST CHESTER, OH 45246

**OFFICE/WAREHOUSE**

**SPACE FOR LEASE**

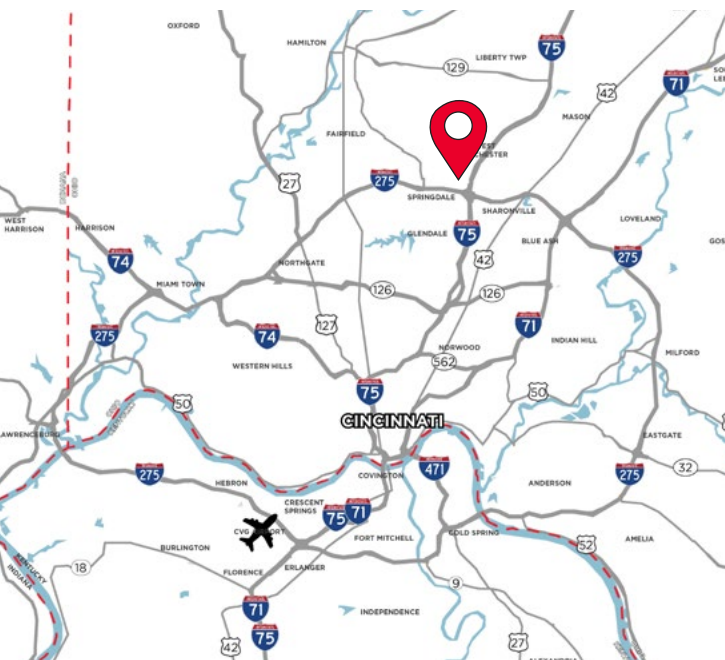

### **PROPERTY HIGHLIGHTS**

- 2,000 - 4,000 SF Available
- Office/Warehouse Space
- Wet Fire System
- Zoned M-2
- No Earnings Tax
- Easy access to I-75 & I-275

For more information, contact:

**Tom McCormick, SIOR, CCIM**  
Managing Director  
+1 513 763 3025  
tom.mccormick@cushwake.com

**Ben McNab, SIOR, CCIM**  
Managing Director  
+1 513 763 3019  
ben.mcnab@cushwake.com

**Seattle Stein**  
Senior Associate  
+1 513 763 3027  
seattle.stein@cushwake.com

201 E. Fourth Street, Suite 1800  
Cincinnati, OH 45202  
P: +1 513 421 4884  
cushmanwakefield.com

©2022 Cushman & Wakefield. All rights reserved. The information contained in this communication is strictly confidential. This information has been obtained from sources believed to be reliable but has not been verified. NO WARRANTY OR REPRESENTATION, EXPRESS OR IMPLIED, IS MADE AS TO THE CONDITION OF THE PROPERTY (OR PROPERTIES) REFERENCED HEREIN OR AS TO THE ACCURACY OR COMPLETENESS OF THE INFORMATION CONTAINED HEREIN, AND SAME IS SUBMITTED SUBJECT TO ERRORS, OMISSIONS, CHANGE OF PRICE, RENTAL OR OTHER CONDITIONS, WITHDRAWAL WITHOUT NOTICE, AND TO ANY SPECIAL LISTING CONDITIONS IMPOSED BY THE PROPERTY OWNER(S). ANY PROJECTIONS, OPINIONS OR ESTIMATES ARE SUBJECT TO UNCERTAINTY AND DO NOT SIGNIFY CURRENT OR FUTURE PROPERTY PERFORMANCE.

# FOR LEASE COMMERCE PARK PLAZA

WEST CHESTER, OH 45246

## BUILDING SPECIFICATIONS

LOCATION	West Chester, OH	DOCK DOORS	Multiple
ACRES	3.89	ZONING	M-2, General Industrial
YEAR BUILT	1979	ELECTRIC	120/208 volt, 225 amps, 3 phase
CONSTRUCTION	Pre-engineered metal	HVAC	Gas-fired heat in warehouse
CLEAR HEIGHT	16'	ELECTRIC/GAS	<a href="http://www.duke-energy.com">www.duke-energy.com</a>
COLUMN SPACE	26' x 40'	WATER/SEWER	<a href="http://www.butlercountyohio.org">www.butlercountyohio.org</a>
PARKING	20± parking spaces	TELEPHONE	<a href="http://www.cincinnati-bell.com">www.cincinnati-bell.com</a>
FIRE SUPPRESSION	Wet System	DATA	<a href="http://www.spectrum.com">www.spectrum.com</a>
LIGHTING	Fluorescent/Metal Halide	OPEX:	\$2.20/psf

Building	Unit #	Space SF	Warehouse SF	Office SF	Doors	Lease Rate
Building A	4860E	2,000 SF	1,000 SF	1,000 SF	1 Dock Door	\$7.95/SF
Building A	4860B	4,000 SF	2,000 SF	1,500 SF	2 Dock Doors	\$7.50/SF
Building B	4866D	3,900 SF	2,800 SF	1,100 SF	2 Dock Doors	\$6.95/SF
Building C	4884C	2,650 SF	1,650 SF	1,000 SF	1 Dock Door	\$8.95/SF

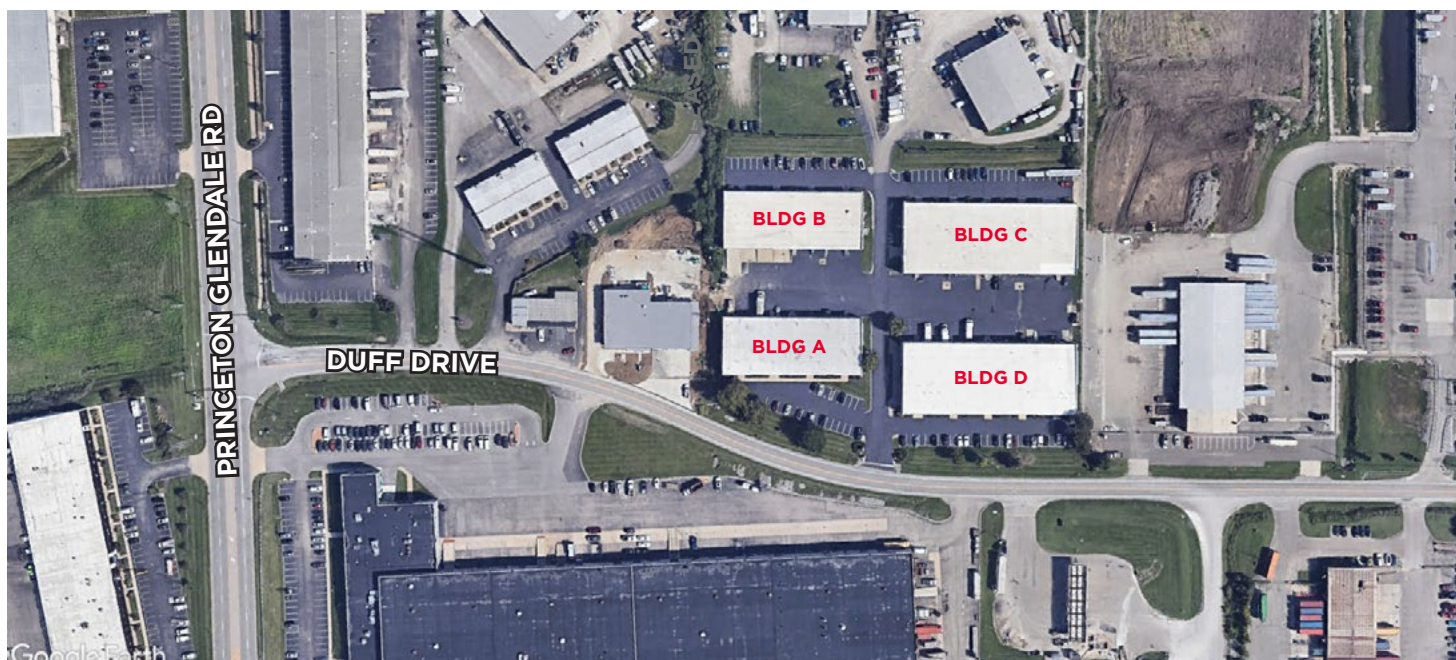



FOR LEASE

# COMMERCE PARK PLAZA

WEST CHESTER, OH 45246

## SITE PLAN



FOR LEASE

# COMMERCE PARK PLAZA

WEST CHESTER, OH 45246

## BUILDING A

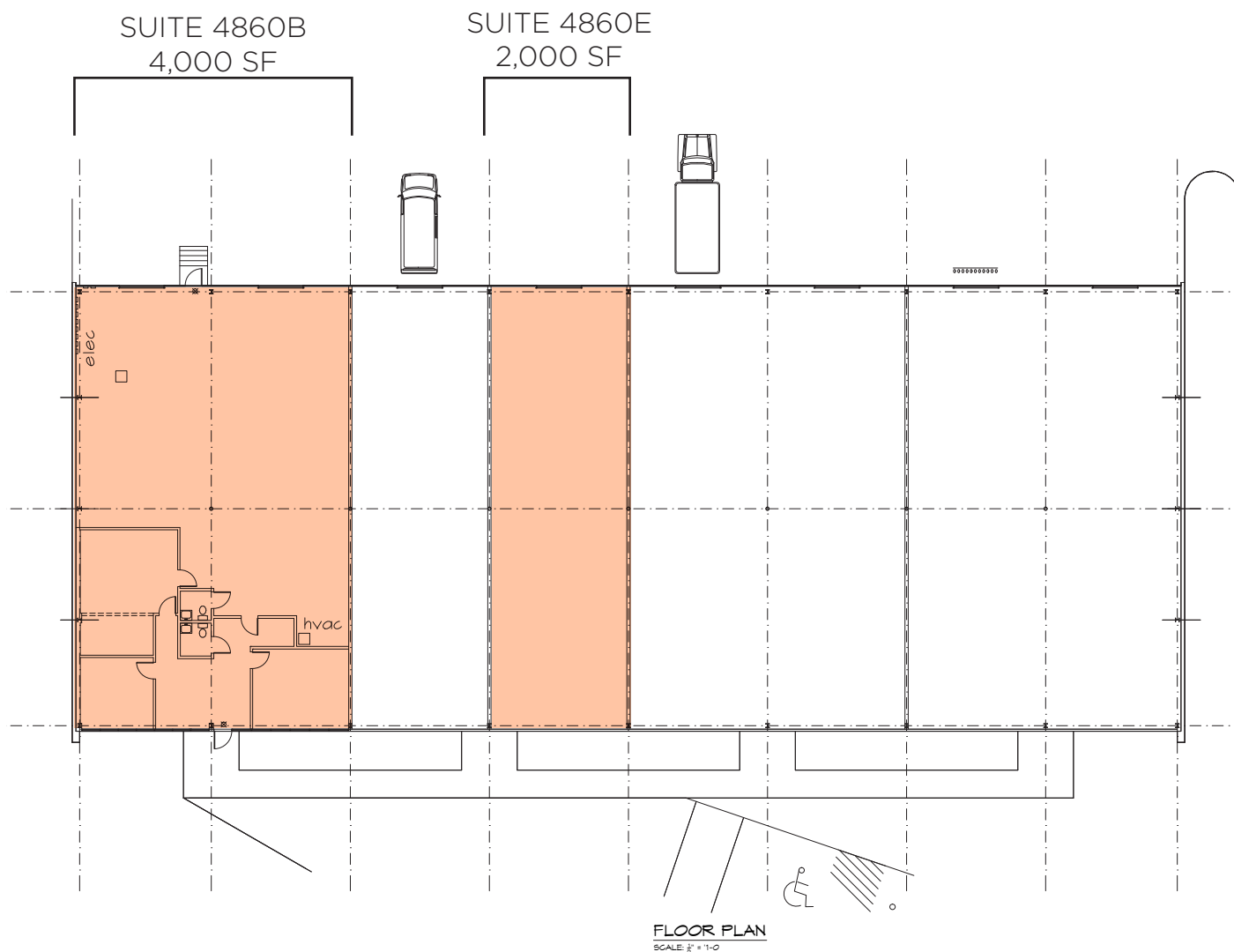

FOR LEASE

# COMMERCE PARK PLAZA

WEST CHESTER, OH 45246

## BUILDING B

SUITE 4866D  
3,900 SF

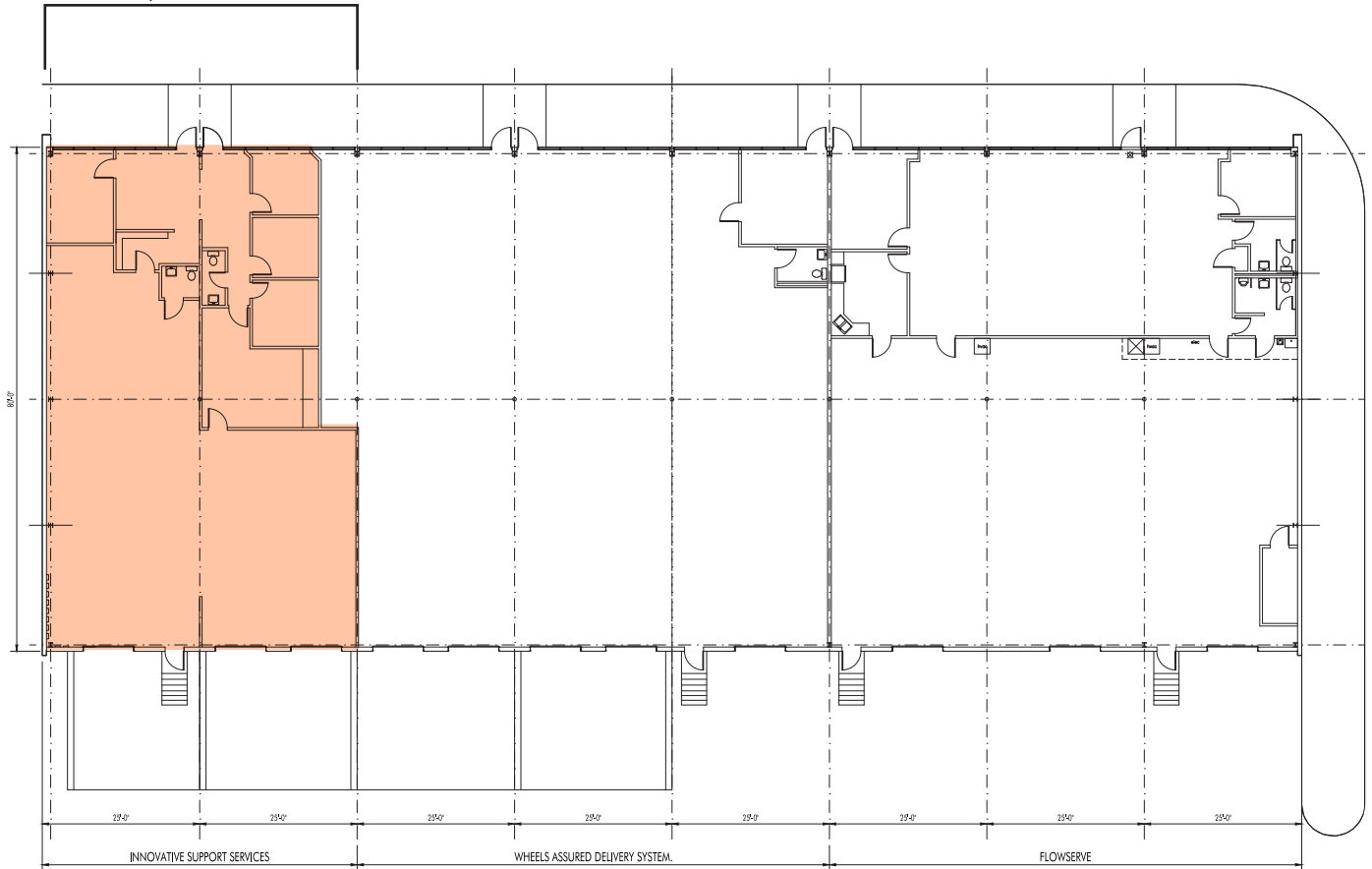

FLOOR PLAN  
SCALE: 1/8" = 1'-0"

FOR LEASE

# COMMERCE PARK PLAZA

WEST CHESTER, OH 45246

## BUILDING C

SUITE 4884C  
2,650 SF

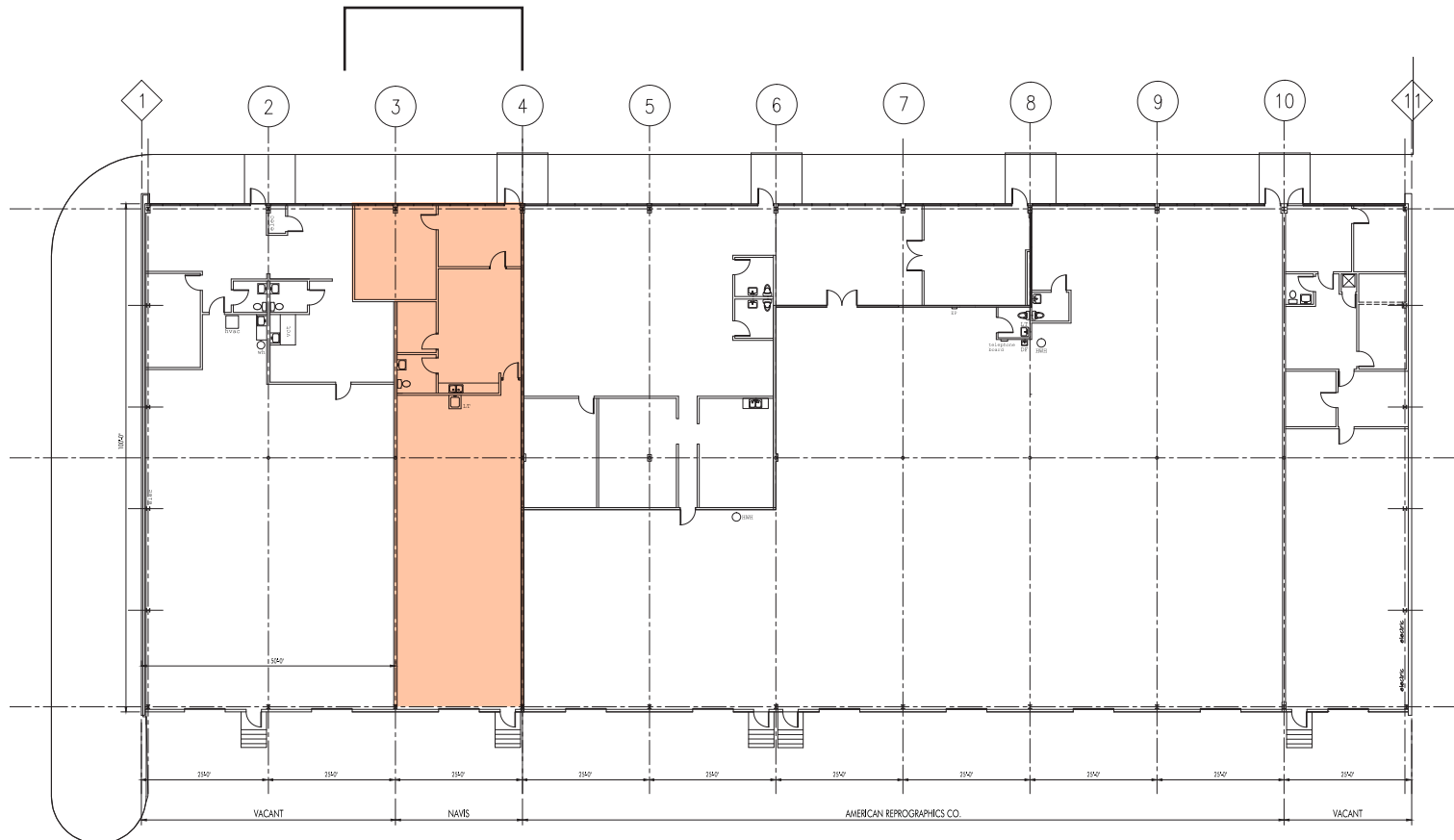

FLOOR PLAN  
SCALE: 1/8" = 1'-0"



FOR LEASE

# COMMERCE PARK PLAZA

WEST CHESTER, OH 45246

## AERIAL LOCATION

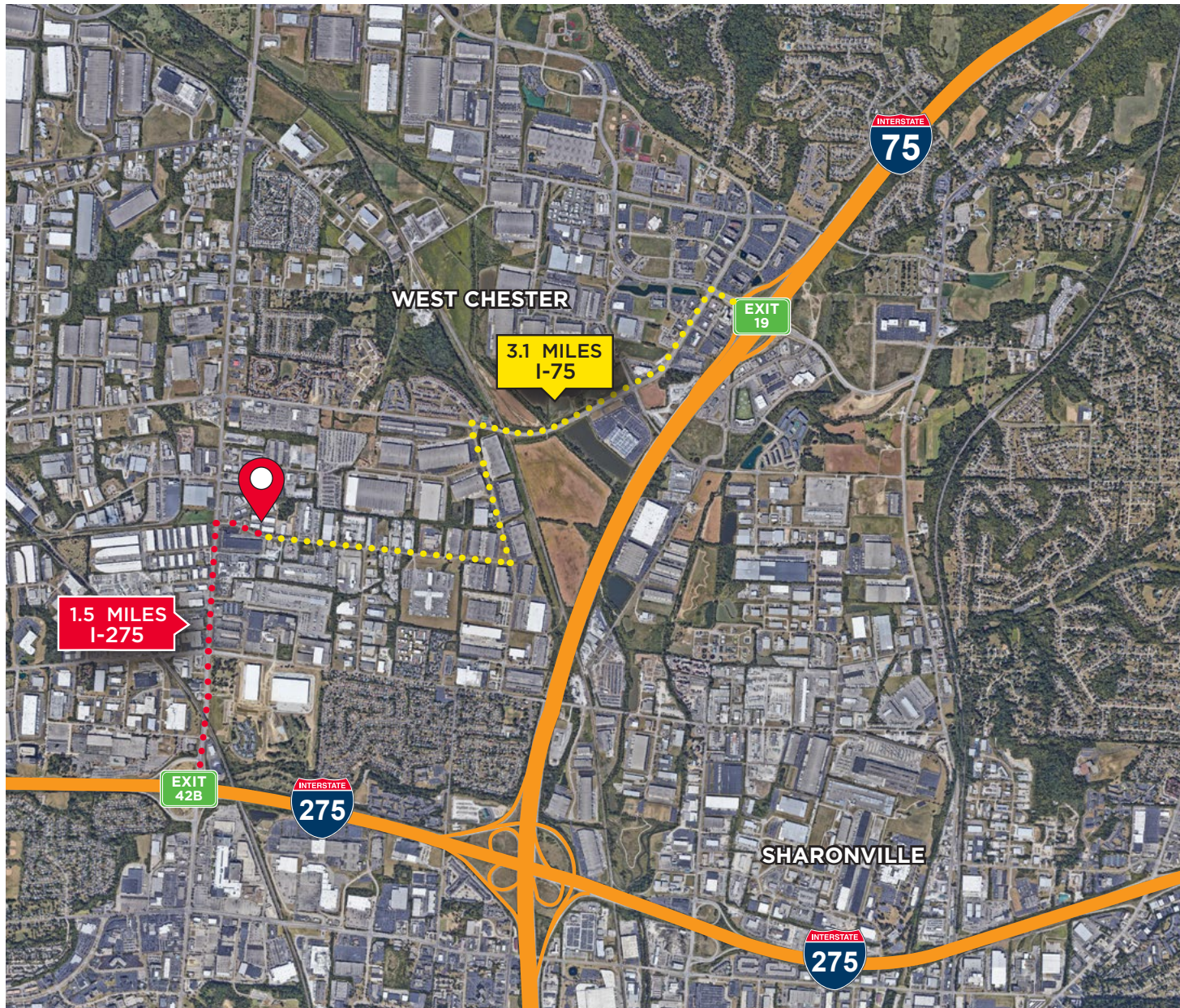

For more information, contact:

**Tom McCormick, SIOR, CCIM**  
Managing Director  
+1 513 763 3025  
[tom.mccormick@cushwake.com](mailto:tom.mccormick@cushwake.com)

**Ben McNab, SIOR, CCIM**  
Managing Director  
+1 513 763 3019  
[ben.mcnab@cushwake.com](mailto:ben.mcnab@cushwake.com)

**Seattle Stein**  
Associate  
+1 513 763 3027  
[seattle.stein@cushwake.com](mailto:seattle.stein@cushwake.com)

201 E. Fourth Street, Suite 1800  
Cincinnati, OH 45202  
P: +1 513 421 4884  
[cushmanwakefield.com](http://cushmanwakefield.com)

©2022 Cushman & Wakefield. All rights reserved. The information contained in this communication is strictly confidential. This information has been obtained from sources believed to be reliable but has not been verified. NO WARRANTY OR REPRESENTATION, EXPRESS OR IMPLIED, IS MADE AS TO THE CONDITION OF THE PROPERTY (OR PROPERTIES) REFERENCED HEREIN OR AS TO THE ACCURACY OR COMPLETENESS OF THE INFORMATION CONTAINED HEREIN, AND SAME IS SUBMITTED SUBJECT TO ERRORS, OMISSIONS, CHANGE OF PRICE, RENTAL OR OTHER CONDITIONS, WITHDRAWAL WITHOUT NOTICE, AND TO ANY SPECIAL LISTING CONDITIONS IMPOSED BY THE PROPERTY OWNER(S). ANY PROJECTIONS, OPINIONS OR ESTIMATES ARE SUBJECT TO UNCERTAINTY AND DO NOT SIGNIFY CURRENT OR FUTURE PROPERTY PERFORMANCE.