

FOR SUBLEASE | FLEX SPACE

# 450 SHERMAN AVE N

HAMILTON, ON



UP TO 6 MONTHS RENT FREE

OPPORTUNITY DETAILS

TOTAL SIZE:	4,133 SF
LAYOUT CONFIGURATIONS:	Private Offices - approx 1,100 SF Open Space - approx. 2,560 SF
ZONING:	M13
CLEAR HEIGHT:	9' to drop ceiling
LOADING:	Double door access at dock height
PARKING:	Ample stalls in front of unit
LEASE RATE:	<b>\$16.50 PSF Gross per Annum</b> (excludes janitorial)
AVAILABILITY:	Immediate
FLEXIBLE TERM:	12 months to 90 months

- Suitable for many uses- R&D and lab space, high tech services & assembly, office, port related support services
- Recently renovated and move in condition
- Flexible lease term
- Ground floor accessible space.
- Potential to increase the size by including 2nd floor space with landlord
- Options for outside storage yard space for storage

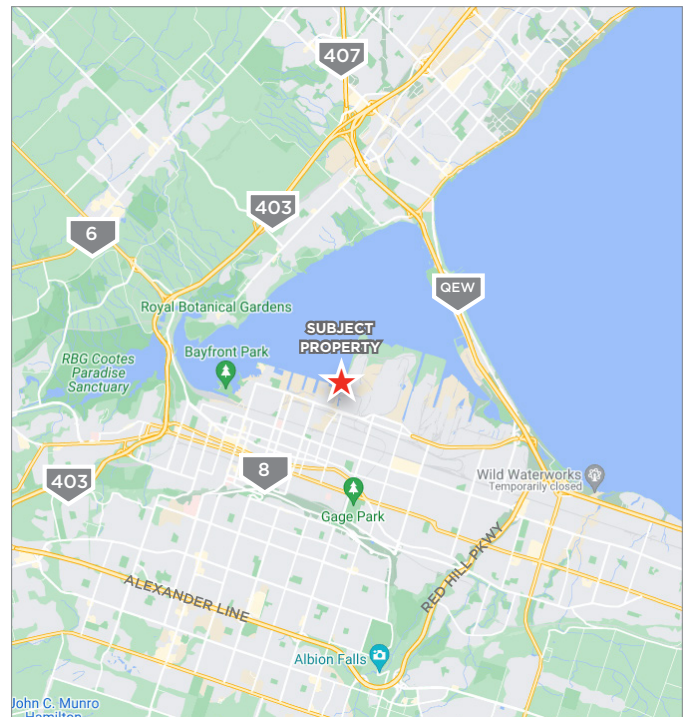

## CONTACT INFORMATION

WALTER SPOJA\*

Associate Vice President

905 501 6469

walter.spoja@cushwake.com

CUSHMAN & WAKEFIELD ULC, BROKERAGE

1 Prologis Blvd., Suite 300  
Mississauga, Ontario L5W 0G2

905 568 9500

[cushmanwakefield.com](http://cushmanwakefield.com)

©2024 Cushman & Wakefield. All rights reserved. The information contained in this communication is strictly confidential. This information has been obtained from sources believed to be reliable but has not been verified. No warranty or representation, express or implied, is made as to the condition of the property (or properties) referenced herein or as to the accuracy or completeness of the information contained herein, and same is submitted subject to errors, omissions, change of price, rental or other conditions, withdrawal without notice, and to any special listing conditions imposed by the property owner(s). Any projections, opinions or estimates are subject to uncertainty and do not signify current or future property performance. \*Sales Representative



FOR SUBLEASE | FLEX SPACE

# 450 SHERMAN AVE N

HAMILTON, ON



## IMAGE GALLERY



## CONTACT INFORMATION

**WALTER SPOJA\***

Associate Vice President

905 501 6469

[walter.spoja@cushwake.com](mailto:walter.spoja@cushwake.com)

**CUSHMAN & WAKEFIELD ULC, BROKERAGE**

1 Prologis Blvd., Suite 300

Mississauga, Ontario L5W 0G2

905 568 9500

[cushmanwakefield.com](http://cushmanwakefield.com)

©2024 Cushman & Wakefield. All rights reserved. The information contained in this communication is strictly confidential. This information has been obtained from sources believed to be reliable but has not been verified. No warranty or representation, express or implied, is made as to the condition of the property (or properties) referenced herein or as to the accuracy or completeness of the information contained herein, and same is submitted subject to errors, omissions, change of price, rental or other conditions, withdrawal without notice, and to any special listing conditions imposed by the property owner(s). Any projections, opinions or estimates are subject to uncertainty and do not signify current or future property performance. \*Sales Representative

FOR SUBLEASE | FLEX SPACE

# 450 SHERMAN AVE N

HAMILTON, ON



## FLOORPLAN

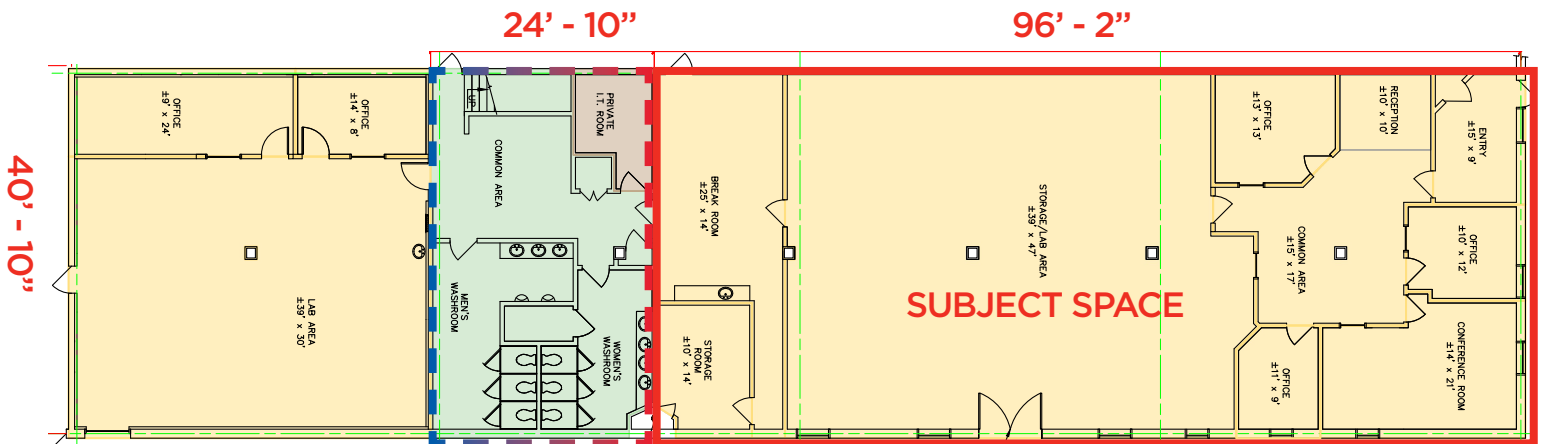

**SUBJECT SPACE - 4,133 SF**



**Shared Common Space**

### CONTACT INFORMATION

**WALTER SPOJA\***

Associate Vice President

905 501 6469

walter.spoja@cushwake.com

**CUSHMAN & WAKEFIELD ULC, BROKERAGE**

1 Prologis Blvd., Suite 300

Mississauga, Ontario L5W 0G2

905 568 9500

[cushmanwakefield.com](http://cushmanwakefield.com)

©2024 Cushman & Wakefield. All rights reserved. The information contained in this communication is strictly confidential. This information has been obtained from sources believed to be reliable but has not been verified. No warranty or representation, express or implied, is made as to the condition of the property (or properties) referenced herein or as to the accuracy or completeness of the information contained herein, and same is submitted subject to errors, omissions, change of price, rental or other conditions, withdrawal without notice, and to any special listing conditions imposed by the property owner(s). Any projections, opinions or estimates are subject to uncertainty and do not signify current or future property performance. \*Sales Representative



FOR SUBLEASE | FLEX SPACE

# 450 SHERMAN AVE N

HAMILTON, ON



## AMENITIES & TRANSIT MAP

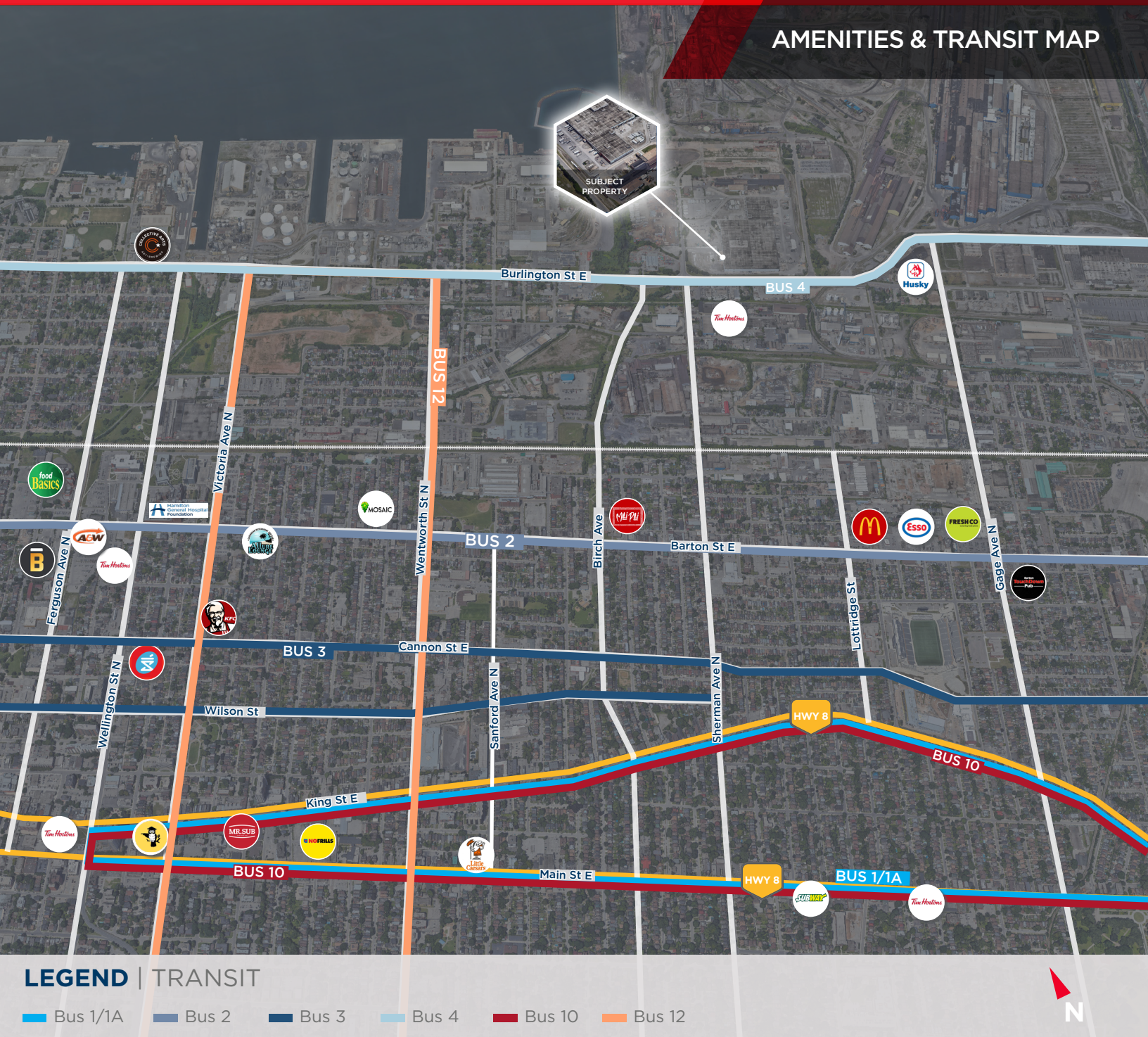

## CONTACT INFORMATION

WALTER SPOJA\*

Associate Vice President

905 501 6469

walter.spoja@cushwake.com

CUSHMAN & WAKEFIELD ULC, BROKERAGE

1 Prologis Blvd., Suite 300

Mississauga, Ontario L5W 0G2

905 568 9500

[cushmanwakefield.com](http://cushmanwakefield.com)

©2024 Cushman & Wakefield. All rights reserved. The information contained in this communication is strictly confidential. This information has been obtained from sources believed to be reliable but has not been verified. No warranty or representation, express or implied, is made as to the condition of the property (or properties) referenced herein or as to the accuracy or completeness of the information contained herein, and same is submitted subject to errors, omissions, change of price, rental or other conditions, withdrawal without notice, and to any special listing conditions imposed by the property owner(s). Any projections, opinions or estimates are subject to uncertainty and do not signify current or future property performance. \*Sales Representative