

FOR LEASE

Post Park Business Center

8719-8861 Boehning Lane, Indianapolis, IN 46219



PROPERTY HIGHLIGHTS

Excellent visibility; west building fronts I-70

Dock and drive-in access

Clear height: 16' - 18'

Double row parking

Easy access to I-70 and I-465 via Post Road

Zoned CS

Wet sprinkler system

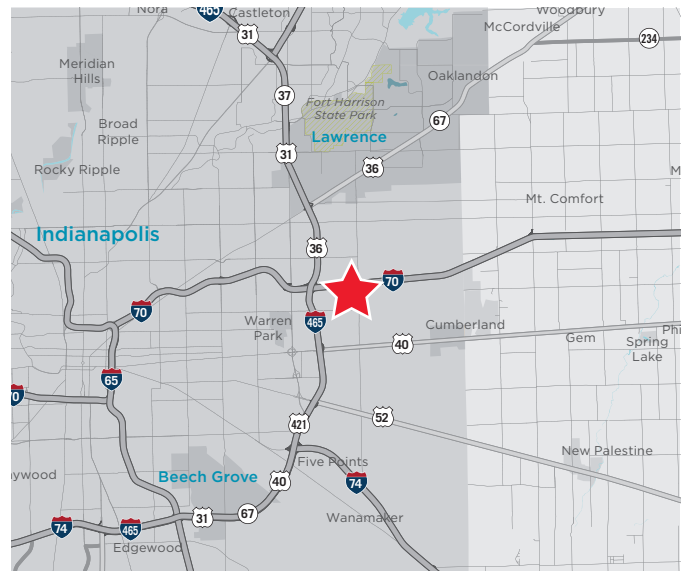

KEVIN W. ARCHER

Senior Director
+1 317 218 7217
kevin.archer@cushwake.com

TODD T. VANNATTA, SIOR

Executive Director
+1 317 639 0455
todd.vannatta@cushwake.com



**CUSHMAN &
WAKEFIELD**

cushmanwakefield.com

Post Park Business Center

Interstate 70

Exit Ramp

Boehning Lane

Post Road

21st Street

West Building

South Building

East Building

8719 8735 8751 8767 8771 8783 8801 8809 8813 8829 - 8841 8845 8857 8861 8901 8905 8909 2162 2158 2150

8740 Suite B 8740 Suite A

N

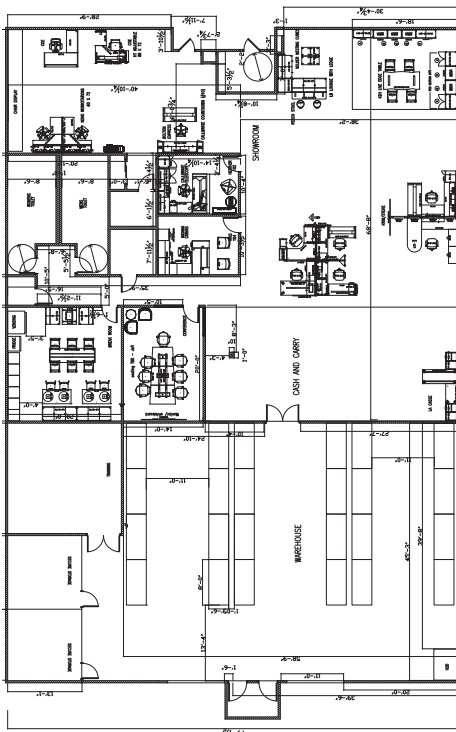

Suite:	8751
Total SF:	9,709 SF
Office SF:	±6,000 SF
Docks/D-1	2 / 0
Clear Ht:	16' - 18'
Base Rate/SF:	\$7.25/SF
OPEX:	\$2.90
Mo. Rent:	\$8,212.20

FOR LEASE

Post Park Business Center

8719-8861 Boehning Lane, Indianapolis, IN 46219

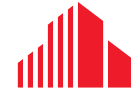

**CUSHMAN &
WAKEFIELD**

Aerial



KEVIN W. ARCHER

Senior Director

+1 317 218 7217

kevin.archer@cushwake.com

TODD T. VANNATTA, SIOR

Executive Director

+1 317 639 0455

todd.vannatta@cushwake.com

One American Square, Suite 1800
Indianapolis, IN 46282

Main +1 317 639 0515

Fax +1 317 639 0504

cushmanwakefield.com